

## ► Warning

The wall structure must be capable of supporting at least a maximum weight of 70lbs (31kg) for 23"-55" televisions. If not, the wall must be reinforced. Proper installation procedure by a qualified service technician, as outlined in the installation instructions, must be adhered to. Failure to do so could result in serious personal injury, or even death.

Safety measures must be practiced at all times during the installation of this product. Use proper safety gear and tools for the installation procedure to prevent personal injury.

Prior to the installation of this product, the installation instructions should be read and completely understood. The installation instructions must be read to prevent personal injury and property damage. Keep these installation instructions in an easily accessible location for future reference.



A secure structure must support the weight or load of the display. When mounting to a wall that contains wooden studs, dead center of the wooden stud must be confirmed prior to installation.



Do not install on a structure that is prone to vibration, movement or chance of impact. Failure to do so could result in damage to the display and/or damage to the mounting surface.



Do not install near heater, fireplace, direct sunlight, air conditioning or any other source of direct heat energy. Failure to do so may result in damage to the display and could increase the risk of fire.



At least two qualified people should perform the installation procedure. Injury and/or damage can result from dropping or mishandling the display.



Recommended mounting surfaces: wooden studs and solid-flat concrete. If the mount is to be installed on any surface other than wooden studs, use suitable hardware (which is commercially available).



# AEON-40112

# AEON-40112

## MOUNTING INSTRUCTIONS

**VESA**  
**100/200/300/400**



70lbs (31kg) max.



23" - 55"(58-140cm)



## ► PARTS INCLUDED

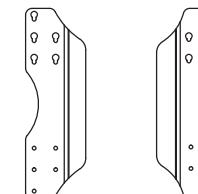
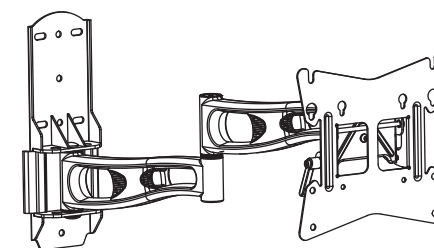

**A**



M4x12 (x4)



M4x30 (x4)

**B**



M5x12 (x4)



M5x30 (x4)

**C**



M6x12 (x4)



M6x30 (x4)

**D**



M8x16 (x4)



M8x30 (x4)

**E**



Φ18x6.5x1.5(x4)



18X8X20 (x4)

**F**



Φ20x8x1(x5)



M8x60 (x5)



Φ10x50(x5)

**G**



M8 (x4)

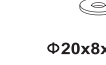

Φ20x8x1(x4)



(level)

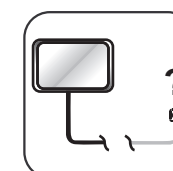
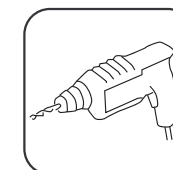
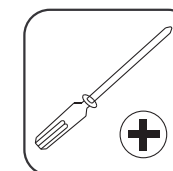

## ► INSTALLATION

### 1 Mark Location of TV Mount (on wooden studs)

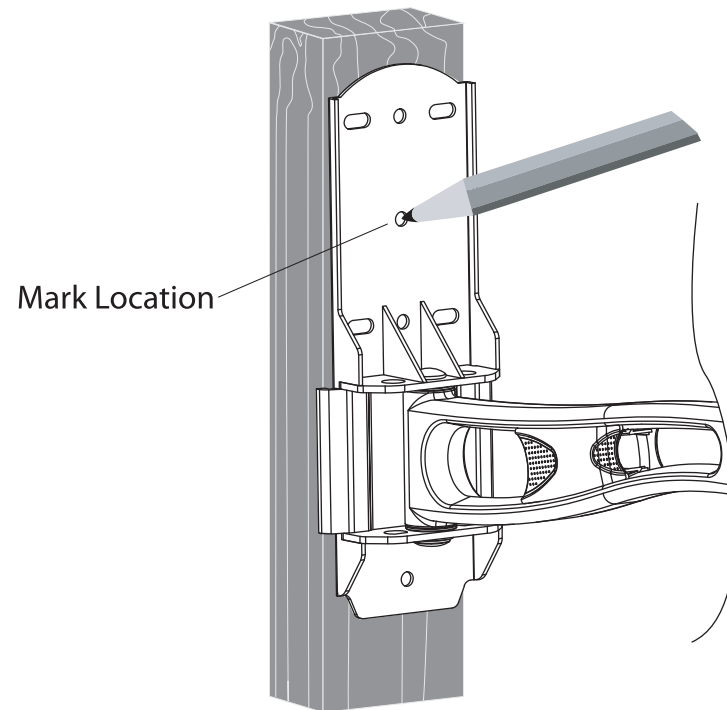
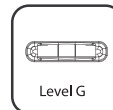

#### NOTE:

If mounting to concrete or masonry please skip to step 3.

1. Using a stud finder, locate the appropriate wood stud where the mount is to be installed.
2. While ensuring the mount is level, mark the wall with a pencil where the pilot holes are to be drilled.

### 2 Mounting to Wooden Stud

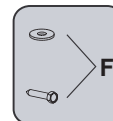
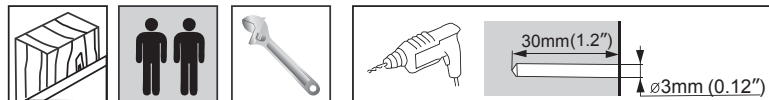

Level

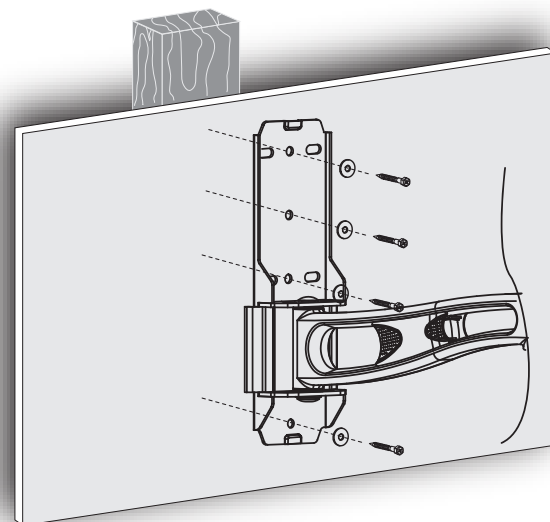

1. Once all pilot holes have been marked, using a 3mm drill bit drill four holes that are each 1.2" deep.
2. Insert and tighten the four (4) screws and washers to securely affix the TV mount to the stud.

## ► INSTALLATION

### 3 Mounting to Concrete or Masonry

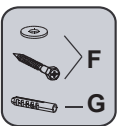
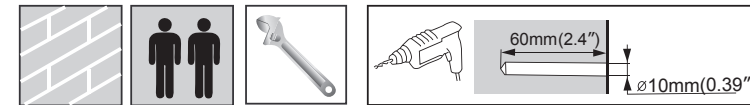

Level

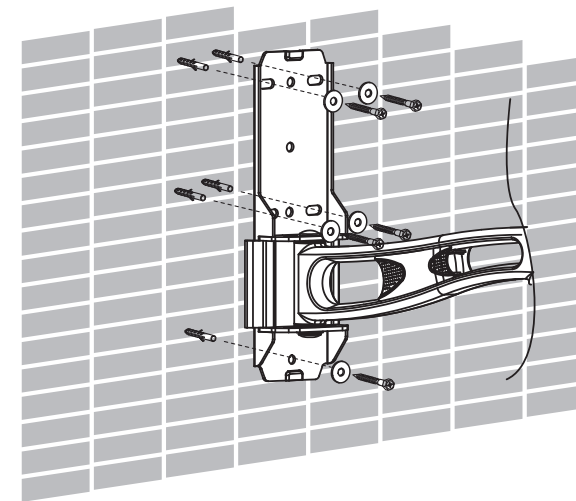

#### NOTE:

If mounting to a wooden stud please skip this step and proceed to step 4.

1. Select the appropriate location where the mount is to be installed and mark the six (6) outer pilot holes.
2. Using a 10mm drill bit, drill six (6) separate holes each 2.4" deep.
3. Attach the provided anchors and screws and securely tighten them into place.

### 4 Mount Installation

#### NOTE:

For TVs with a 100 x 100 or 200 x 200mm VESA size. (TVs with a 300 x 300 or 400 x 400 VESA size please skip this step and refer to step 5).

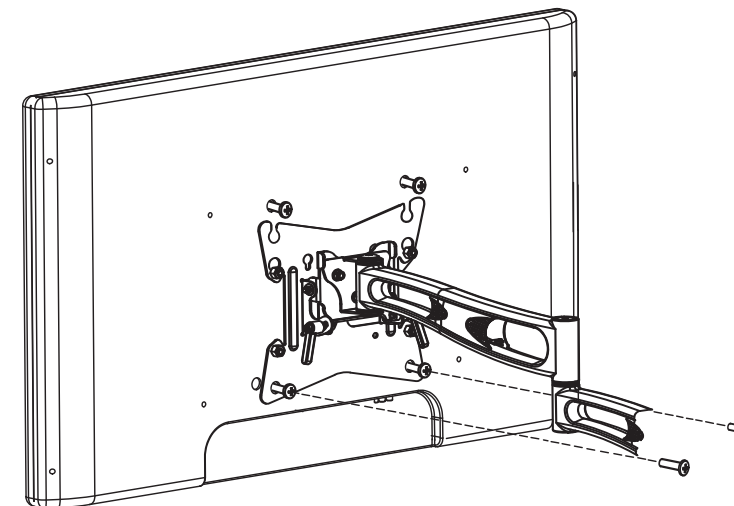

1. Install two (2) of the appropriately sized mounting screws into the top two mounting holes on the back of your TV. Do not tighten completely at this time.
2. Align the TV mount's faceplate with the two screws in your TV and then hook both screws into the appropriate slots/channel at the top of the faceplate and tighten them securely.
3. Now insert and securely tighten the bottom two screws into the back of your TV.

**NOTE:** Once the bottom screws have been installed, please recheck the top screws and make sure they are still extremely tight.

## ► INSTALLATION

### 5 Attaching the Adapter Plates

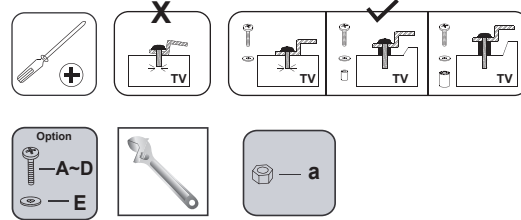
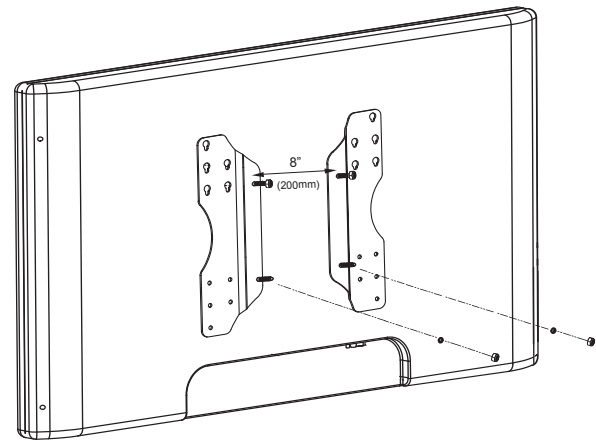

#### NOTE:

This step is necessary for TVs with a 300 x 300 or 400 x 400mm VESA pattern.

1. Place the adapter plates on the back of the TV (with the slotted mounting holes at the top) aligning them with the appropriate VESA pattern. Install the top two screws to secure the adapter plates to the back of the TV, please note the adapter plates must be 8" or 200mm apart from one another so the TV mount faceplate can be attached them.

2. Next, install the top two (2) Bolts and nuts into the adapter plate with the bolt head(s) facing you; do not completely tighten these yet.

### 6 Attaching the Adapter Plates to TVs with a Recessed Mounting Pattern

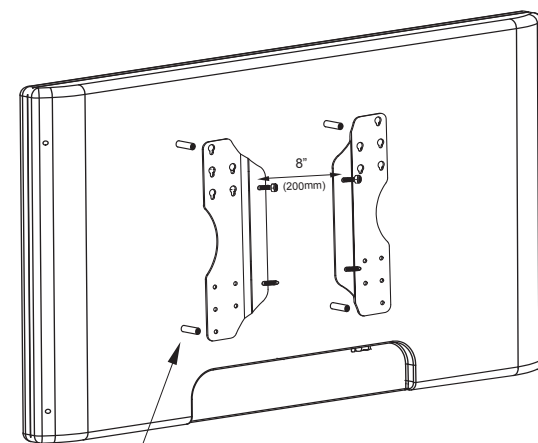

If your TV's mounting holes are recessed please incorporate the included spacers by placing them between the back of the TV and the adapter plates. If not, proceed to step 7.

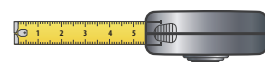

spacers

## ► INSTALLATION

### 7 Attaching the TV to the Mount

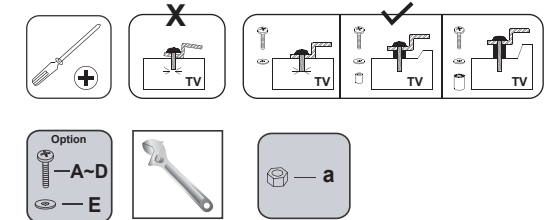
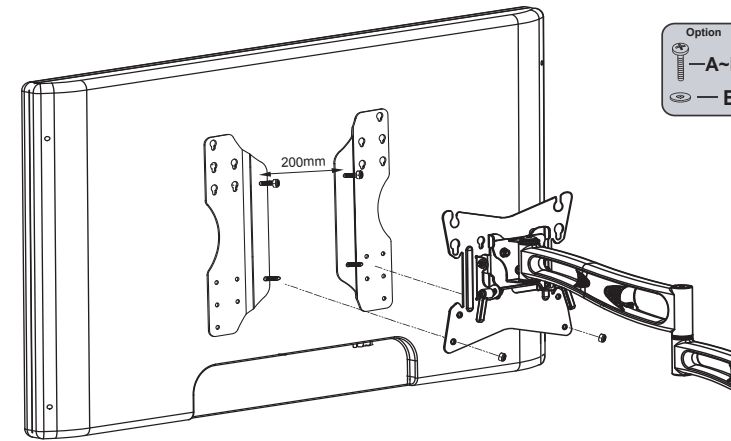

1. Install the bottom two (2) bolts and nuts in the opposite order of step 5, the bottom two bolts will have the bolt heads facing your TV when installed through the adapter plates, do not install the nuts yet.

2. Now install the TV Mount onto the adapter plates by lining up the two slotted holes at the top of the faceplate and hooking them on to the top two bolts. These can now be securely tightened. The bottom two bolts will slide through the adapter plate so the nuts can be installed and tightened securely; locking the TV mount in place.

### 8 Using Cable Management

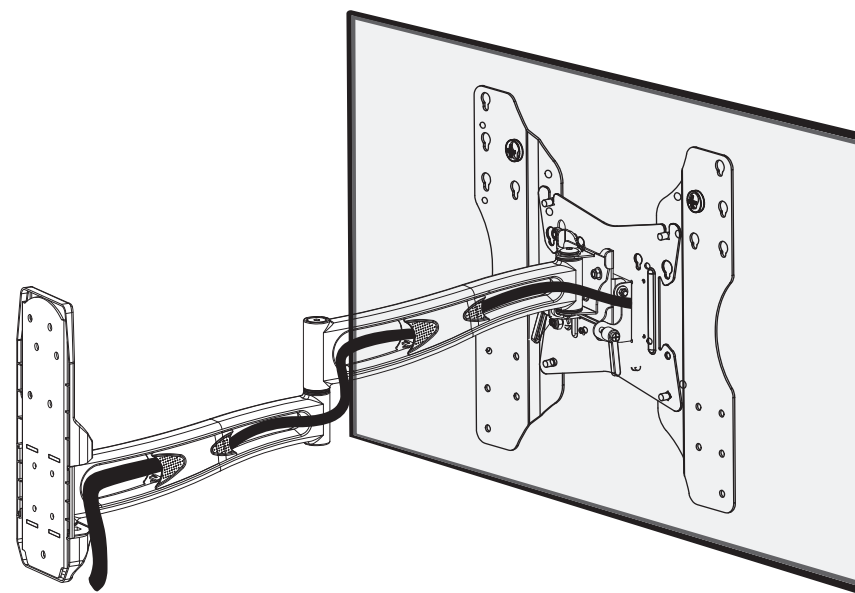

Easy to use cable management allows several cords / interconnects to be concealed putting a neat, clean appearance on your installation.

## ► INSTALLATION

### 9 Plastic Covers Installation

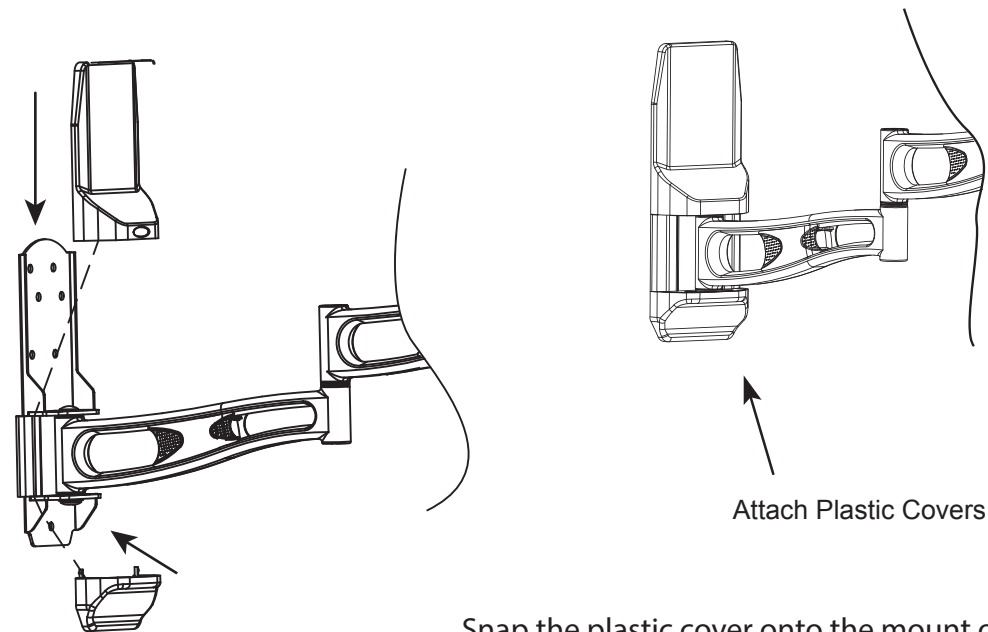

Attach Plastic Covers

Snap the plastic cover onto the mount once all cable and wire management has been completed.

### 10 Post-Installation Leveling

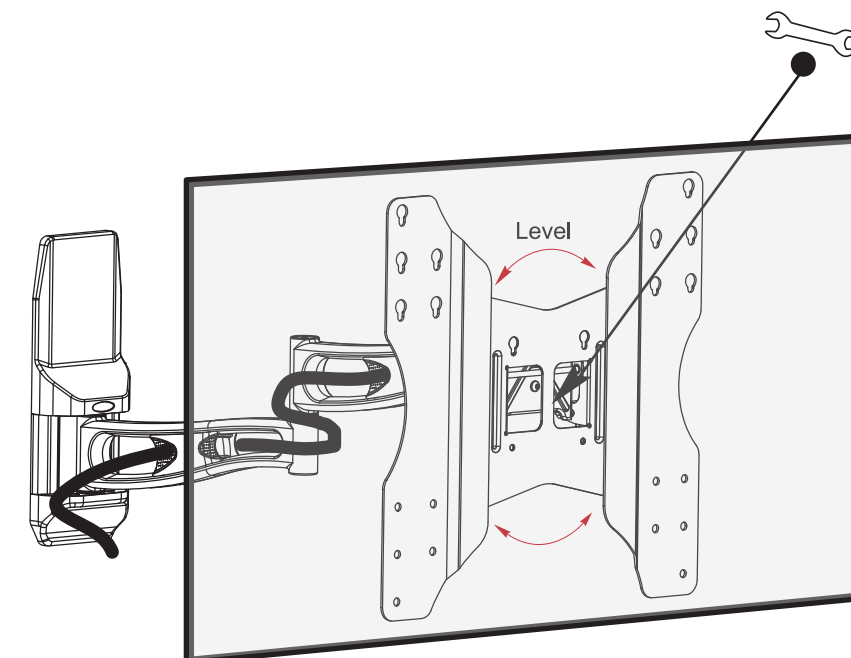

The Aeon 40112 features a level adjustment via the 3 screws on the back of the faceplate. Simply loosen these screws and adjust the TV to the proper position. Once the TV is in the ideal location please re-tighten these screws securely.

## ► INSTALLATION

### 11 Adjusting the Display

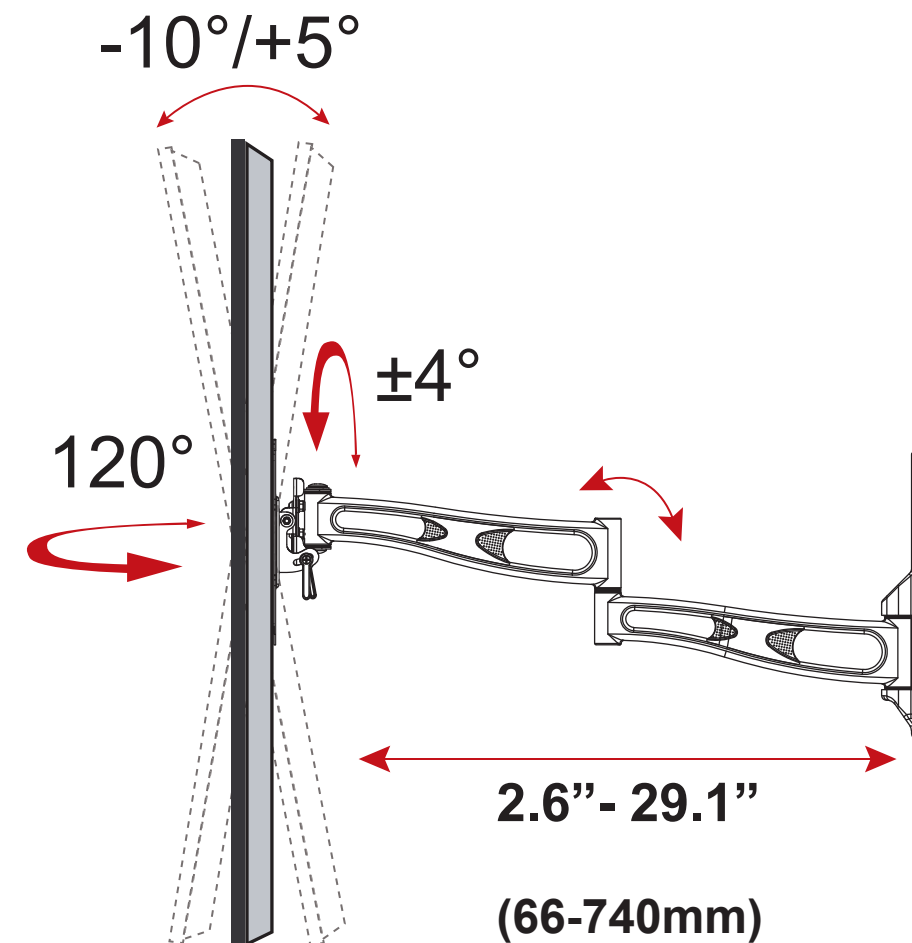

**AEON**  
Stands & Mounts

**AEON - 40112**