

Assembly Instruction

Easy Installation

D.I.Y

WARNING! PLEASE PLACE ALL THE PRODUCTS AT ROOM TEMPERATURE AND DO NOT STORAGE THE BIDETS AND ITS ASSESSORIES IN THE FREEZING TEMPERTURE ENVIRONMENTS UNDER 0 DEGREE CELCIUS!

1. NAMES AND FUNCTIONS OF PARTS

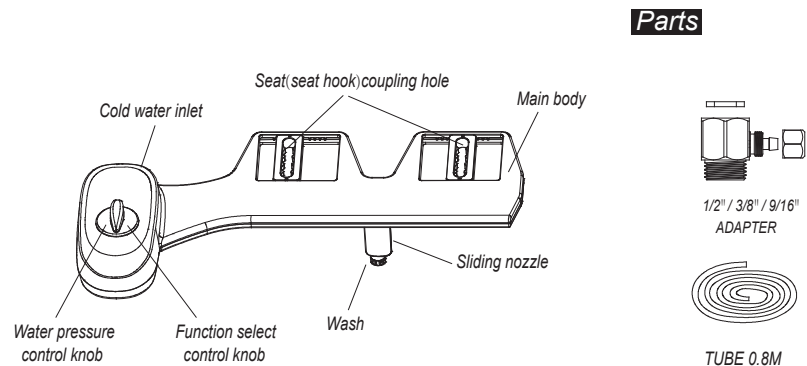

Intallation Tools May Needed

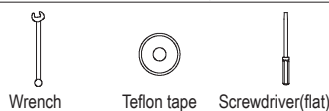

2. INSTALLATION

PREPARATION

A. Remove the existing toilet seat.
C. Flush toilet to drain tank completely.

B. Turn off the water valve.
D. Take out exiting water pipe.

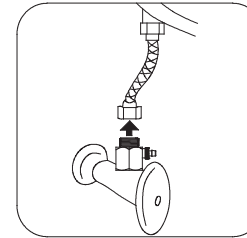

A. Install adaptor beneath water tank

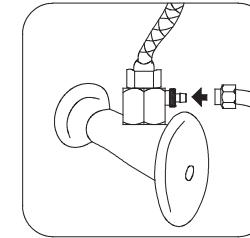

B. Connect white water tube into adaptor nipple

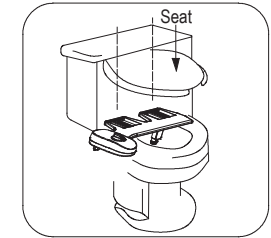

C. Install main body



HELPFUL TIP:

Over tightening flexible hoses adaptor can cause damage to the threads and result in water leakage. Use only hand pressure first and check for any leakage. Turn only less than quarter turn at a time making sure there is no leakage.

3. FINAL ASSEMBLED FIGURE

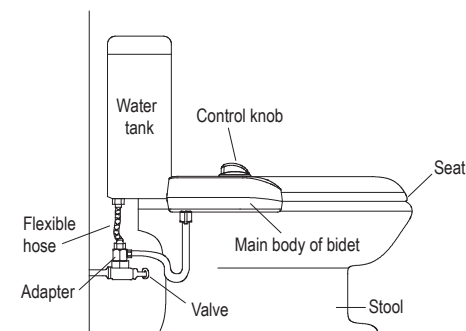

TRYING FOR THE FIRST TIME

Congratulations! You are ready to use for the first time. Be sure to turn water pressure control knob gently until reaching your desired pressure. Water pressure control device is only to control water pressure, not for setting up the duration of water spray.

TROUBLE SHOOTING

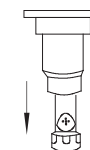

If your spray outlet hole is clogged for some reason, simply try to move spray outlet up and down for a few times manually.