

## PREPARATION

Tools Required for Assembly: (Not included)

- Pencil
- Electrical drill with 5/16 in. drill bit
- Mallet Hammer



- Phillips head screwdriver
- Tape measure

- Level
- Safety glasses

**! CAUTION:** Molly bolts are for dry wall only.  
Use tile anchors for solid surface. (Not included)

## INSTALLATION INSTRUCTIONS

1. Hold assembled item up against desired position on wall, and outline the back plates of end pieces with a pencil. Use a measuring tape and a level for accuracy (Fig. 1).
2. Position a mounting bracket in the center of outlined back plate. Use a pencil to mark positioning of the screw holes (Fig. 2).
3. Drill 5/16 in. pilot holes into the wall where the molly bolts will be inserted using an electrical drill. Tap molly bolts into the pilot holes using a hammer (A). Use an electrical screwdriver to tighten the screws. This will collapse the molly bolts tightly to the wall (B). Unscrew the screws from the molly bolts (C). Molly bolts will remain in the wall (Fig. 3).
4. Place the mounting bracket over the molly bolts. Insert the screws back through the bracket and the molly bolts, then tighten firmly with Phillips head screwdriver (Fig. 4).
5. Secure the end piece with Allen wrench and set screw (Fig. 5).  
Do not use power drill.

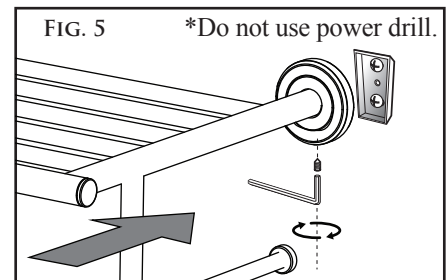
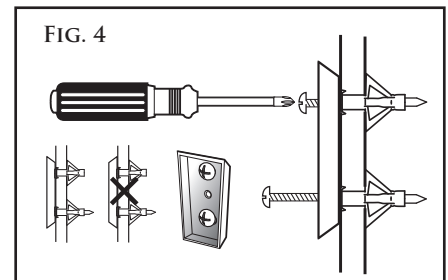
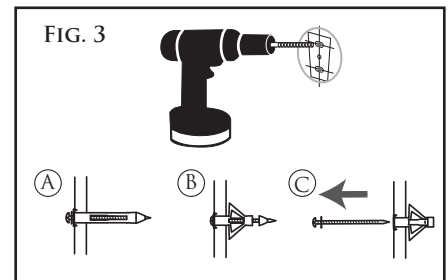
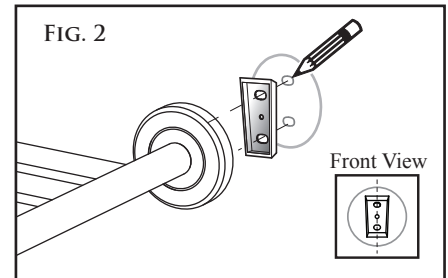
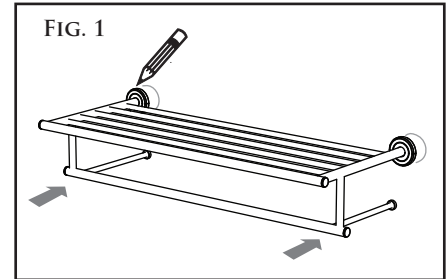

## CARE AND MAINTENANCE

To maintain the beautiful luster finish, please use soft damp cloths when cleaning and never use any cleaning solvents.