

WALL SHELF

with keyholes

TOOLS NEEDED

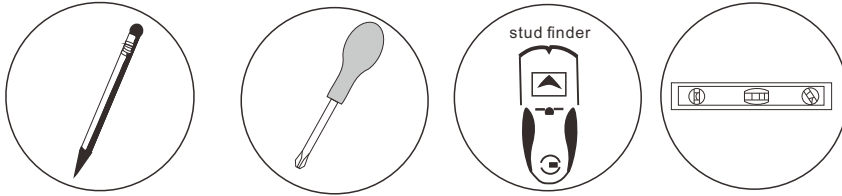

HARDWARE

plastic dry wall anchor
Size: 6mm \varnothing × 30mm L

philip head screws
Size: 4mm dia. × 30mm L

stud mounting screw
Size: 4mm \varnothing × 50mm L



NOTE:

- For drywall mounting, use anchors with screws.
- For stud mounting, use stud mounting screw.
- If walls are concrete or plaster, please consult your local hardware store.

STEP 1

Drywall Mounting: (1a) Determine placement of shelf on wall. Mark for anchors. Drill 2mm (3 / 32") hole through the pencil marks into the wall

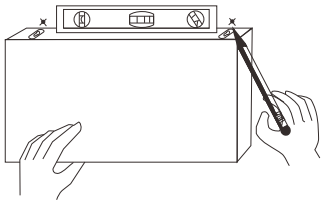

STEP 2

Dry wall mounting: (2a) Place Philips screw driver into anchor (a). Press the anchor into wall, then turn clockwise until anchor is flush with the wall.

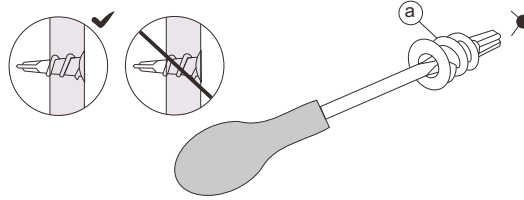

STEP 3

Dry wall mounting: (3a) Insert screws (b) into anchors.

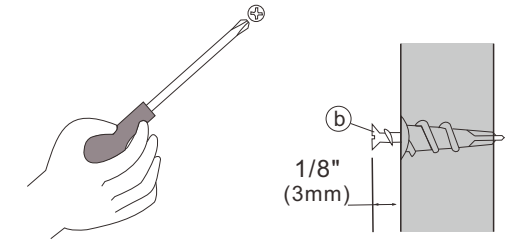

Stud Mounting: (1b) Using a stud finder, locate and carefully mark the location of studs on the wall where you want to hang your shelf.
Note: It is best to mount the shelf to at least one stud.

Stud Mounting: (2b) Skip to step 3

Stud Mounting: (3b) Using Philips

STEP 4

Hang shelf.

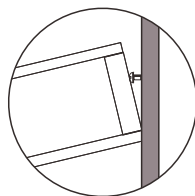
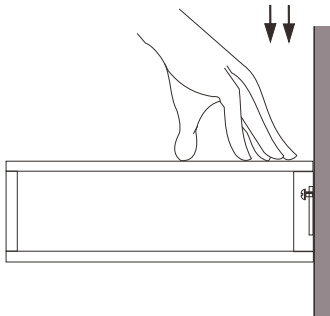

NOTE: Tighten screw and re-hang