

 brondell™
a better bathroom experience

FreshSpa

easy bidet



Owner's Manual FS-10/FreshSpa



Table of Contents

Product Features.....	Page 2
Parts List.....	Page 3
Configuration.....	Page 4
Installation	Page 5
Operation	Page 9
Maintenance.....	Page 10
Warranty	Page 11
Contact.....	Page 13

FreshSpa

easy bidet

FreshSpa Feature List:

- Hygienic retractable nozzle
- Self cleaning nozzle feature
- Ambient temperature bidet wash
- Nozzle positioning (3 settings)
- Adjustable water pressure
- All brass internal valve
- All brass 3/8" T-valve
- High quality braided PVC hose
- Anti-bacterial ABS material with full body panel
- Backflow prevention valve
- No electricity or batteries required
- Easy installation and adjustable toilet fit
- All accessories included for standard installation
- 1 year warranty

FreshSpa

easy bidet

Parts List



Bidet attachment with turn dial control

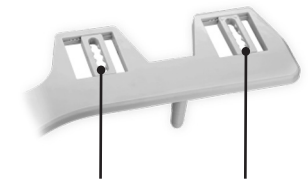

Adjustable brackets

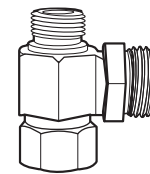

T-valve connector

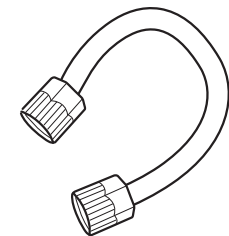

Bidet hose



2 ea large rubber washer



2 ea small rubber washer

FreshSpa

easy bidet

Configuration

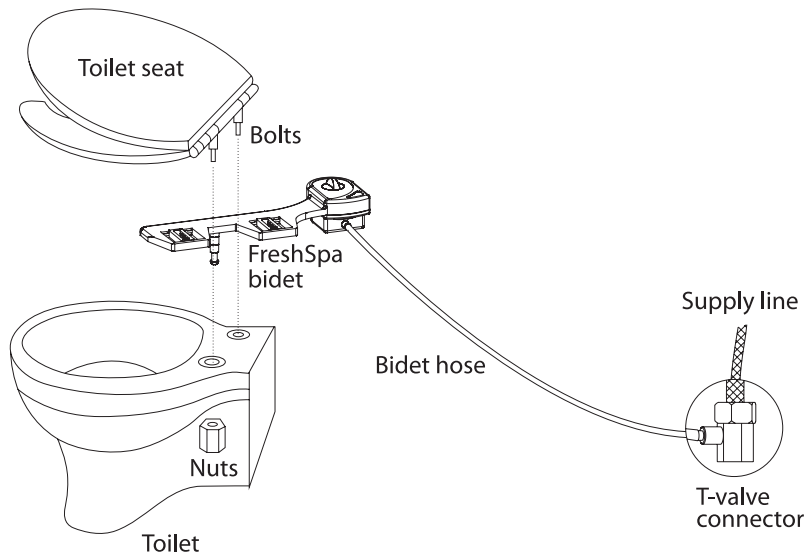
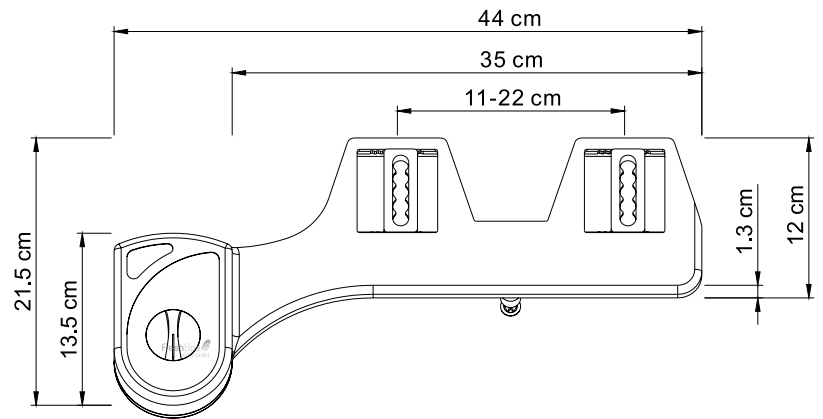

FreshSpa

easy bidet

Installation

Check the size of the connection at your water supply shut off valve. It needs to be a 3/8" connector for our T-valve to install between the supply line and the shut off valve. Note: if you have a 1/2" water supply connection at the wall, you will need to purchase the following reducing adapter available online and at many plumbing hardware stores: **Reducing Adapter, 1/2" Female NPT X 3/8" Male Compression.**

Check the water supply line that connects the toilet tank to the water shut off valve at the wall. If it is a rigid pipe, you will need to purchase a flexible water supply hose to replace it before installing the FreshSpa. The length of the hose will vary, the top connection size should be 7/8" ballcock to connect to your fill valve under the toilet tank and the bottom connection size should be 3/8" female compression to connect to the FreshSpa brass T-valve.

1) Remove existing toilet seat

- a. Lift hinge covers and use flathead or Phillips head screwdriver to remove the mounting bolts. Alternatively, you may need to loosen mounting bolts underneath the seat.
- b. Remove the toilet seat and set the seat, mounting bolts and hardware aside.

Installation

2) Turn off water supply valve and flush toilet

a. Turn off water supply at the wall to stop flow of water.

b. Flush toilet and hold down handle to completely empty toilet tank.

c. Disconnect water supply hose from water shut off valve. You may have to use a 3/8" compatible wrench or a similar tool if the connection is tight (not supplied).

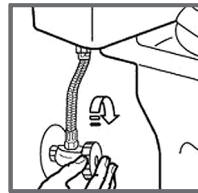

Step 2a

3) Connect T-valve to supply line

Note: Do not connect FreshSpa to hot water line. Only connect to a cold water pipe.

a. Install the T-valve and the small rubber washer onto the water shut off valve coming out of the wall.

b. Connect the water supply line to the open end of the T-valve using the second small rubber washer (if needed).

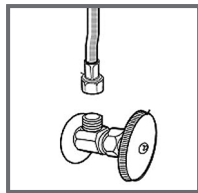

Step 2c

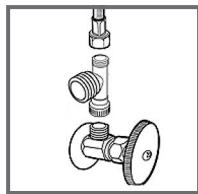

Step 3a & 3b

Installation

4) Connect the Bidet Hose to the T-valve

a. Connect one end of the bidet hose to the remaining open side of the T-valve.

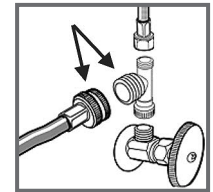

Step 4a

5) Install Bidet Attachment on Toilet

a. Place large rubber washers over the open bolt holes in the toilet fixture.

b. Place bidet attachment over washers so the nozzle is as close to the back of the toilet bowl as it will go. This will vary by toilet.

c. Make sure the adjustable brackets line up with the holes in the toilet fixture. You may need to move the adjustable brackets accordingly to line up properly.

d. Replace the toilet seat on top of bidet attachment and secure using original toilet seat hardware. Make sure to tighten so that the bidet attachment and seat do not move.

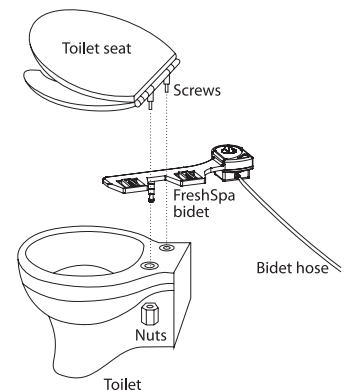

Step 5

FreshSpa

easy bidet

Installation

6) Connect Bidet Hose to Bidet Attachment

- a. Connect open end of bidet hose to the brass connection on the bottom side of the bidet attachment.



Step 6a

7) Turn on Water Supply & Check for Leaks

- a. Open the main water supply valve slowly and check for leaks.
- b. Wait 5-10 minutes, check again and if there are no leaks continue.

Note: if there is any leaking, check all rubber washers and make sure all water connections are tight and secure. If necessary, you can use plumbers tape for any leaking connections.

FreshSpa

easy bidet

Operation

Using the FreshSpa

To clean the bidet nozzle, turn the control dial towards the “Nozzle Cleaning” position and water should wash over the nozzle.

For the general bidet wash function, turn the dial towards the “Wash” position.

- The further the dial is turned, the higher the water pressure will be.
- To lower the water pressure, turn the nozzle back towards the center.

For a front wash function, women may need to tilt & bend forward slightly in order for the spray to hit the appropriate areas.

Nozzle positioning

There are 3 different nozzle positions that you can easily adjust by gently pulling the end of the nozzle forward or backwards. Once desired position is set, the nozzle will remain in that position until manually moved.





Maintenance

To clean the nozzle, gently pull down on the head of the nozzle, and use a toothbrush or soft cloth and mild detergent (such as dish soap) to clean the nozzles. You may also unscrew the nozzle tip cap for a more thorough cleaning or use a toothpick if any nozzle holes are plugged with hard water buildup.

To clean the bidet, use a mild cleaner such as Simple Green or Windex spray to clean the FreshSpa. Do not scrub or use harsh, abrasive products to clean the FreshSpa, which may scratch the product.



Warranty

Brondell products are backed by some of the most comprehensive warranties in the industry. Brondell warrants that the FreshSpa shall be free from defects in material and workmanship under normal use and service.

FreshSpa One-Year Limited Warranty

100% Coverage of all parts and labor for the entire product for the first year from original date of purchase

Exclusions and Limitations

1. BRONDELL warrants its products to be free from manufacturing defects under normal use and service. This warranty is extended only to the ORIGINAL PURCHASER.
2. BRONDELL's obligations under this warranty are limited to repairs or replacement, at BRONDELL's option, of products or parts found to be defective, provided that such products were properly installed and used in accordance with instructions. BRONDELL reserves the right to make such inspections as may be necessary in order to determine the cause of the defect. BRONDELL will not charge for labor or parts in connection with warranty repairs for the first full year from date of purchase on all products except those that may be subject to commercial use limitations.
3. BRONDELL is not responsible for the cost of removal, return (shipping) and/or reinstallation of products. This warranty does NOT apply to:
 - Damage or loss which occurs during shipment.
 - Damage or loss sustained through any natural or manmade causes beyond the control of BRONDELL, including but not limited to fire, earthquake, floods, etc.
 - Damage or loss resulting from sediments or foreign matter contained in a water system.
 - Damage or loss resulting from negligent or improper installation including installation of a unit in a harsh or hazardous environment.
 - Damage or loss resulting from removal, improper repair, modification of the product, or improper maintenance including damage caused by chlorine or chlorine related products.
 - Damage or loss resulting from acts which are not the fault of Brondell or which the Product is not specified to tolerate.



Warranty

4. This warranty gives you specific legal rights. You may have other rights which vary from state to state.

THIS WRITTEN WARRANTY IS THE ONLY WARRANTY MADE BY BRONDELL. REPAIR OR REPLACEMENT AS PROVIDED UNDER THIS WARRANTY SHALL BE THE EXCLUSIVE REMEDY AVAILABLE TO THE PURCHASER. BRONDELL SHALL NOT BE RESPONSIBLE FOR LOSS OF USE OF THE PRODUCT OR FOR OTHER INCIDENTAL, SPECIAL, FOR CONSEQUENTIAL DAMAGES OR EXPENSES INCURRED BY THE PURCHASER OR FOR LABOR OR OTHER COSTS DUE TO INSTALLATION OR REMOVAL OR COSTS OF REPAIRS BY OTHERS, OR FOR ANY OTHER EXPENSE NOT SPECIFICALLY STATED ABOVE. EXCEPT TO THE EXTENT PROHIBITED BY APPLICABLE LAW, ANY IMPLIED WARRANTIES, INCLUDING THAT OF MERCHANTABILITY, ARE EXPRESSLY LIMITED TO THE DURATION OF THIS WARRANTY. SOME STATES DO NOT ALLOW LIMITATIONS, SO THE ABOVE LIMITATION AND EXCLUSION MAY NOT APPLY TO YOU.

How to Obtain Service

To obtain repair service under this warranty, you must contact an authorized BRONDELL Service Center to obtain an RMA (Return Merchandise Authorization) number. Proof of purchase in the form of a copy of your original receipt must accompany the returned unit for the warranty to be valid. Take or ship the unit pre-paid to the closest Brondell authorized service center along with your RMA number and proof of purchase.

To obtain your RMA number and locate the BRONDELL Service Center location nearest you, call 1-888-542-3355.



Contact

Brondell, Inc.

PO Box 470085

San Francisco, CA 94147-0085

Phone: 1-888-542-3355

Email: support@brondell.com

Web: www.brondell.com

For questions, contact
Brondell Customer Service:

1-888-542-3355



