

## ENGLISH

### TO INSTALL:

**WARNING:** TO BE INSTALLED AND/OR USED IN ACCORDANCE WITH APPROPRIATE ELECTRICAL CODES AND REGULATIONS.

**WARNING:** USE THIS DEVICE WITH **COPPER OR COPPER-CLAD WIRE ONLY**.

**WARNING:** IF YOU ARE NOT SURE ABOUT ANY PART OF THESE INSTRUCTIONS, CONSULT AN ELECTRICIAN.

**FOR SEPARATE FEED CONVERSION ONLY:** Our outlet is provided with a break-off fin located between the two brass terminal screws. If you want to have the top outlet and the bottom outlet controlled by two *different* hot wires (two circuits), remove the break-off fin *before wiring*. With needlenose pliers, bend fin back and forth until it breaks off.

- 1. WARNING:** TO AVOID FIRE, SHOCK, OR DEATH; **TURN OFF POWER** AT CIRCUIT BREAKER OR FUSE AND TEST THAT THE POWER IS OFF BEFORE WIRING!
2. Remove insulation per strip gauge on device [about 5/8" (1.6 cm)].
3. Connect wires per WIRING DIAGRAM as follows:  
**To Side Wire:** Loop wires clockwise 3/4 turn around terminal screws. BLACK (hot) wire to BRASS screw, WHITE (neutral) wire to SILVER screw, GREEN or BARE (ground) wire to GREEN screw. Firmly tighten screws over wire loops. Terminal screws accept up to #12 AWG copper or copper clad wire.  
**To Quickwire™:** Insert straight #14 AWG solid copper or copper clad wires into round Quickwire™ holes. Quickwire™ terminals accept #14 AWG solid copper or copper clad wires **ONLY!** For circuits with #12 AWG solid copper or copper clad wires, use terminal screws instead. If the receptacle must be replaced or rewired after Quickwiring, gently press the tip of a small screwdriver in the release slot and back the wire out gradually.
4. Mount device using long mounting screws. Attach wallplate (not included).
5. Restore power at circuit breaker or fuse. **Installation is complete.**

### DIRECTIONS FOR BREAKING OFF TERMINAL FIN

DIRECTIVES POUR SÉPARER L'AILETTE DÉTACHABLE

DIRECCIONES PARA ROMPER LA ALETA TERMINAL

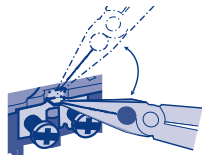

**STRIP GAGE**  
GABARIT DÉNUDAGE  
MEDIDA DE PELADO

**5/8" (1.6 cm)**  
1,6 cm (0,625 po)  
1.6 cm (5/8")

