

QUICK Install Guide

PerforMAX® 400AH FILL VALVE



*See back page for important legal information.

INSTALL WITH CONFIDENCE

TOOLS NEEDED



Pliers



Towel

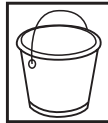

Bucket



Sponge

GETTING STARTED

PARTS OVERVIEW



STEP 1: PREPARE TANK

A: TURN OFF WATER



B: DRAIN WATER

Flush toilet to drain most of the water from the tank.

FLUSH



C: USE SPONGE OR TOWEL TO SOAK UP EXCESS WATER IN TANK



Sponge



Towel

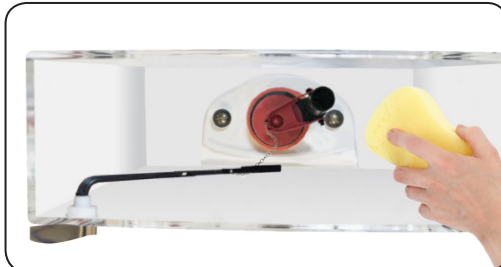

STEP 2: REMOVE OLD FILL VALVE

A: REMOVE CONNECTOR

Remove water supply connector from bottom of fill valve by twisting connector nut to the **left (clockwise)**.



B: REMOVE OLD LOCKNUT

Below tank, twist locknut to the **left (clockwise)** to remove from fill valve.



Pliers
(Optional)



C: REMOVE OLD FILL VALVE

Drain any excess water into bucket by removing fill valve from tank.
(Pull fill valve up)



Bucket
(Optional)



STEP 3: ADJUST HEIGHT OF NEW FILL VALVE

A: TWIST FILL VALVE TO ADJUST HEIGHT

Top of fill valve cap should measure *roughly 3"* above top of overflow pipe.

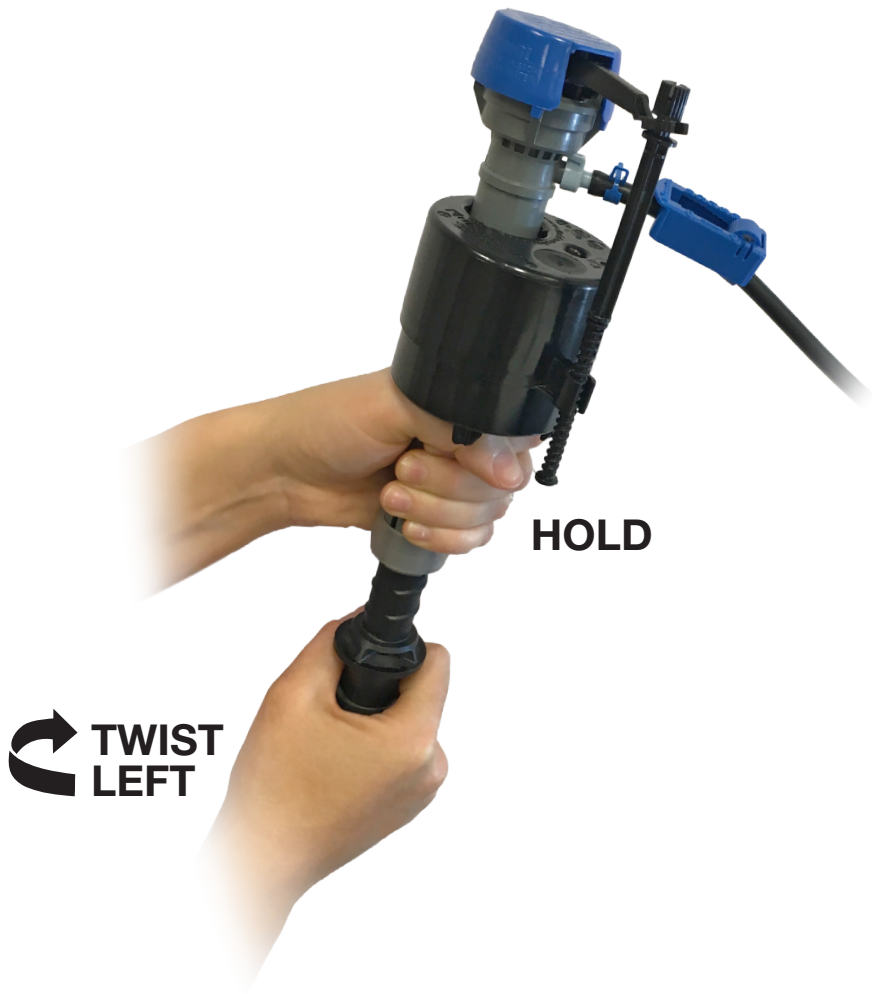

FOR STANDARD FLUSH VALVES

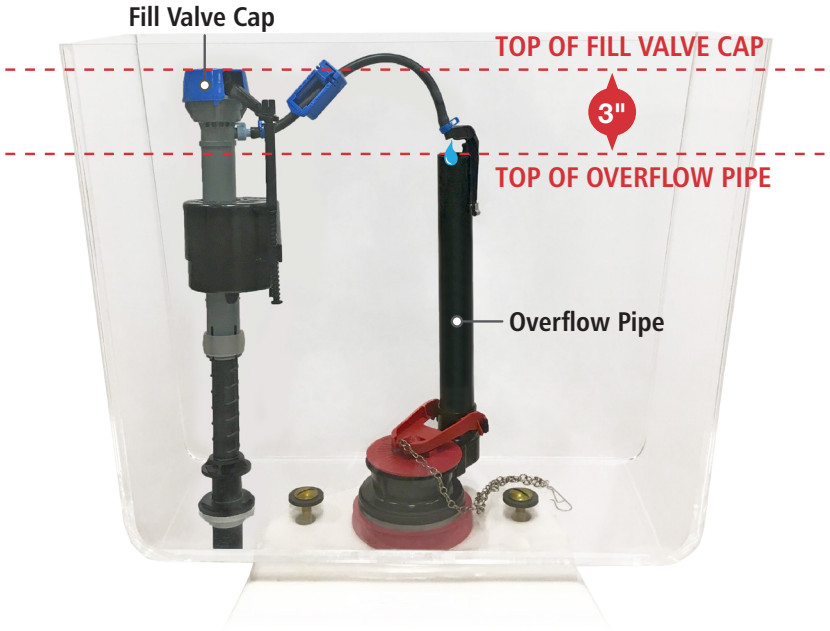

FOR CANISTER FLUSH VALVES



STEP 4: INSTALL NEW FILL VALVE

A: INSTALL SHANK WASHER

Pull up to top of shank.

* Place shank washer onto threaded shank of fill valve. **WIDE SIDE UP.**

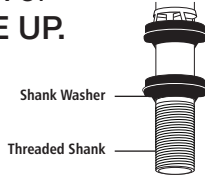

B: PUSH REFILL TUBE ONTO REFILL PORT FIRST

Squeeze tube clamp arms and move it towards refill port.



C: ATTACH REFILL CLIP TO OVERFLOW PIPE

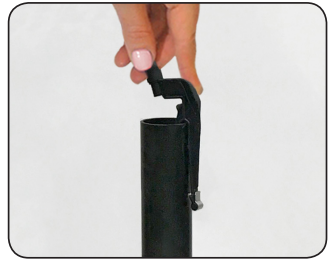

D: INSERT FILL VALVE

Position refill tube to face overflow pipe.



- E: INSTALL LOCKNUT**
Screw locknut to the **right (counterclockwise)** onto fill valve shank (below tank).



- F: ATTACH REFILL TUBE TO REFILL CLIP**
Squeeze tube clamp arms and move it towards refill clip.
Note: If refill tube is too long, cut tube.

Standard Flush Valves

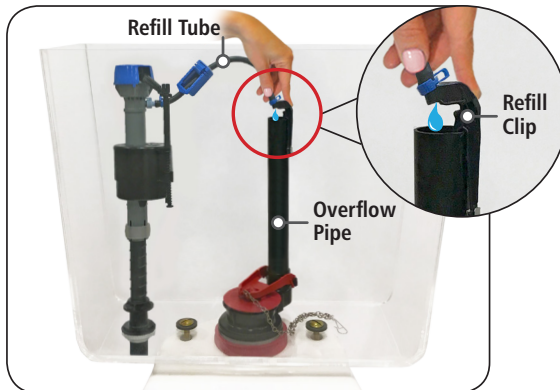

Canister Flush Valves

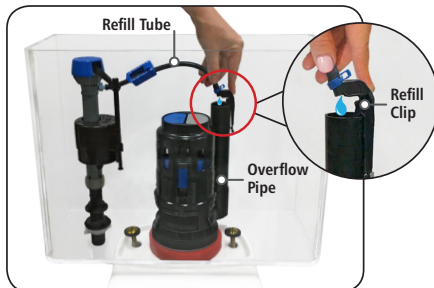

STEP 5: FINISHING STEPS

A: ATTACH WATER SUPPLY CONNECTOR TO FILL VALVE

Twist to the **right** (counterclockwise)



B: TURN ON WATER

Check for leaks.

(See Troubleshooting for leak solutions)



C: WATER LEVEL

After the tank stops filling, water level should fill the tank to **roughly ½ inch below top of overflow pipe** to ensure a proper flush.

See diagrams on next page.

FOR STANDARD FLUSH VALVES

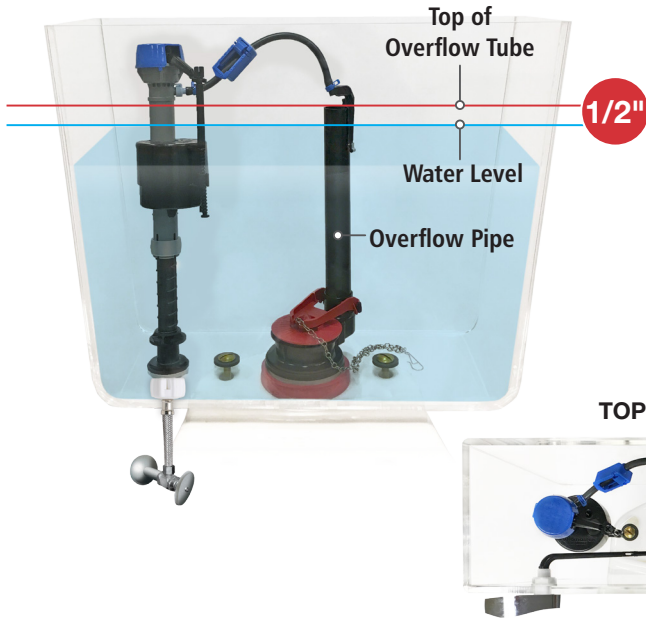

FOR CANISTER FLUSH VALVES

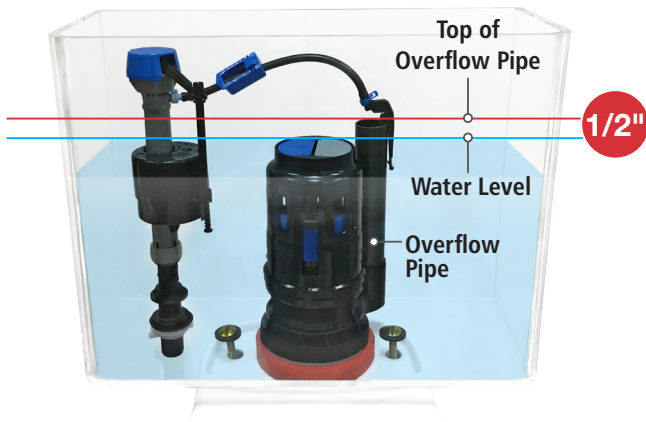

STEP 6: FINE-TUNE TANK WATER LEVEL

A: FLUSH THE TOILET TO CHECK THE TANK WATER LEVEL

After the water stops filling the tank, the water level should be **roughly 1/2 inch** below the top of overflow pipe to ensure a proper flush.

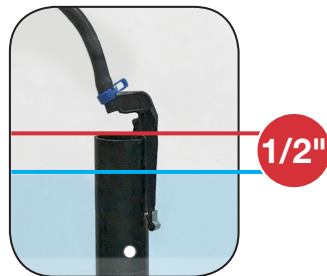

Overflow Pipe

B: WATER LEVEL IS TOO LOW

Turn the tank water level adjustment screw clockwise to raise the float. Flush to reset water level.

WATER LEVEL IS TOO HIGH

Turn the water level adjustment screw counterclockwise to lower the float. Flush to reset water level.



FOR STANDARD FLUSH VALVES

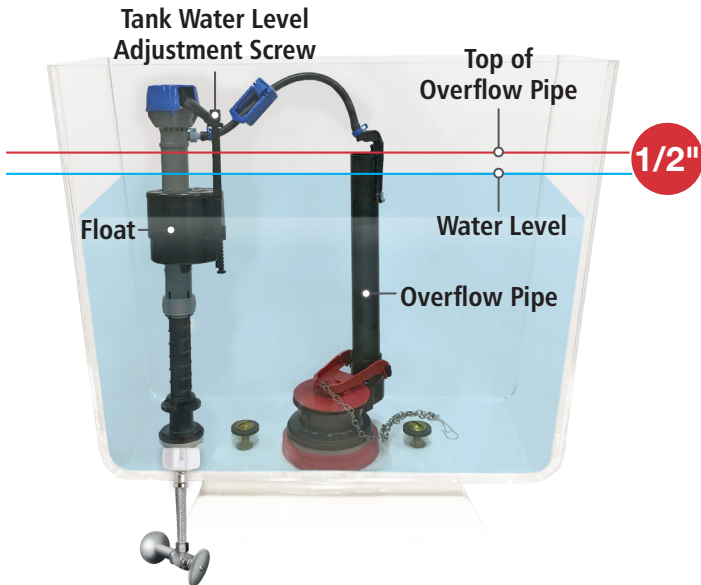

FOR CANISTER FLUSH VALVES

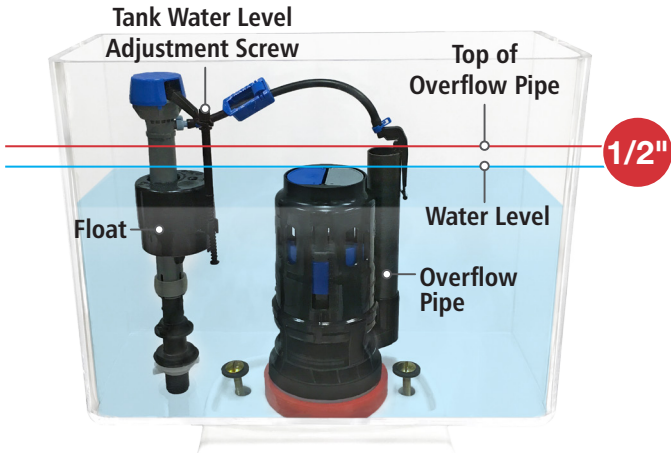

STEP 7: FINE-TUNE BOWL WATER LEVEL

A: FILL BOWL WITH A GALLON OF WATER

Wait 1 minute until the bowl water level recedes down and stops.



B: MARK THE WATER LEVEL IN THE BOWL

With a pencil, draw a line at the top of the water level in bowl.



C: FLUSH TOILET TO CHECK BOWL WATER LEVEL

If the water level **matches the line** you've made in the bowl when the fill valve **stops filling the tank**, the water level is correct, proceed to Step 8.



If the water level matches the line in the bowl and the fill valve is **STILL FILLING**, then the bowl water level is **TOO HIGH**, proceed to Step 7D.



If the valve shuts off and the water level **does NOT match the line** in the bowl, the water level is **TOO LOW**, proceed to Step 7D.



D: ADJUST THE BOWL WATER LEVEL

TOO HIGH = Turn roller clamp with thumb to the next **LOWER** number.

TOO LOW = Turn roller clamp with thumb to next **HIGHER** number.



NOTE: "0" on roller clamp equals no refill to bowl.

E: FLUSH TOILET, CHECK BOWL WATER LEVEL

Repeat Steps 7D and 7E until water level in bowl matches the line when the fill valve shuts off.



STEP 8: FLUSH THE TOILET

A: FLUSH THE TOILET

If you're satisfied with the flush, **YOU'RE DONE!**



YOU DID IT!

We knew you could!

Share your success story
with friends and family!



#FixedMyToilet
#Fluidmaster

**Still not working exactly right?
See the next page for Troubleshooting.**

TROUBLESHOOTING

IF THE FILL VALVE:

- **DOES NOT TURN ON**
- **WON'T TURN OFF**
- **WON'T REFILL TANK**

REMOVE CAP AND CHECK FOR DEBRIS

- A:** Turn off water supply.
- B:** Flush toilet.
- C:** With right hand push float up, grip and hold shaft under float.
- D:** With left hand twist cap and lever arm counterclockwise to unlock cap. Let cap hang on float cup.
- E:** Hold empty cup upside down over uncapped valve to prevent splashing.
- F:** Turn water supply on and off a few times.
- G:** Turn water supply off.
- H:** Replace valve cap.
- Place cap assembly on top of gray valve body by aligning cap arm and adjustment rod next to refill tube.
 - Press down on top cap while rotating top & arm clockwise to locked position.



**See Our Troubleshooting
HOW-TO VIDEO**
<http://bit.ly/2yAdZn7>

IF THE FLOAT DOES NOT DROP WHEN FLUSHED

REPLACE FILL VALVE SEAL

- A:** Remove cap (see page 18).
- B:** Replace seal with a genuine Fluidmaster 242 Seal.
- C:** Replace valve cap.
- Place cap assembly on top of gray valve body by aligning cap arm and adjustment rod next to refill tube.
 - Press down on top cap while rotating top & arm clockwise to locked position.



IF THE FILL VALVE TURNS ON AND OFF BY ITSELF

CLEAN FLAPPER AND DRAIN SEAT

- A:** The tank is losing water, clean the flapper and drain seat for a better seal.
- B:** Replace flapper.
- C:** If leak continues after replacing flapper, replace flush valve (507AK, or 540AKR) or repair flush valve seat (555C).



IF WATER SUPPLY CONNECTOR IS LEAKING

- A:** Replace water supply line.

TROUBLESHOOTING

WATER LEVEL IN BOWL IS TOO LOW

A: WATER FROM REFILL TUBE MUST FLOW THROUGH OVERFLOW PIPE

Make sure the refill tube is supplying water down overflow pipe.

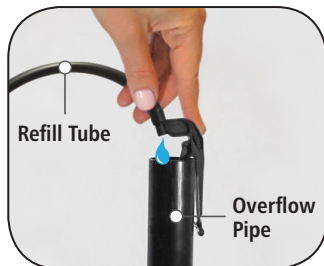

B: WATER LEVEL IN TANK MAY BE TOO LOW

1/2" below top of overflow pipe is recommended (see page 12).

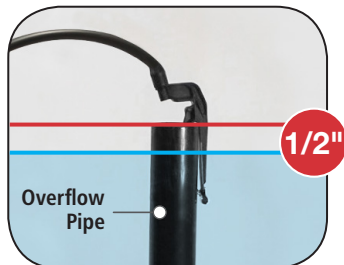

C: Roller clamp may need to be adjusted

(see page 14).

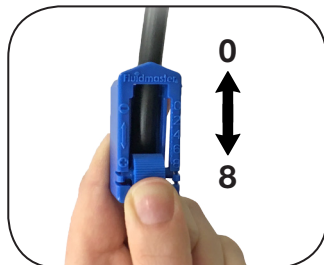

D: FLAPPER MAY BE CLOSING TOO SOON

Give flapper chain approximately 1/2" of slack.

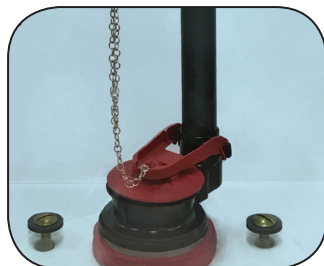



ADDITIONAL QUESTIONS?

For installation assistance, contact our technical services department. Email, chat or call our toll-free number.

www.fluidmaster.com/support

1-800-631-2011

Hours Available:

Monday – Friday

5:30 AM - 5:00 PM PST

 **WARNING**

DO NOT USE IN-TANK DROP-IN TOILET BOWL CLEANERS CONTAINING BLEACH OR CHLORINE. Use of such products will: (1) RESULT IN DAMAGE to tank components and MAY CAUSE FLOODING and PROPERTY DAMAGE and (2) VOID FLUIDMASTER WARRANTY. Fluidmaster Flush 'n Sparkle Toilet Bowl Cleaning System is recommended for those choosing to use in-tank bowl cleaners and WILL NOT VOID the FLUIDMASTER WARRANTY because it will not damage the components. DO NOT overtighten nuts or tank/bowl may crack. Always use quality Fluidmaster parts when installing or repairing. Fluidmaster will not be responsible or liable for use of non-Fluidmaster parts during installation or repair.

LIMITED SEVEN-YEAR EXPRESS WARRANTY

Subject to the "Exclusions" set forth below, Fluidmaster Inc. promises to the consumer to repair, or at the option of Fluidmaster Inc. to replace any part of this plumbing product which proves to be defective in workmanship or materials under normal use for seven years from the date of purchase. All costs of removal, transportation and reinstallation to obtain warranty service shall be paid by the consumer. During this "Limited Seven Year Express Warranty," Fluidmaster Inc. will provide, subject to the "Exclusions" section set forth below, all replacement parts free of charge, necessary to correct such defects. This "Limited Seven Year Warranty" is null and void if this plumbing product has not been installed and maintained in accordance with all written instructions accompanying the product, and if non-Fluidmaster Inc. parts are used in installation.

EXCLUSIONS: FLUIDMASTER INC. SHALL NOT BE LIABLE FOR INCIDENTAL OR CONSEQUENTIAL DAMAGES, INCLUDING COSTS OF INSTALLATION, WATER DAMAGE, PERSONAL INJURY OR FOR ANY DAMAGES RESULTING FROM ABUSE OR MISUSE OF THE PRODUCT, FROM OVERTIGHTENING OR FROM FAILURE TO INSTALL OR MAINTAIN THIS PLUMBING PRODUCT IN ACCORDANCE WITH THE WRITTEN INSTRUCTIONS, INCLUDING USE OF NON-FLUIDMASTER PARTS. DO NOT USE IN-TANK DROP-IN TOILET BOWL CLEANERS CONTAINING BLEACH OR CHLORINE. USE OF SUCH PRODUCTS WILL RESULT IN DAMAGE TO TANK COMPONENTS AND MAY CAUSE FLOODING AND PROPERTY DAMAGE. USE OF SUCH PRODUCTS WILL VOID THIS WARRANTY.



30800 Rancho Viejo Road, San Juan Capistrano, CA 92675

www.Fluidmaster.com • 800-631-2011

Contact Fluidmaster for troubleshooting help or visit www.Fluidmaster.com

M-F 5:30 am - 5:00 pm PST.

FM # 91624, Rev. 3, 11/17