

Digital Ceramic Heater

With Remote Control



Owner's Manual

English

Model
HPQ15C-EA

SINCE 1886
Hunter

TABLE OF CONTENTS

Introduction.....	3
Safety and Warnings.....	3
Important Instructions.....	3
Parts of the Heater.....	5
Operating Instructions.....	5
Tip-over Switch.....	7
Thermal Protection System.....	7
Maintenance.....	8
Storage.....	8
Trouble Shooting.....	8
Technical Support.....	8
FCC Warning.....	9
Warranty.....	9

INTRODUCTION

Thank you for choosing the Hunter Ceramic Heater. This manual gives you complete instructions for using your heater.

SAFETY AND WARNINGS

READ CAREFULLY BEFORE ATTEMPTING TO ASSEMBLE, INSTALL, OPERATE OR MAINTAIN THE PRODUCT DESCRIBED. PROTECT YOURSELF AND OTHERS BY OBSERVING ALL SAFETY INFORMATION. FAILURE TO COMPLY WITH INSTRUCTIONS COULD RESULT IN PERSONAL INJURY AND/OR PROPERTY DAMAGE!
SAVE THESE INSTRUCTIONS FOR REFERENCE.

NOTE: When switching on the appliance for the first time, allow it to run at full power for approximately two hours to get rid of the unpleasant odour. Make sure that the room in which the appliance is located is well ventilated during this operation. It is normal for the appliance to emit small cracking sounds when you turn it on the first time. Do not be alarmed.

IMPORTANT INSTRUCTIONS

When using electrical appliances, basic precautions should always be followed to reduce the risk of fire, electric shock, and injury to persons or property, including the following:

1. Read all instructions before using this heater.
2. This heater is hot when in use. To avoid burns, do not let bare skin touch hot surfaces. Use handles when moving this heater. Keep combustible materials, such as furniture, pillows, bedding, papers, clothes and curtains at least 3' (0.9 m) from the front and top of the heater and keep them away from the sides and rear. Keep the rear grille away from walls or drapes so as not to block the air intake.
3. Extreme caution and supervision is necessary when any heater is used by or near children or pets, and whenever the heater is left operating and unattended.
4. Always unplug heater when not in use.
5. Do not operate heater with a damaged cord or plug or after the heater malfunctions, or has been dropped or damaged in any manner. Discard heater or return to an authorized service facility for examination and/or repair.
6. Do not use outdoors.
7. This heater is not intended for use in bathrooms, laundry areas and similar indoor locations. Never locate heater where it may fall into a bathtub or other water container.
8. Do not run cord under carpeting. Do not cover cord with throw rugs, runners, or similar coverings. Do not route cord under furniture or appliances. Arrange cord away from traffic area and where it will not be tripped over.
9. To disconnect the heater, turn control to OFF, then remove the plug from the outlet.
10. Do not insert or allow foreign objects to enter any ventilation or exhaust opening as this may cause an electric shock or fire, or damage to the heater.



11. To prevent a possible fire, do not block air intakes or exhaust in any manner. Do not use on soft surfaces, like a bed, where openings may become blocked.

12. A heater has hot and arcing or sparking parts inside. Do not use it in areas where gasoline, paint, or flammable liquids are used or stored.

13. Use this heater only as described in this manual. Any other use not recommended by the manufacturer may cause fire, electric shock, injury to persons, or other damage to property.

14. Ensure the heater is on a stable, secure surface to eliminate the potential of tipping it over.

15. To prevent overload and blown fuses, be sure that no other appliance is plugged into the same outlet (receptacle) or into another outlet (receptacle) wired into the same circuit.

16. It is normal for the heater's plug and cord to feel warm to the touch. A plug or cord which becomes hot to the touch or becomes distorted in shape may be a result of a worn electrical outlet. Worn outlets or receptacles should be replaced prior to further use of the heater. Plugging heater into a worn outlet/receptacle may result in overheating of the power cord or fire.

17. Always plug heaters directly into a wall outlet/receptacle. Never use with an extension cord or relocatable power tap (outlet/power strip).

18. Check your heater cord and plug connections. A loose fitting outlet can cause the plug to overheat or cause a fire. Be sure plug fits tight in the outlet. Check frequently during use to make sure plug and outlet are not hot. If so, discontinue using heater and have outlet replaced by a qualified electrician.

19. Note: Heaters draw more current than small appliances, overheating of the outlet may occur even if it has not occurred with the other appliances.

20. Check that neither the appliance nor the power cable has been damaged in any way during transportation.

21. Make sure that no pieces of polystyrene or other packaging material have been left between elements of the appliance. It may be necessary to clean the appliance.

22. Connect to properly polarized outlets only.

23. This appliance has a polarized plug (one blade is wider than the other). To reduce the risk of electric shock, this plug is intended to fit in a polarized outlet only one way. If the plug does not fit fully in the outlet, reverse the plug. If it still does not fit, contact a qualified electrician. Do not attempt to defeat this safety feature.

CAUTION: TO PREVENT ELECTRIC SHOCK, MATCH WIDE BLADE OF PLUG TO WIDE SLOT, FULLY INSERT.

DANGER-HIGH TEMPERATURES MAY BE GENERATED UNDER CERTAIN ABNORMAL CONDITION. DO NOT PARTIALLY OR FULLY COVER OR OBSTRUCT THE FRONT OF THIS HEATER.

**FOR HOUSEHOLD USE ONLY
SAVE THESE INSTRUCTIONS**



PARTS OF THE HEATER

Parts of the Heater

1. Control Panel
2. LED Display
3. Safety Grille
4. Base
5. Remote Control
6. Power Light

(Figure 1)

Symbols

- ⏻ Power Button
- ⏪ H/L Heat Button
- ⏩ Oscillation Button
- ⊕ High Temperature Setting Button
- ⊖ Low Temperature Setting Button
- ⌚ Timer Button

(Figure 2)

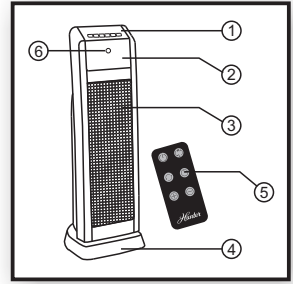

Figure 1

OPERATING INSTRUCTIONS

Operation

1. Place the heater on a firm, level surface, after assembling per this manual. Plastic or rubber tabs, like the feet on this unit, may stick to furniture surfaces and/or hardwood floors. The unit may leave a residue that could darken, stain or leave permanent blemishes on the finish of certain furniture surfaces, including wood surfaces, and/or hardwood floors.

2. Plug the cord set into a 120 volt AC outlet. **Be sure that the plug fits tightly into outlet.** When plugs fit loosely into receptacles, they may slip partially or completely out of the receptacle with only the slight movement of the attached cord. Receptacles in this condition may overheat and pose a serious fire hazard; if covered by a curtain or drape, the fire hazard is even greater.

3. When the heater is initially plugged in, there will be a "beep" and the **Power Light** will come on indicating that there is power to the unit. The **Power Light** will remain lit until the heater is unplugged from the electrical outlet. (Figure 2)

4. Turn the heater ON by pressing the **Power Button** ⏻ .

5. Press the ⊕ and ⊖ buttons at the same time for two seconds to change the display to show the temperature reading in Celsius. Press the same two buttons together again to change the display back to show the temperature reading in Fahrenheit.

6. Upon turning the heater on, the unit will be in HIGH heat.

7. Press the ⏪ button to switch over LOW or HIGH heat.

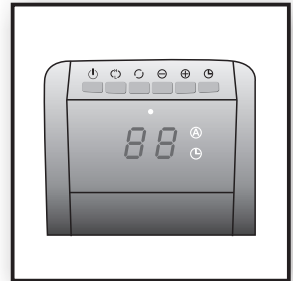







Figure 2

8. To turn the heater OFF, press the **Power Button**  . The unit will first turn off the heating elements, the fan will be shut down a few minute later. Unplug the unit by pulling the plug from the electrical outlet only after the fan stopped.

Oscillation



Pressing the **Oscillation Button**  will allow the heater to oscillate back and forth. To stop the oscillation, press the **Oscillation Button**  again. When the heater is in Automatic Temperature Control, the oscillation function will stop when the set temperature is reached and resume when the heater turns back on.

Timer Function (Figure 3)

The timer function may be activated when the heater display is in any function. This function allows you to set the length of time the heater will run before turning itself off, from 1 hour to 8 hours. Pressing the **Timer Button**  will increase the length of time by 1 hour each time this button is pressed. After the display reflects 8 hours, pressing the **Timer Button**  once more will reset the heater to run continuously. The heater will turn off when the set time has elapsed. The unit can be turned back on by pressing the **Power Button**  .

Automatic Temperature Control (Figure 4) (Figure 5)

The automatic temperature function will only operate on HIGH heat. You cannot set the temperature automatically when the unit is in the LOW heat mode.

1. To set the room at a specific temperature, press the  or  buttons to the desired temperature. The heater is now in Auto Temperature Mode and the  indicator will glow on the **LED display**.

2. When the display shows the temperature at which you want to set the unit, the set temperature will flash several times and then the display will return to indicate the current room temperature and will gradually change as the room temperature changes.

NOTE: The temperature display does not indicate the temperature of the heated air being emitted by the heater.

3. Once the room temperature reaches 2 degrees above the set temperature, the heater will shut off. Once the room temperature reaches 2 degrees below the set temperature, the heater will turn back on and continue to cycle off and on to maintain the set temperature.

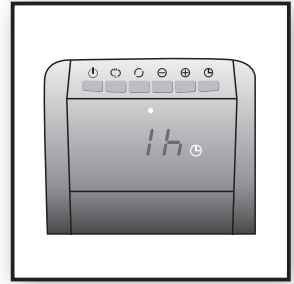

Figure 3



Figure 4

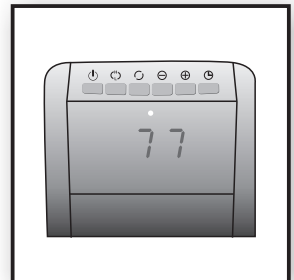
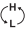

Figure 5

4. This function will cancel if the  button is pressed. The heater will now be in HIGH heat and run continuously.

NOTE: It is normal for the heater "fan" to run for approximately 30 seconds when the heater shuts off after reaching the set temperature.

Remote Control (Figure 6)

1. The remote control uses two (2) "AAA" batteries (not included) for operation.

2. All the functions performed using the Remote Control work identically to the Manual Controls.

Note: Change the batteries with new and same types if the remote control does not operate well. Otherwise your remote control may not operate properly. Remove the batteries out of the remote control if you won't use the remote control for a long time. Remaining batteries may damage your remote control.

Note: Do not mix old and new batteries. Do not mix alkaline, standard (carbon-zinc), or rechargeable (nickel-cadmium) batteries.

Battery Disposal - Please dispose of the used battery per municipal or provincial law.



Figure 6

TIP-OVER SWITCH

This heater is equipped with a safety tip-over switch, which is located on the bottom of the heater. This feature cuts the main power to the heater if it gets knocked over. If the heater does tip over, simply stand it upright in order to resume operation.

THERMAL PROTECTION SYSTEM

This heater includes an Overheat Protection System that shuts the unit off when a potential overheat temperature is reached. If this occurs, the heater can only resume its normal operation after resetting it. To reset the heater:

1. Unplug the heater and wait 10 minutes for the unit to cool down.
2. After the 10 minutes, plug the unit in again and operate normally.

MAINTENANCE

1. Press the Power Button  to turn the heater OFF and unplug the heater before moving or cleaning.
2. Interior dust can often be removed by using a vacuum cleaner with a crevice tool attachment.
3. To clean the enclosure, use a clean, soft and lightly damp cloth to gently wipe off the dirt from the surface of the unit. Be sure not to wet the Heating Element and the switches. Allow the unit to dry completely before use.
4. Do not use cleaning liquid or other chemicals to spray on the unit.

STORAGE

1. Perform the cleaning procedures described above.
2. Wipe all parts dry.
3. Pack the heater in a plastic bag and store it in a cool, dry place. We recommend that you store the heater in its original carton.

TROUBLE SHOOTING

If your heater fails to operate:

- Make sure the electrical outlet or circuit breaker is working.
- Check for obstructions. If you find an obstruction, turn the heater OFF, and UNPLUG THE UNIT. Carefully remove the obstruction and follow the reset instructions.

TECHNICAL SUPPORT

If you have any additional questions or problems with your Hunter Heater, please call:

USA: 1-888-880-3267

Hours of operation are from 8:00 am to 5:00 pm Monday to Friday, Eastern Time. You may also reach us online at www.HunterHomeComfort.com.

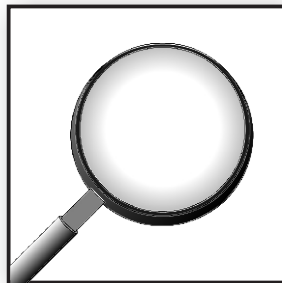
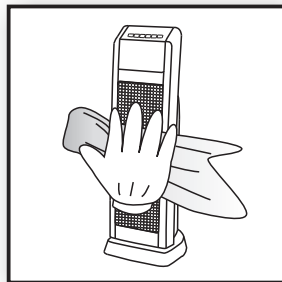

FCC WARNING

FCC WARNING:

Changes or modifications to this unit not expressly approved by the party responsible for compliance could void the user's authority to operate the equipment.

NOTE :

This equipment has been tested and found to comply with the limits for a Class B digital device, pursuant to Part 15 of the FCC Rules. These limits are designed to provide reasonable protection against harmful interference in a residential installation. This equipment generates, uses and can radiate radio frequency energy and, if not installed and used in accordance with the instructions, may cause harmful interference to radio communications.

However, there is no guarantee that interference will not occur in a particular installation. If this equipment does cause harmful interference to radio or television reception, which can be determined by turning the equipment off and on, the user is encouraged to try to correct the interference by one or more of the following measures:

- Reorient or relocate the receiving antenna.
- Increase the separation between the equipment and receiver.
- Connect the equipment into an outlet on a circuit different from that to which the receiver is connected.
- Consult the dealer or an experienced radio/TV technician for help

WARRANTY

Hunter Home Comfort makes the following limited warranty to the user or consumer purchaser of this Hunter heater:

If your Hunter heater motor fails at any time within three years after the date of sale to you due to a defect in material or workmanship, labor to repair the defect will be provided free of charge at our nearest service center or our Service Department in Marietta, Georgia. You will be responsible for labor costs after this three years period. The foregoing limited warranty applies only to the motor itself, and does not apply to electronic controls such as remote controls, remote control receivers or transmitters used in conjunction with the motor. These electronic control items are included in the one year limited warranty below.

If any part of your Hunter heater other than the motor fails at any time within one year after the date of sale to you due to a defect in material or workmanship, we will repair or, at our option, replace the defective part free of charge for parts and labor performed at our nearest service center or at our Service Department in Marietta, Georgia.

IF THE USER OR CONSUMER PURCHASER CEASES TO OWN THE HEATER, THIS WARRANTY AND ANY IMPLIED WARRANTY WHICH THEN REMAINS IN EFFECT, INCLUDING BUT NOT LIMITED TO ANY IMPLIED WARRANTY OF MERCHANTABILITY OR FITNESS FOR A PARTICULAR PURPOSE, ARE VOIDED. NO WARRANTY, EXPRESSED OR



IMPLIED, INCLUDING ANY WARRANTY OF MERCHANTABILITY OR FITNESS FOR A PARTICULAR PURPOSE, IS MADE IN RESPECT TO THE GLASS GLOBES OR LIGHT BULBS OR THE FINISH ON ANY METAL PORTION OF THE HEATER. THIS WARRANTY IS IN LIEU OF ALL OTHER EXPRESS WARRANTIES. THE DURATION OF ANY IMPLIED WARRANTY, INCLUDING, BUT NOT LIMITED TO ANY IMPLIED WARRANTY OF MERCHANTABILITY OR FITNESS FOR A PARTICULAR PURPOSE, IN RESPECT TO ANY HUNTER HEATER MOTOR OR OTHER HEATER PART, IS EXPRESSLY LIMITED TO THE PERIOD OF THE EXPRESS WARRANTY SET FORTH ABOVE FOR SUCH MOTORS AND OTHER PARTS.

This warranty is voided if your Hunter heater is not purchased and used in the USA.

This warranty excludes and does not cover defects, malfunctions or failures of any Hunter heater which were caused by repairs by persons not authorized by us, use of parts or accessories not authorized by us, mishandling, improper installation, modifications, or damage to the Hunter heater while in your possession, or unreasonable use, including failure to provide reasonable and necessary maintenance.

To obtain servicing, contact the nearest Hunter authorized service center or the Hunter Home Comfort Service Department, 2260 Northwest Pkwy., Suite I, Marietta, Georgia 30067. Please contact us before shipping your heater to us. If we authorize you to ship it to us, you will be responsible for all insurance and freight or other transportation charges to our factory service center. We will return your Hunter heater freight prepaid. Your heater should be properly packed to avoid damage in transit since we will not be responsible for any such damage. Proof of purchase is required when requesting warranty service. The purchaser must present sales receipt or other document that establishes proof of purchase.

IN NO EVENT SHALL HUNTER HOME COMFORT BE LIABLE FOR CONSEQUENTIAL OR INCIDENTAL DAMAGES.

SOME STATES DO NOT ALLOW LIMITATIONS ON HOW LONG AN IMPLIED WARRANTY LASTS OR THE EXCLUSION OR LIMITATION OF INCIDENTAL OR CONSEQUENTIAL DAMAGES SO THE ABOVE LIMITATION MAY NOT APPLY TO YOU.

THIS WARRANTY GIVES YOU SPECIFIC LEGAL RIGHTS AND YOU MAY ALSO HAVE OTHER RIGHTS WHICH VARY FROM STATE TO STATE.

Hunter
SINCE 1886

2260 Northwest Pkwy., Suite I, Marietta, GA 30067

Hunter is a trademark of the Hunter Fan Company and is used under license to Hunter Home Comfort.

Printed in China

