

Tools & Supplies



Measuring Tape



Hack Saw

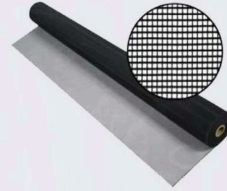

Screen



Rollerknife

How to Build & Install

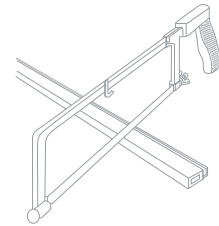
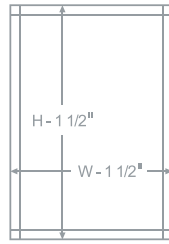
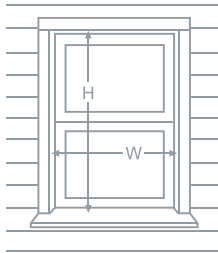

1 Measure

Measure the height & width of the window opening where the frame will be installed.

2 Mark

Mark Aluminum frames to height (H-1 1/2") & width (W-1 1/2") Each corner adds 3/4".

3 Cut

Cut marked pieces with hacksaw. If your frame exceeds 3 feet in height, cut an additional (W-1 1/2") for use as a cross brace.

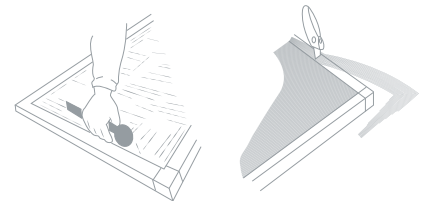
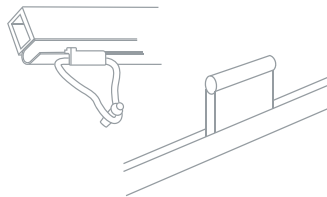
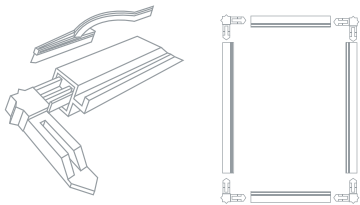

4 Assemble

Insert corners into frames using the screen frame fastener vertical pieces first, then attach each vertical piece to the horizontals.

5 Install Hardware

Place pull tabs as desired and install any other additional hardware such as a plunger bolt or loop and latch.

6 Roll Screen & Trim

Roll Screen into spline groove with .160 spline. Spline will hold in hardware. Trim excess screen with Utility knife or blade from Rollerknife.

Access Videos & Resources at ScreenTight.com