

Step 1 – Find the “Nightingale Sound” app on the iOS app store

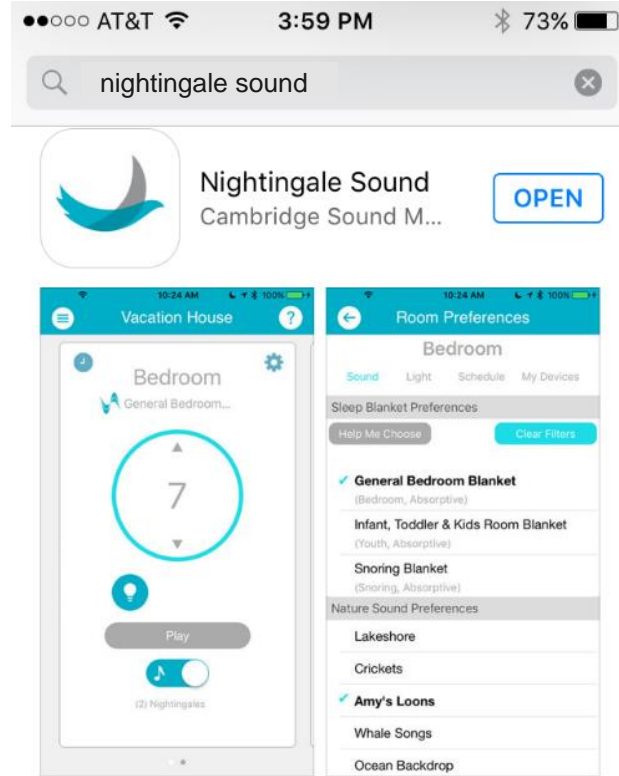

Step 2 – Your phone will find your Nightingale devices (assuming Bluetooth is on)

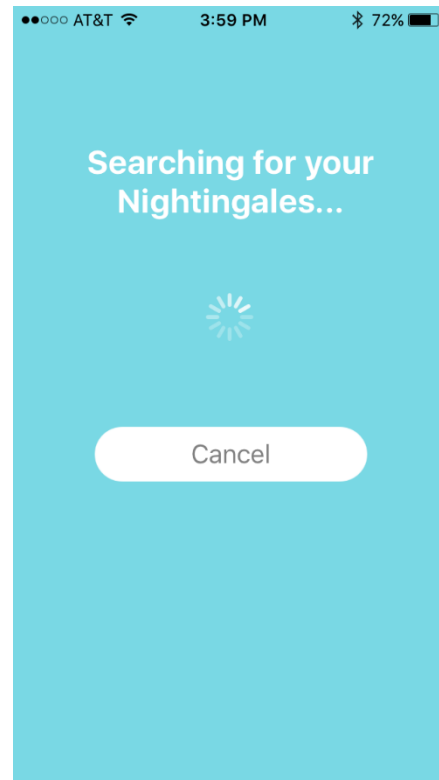
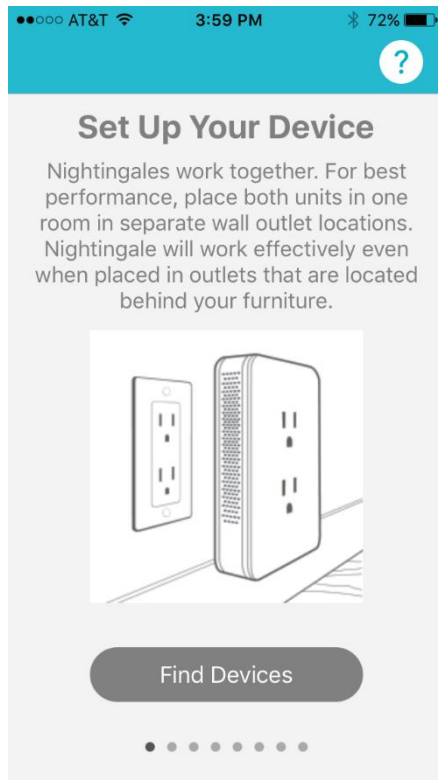

Step 3 – Push on the “Play” icon to test the audio

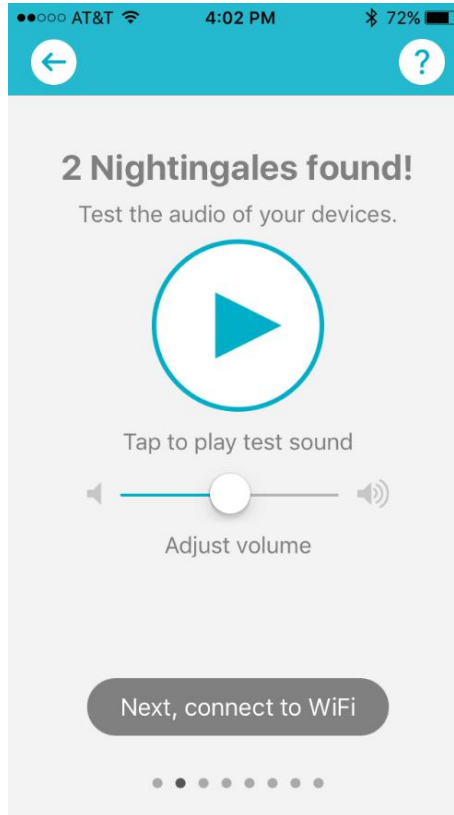

Step 4 – Find Wi-Fi network that you have access for

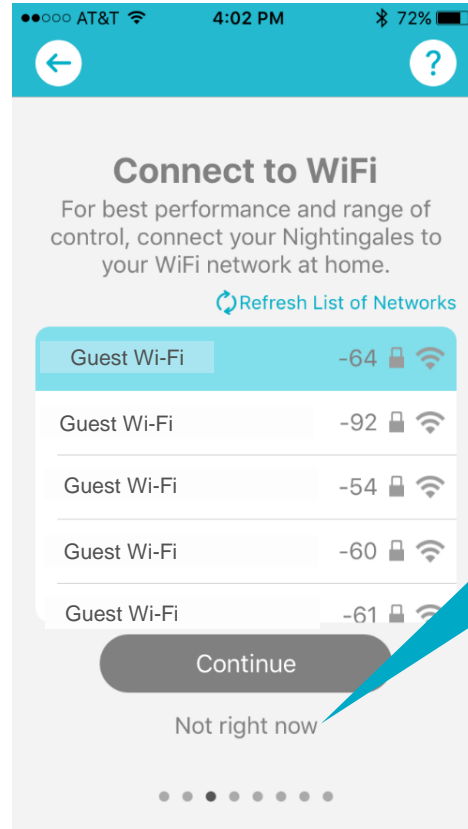

“Not right now” command will put you onto local control via Bluetooth connection

Step 5 – Enter Wi-Fi password and hit “OK”

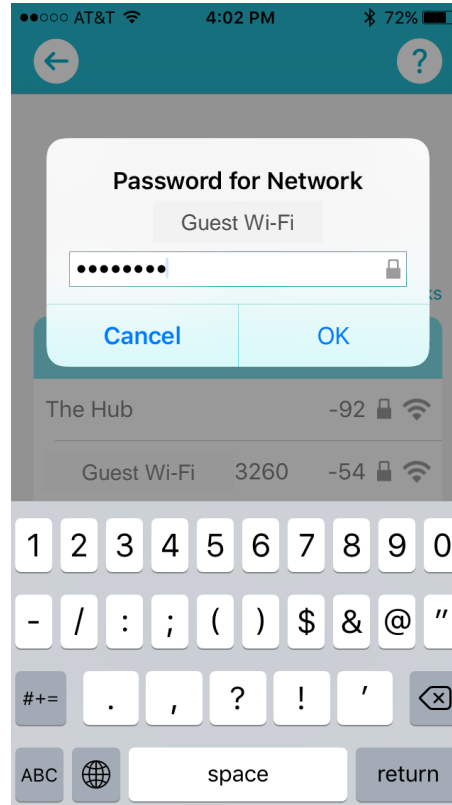

If you have already set up your account before and are just adding more rooms, you can skip to Step 9 to set up the room

Step 6 Create account with name, email and password

●●○○ AT&T 4:05 PM 71%

← ?

Create Account

Create an account to securely operate your Nightingales from anywhere!

Jane

Doe

United States

[Already have an account?](#)

Continue

● ● ● ● ● ● ●

●●○○ AT&T 4:05 PM 71%

← ?

Create Account Continued

Create an account to securely operate your Nightingales from anywhere!

janedoe@gmail.com

●●●●●●●●

Case sensitive and must contain at least one number.

Show password

Create Account

● ● ● ● ● ● ●

●●○○ AT&T 4:05 PM 71%

← ?

Confirm Account

A confirmation email has been sent to:

janedoe@gmail.com

Open the email on your phone and follow the link to complete your account registration.

Once you've confirmed your account, let's set up your room!

Resend Confirmation Email

● ● ● ● ● ● ●

Step 7 - Confirm email on the device that you use for setup

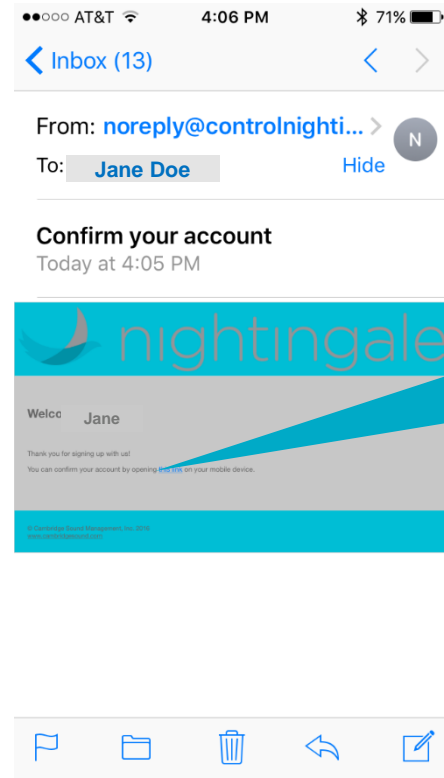
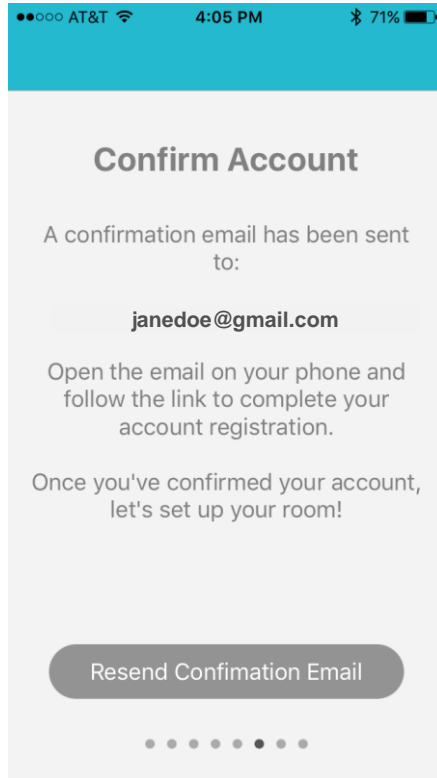

Click on blue highlighted link in the email to confirm

Step 8 - Click on "Open" to open the app on your phone

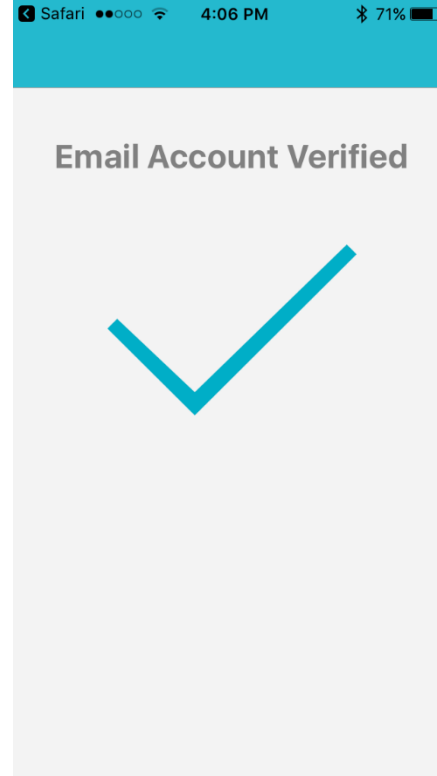
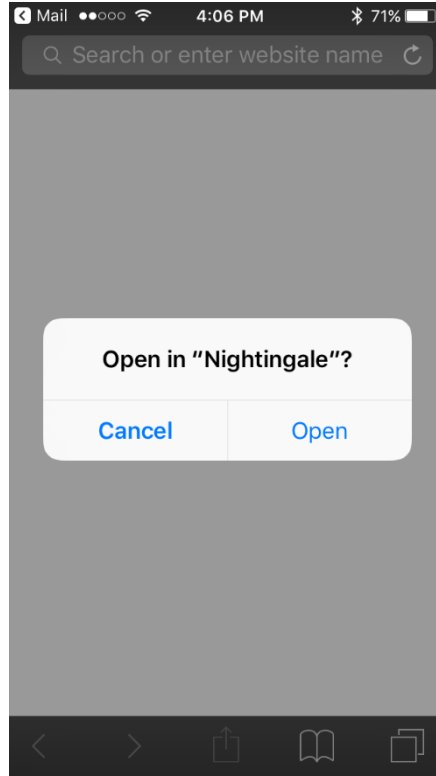

Step 9 – Set up room, by naming the dwelling you are in (e.g. “home”)

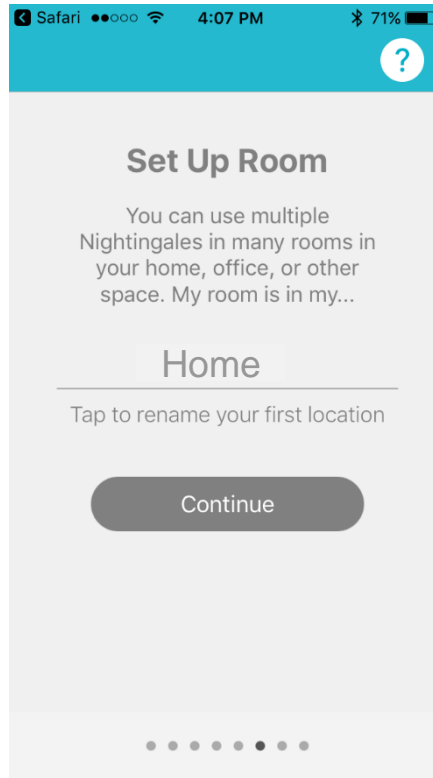

Step 10 – Select the bedroom type and the acoustic material type of the room (absorptive, reflective, or neutral)

The screenshot shows a mobile application interface for setting up a room. At the top, there is a teal header with a back arrow on the left and a question mark on the right. Below the header, the title "Finish Setting Up Room" is displayed in bold. The main text reads: "We can help you select a sleep blanket perfectly suited to your space. Tell us". Below this, it says "This Nightingale system is going to be used in" followed by a dropdown menu currently showing "Adult Bedroom". Underneath, it says "This room is" followed by another dropdown menu currently showing "Absorptive". At the bottom of the form is a dark grey rounded button labeled "Continue". At the very bottom of the screen, there is a progress indicator consisting of seven dots, with the fifth dot from the left being filled, indicating the current step in the process.

Step 11 – Select any sleeping conditions (i.e. snoring, tinnitus) if applicable. If not relevant, select “None”

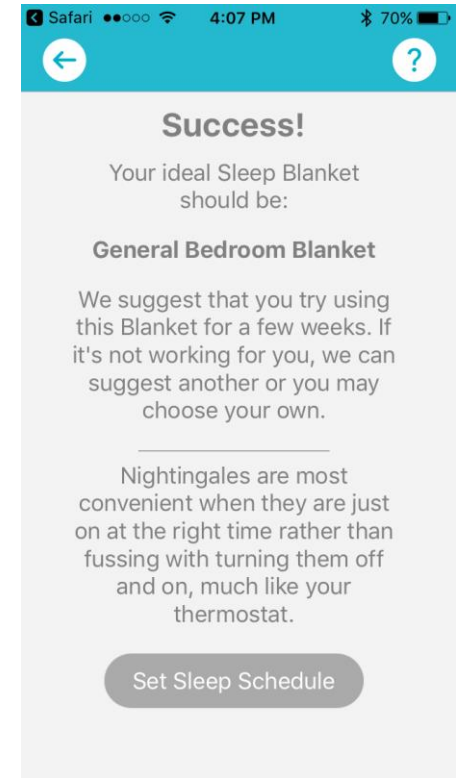
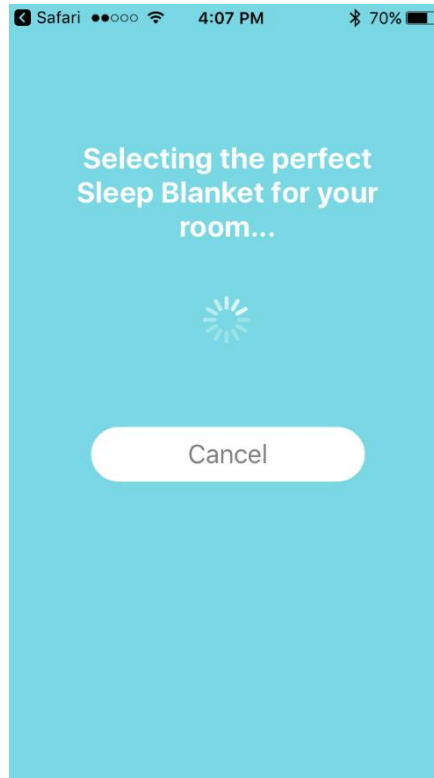
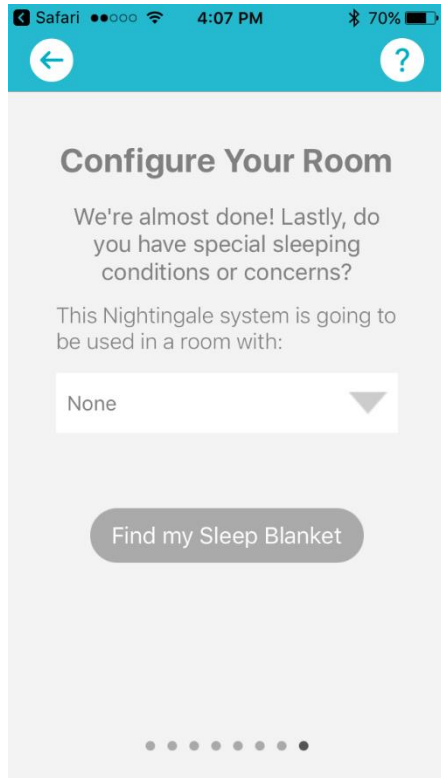

Step 12 - Schedule Nightingale to start “sleep time” and stop “wake time” (only over Wi-Fi)

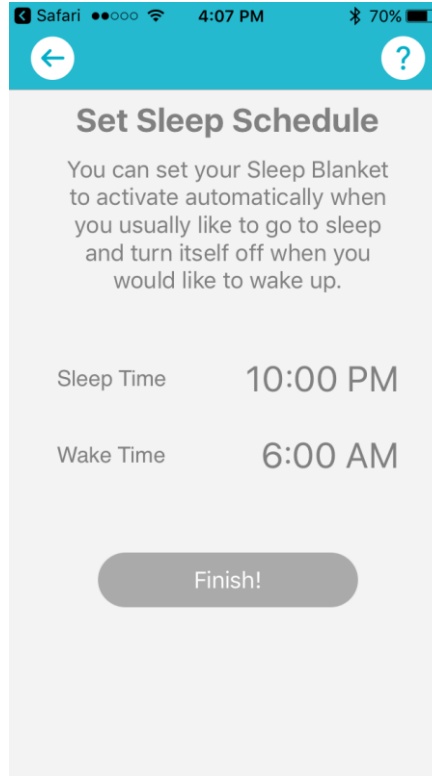

Step 13 – Adjust the volume by using the up and down arrows

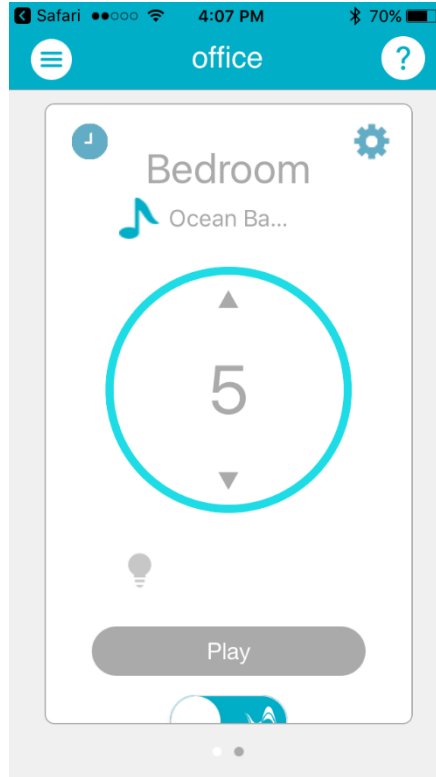

Step 14 – Use “gear” icon to access balance, sound, and light control

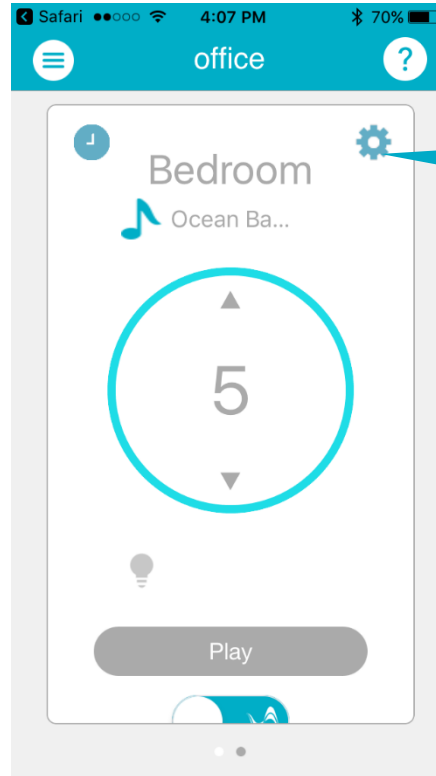

Gear for advanced control options

Step 15 – Adjust balance, if the Nightingale units aren't equidistant from you as you sleep

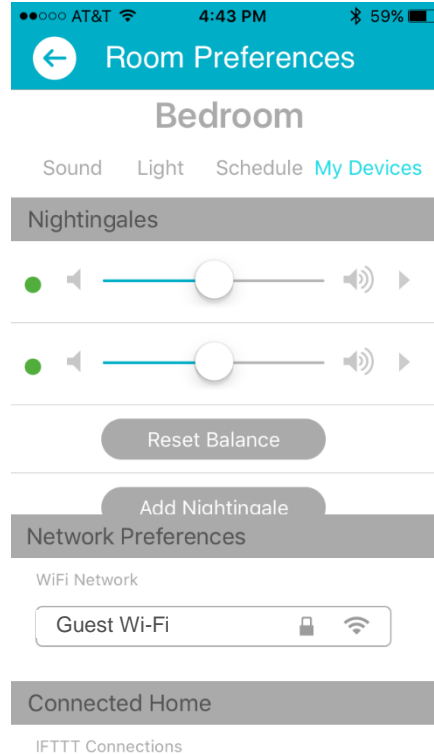

Step 16 – Set blankets or nature sounds

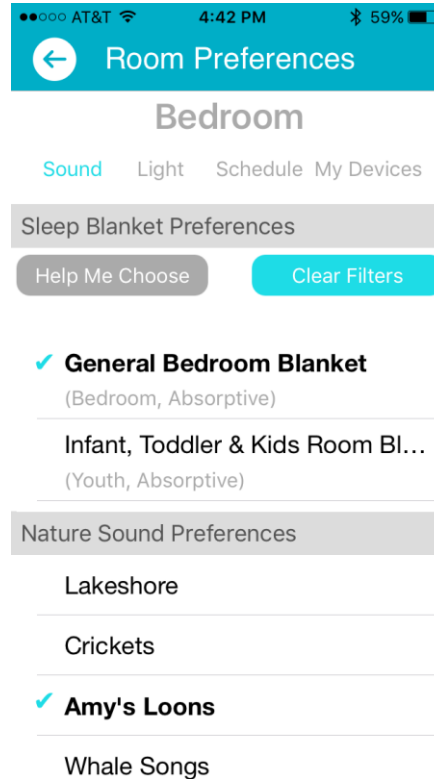

To select a blanket, press 'Help Me Choose' or find the scroll bar on the right, which reveals all 15 options.

Step 17 – Choose different nightlight colors or intensity

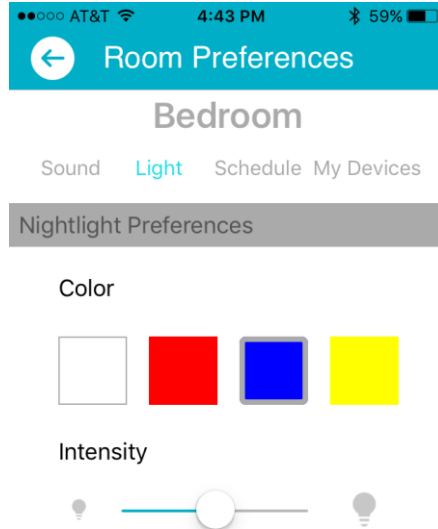

Step 18 – Schedule sounds or nightlight (via Wi-Fi)

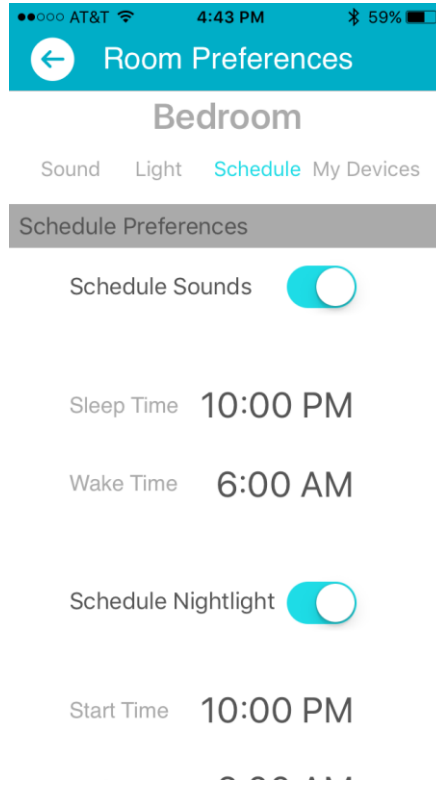

The sleep schedule currently defaults to 'on'. To turn it 'off', use this screen.

Adding units to existing dwelling

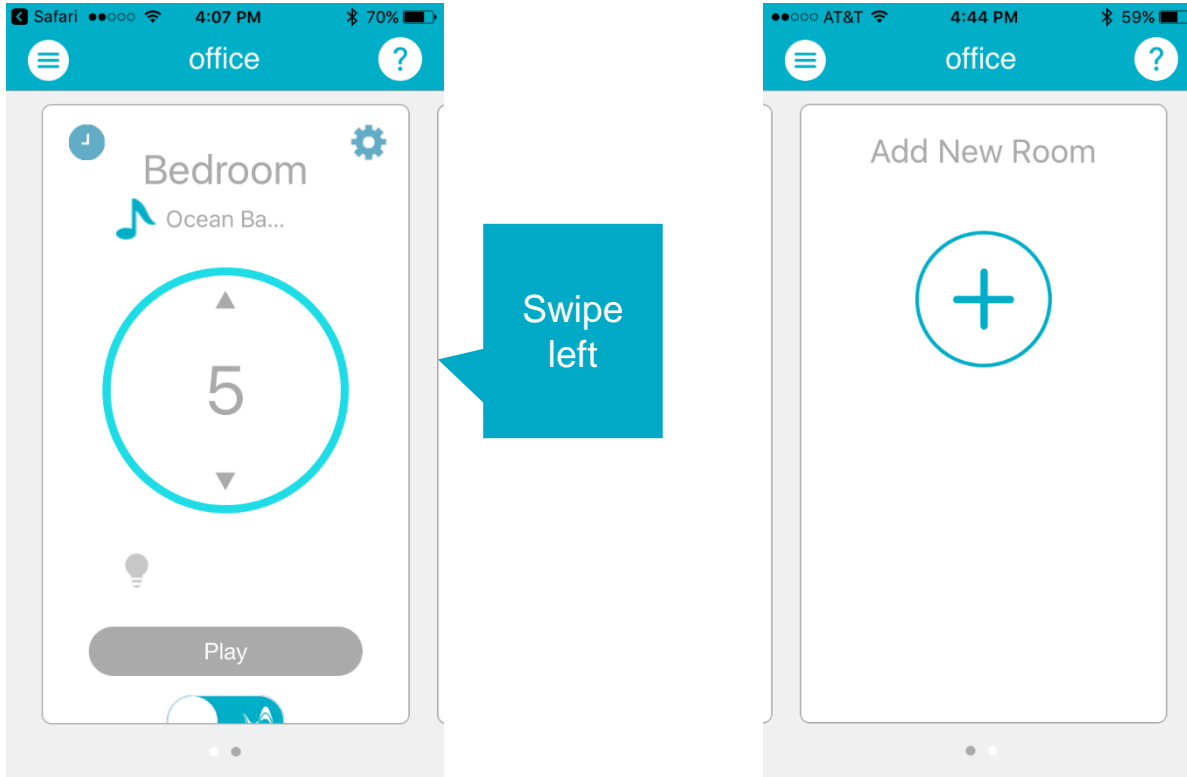

Adding new dwelling

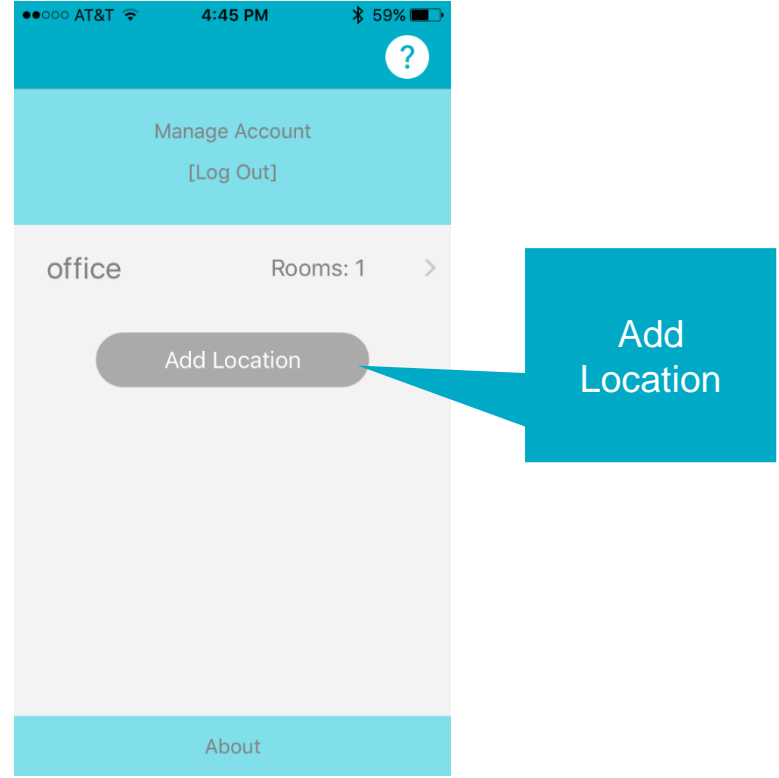
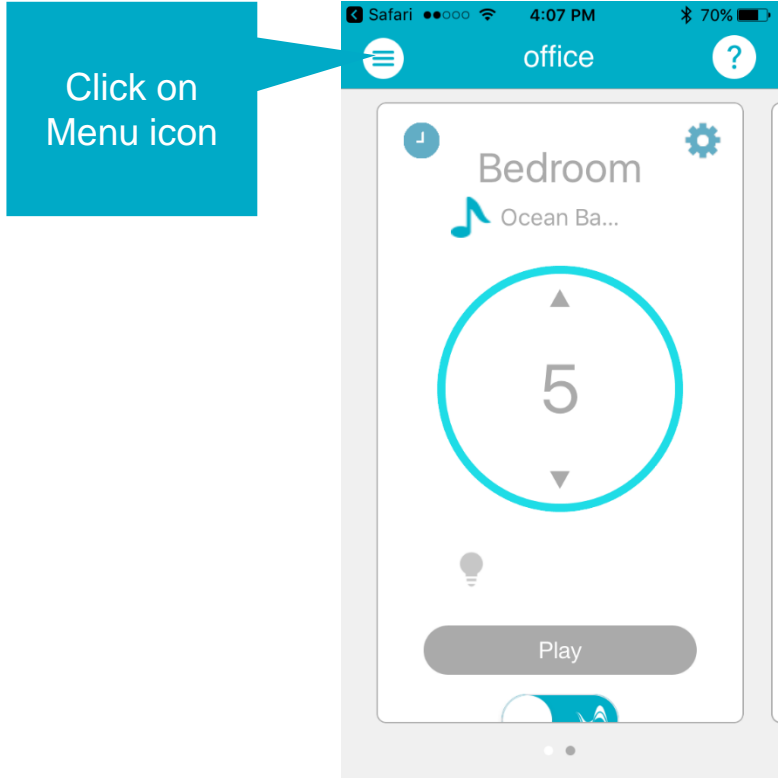

Deleting units – Deleting units in a room when a dwelling (e.g. house) has multiple units

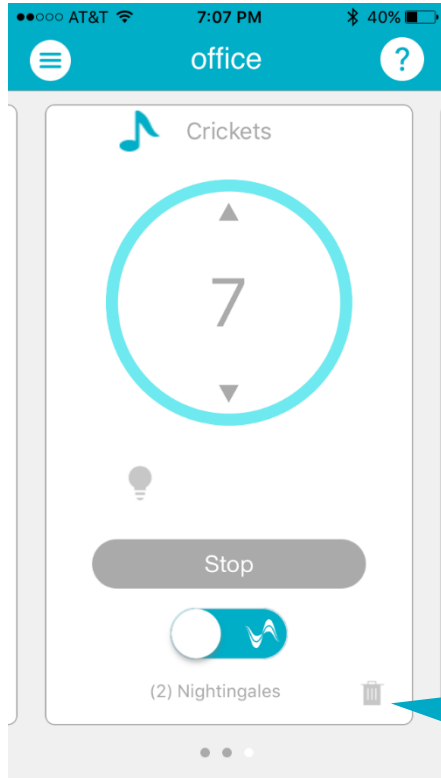

Click to delete room

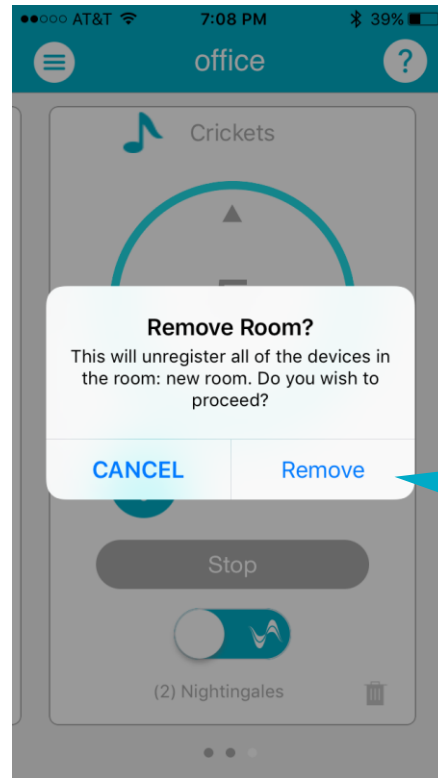

Note, this only deletes a room within a dwelling (location), not the dwelling setting itself

Confirm deletion

Deleting units – Deleting dwelling with one room – Steps 1 & 2

Click on Menu icon

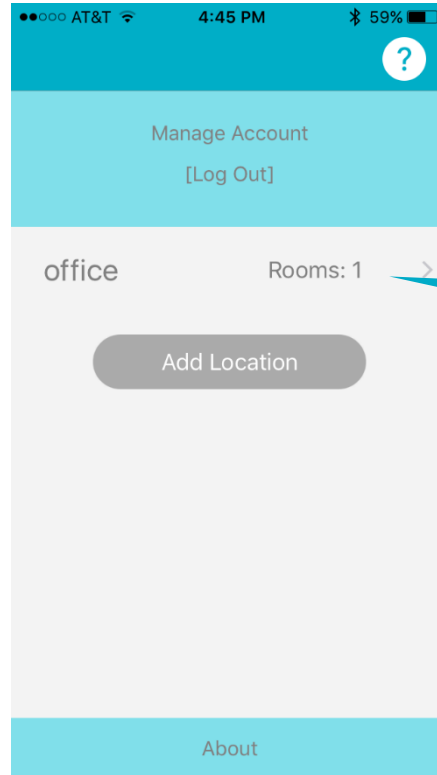
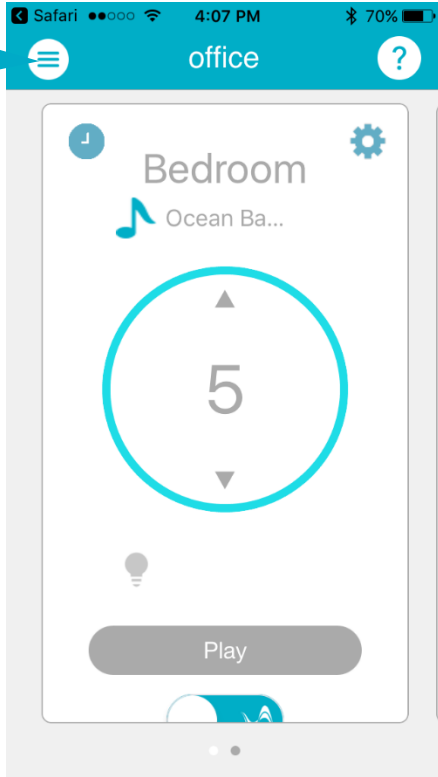

Swipe left on the line with "Rooms"

Deleting units – Deleting dwelling with one room – Steps 3 & 4

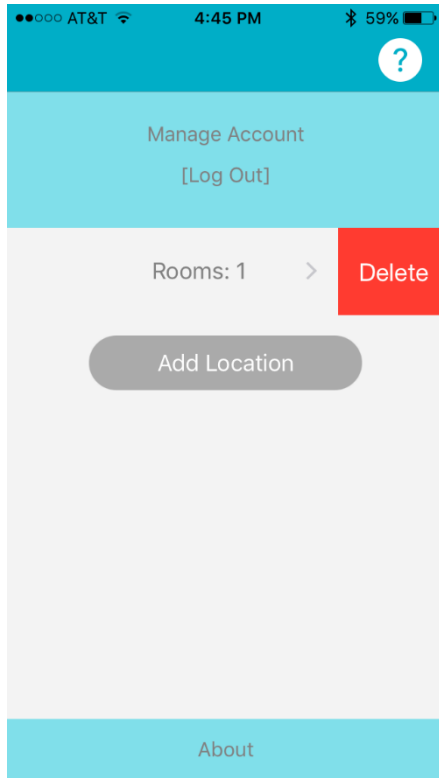

Click
"Delete"

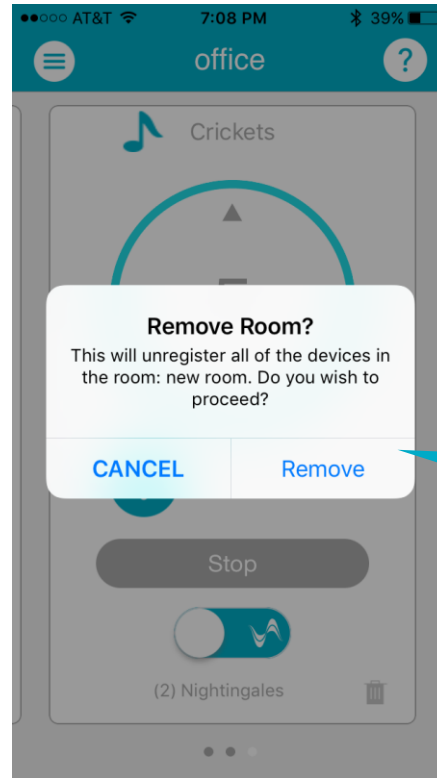

Confirm
"Delete"

Web app login – controlnightingale.com

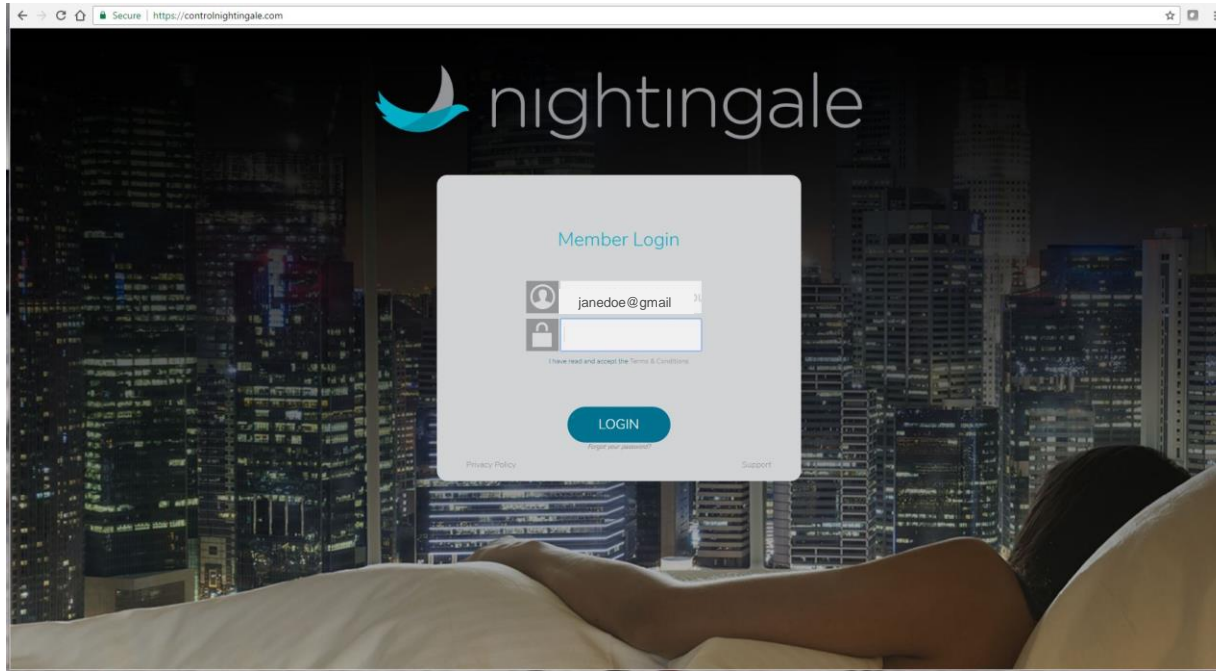

Must set up an account on an iPhone 4S or higher generation phone first.

Once account is set up, use your account login information to login onto controlnightingale.com on a web browser (e.g. Chrome)

This is a way you can control Nightingale on an iPad and other browser enabled devices.

Web app home page

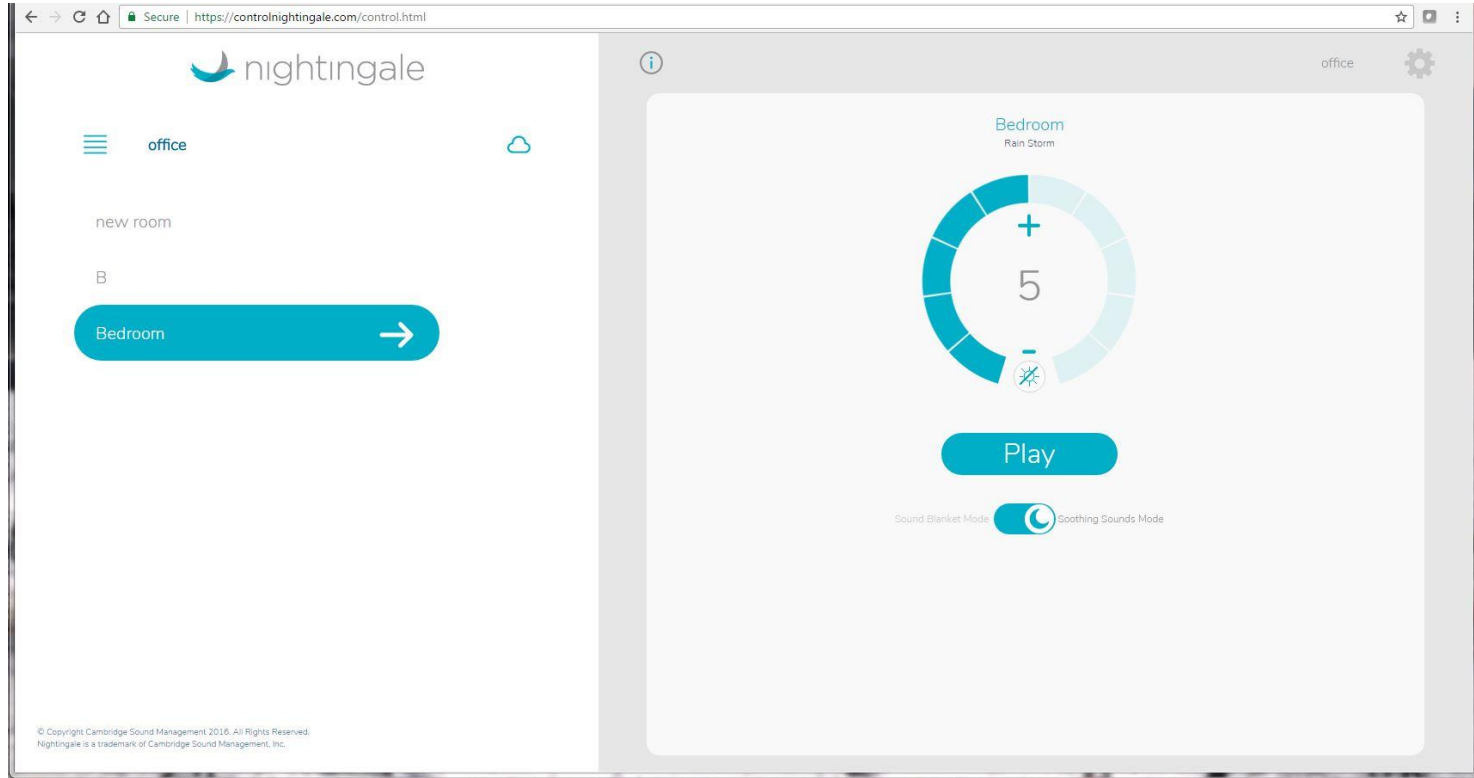

Settings

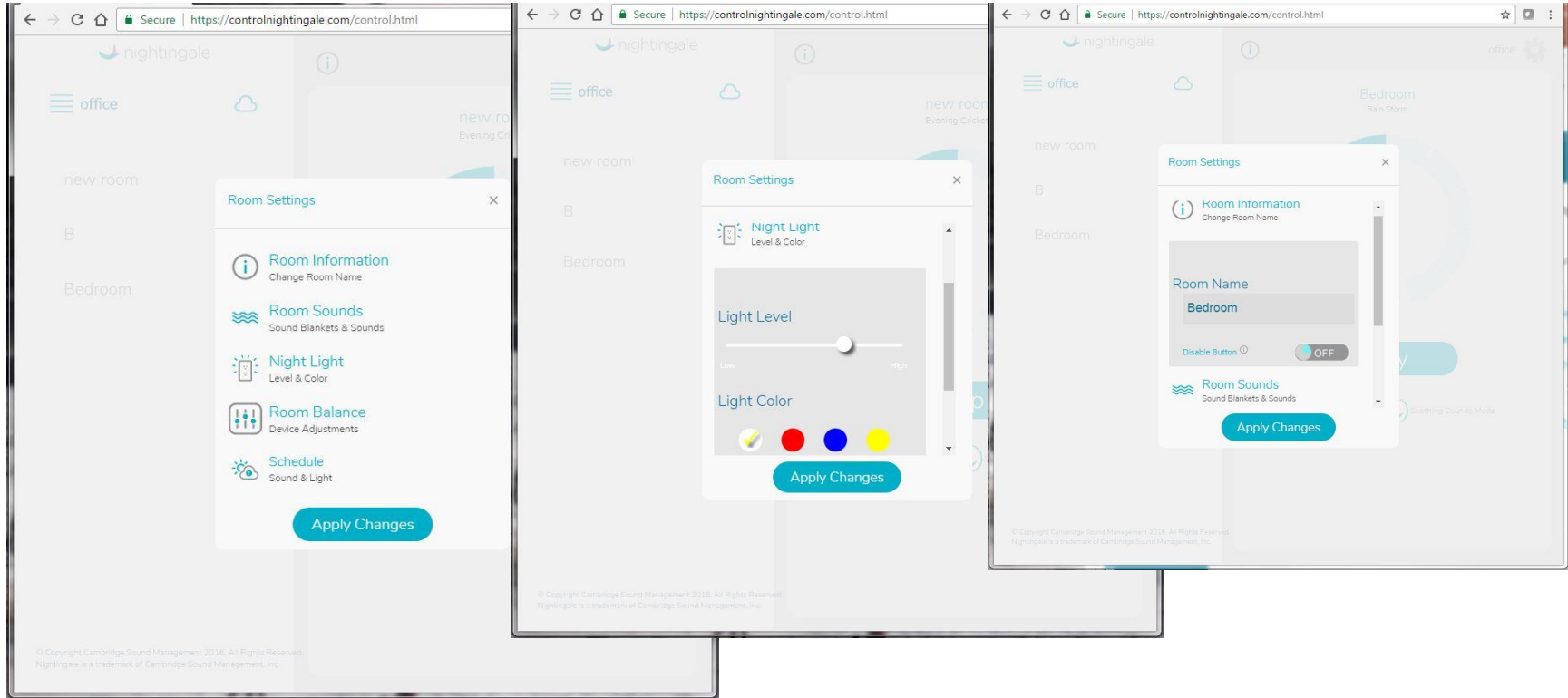

Nightingale Set Up Overview

Account Set Up and Adding First Room via Wi-Fi

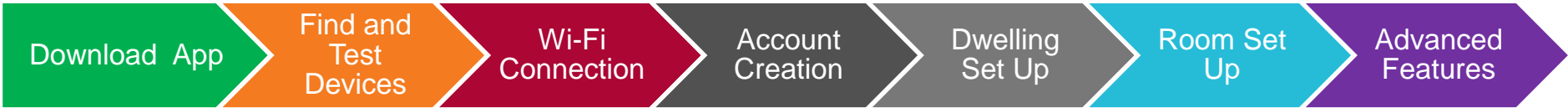

Adding a room to an existing dwelling and account via Wi-Fi



Adding new dwelling (e.g., second home) via Wi-Fi



Ways to control Nightingale

- Mobile app
 - iOS
 - Locally via Bluetooth, or on the network via Wi-Fi (preferred)
- Web app (controlnightingale.com)
 - Only via Wi-Fi
 - After you set up Nightingale
 - Use same login as when you set up the app
 - Any web browser (including iPad, Android smart home, etc.)
 - Great option for other users
- IFTTT integration
 - Only via Wi-Fi
 - We have a specific Alexa skill to control Nightingale via Amazon Echo
- Manually
 - Single button on side of unit

Manual Control Options

- Basic functions are accessible (one device at a time)
 - Turn nightlight on/off (double click)
 - Turn sound on/off (press and hold)
 - Change sound selection (continue to press and hold)
 - Change volume one step at a time (single click)

Considerations

- Advantages of Wi-Fi
 - Maximum control options and features – e.g. scheduling on/off times for light and sound
 - Control multiple pairs of units in a dwelling, or across dwellings
- When to control via Bluetooth
 - When there is low Wi-Fi signal strength
- When to control manually (not recommended)
 - To just do light on/off or sound on/off on demand