

STUDiO[®]

•••• BY DUALIT ••••

Dualit[®]

Since 1945



Instruction Manual & Guarantee

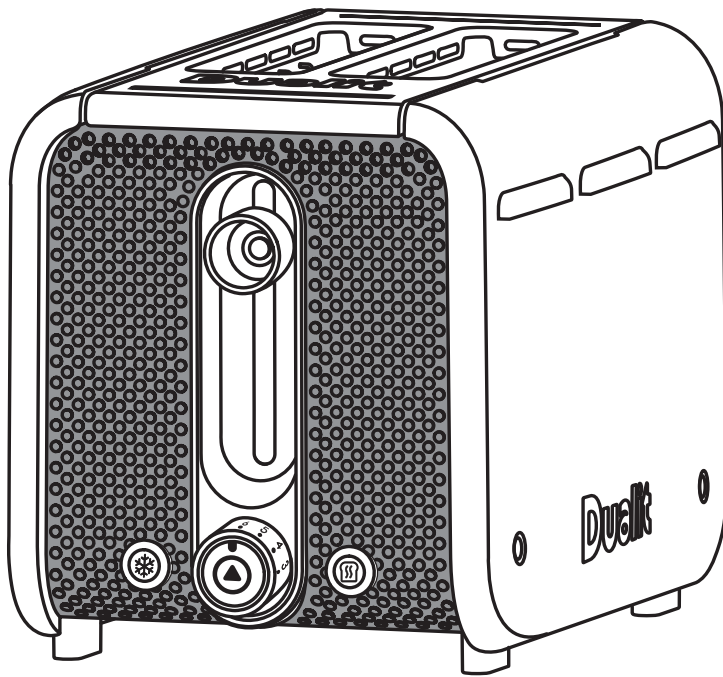

CSL2

CSL4

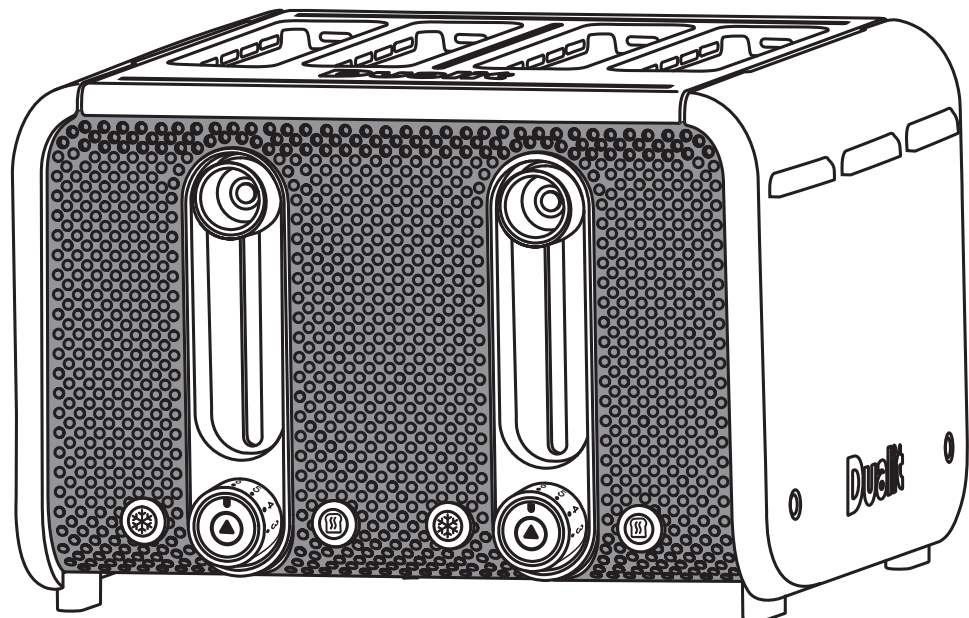

YOUR STUDIO® TOASTER

The perfect slice of toast is an essential part of breakfast and the Studio® Toaster is designed to deliver every time. With wide slots for the chunkiest of bread, defrost option and reheat, you will be serving superior toast, to change the way you breakfast.



FOR SERVICE, PARTS AND SUPPORT PLEASE
call our US Service Center at 201.439.1700
or via email info@electra-craft.com

Design Registration No. 002723841-0001, 002723841-0004.
Patent Application No. 1402187.7, 1315591.6, Reg No. 3085400

CONTENTS

Safety precautions _____	04
Know your Toaster _____	06
Setting up _____	08
Toasting tips _____	09
Toasting bread _____	10
Reheating Toast _____	11
Toasting frozen bread _____	12
4 slot toasting _____	13
Stop toasting _____	14
Cleaning & care _____	15
Troubleshooting _____	16
Guarantee _____	17

Unpack the box with care, keeping all the packaging materials until you are satisfied everything is present and in working order. Once satisfied remove any tags from the toaster body and recycle the packaging appropriately. Do not remove tags from the cord where appropriate. You may wish to keep the box to store your toaster.

All illustrations are for representation only; your model may vary from illustrations shown.



IMPORTANT SAFETY PRECAUTIONS



READ ALL INSTRUCTIONS

BEFORE USING THE TOASTER KEEP THESE INSTRUCTIONS FOR FUTURE REFERENCE

IMPORTANT SAFEGUARDS THIS IS AN ATTENDED APPLIANCE.

- Do not leave unattended during use, unplug after each use (risk of fire if an unattended appliance is left operating or plugged in).
- This appliance must not be used by children younger than 8 years old and persons with very extensive and complex disabilities. Children aged 8-14 years and persons with reduced physical, sensory or mental capabilities or lack of experience and knowledge shall not use this appliance, unless they are supervised and have been given instruction concerning the use of the appliance in a safe way and understand the hazards involved. Children shall not play with the appliance. Cleaning and user maintenance shall not be made by children unless they are older than 8 and supervised. Keep the appliance and its cord out of reach of children less than 8 years old.
- This appliance is intended for indoor household use only. If the appliance is used improperly or for professional or semi-professional purposes or if it is not used according to these instructions the Guarantee becomes invalid and Dualit refuses any liability for damage caused.

Electrical safety

- Before plugging in, check that the voltage on the rating label is the same as the mains supply.
- We recommend that the toaster is plugged into a socket that has no other appliance

connected to it. Failure to do this may cause an overload, trip a circuit breaker or blow a fuse. Preferably the socket outlet should be protected by a Residual Current device (RCD).

- Unplug from outlet when not in use. Allow to cool before cleaning and before putting on or taking off parts.
- **Should any of the lights remain illuminated after using the appliance, immediately unplug the toaster and call service centre.**
- The toaster is not intended to be operated by means of an external timer or separate remote-control system.
- To protect against electric shock, do not immerse any part of this product in water or other liquid.
- **NOTE:** Any plug cut from power supply cord should be disposed of immediately. Inserting any cut off plug into a 13A socket-outlet is hazardous.
- Do not operate any appliance with a damaged lead or plug, or after the appliance malfunctions, or has been damaged in any manner.
- If the supply cord is damaged, it must be replaced by the manufacturer, its service agent or similarly qualified persons in order to avoid a hazard.
- Never use the plug without the fuse cover fitted. Ensure replacement fuse is the same current value as original.
- Replacement fuses should be ASTA approved to BS 1362.
- **WARNING:** This appliance must be earthed.

General safety

- Bread may burn. Therefore toasters must not be used near or below curtains and other combustible materials.
- When in use a fire may occur if the toaster is covered or touching flammable material.

- Do not place on or near a hot gas or electric burner, or in a heated oven.
- Do not attempt to dislodge bread when the toaster is plugged in.
- Crumb tray must be in place during toasting.
- Crumb tray should be regularly cleaned. A build up of crumbs can burn or cause a fire.
- Do not allow cable to touch hot surfaces, or to hang over edge of a table or counter top.
- Keep the appliance and its cord out of reach of children.
- **Do not use appliance for any purpose other than the intended use.**
- Do not store or use toaster in an appliance garage or under cupboards.
- Do not put a pan on top of the toaster or warming rack.
- Do not use if dropped, cracked or damaged.
- Accessible surfaces of the toaster may get hot during use. Therefore use handles or knobs.
- Do not use scouring pad or abrasive cleaner on the toaster body.
- The use of accessory attachments not recommended by Dualit may result in fire, electric shock or injury to persons.

SAVE THESE INSTRUCTIONS

In the interest of improving products, Dualit Ltd. reserves the right to change the product specification without prior notice.

All illustrations are for representation only, your model may vary from illustrations shown.

INSTRUCTIONS ON ENVIRONMENT PROTECTION



Do not dispose this product in the usual household garbage at the end of its life cycle. Please hand it over to a collection point for the recycling of electrical and electronic appliances.

The symbol on the product, the instruction of use or the packaging will inform you about the methods of disposal. The materials are recyclable as mentioned on its marking. By recycling, material recycling or other forms of re-utilization of old appliances you are making an important contribution to protect our environment. Please enquire at the community administration for the authorised disposal location.

IMPORTANT: BEFORE FIRST USE

- Read this instruction manual before you start using the toaster. It gives you important safety information and will ensure you get the most out of your Dualit toaster.
- Keep this manual and your proof of purchase in a safe place.
- Before you use your toaster for the first time, wash all parts according to the cleaning instructions.
- Position the toaster according to the safety precautions.
- Make sure the toasting lever is in the raised position when you put the plug into the wall socket.
- The toasting lever will only engage when the toaster is plugged in with the power on.
- The cancel button will illuminate to show that the toaster is heating.
- When you turn the toaster on for the first time, a "new" smell/or smoke may be given off, this will dissipate after a few uses.

KNOW YOUR TOASTER

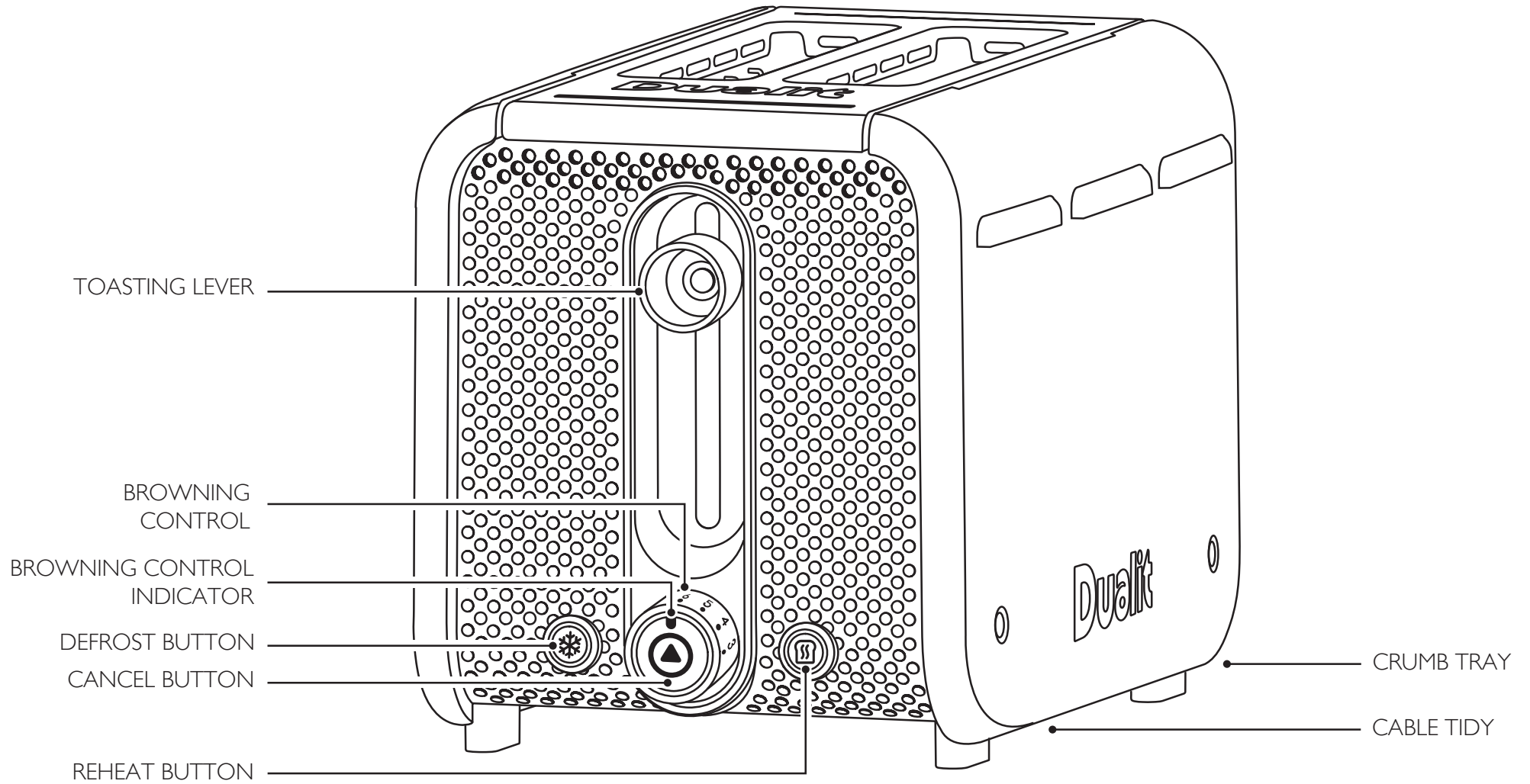

SETTING UP

Read and follow these instructions before using your toaster.

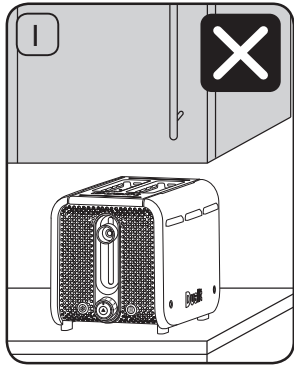

DO NOT STORE OR USE YOUR TOASTER IN AN APPLIANCE GARAGE OR UNDER CUPBOARDS. A fire may occur if incorrectly positioned.

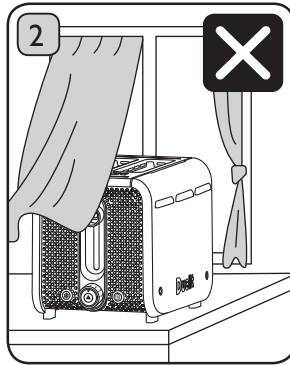

DO NOT STORE OR USE YOUR TOASTER CLOSE TO CURTAINS OR FLAMMABLE MATERIAL. A fire may occur if incorrectly positioned.

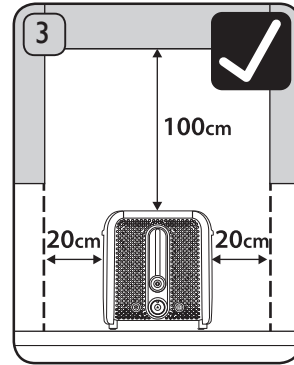

Place the toaster on an open level surface. Ensure the toaster is positioned at least **20cm/100cm CLEAR FROM ANY OVERHANGING CUPBOARDS, WALLS OR CEILING.**

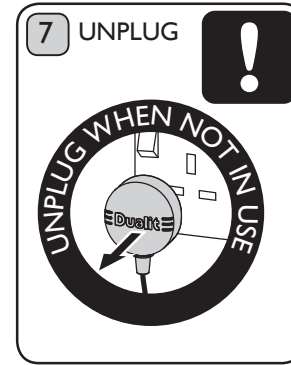

UNPLUG WHEN NOT IN USE.

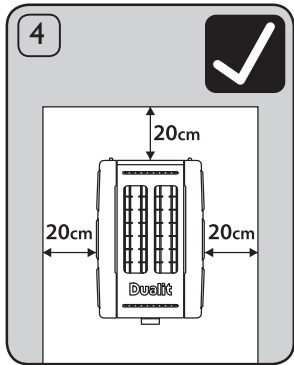

Ensure the toaster is positioned at least **20cm CLEAR FROM ANY OVERHANGING CUPBOARDS OR WALLS.**

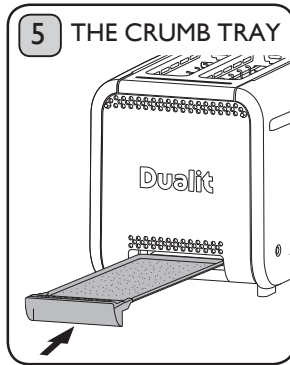

CRUMB TRAY MUST BE IN PLACE DURING TOASTING.

TOASTING TIPS

Here are a few tips to help get the best out of your toaster.

- Different breads will toast at different rates, wholemeal bread takes longer than white bread, fresh bread will take longer than day old bread. Remember to adjust your browning control to allow for your particular type of bread.
- The thickest slice of bread that will fit in your toaster is 28mm thick. Forcing bread which is too thick or too long into the slots will be difficult to eject once toasted.
- When hand cutting a fresh loaf, cut the slices as evenly as possible. Uneven slices will toast unevenly.
- Keep elements free from breadcrumbs and broken pieces of bread. If left these may burn out the elements. With the toaster unplugged use a soft brush to clean inside your toaster, do not use a knife!
- To reheat recently made toast, pull the toasting lever down and press 'Reheat.' Note, there is no need to adjust the browning control.
- Cancel toasting manually at any time by pressing the cancel button on the browning control knob.

TOASTING BREAD

THIS IS AN ATTENDED APPLIANCE. Do not leave unattended during use, unplug after each use (risk of fire if an unattended appliance is left operating).

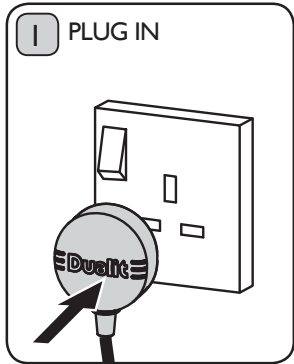
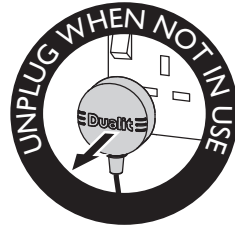

The toaster will only engage when the power is switched on. Plug the toaster into the wall power socket and turn power on at socket.

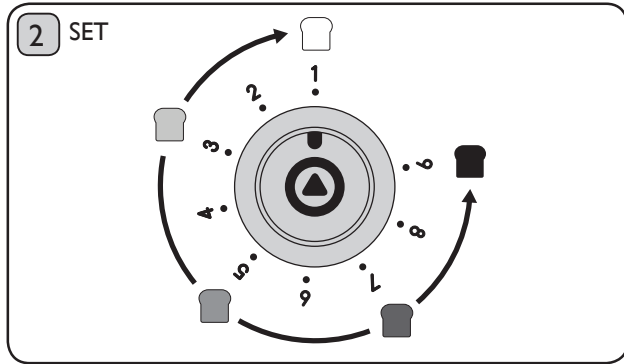

To toast, turn the browning control indicator to your desired browning setting (1 is the lightest and 9 is the darkest setting). Note: the freshness, thickness and type of bread will effect required toasting times. We recommend setting 5 for medium slice, white bread. Adjust for your bread type, see chart below for a guide to toasting.



	REDUCE BROWNING SETTING (Turn slightly anti-clockwise)	SETTING 5	INCREASE BROWNING SETTING (Turn slightly clockwise)	
FRESHNESS (age) of bread	5+ days old	2 days old	0 days old (freshly baked)	
MOISTURE CONTENT of bread	Dry	Average	Moist	
COLOUR of bread	—	White	Brown	Rye
INGREDIENTS in bread	Sweet	Savoury	Lots of seeds & savoury	

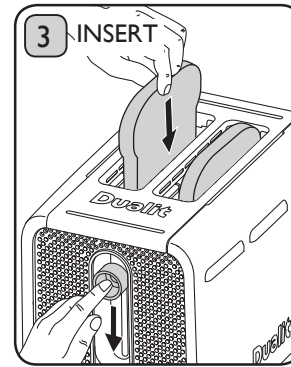

Place the bread into the slots and press the toasting lever down until it engages. The browning control will be illuminated red for the duration of the toasting.

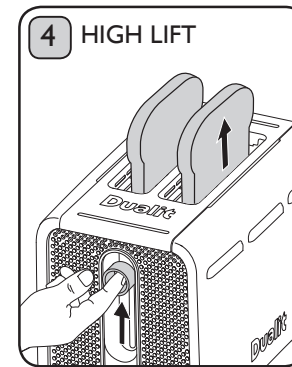

When toasted the toast will pop up automatically. If the slices are difficult to remove safely, lift the toasting lever manually for extra high lift.

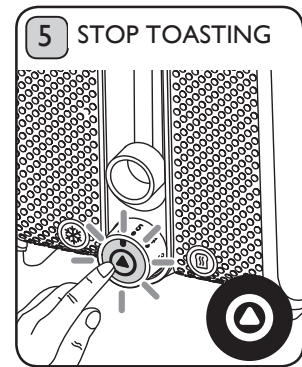

To immediately stop toasting, press the cancel button. **After cancelling if any light remains illuminated after use immediately UNPLUG the toaster & call service centre.**

REHEATING TOAST

If your toast has cooled before you have managed to eat, it can be warmed again using the REHEAT function.

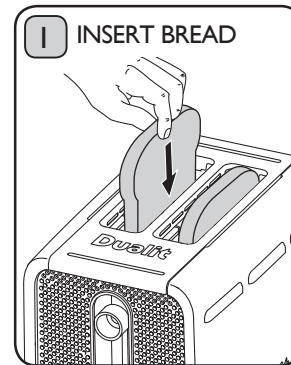

Place the toast in the slots.

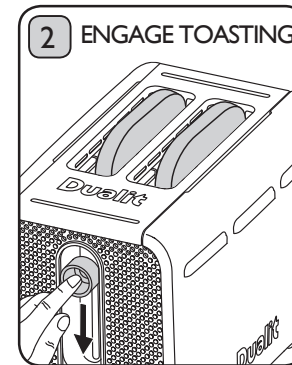

Push the toasting lever down until it engages.

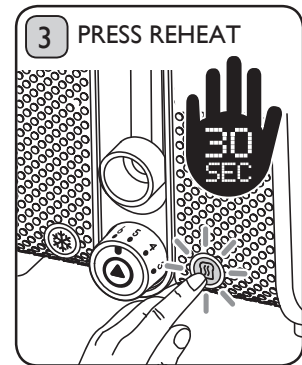

Immediately press the reheat button. The button will illuminate red.

NOTE: bread may burn if your toast is already well done.

TOASTING FROZEN BREAD

When 'defrost' is activated, the toaster automatically adjusts the settings to defrost and then toast frozen bread.

To cancel toasting see page 11.

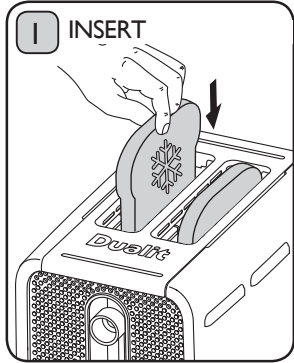

To toast frozen bread, place the bread into the slots.

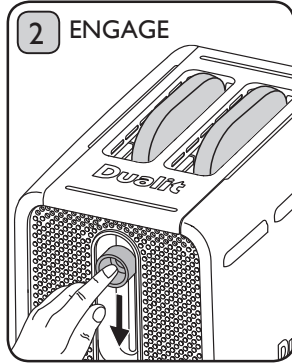

Press the toasting lever down until it engages.

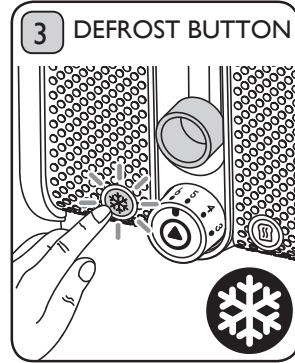

Immediately press the defrost button. The button will be illuminated red.

Note: Defrost and reheat functions cannot be used at the same time. The toaster will perform the function that is selected first. If the incorrect function is selected, cancel toasting and start again.

DON'T FORGET TO REGISTER YOUR PRODUCT	WWW.DUALIT.COM/REGISTER	Register my appliance ✓
	OR BY POST	

4 SLOT TOASTING

To cancel toasting see page 11.

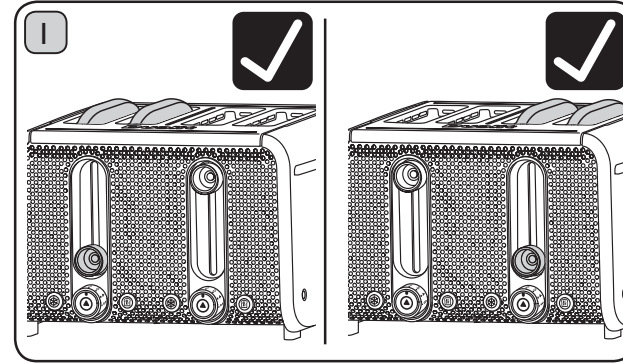

If you want to toast 2 pieces of bread only **LOAD AND ENGAGE** one side of the toaster.

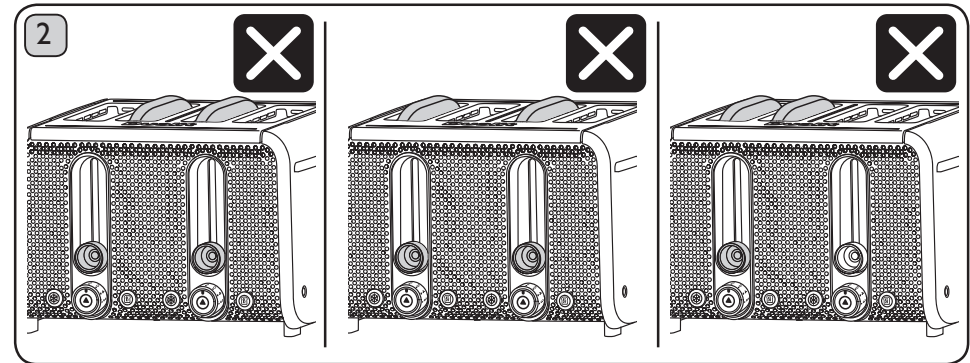

DO NOT LOAD AND ENGAGE BOTH SIDES OF THE TOASTER, TO TOAST 2 PIECES OF BREAD.

STOP TOASTING

The toasting cycle will automatically stop and the toast will pop up, but if required, you can cancel at any time.

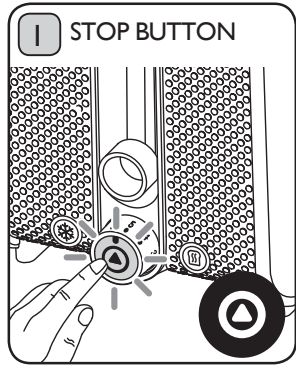

1 STOP BUTTON
Press the cancel button located on the end of the browning control.

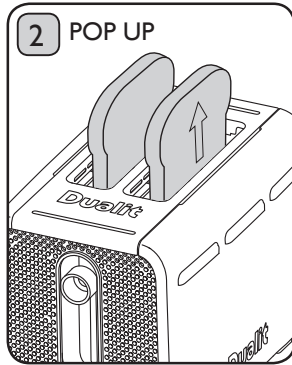

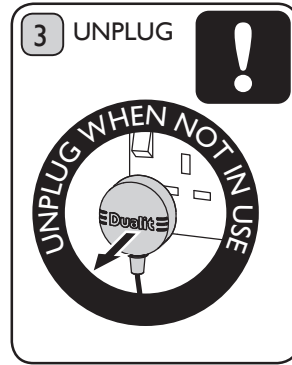

2 POP UP
The toaster will immediately stop and the items being toasted will pop up. **The light will go out. After cancelling if any light remains illuminated after use immediately unplug the toaster & call service centre.**

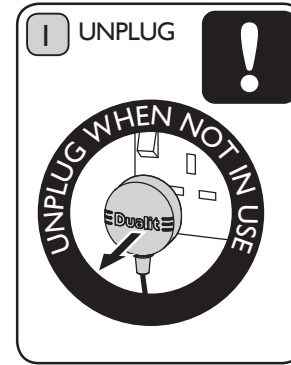

3 UNPLUG 
THIS IS AN ATTENDED APPLIANCE. Do not leave unattended during use, unplug after each use (risk of fire if an unattended appliance is left operating).

CLEANING & CARE



1 UNPLUG 
Switch toaster off, remove the plug from the wall socket and let the toaster cool down before you start cleaning it.

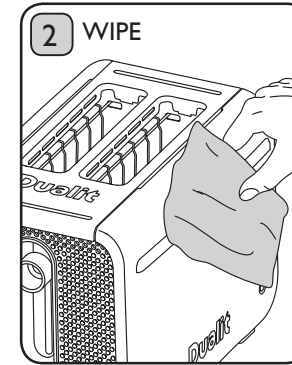

2 WIPE
Wipe the outside of the toaster with a soft moist cloth and dry it with another cloth. Do not use a scouring pad or abrasive cleaner.



3 CAUTION
Use a soft brush to clean inside your toaster. Do not insert any metallic or sharp utensils in to the toaster.

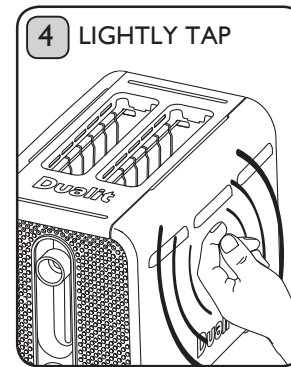

4 LIGHTLY TAP
When the toaster has cooled completely, tap the sides of the toaster lightly to dislodge any crumbs caught in the toasting chamber.

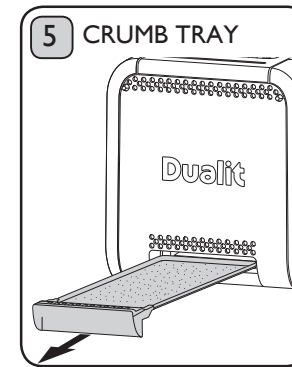

5 CRUMB TRAY
Crumbs will accumulate in the crumb tray and could catch fire if the tray is not emptied frequently. Pull out the crumb tray and wipe clean using a damp cloth.

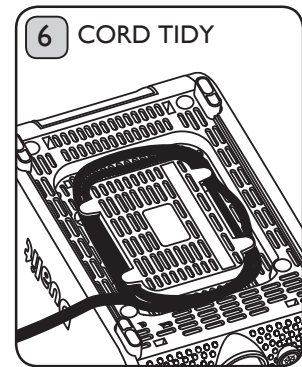

6 CORD TIDY
Store the cleaned toaster unplugged with the cord wrapped round the cord tidy on the base of the toaster.

TROUBLESHOOTING



POSSIBLE CAUSE(S)	SOLUTION(S)
MY TOASTER IS NOT WORKING:	
1. The toaster may not be properly connected to the power supply.	1. Check the plug is in the socket and the switch is turned on. If the toaster is still not working, check the plug fuse.
2. If your lever is not staying down.	2. Check if the light is glowing red. If yes, unplug the toaster and call service centre. If no, your plug fuse may have blown.
I GET UNEVEN TOASTING:	
1. Different bread types and sizes have been used at the same time.	1. Ensure size and type of bread being toasted are the same.
2. End elements take a little longer to warm up than centre elements.	2.1 Ensure all active slots have bread inserted when toasting.
	2.2 Once toaster is at optimum operating temperature this will no longer occur.
MY TOAST DOESN'T POP UP WHEN THE TOASTER HAS FINISHED:	
1. There may be a fault with the toaster.	1. If the power light remains illuminated, immediately unplug the toaster and call service centre.
2. Your bread may be too thick	2.1 Slices thicker than 28mm will get stuck.
	2.2 Hand cut slice must be cut evenly.
SMOKE COMING OUT OF THE SLOTS:	
1. If this is the first time using your toaster, this is normal, your elements are being conditioned.	1. This will dissipate after a few uses.
2. The crumb tray might be full. A build up of crumbs can burn or cause a fire.	2. Empty the crumb tray.
3. Some crumbs or pieces of bread may be stuck in the toaster.	3. Unplug and allow to cool, remove the crumb tray then turn the toaster upside down over a sink or bin and gently shake the crumbs out.

GUARANTEE

This appliance is of excellent quality and construction. However, if any defects in materials or workmanship do appear during the relevant guarantee period, we will, at our discretion, either repair or replace the defective parts, free of charge, subject to the terms and conditions of our Guarantee shown below.

This Guarantee covers both parts and labour. Carriage is not included.

Your Guarantee period is as follows:

- 1 year

This Guarantee provides benefits which are additional to, and do not affect, your statutory rights. This Guarantee does not cover the cost of returning the product to the dealer from whom it was purchased or to ourselves. This Guarantee applies only to products sold and located in mainland Great Britain. It does not cover liability in respect of or replacement of plugs, cables or fuses and also does not cover defects due to:

- Failure to use or maintain product in accordance with Dualit's instructions.
 - The product being connected to an unsuitable electricity supply.
 - Accidental damage to or abuse or misuse of the product.
 - product modification, except by Dualit or approved agent.
 - Dismantling of or interference with the product.
 - Theft or attempted theft of the product.
- Before returning any product under this Guarantee, please check that:
- You have followed the product instructions correctly.
 - Your mains electricity supply is functional.
 - The defect is not due to a blown fuse.

If you wish to claim under this guarantee you should:

- Send the product, postage or carriage paid, to the dealer from whom it was purchased or to Dualit direct.
- Ensure that the product is clean and packed carefully (preferably in its original carton).
- Enclose details of your name, address and telephone number and when and where the product was purchased, together with proof of purchase (e.g. a till receipt).
- Give exact details of the nature of the defect.

This Guarantee does not cover any other claims whatsoever, including, without limitation, any liability for incidental, indirect or consequential damage, nor does it cover any claims for conversion or modification or for the costs of repair carried out by any third party without the prior consent of Dualit. If replacement parts are fitted to the product this will not extend the period of the Guarantee.

For further advice contact the Dualit customer helpline on +44 (0)1293 652 500 (09:00 to 17:00 Monday to Friday).

Alternatively, email Dualit at info@dualit.com or visit www.dualit.com

Do not throw away the appliance with the normal household waste at the end of its life, but hand it in to an official collection point for recycling. By doing this you help preserve the environment.