

OPERATION

Using the Washer

WARNING

- To reduce the risk of fire, electric shock, or injury to persons, read the SAFETY INSTRUCTIONS before operating this appliance.

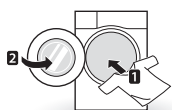

1 Sort Laundry and Load the Washer

Sort laundry by fabric type, soil level, color and load size, as needed. Open the door and load items into the washer.



2 Cleaning Products

Add the proper amount of HE (High-Efficiency) detergent and liquid fabric softener to the Auto Dispense reservoir or the manual dispenser. If desired, use the manual dispenser to add powdered oxygen-based bleach. Do not use liquid chlorine bleach.



3 Turn on the Washer

Press the **Power** button to turn on the washer. After a short delay, the display will illuminate and a chime will sound.

4 Cycle Buttons

Touch a cycle icon in the display to select a cycle. Swipe left in the display to see additional cycles.

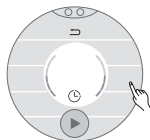

5 Adjust Settings

Default settings for the selected cycle can now be changed, if desired, by selecting the options in the display. See the Control Panel section for more details.

NOTE

- Not all modifiers and options are available on all cycles. The selection will not appear in the display if it is not allowed.



6 Begin Cycle

Press the **Start/Pause** button to begin the cycle. The washer will agitate briefly without water to measure the weight of the load. If the **Start/Pause** button is not pressed within 15 minutes, the washer will shut off and all settings will be lost.

7 End of Cycle

When the cycle is finished, a melody will sound. Immediately remove your clothing from the washer to reduce wrinkling. Check around the door seal when removing the load for small items that may be caught in the seal.

NOTE

- The washer rotates the laundry in a way that allows it to use less water while still fully saturating your clothing. It is normal to not be able to see water during the wash cycle. If the temperature or the water level inside the machine is too high, the door locks and cannot be opened. To open the door while washing, use the Rinse+Spin cycle.

Sorting Laundry

CAUTION

- The washer can be fully loaded, but the drum should not be tightly packed with items. The door of the washer should close easily.
- Use the Bulky/Large cycle for buoyant or nonabsorbent items such as pillows or comforters. Failure to follow this caution can result in leakage.
- If possible, do not wash any water-resistant items. If you must, please select the Bulky/Large cycle.

Grouping Similar Items

For the best washing results, and to reduce the possibility of damage to clothing, care should be taken to sort the clothing into loads that are made up of similar items.

Mixing different fabric types and/or soil levels can result in poor wash performance, color transfer, discoloration, fabric damage or linting. Fabrics should be sorted into groups as described below.

Colors

Sort articles by color. Wash dark clothes together in a separate load from light colors or whites. Mixing dark clothes with light clothes can result in dye transfer or discoloration of the lighter clothes.

Soil Level

Wash heavily soiled clothing together. Washing lightly soiled clothing in the same load with heavily soiled clothing could result in poor wash performance for the lightly soiled clothing.

Fabric Type

Delicate articles should not be mixed with heavy or sturdy fabric types. Washing heavy fabrics in a delicate load can result in poor wash performance for the heavy fabrics and possible damage to the delicates.

Lint Type









Some fabrics attract and bind lint to them while others give off lint in the laundry process. Avoid mixing these lint collectors and lint producers in the same load. Mixing these fabrics will result in pilling and linting on the lint collectors. (For example, lint collector—knit sweater; lint producer—terry cloth towels.)

Sort Laundry

| By colors | By Soil | By Fabric | By Lint |
|-----------|---------|-----------|----------------|
| White | Heavy | Delicates | Lint Producer |
| Lights | Normal | Easy Care | Lint Collector |
| Darks | Light | Sturdy | |

Fabric Care Labels

Many articles of clothing include a fabric care label. Using the chart below, adjust the cycle and option selections to care for your clothing according to the manufacturer's recommendations.

| Category | Label | Directions |
|-------------------|---|---|
| Washing |  | Hand wash |
| |  | Machine wash, Normal cycle |
| |  | Perm Press/Wrinkle Resistant setting (which has a cool down or cold spray before the slower spin) |
| |  | Gentle/Delicate setting (slow agitation and/or reduced wash time) |
| |  | Do not wash |
| |  | Do not wring |
| Water Temperature | ... | Hot |
| | .. | Warm |
| | . | Cold/Cool |
| Bleach Symbols |  | Any bleach (when needed) |
| |  | Only non-chlorine bleach (when needed) |
| |  | Do not bleach |

Loading the Washer

- Check and empty pockets. Paper clips, coins, matches, etc. can damage clothing and the washer.
- Close zippers and hooks, and tie drawstrings to prevent snagging or tangling of clothes.
- Pretreat heavily stained areas for best results.
- Combine large and small items in a load. Load large items first. Large items should not be more than half of total load.
- The washer can be fully loaded, but the drum should not be tightly packed with items. The door of the washer must close easily.
- Do not wash single small items. Add 1-2 similar items to the load to prevent an out-of-balance load.
- Wash thick, bulky items individually. Heavy blankets, comforters, bedspreads, or pet beds can get tangled or cause an unbalanced load if combined with other items.
- Do not wash/spin waterproof items. Washing raincoats or sleeping bags may result in abnormal vibration or may cause the load to bounce, which could damage the drum.
- Wash small, light items in a mesh bag. Items like underwear can get caught in the door seal, and a brassiere hook may damage other items or the drum.
- Brush off heavy soil, dust, and hair from items before washing. Excess dirt or sand can abrade other fabrics and lead to poor wash performance.
- For best performance, load clothes as shown.

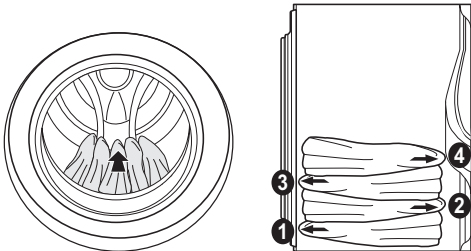

- Load clothes loosely, and do not overfill the drum. Clothes need room to circulate in order to get clean.
- Do not press down on items while stacking them in the drum.

Adding Cleaning Products

Using the Auto Dispense Function

When the Auto Detergent and Auto Softener functions are turned on, detergent and softener are automatically dispensed in amounts based on the load size, at the appropriate time during the cycle.

- 1 Press the O mark to open the lower cover as shown below.**

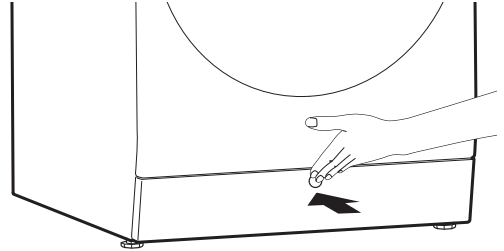

- 2 Press PUSH on the Auto Dispense tray as shown. Use the handle to pull the tray out.**

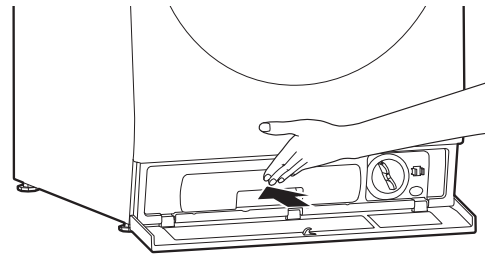

- 3 Turn the caps on the Auto Dispense tray to the left to open the two reservoirs.**

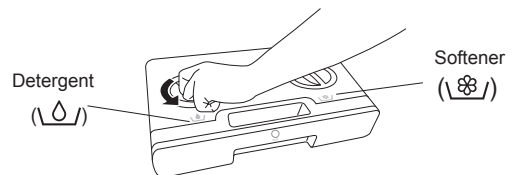

4 Pour the detergent and softener into their respective reservoirs.

- The Auto Dispense tray has two reservoirs. Put the liquid detergent (🧴) into the left reservoir and the fabric softener (🧼) into the right reservoir.
- Fill to the Max line.

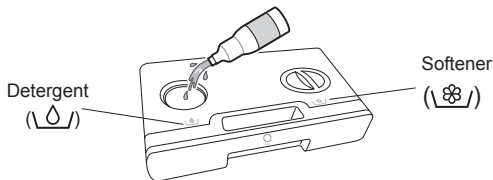

5 After filling, insert and turn the caps to the right until tightly closed.

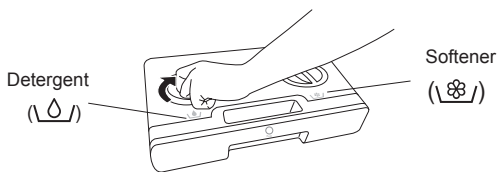

6 Insert the Auto Dispense tray until it clicks.

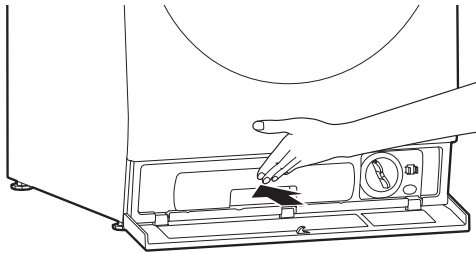

7 Close the lower cover.

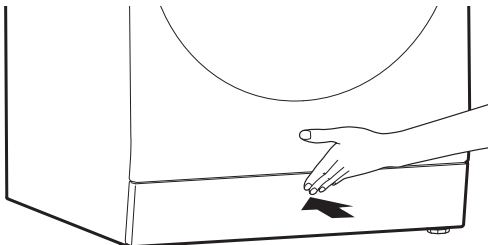

8 Touch the icon at the top of the display to open the Settings screen and select the Auto Detergent and Auto Softener functions.

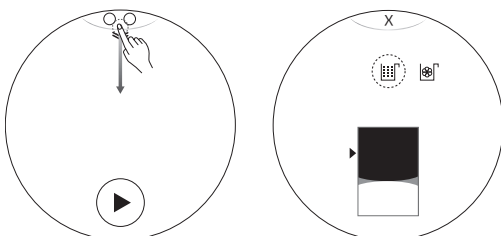

NOTE

- Before using the appliance, make sure there is detergent in the Auto Dispense reservoir.
- A full detergent reservoir will last for about 18 standard cycles, with half a load of laundry in the drum.
- The default settings are configured to automatically dispense 2.4 oz (70 ml) of detergent and 1 oz (30 ml) of softener for 8-12 lb (4-6 kg) of normally soiled laundry. This can be changed using the **More Settings** button. For more details, see the Settings section of this manual.
- To set the Auto Dispense amounts for 8-12 lb (4-6 kg), see the manufacturer's recommendations on the detergent or fabric softener.
- When you select **Auto Wash**, **Auto Detergent** is automatically turned on.
- Turn on the detergent/softener refill alarm to be notified of when the reservoirs need to be refilled.
- Remove any residual detergent on the outside of the Auto Dispense tray before inserting it.
- To change detergents, follow the steps above or turn off the Auto Detergent function and use the included manual dispenser.
- Do not use force when pulling out the Auto Dispense tray.
- To use the Auto Detergent function with the Wool cycle or other cycles where a neutral detergent is recommended, touch Cancel when prompted.
- Always use HE (High-Efficiency) detergent with this washer.

⚠ WARNING

- Do NOT mix chlorine bleach with ammonia or acids such as vinegar or rust/scale remover. Mixing chemicals like these can produce a lethal gas, resulting in severe injury or death.

⚠ CAUTION

- Do not place or store laundry products, such as detergent, bleach, or liquid fabric softener, on top of the washer or dryer. Wipe up any spills immediately. These products can damage the machine's finish and controls.
- Remove the Auto Dispense tray only when refilling or replacing detergent or softener.
- Use only liquid HE detergents in the Auto Dispense tray.
- Do not pour any powdered cleaning products into the Auto Dispense reservoirs.
- Do not put liquid bleach into the Auto Dispense tray or the manual dispenser.
- The Auto Dispense function may not work properly with some concentrated gel detergents. Use the manual dispenser to dispense gel detergents.
- Do not mix detergent with fabric softener.
- Use care when removing and inserting the Auto Dispense tray, as detergent or fabric softener may spill. Wipe up any spills before proceeding.
- To use the Auto Dispense function, Auto Detergent and/or Auto Softener must be turned on in the Settings screen.
- Detergent or fabric softener left in the Auto Dispense reservoirs for an extended period may harden and fail to dispense properly.
- The ventilation holes help in dispensing the detergent and fabric softener. Do not hold the Auto Dispense tray upside down, as cleaning products may leak.

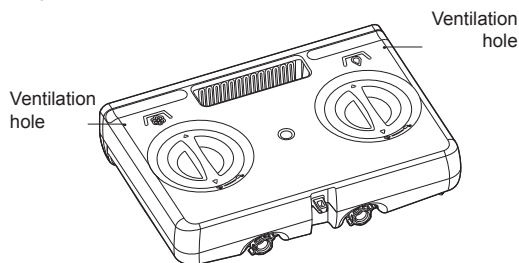

- Do not block the ventilation holes in the Auto Dispense tray.

Dispensing Detergent Manually

To manually dispense powdered detergent or neutral detergent, disable the Auto Detergent function and use the provided manual dispenser. To dispense oxygen-based bleach, leave the Auto Detergent function on. Do not use the manual dispenser with liquid bleach.

1 Turn off Auto Detergent function, if necessary.

2 Measure and pour cleaning product into manual dispenser.



Place manual dispenser on top of clothing in drum.



NOTE

- Dispense the detergent by referring to the scale mark in the manual dispenser.
- When washing is finished, wash the manual dispenser clean before storing it.
- To use fabric softener, turn on the **Auto Softener** function.
- Do not use the manual dispenser with the **Auto Detergent** function turned on. Excessive suds will remain even after rinsing, causing a longer rinsing time or preventing a proper rinsing.
- When you use the Delay Wash function, Auto Dispense is recommended.
- Manual dispenser can be collapsed for easy storage.



⚠ CAUTION

- Dispense the fabric softener using the Auto Detergent function.
- Carefully place the manual dispenser on top of clothes, to avoid spilling detergent directly onto clothing. Detergents with strong bleaching properties could cause damage to clothing.

Control Panel

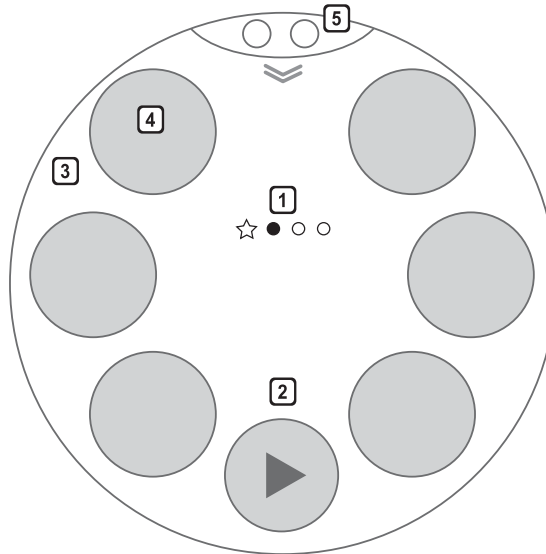

Control Panel Features

1 Cycle Category

The dots indicate the current category screen. Swipe the display left or right to show Everyday Cycles, Special Cycles, Dry Cycles(Optional), Download Cycles, and My Pattern.

Use My Pattern for cycles you use frequently. If you run the same cycle more than three times, it will be registered under **My Pattern**.

Cycle categories may differ on some models.

2 Start/Pause Button

Press this button to start the selected cycle. If the washer is running, use this button to pause the cycle without losing the current settings.

NOTE

- If Start/Pause is not pressed within 15 minutes of selecting a cycle, the washer automatically turns off and all cycle settings are lost.

3 Time and Status Display

The display shows the settings, estimated time remaining, options, and status messages for your washer. When the washer is turned on, the default settings in the display will illuminate.

4 Cycles

You may select a desired cycle. For more information, see the Wash Cycles section.

Download new and specialized cycles that are not included in the appliance's standard cycles in the **Download Cycles** category.

5 Quick Setting

Control Lock, Remote Start, Auto Detergent, Auto Softener, Selection of Main Washer and Mini Washer, and More Settings are displayed. Touch a function to turn it on or off.

Wash Cycles

Wash cycles are designed for the best wash performance for each type of load. Select the cycle that best matches the load contents for maximum wash performance and fabric care. For best results, follow the fabric care labels on your garments. See the Sorting Laundry section for a guide to the symbols used on fabric care labels.

Swipe through the cycle category screens and touch a cycle icon to select the desired cycle. When you select a wash cycle, the icon for the cycle will be highlighted in the screen.

NOTE

- Whenever load weights are mentioned, assume 1 lb (0.45 kg) = 1 thick bath towel (dry).
- For information on using SmartThinQ™ applications to save energy, see the Smart Functions section.

| Choosing by | Wash Cycle | Description |
|-------------|-------------|--|
| Fabric Type | Normal | Use this cycle to wash all normal items, except delicate fabrics such as wool or silk. NOTE: Pressing the Start/Pause button without selecting a cycle will cause the Normal cycle to begin immediately, using the default settings. |
| | Wool | This cycle is for washing 100% pure wool items only. (Use detergent for machine-washable woolens.) |
| | Delicate | This cycle is for washing lingerie or sheer and lacy clothes which can easily be damaged. |
| | Perm.Press | Use this cycle to wash wrinkle-free clothes or tablecloths, to minimize wrinkles. |
| | Gentle Care | Use this cycle for hand-washable clothes such as lingerie, dresses etc. |
| | Outdoor | Use this cycle for garments that are specially designed and treated for outdoor use. |
| Load Size | Normal | If you have a mixed load that is half-size, use the Normal cycle with default settings. For full-size loads, use the Normal cycle with the soil level set to heavy, and add an extra rinse. In both cases, the machine will automatically detect the load size and adjust accordingly. |
| | Speed Wash | Use the Speed Wash cycle to quickly wash lightly soiled clothing and small loads. For high wash and rinse efficiency, wash small loads of 2-3 lightly-soiled garments (less than 3 lb. (1.36 kg)). NOTE: Use very little detergent in this cycle. For additional rinsing, add an extra rinse in the Rinse option screen. |
| | Bulky/Large | This cycle is for washing king or queen sized comforters. NOTE: Using the Bulky/Large cycle with a low spin speed is recommended when washing waterproof or water-resistant items, to help protect the fabrics' properties. If your washer does not function properly, manually redistribute the load or put one comforter in at a time. |
| | Auto Wash | Use this cycle to adjust wash and rinse patterns automatically after detecting load size and soil level. |

| Choosing by | Wash Cycle | Description |
|-------------|----------------|---|
| Convenience | Speed Wash | Use the Speed Wash cycle to quickly wash lightly soiled clothing and small loads. For high wash and rinse efficiency, wash small loads of 2-3 lightly-soiled garments (less than 3 lb. (1.36 kg)). NOTE: Use very little detergent in this cycle. For additional rinsing, add an extra rinse in the Rinse option screen. |
| | Rinse+Spin | Select this option to rinse and spin a load separately from a regular cycle. This can be helpful in preventing fresh stains from setting in fabrics. Change the spin speed in the Spin options screen after selecting the cycle. |
| | Tub Clean | Use this cycle to clean the washer's drum. See Tub Clean Cycle in the Maintenance section. |
| | Speed Wash+Dry | This cycle provides both washing and drying within 80 minutes for up to 3 lightly soiled shirts. |
| Soil Level | Normal | For tough stains on children's clothes, use the Normal cycle with a hot Wash Temp. setting, plus the Prewash option and an Extra Rinse. |
| | Heavy Duty | This cycle is for washing heavily soiled laundry using more powerful wash motions. |
| | Allergiene™ | This cycle is a powerful, high-temperature cycle designed specifically to reduce certain allergens. NOTE <ul style="list-style-type: none"> • Selecting the Allergiene™ cycle automatically incorporates steam into the wash cycle. • The Allergiene™ cycle can significantly reduce allergens in bedding and clothing. • The Allergiene™ cycle helps reduce dust mite populations and helps reduce allergens. Due to the higher energy and temperatures used, the Allergiene™ cycle is not recommended for wool, silk, leather, or any other delicate or temperature sensitive items. |
| | Sanitary | This cycle reduces 99.9% of bacteria on laundry when used in conjunction with bleach, without high energy consumption. |

Cycle Guide

● = available option, ■ = default setting

| Cycle | Cycle Options | Wash Temp | Spin Speed | Soil Level | Delay Wash | Extra Rinse |
|------------|----------------|-----------|------------|------------|------------|-------------|
| Normal | Turbo Wash | Extra Hot | Extra High | Heavy | ● | ● |
| | Prewash | Hot | Very High | | | |
| | | Warm | High | Normal | | |
| | Fresh Care | Cold | Medium | | | |
| | | Tap Cold | Low | Light | | |
| | | | Very Low | | | |
| Speed Wash | | Hot | | | ● | ● |
| | | Warm | | | | |
| | Fresh Care | Cold | Medium | | | |
| | | | Low | Light | | |
| | | | Very Low | | | |
| Heavy Duty | | Extra Hot | Extra High | Heavy | ● | ● |
| | Prewash | Hot | Very High | | | |
| | Hygienic Rinse | Warm | High | | | |
| | Fresh Care | Cold | Medium | | | |
| | | Tap Cold | Low | | | |
| | | | Very Low | | | |
| Auto Wash | | Hot | Very High | | ● | |
| | | | High | Normal | | |
| | Fresh Care | | Medium | | | |
| | | | Low | | | |
| | | | Very Low | | | |
| | | | | | | |
| Perm.Press | Turbo Wash | Extra Hot | | Heavy | ● | ● |
| | Prewash | Hot | Very High | | | |
| | Hygienic Rinse | Warm | High | Normal | | |
| | Fresh Care | Cold | Medium | | | |
| | | Tap Cold | Low | Light | | |
| | | | Very Low | | | |
| Wool | | Hot | | Heavy | ● | ● |
| | | Warm | | Normal | | |
| | Fresh Care | Cold | Medium | | | |
| | | Tap Cold | Low | Light | | |
| | | | Very Low | | | |
| | | | | | | |

● = available option, ■ = default setting

| Cycle | Cycle Options | Wash Temp | Spin Speed | Soil Level | Delay Wash | Extra Rinse |
|----------------|----------------|-----------|------------|------------|------------|-------------|
| Allergiene™ | | Extra Hot | Extra High | Heavy | ● | ● |
| | | | Very High | | | |
| | Hygienic Rinse | | High | Normal | | |
| | Fresh Care | | Medium | | | |
| | | | Low | | | |
| | | | Very Low | | | |
| Sanitary | | Extra Hot | | Heavy | ● | ● |
| | | | | | | |
| | Hygienic Rinse | | High | Normal | | |
| | Fresh Care | | Medium | | | |
| | | | Low | | | |
| Speed Wash+Dry | Turbo Wash | | | | ● | ● |
| | | Hot | Very High | | | |
| | | Warm | | | | |
| | | Cold | | | | |
| | | | | Light | | |
| | | | | | | |
| Baby Wear | | Extra Hot | | Heavy | ● | ● |
| | Prewash | Hot | | | | |
| | Hygienic Rinse | Warm | High | Normal | | |
| | Fresh Care | Cold | Medium | | | |
| | | Tap Cold | Low | | | |
| | | | Very Low | | | |
| Outdoor | Turbo Wash | | | Heavy | ● | ● |
| | | Hot | | | | |
| | | Warm | | Normal | | |
| | Fresh Care | Cold | Medium | | | |
| | | Tap Cold | Low | Light | | |
| | | | Very Low | | | |
| Delicate | Turbo Wash | | | Heavy | ● | ● |
| | | Hot | | | | |
| | | Warm | | Normal | | |
| | Fresh Care | Cold | Medium | | | |
| | | Tap Cold | Low | Light | | |
| | | | Very Low | | | |

● = available option, ■ = default setting

| Cycle | Cycle Options | Wash Temp | Spin Speed | Soil Level | Delay Wash | Extra Rinse |
|--------------|----------------|-----------|------------|------------|------------|-------------|
| Tub Clean | | Extra Hot | | | | |
| | | | | | | |
| | | | | Normal | | |
| | | | | | | |
| | | | | | | |
| Rinse + Spin | | | Extra High | | | |
| | | | Very High | | | |
| | Hygienic Rinse | | High | Normal | ● | ● |
| | Fresh Care | | Medium | | | |
| | | | Low | | | |
| Spin | | | Very Low | | | |
| | | | Extra High | | | |
| | | | Very High | | | |
| | | | High | | | |
| | Fresh Care | | Medium | | ● | |
| Bulky/Large | | | Low | | | |
| | | | Very Low | | | |
| | Turbo Wash | | | Heavy | | |
| | | Hot | | | | |
| | | Warm | | Normal | ● | ● |
| | Fresh Care | Cold | | | | |
| Cotton+ | | Tap Cold | Low | Light | | |
| | | | Very Low | | | |
| | Turbo Wash | Extra Hot | Extra High | Heavy | | |
| | Prewash | Hot | Very High | | | |
| | Hygienic Rinse | Warm | High | Normal | ● | ● |
| | Fresh Care | Cold | Medium | | | |
| | Tap Cold | Low | Light | | | |
| | | Very Low | | | | |

Cycle Modifier Buttons

Each cycle has default settings that are selected automatically. Customize these settings using the cycle modifier buttons. Press the button for the desired modifier to open the modifier's screen. The washer automatically adjusts the water level for the type and size of wash load for best results and maximum efficiency. Due to the high-efficiency nature of this product, water levels may be much lower than expected. This is normal and cleaning/rinsing performance will not be compromised.

When you select a cycle, washing starts with the default settings. If needed, modify the cycle as shown below.

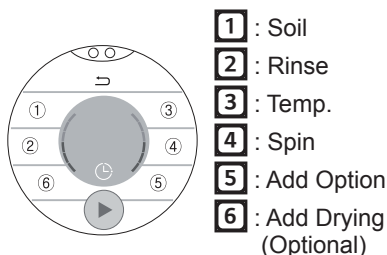

- 1** Press the **Power** button.
- 2** Select a washing cycle.
- 3** Select the options you want to change.
- 4** Change the options and press the **OK** button.
- 5** Press the **Start/Pause** button.

1 Soil

Adjusting the soil level setting will change the cycle times and/or wash actions. Touch the Soil button to open the modifier's screen and change the default soil level.

NOTE

- This feature needs more time for heavily soiled loads or less time for lightly soiled loads.

2 Rinse

This option adds an extra rinse to the selected cycle to help ensure the removal of detergent or bleach residue from fabrics. Liquid fabric softener, if used, is always dispensed in the final rinse. Touch the Rinse button to open the modifier's screen and add rinses to the cycle.

3 Temp.

Temp. selects the wash and rinse temperature combination for the selected cycle. Touch the Temp button to open the modifier's screen and change the default temperature setting. Cold rinses use less energy. The actual cold rinse temperature depends on the temperature of the cold water at the faucet.

The washer features a heating element to boost the hot water temperature for Extra Hot settings. This provides improved wash performance at normal water heater settings.

NOTE

- Select the water temperature suitable for the type of load you are washing. Follow the garment fabric care labels for best results.

4 Spin

Higher spin speeds extract more water from clothes, reducing drying time and saving energy. Touch the Spin button to open the modifier's screen and change the default spin speed. Some fabrics, such as delicates, require a slower spin speed. To protect your clothing, not all spin speeds are available for all cycles.

- The Rinse+Spin and Spin cycles are available in the last cycle category screen.

5 Add Option

Option settings may be different depending on the cycle.

Turbo Wash

Adding the Turbo Wash™ option reduces the cycle time while still providing similar wash performance to the same cycle without Turbo Wash™.

NOTE

- The Turbo Wash™ option cannot be used with all cycles.
- Turbo Wash™ defaults to on for Normal, Heavy Duty and Perm.Press wash cycles.

Prewash

Add the Prewash option to heavily soiled loads.

NOTE

- If you select Prewash after putting the detergent directly in drum, the detergent may be washed away, reducing the washing performance. For best results, use **Prewash** with the Auto Detergent function.

Hygienic Rinse

Use this option to improve cleaning or rinsing performance. The final rinse is heated to 104°F (40°C).

Fresh Care

Use this function when you won't be able to take out your clothes immediately after the wash cycle ends. After the cycle ends, the drum will tumble periodically for up to 19 hours to prevent wrinkles. Press the **Start/Pause** or **Power** button at any time to unload laundry.

NOTE

- To prevent tangling of your laundry, the tub will rotate for a certain period of time after spinning is finished.

6 Add Drying

Option settings may vary based on the dry cycle selected. Refer to the Drying Cycle Guide.

Air Cooling

Use this setting for air drying temperature sensitive items or to cool down clothes after drying, if they are too hot to handle.

Normal

Use the Normal Dry setting to dry normal fabrics.

Damp

Use Damp Dry to leave clothes slightly damp for easier ironing.

Energy Saving

Use this special setting to optimize energy consumption during drying.

Speed

Use Speed Dry to dry clothes more quickly.

Time Drying (30/60/90/120 min)

Time Dry allows you to manually set the dry time, from 30 to 120 minutes, in 30-minute increments.

Drying Cycle Guide

● = available option, ■ = default setting

| Cycle | Cycle Options | Wash Temp | Spin Speed | Soil Level | Delay Wash | Extra Rinse |
|-------------|--------------------------------|-----------|------------|------------|------------|-------------|
| Normal | Air Cooling | | Extra High | | ● | |
| | Normal | | Very High | | | |
| | Damp | | High | | | |
| | Energy saving | | | | | |
| | Speed | | | | | |
| | Time Drying (30/60/90/120 min) | | | | | |
| Outdoor | Air Cooling | | | | ● | |
| | Normal | | | | | |
| | Damp | | High | | | |
| | | | Medium | | | |
| | | | | | | |
| | | | | | | |
| Time Dry | Air Cooling | | Extra High | | ● | |
| | | | Very High | | | |
| | | | High | | | |
| | | | | | | |
| | | | | | | |
| | Time Drying (30/60/90/120 min) | | | | | |
| Wash+Dry | Air Cooling | Extra Hot | Extra High | Heavy | ● | ● |
| | Normal | Hot | Very High | | | |
| | Damp | Warm | High | Normal | | |
| | Energy saving | Cold | | | | |
| | Speed | Tap Cold | | Light | | |
| | Time Drying (30/60/90/120 min) | | | | | |
| Perm. Press | Air Cooling | | | | ● | |
| | Normal | | Very High | | | |
| | Damp | | High | | | |
| | | | Medium | | | |
| | | | | | | |
| | | | | | | |
| Delicate | Air Cooling | | | | ● | |
| | Normal | | | | | |
| | | | | | | |
| | | | Medium | | | |
| | | | | | | |
| | | | | | | |

Special Cycles/Features

After selecting a cycle, press the buttons to select additional features for your load.

Delay Wash

Once you have selected the cycle and other settings, press this button to delay the start of the wash cycle. Each press of the button increases the delay time by 1 hour, for up to 19 hours. Once the desired delay time is set, press the **Start/Pause** button to start the delay time.

Add Garments

Use this function to add garments or remove foreign objects like coins or keys after the cycle has started.

- 1 Press the **Start/Pause** button.
- 2 Press **Add Garments**. The cycle pauses and the door unlocks.
- 3 Open the door, add garments or remove foreign objects, and close the door.
- 4 Press the **Start/Pause** button again to continue the cycle. The cycle continues automatically.

NOTE

- After checking the water level/temperature conditions for safety, the door unlocks once the wash movement has stopped.
- This may take several seconds depending on the water level. When a lot of water is in the tub, the door unlocks after water drains to a safe level.
- If the temperature in the tub is higher than 113 °F (45 °C), a short warning chime sounds and Add Garments is not allowed for safety.
- Add Garments is disabled during the Tub Clean cycle or while a cycle is in Spin mode for safety.
- To preserve wash performance, wash time may be extended depending on when garments are added to a cycle.

WARNING

- Be careful when opening the door as wet laundry may drip or fall out when the door is opened.
- Do not attempt to force the door to open when locked. Doing so could result in damage to the machine, malfunction, or personal injury.

Drying Tips

Use the sensor dry cycles to dry most loads. Electronic sensors measure the temperature of the exhaust to increase or decrease drying temperatures for faster reaction time and tighter temperature control.

- Cold water tap must be left on during drying cycles.
- This washing machine's automatic process from washing to drying can be selected easily.
- For most even drying, make sure all articles in the load are similar in material and thickness.
- Do not overload the washing machine by stuffing too many articles into the drum. Items must be able to tumble freely.
- Remember to press Start/Pause to resume the cycle if you open the door to remove clothing before the cycle is finished.
- When "Cool Down" appears in the display, the dry cycle has finished and the dryer is air drying to reduce wrinkles. Press Start/Pause or the Power button at any time to remove clothing. If not stopped, the cool down will end after about 4 hours.

NOTE

- To spin clothes while drying, select the spin speed in the modifier screen for each dry cycle.
- Be careful when removing your clothing from the washing machine, as the clothing or washing machine may be hot.

Woolen Articles

- Do not tumble dry woolen articles. Pull them to their original shape and dry them flat.

Woven and Loopknit Materials

- Some woven and loopknit materials may shrink, by varying amounts, depending on their quality.
- Always stretch these materials out immediately after drying.

Permanent Press and Synthetics

- Do not overload the washing machine.
- Take out permanent press articles as soon as the washing machine stops to reduce wrinkles.

Baby Clothes and Night Gowns

- Always check the manufacturer's instructions.

Rubber and Plastics

- Do not dry any items made from or containing
 - aprons, bibs, chair covers
 - curtains and table cloths
 - bathmats

Fiberglass

- Do not dry fiberglass articles in the washing machine. Glass particles left in the washing machine may be picked up by your clothes the next time you use the washing machine and cause skin irritation.

Drying Time Guide

- Drying cycles can last up to about 7 hours.
- These drying times are given as a guide to help you set your washing machine for manual drying.
- If the load is not dry after the estimated time, the drying time is modified automatically and the new estimated time appears in the display.

NOTE

- The actual drying time may vary from the estimated drying time for the sensor dry cycles. Drying time is affected by the type of fabric, load size, and selected dry level.

Settings

Swipe down the display to open the Settings screen. Touch More Settings to reveal the entire Settings menu.

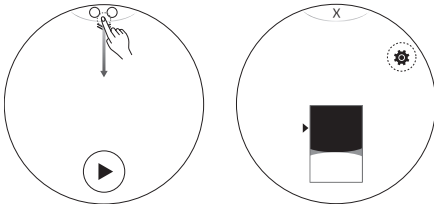

Control Lock

This option disables the controls and can prevent children from changing cycles or operating the machine. The feature does not lock the door. Once the Control Lock is set, it must be deactivated before any controls, except the Power button and Switching between Main Washer and Mini Washer, can be used. Once the washer has shut off, the Power button will allow the machine to be turned on, but the controls will still be locked.

Locking the Control Panel

Press Control Lock in the Settings screen to turn Control Lock on or off.

NOTE

- Turning off the power will not reset the Control Lock function. You must deactivate Control Lock before you can access any other functions.
- When Control Lock is turned on, the Wi-Fi icon on the display window is changed to the Control Lock icon.
- When Control Lock is turned on, you cannot operate any buttons except the Power button, the Settings drop down button, and the button to switch between the Main Washer and Mini Washer.

Unlocking the Control Panel

Press Control Lock in the Settings screen to turn Control Lock on or off.

Wi-Fi

Setup the Wi-fi connection. When Wi-Fi is turned on, the Wi-Fi icon appears in the display.

Remote Start

Use a smart phone to control the appliance remotely or check to see how much time is left in the cycle.

NOTE

- You must first connect to a gateway and register the appliance in order to use the Remote Start function. See the Smart Functions section for more details.

Using Remote Start

- 1 Press the **Power** button.
- 2 Load the laundry.
- 3 Swipe down from the top of the display to open the Settings screen and press **More Settings**. Press **Remote Start** in the Settings menu.

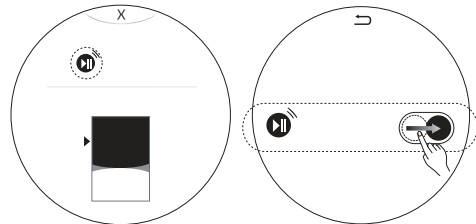

- 4 Start a cycle from the LG Smart ThinQ application on your smart phone.

NOTE

- Once the Remote Start mode is enabled, you can start a cycle from the LG Smart ThinQ smartphone application. If the cycle is not started, the machine will wait to start the cycle until it is turned off remotely from the application or the Remote Start mode is disabled.
- When Remote Start is turned on, the door is automatically locked.

Disabling Remote Start

To disable Remote Start, turn it off in the Settings screen.

NOTE

- Remote Start will not start if the door is open.

Auto Dispense

Use this button to setup and control the Auto Dispense function.

- When the Refill Alarm is turned on, it sends a message when the detergent or softener need refilling.
- The default settings are configured to automatically dispense 2.4 oz (70 ml) of detergent and 1 oz (30 ml) of softener for 8-12 lb (4 - 6 kg) of normally soiled laundry.

Changing Default Dispense Amounts

- 1 Press the **Power** button.
- 2 Swipe the display down to see the Settings screen and select **More Settings**. Select **Auto Dispense** from the Settings menu.

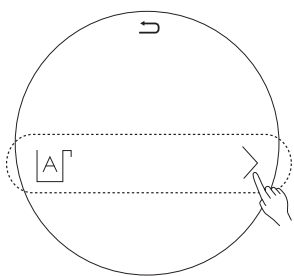

- 3 Turn on **Auto Detergent**.

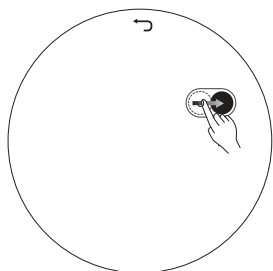

- 4 Change the default Auto Dispense amount as desired and press **OK**.

Sound

Use this option to turn on or off the sound when a button is pressed.

Brightness

Set brightness from 20% to 100%.

Language

Change the display language.

Time

Change the current time.

Summertime

Set the time for Daylight Savings Time.

Smart Diagnosis

Use this to help troubleshoot errors or malfunctions. See the Smart Diagnosis section for more details.

Washer Pairing (Optional) ↻

Select this to (un)pair the Main Washer and the Mini Washer.

- This option is available when the Main Washer is used with the Mini Washer.

- 1 Press the **Power** button.
- 2 Swipe the display down to see the Settings screen and select More Settings. Select Washer Pairing from the Settings menu.

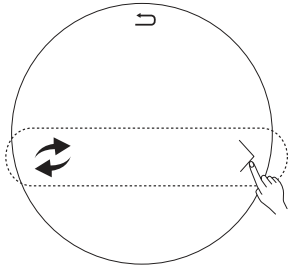

- 3 Press the **Pair** button.
- 4 When pairing is done, a popup window will appear in the display.

NOTE

- If pairing fails, follow these steps:

- 1 Make sure the mini washer is plugged in.
- 2 Reset the mini washer:
Press the **Power** button on the mini washer. Press and hold **Normal** and **Tub Clean** at the same time for 7 seconds.

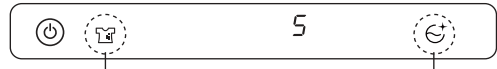

- 3 If pairing fails several times, reset both the main washer and mini washer.

See the Factory Data Reset section for instructions on resetting the main washer.

- When '0' appears on the display, repeat Step 2.
- When the reset is complete, a number that is '1' or above is displayed. Try pairing again by referring to Washer Pairing.

Switching Between Main and Mini Washer

When the main and mini washers are paired, this function allows you to switch the controls between the two washers. Swipe down to open the Settings screen to select Main Washer or Mini Washer.

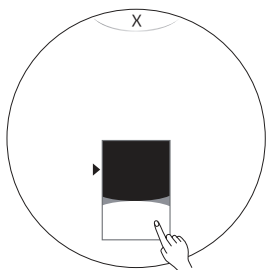

NOTE

- This feature is available only when the Mini Washer is connected.
- The cycles in Main Washer and Mini Washer are available at the same time and when both washers are running, the following display appears.

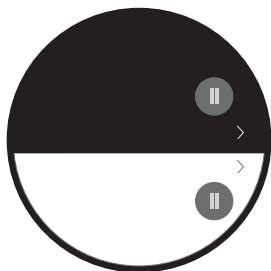

User Guide

Select this item to open instructions for operating the machine in the display window.

Program Update

Check to see if a newer version of the software is available.

Factory Data Reset

Select this to delete all the stored data and reset to the default settings.

- 1 Press the **Power** button.
- 2 Swipe down on the display to open the Settings screen and select **More Settings**. Select **Factory Data Reset** from the Settings menu.

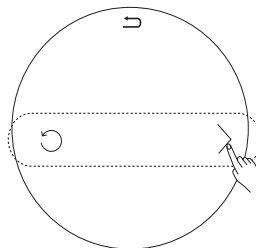

- 3 Press **Reset**.
- 4 Press the **Yes** button.

NOTE

- When a factory data reset is performed on the main washer, all data is deleted, including the Wi-Fi settings.
- The pairing can be delayed or fail due to communication problems between the Main Washer and Mini Washer or a Wi-Fi issue.

Download Cycles

This feature allows you to download new and specialized cycles that are not included in the appliance's standard cycles.

The appliance must be connected to the internet through a home Wi-Fi network to download cycles.

Downloading Cycles Using an Application

Follow these instructions after downloading and installing the LG Smart ThinQ application to your smartphone.

- 1 Press the **Power** button.
- 2 Using the LG Smart ThinQ app, check which cycles are currently downloaded.
 - If you try to download cycles on many different smart phones at the same time, the cycle displayed on your smart phone may be different from the actual cycle downloaded on the washing machine.
 - Press  in the application to check which cycle has been downloaded on the washing machine.
- 3 Select **Downloaded** button.
 - The available settings may vary depending on which cycle is downloaded.

NOTE

- You can download cycles after registering the appliance and configuring the Wi-Fi connection. For information on how to register the appliance and configure the Wi-Fi connection, refer to the Smart Functions section.
- Download desired cycles using the LG Smart ThinQ smartphone application. For more information on each cycle, refer to the application.
- Available cycles vary based on the washer model purchased.
- The downloadable cycles may change with updates to the LG Smart ThinQ application.

Downloading Cycles Directly

- 1 Press the **Power** button.
- 2 Swipe left on the display to get to the Download Cycles screen and press **Edit**.
 - You may need to delete one of the existing cycles to make room for a new downloaded cycle.
- 3 Press the add icon  to select a cycle to download.

Deleting a Downloaded Cycle

- 1 Press the **Power** button.
- 2 Swipe left on the display to get to the Download Cycles screen and press **Edit**.
 - You may need to delete one of the existing cycles to make room for a new downloaded cycle.
- 3 Press the  button on the cycle you want to delete.
- 4 Press the **OK** button.

SMART FUNCTIONS



Smart ThinQ Application

The Smart ThinQ application allows you to communicate with the appliance using a smartphone.

Installing Smart ThinQ Application

Search for the LG Smart ThinQ application from the Google Play Store or Apple App Store on a smart phone. Follow instructions to download and install the application.

Smart ThinQ Application Features

- For appliances with the  or  logo

Download Cycle

Set or download any preferred cycle and operate by remote control.

Tub Clean Coach

Check the appropriate Tub Clean period by washing frequency.

Energy Monitoring

Check the energy consumption of the recently used cycles and monthly average.

Smart Diagnosis™

This function provides useful information for diagnosing and solving issues with the appliance based on the pattern of use.

Settings

Various functions are available.

Push Alert

Turn on the Push Alerts to receive appliance status notifications. The notifications are triggered even if the LG Smart ThinQ application is off.

NOTE

- To verify the Wi-Fi connection, check that the **Wi-Fi**  icon on the control panel is lit.
- LG Smart ThinQ is not responsible for any network connection problems or any faults, malfunctions, or errors caused by network connection.
- The machine supports 2.4 GHz Wi-Fi networks only.
- If the appliance is having trouble connecting to the Wi-Fi network, it may be too far from the router. Purchase a Wi-Fi repeater (range extender) to improve the Wi-Fi signal strength.
- The Wi-Fi connection may not connect or may be interrupted because of the home network environment.
- The network connection may not work properly depending on the internet service provider.
- The surrounding wireless environment can make the wireless network service run slowly.
- This information is current at the time of publication. The application is subject to change for product improvement purposes without notice to users.

Wireless LAN Module

| | |
|---------------------|----------------------------------|
| Model | TWFM-K304D |
| Frequency Range | 2412~2462 MHz |
| Output Power (Max.) | IEEE 802.11 b : 19.58 dBm |
| | IEEE 802.11 g : 19.84 dBm |
| | IEEE 802.11 n(HT20) : 18.77 dBm |
| | IEEE 802.11 n (HT40) : 17.25 dBm |

ZigBee Module Specifications

| | |
|---------------------|-------------------------|
| Model | EBR81777301 |
| Frequency Range | 2405~2480 MHz |
| Output Power (Max.) | IEEE 802.11 b : 2.3 dBm |

FCC Notice

- For transmitter module contained in this product

This equipment has been tested and found to comply with the limits for a Class B digital device, pursuant to Part 15 of the FCC Rules. These limits are designed to provide reasonable protection against harmful interference in a residential installation. This equipment generates, uses, and can radiate radio frequency energy and, if not installed and used in accordance with the instructions, may cause harmful interference to radio communications. However, there is no guarantee that interference will not occur in a particular installation. If this equipment does cause harmful interference to radio or television reception, which can be determined by turning the equipment off and on, the user is encouraged to try to correct the interference by one or more of the following measures:

- Reorient or relocate the receiving antenna.
- Increase the separation between the equipment and the receiver.
- Connect the equipment to an outlet on a circuit different from that to which the receiver is connected.
- Consult the dealer or an experienced radio/TV technician for help.

This device complies with part 15 of the FCC Rules. Operation is subject to the following two conditions:

- 1) This device may not cause harmful interference and
- 2) This device must accept any interference received, including interference that may cause undesired operation of the device.

Any changes or modifications in construction of this device which are not expressly approved by the party responsible for compliance could void the user's authority to operate the equipment.

FCC RF Radiation Exposure Statement

This equipment complies with FCC radiation exposure limits set forth for an uncontrolled environment. This transmitter must not be co-located or operating in conjunction with any other antenna or transmitter.

This equipment should be installed and operated with a minimum distance of 20 cm (7.8 inches) between the antenna and your body. Users must follow the specific operating instructions for satisfying RF exposure compliance.

Industry Canada Statement

- For transmitter module contained in this product

This device complies with Industry Canada's applicable licence-exempt RSSs. Operation is subject to the following two conditions:

- 1) This device may not cause interference; and
- 2) This device must accept any interference, including interference that may cause undesired operation of the device.

IC Radiation Exposure Statement

This equipment complies with IC radiation exposure limits set forth for an uncontrolled environment.

This equipment should be installed and operated with a minimum distance of 20 cm (7.8 inches) between the antenna and your body.

NOTE

- The manufacturer is not responsible for any radio or TV interference caused by unauthorized modifications to this equipment. Such modifications could void the user's authority to operate the equipment.

Open Source Software Notice Information

LG Electronics will also provide open source code to you on CD-ROM for a charge covering the cost of performing such distribution (such as the cost of media, shipping, and handling) upon email request to opensource@lge.com. This offer is valid for three (3) years from the date on which you purchased the product.

To obtain the source code under GPL, LGPL, MPL, and other open source licenses, that is contained in this product, please visit <http://opensource.lge.com>.

In addition to the source code, all referred license terms, warranty disclaimers and copyright notices are available for download.

Smart Diagnosis™ Function

Should you experience any problems with the appliance, it has the capability of transmitting data via your telephone to the LG Customer Information Center. NFC or Wi-Fi equipped models can also transmit data to a smartphone using the LG Smart ThinQ application.

Smart Diagnosis™ through the Customer Information Center

- For appliances with the  or  logo

This method allows you to speak directly to our trained specialists. The specialist records the data transmitted from the appliance and uses it to analyze the issue, providing a fast and effective diagnosis.

- 1 Call the LG Electronics Customer Information Center at:
(LG U.S.A.) 1-800-984-6306
- 2 Swipe the display down to see the Settings screen and select **More Settings**. Select **Smart Diganosis** from the Settings menu and press the **Start** button.
- 3 When instructed to do so by the call center agent, hold the mouthpiece of your phone over the **Power** button. Hold the phone no more than one inch from (but not touching) the machine.

NOTE



- Do not touch any other buttons or icons on the display screen.

- 4 Keep the phone in place until the tone transmission has finished. The display will count down the time.
- 5 Once the countdown is over and the tones have stopped, resume your conversation with the call center agent, who will then be able to assist you in using the information transmitted for analysis.

NOTE

- Smart Diagnosis™ cannot be activated unless the appliance can be turned on using the **Power** button. If the appliance cannot be turned on, troubleshooting must be done without using Smart Diagnosis™.
- For best results, do not move the phone while the tones are being transmitted.
- If the call center agent is not able to get an accurate recording of the data, you may be asked to try again.
- The Smart Diagnosis™ function depends on the local call quality.
- Bad call quality may result in poor data transmission from your phone to the call center, which could cause Smart Diagnosis™ to malfunction.

Smart ThinQ Smart Diagnosis™

- For appliances with the  or  logo

Use the Smart Diagnosis feature in the Smart ThinQ application for help diagnosing issues with the appliance without the assistance of the LG Customer Information Center.

Follow the instructions in the Smart ThinQ application to perform a Smart Diagnosis using your smartphone.

NOTE

- Smart Diagnosis™ cannot be activated unless the appliance can be turned on using the **Power** button. If the appliance cannot be turned on, troubleshooting must be done without using Smart Diagnosis™.

MAINTENANCE

WARNING

To reduce the risk of fire, electric shock, or injury to persons, read and follow this entire owner's manual, including the Important Safety Instructions.

- Unplug the washer before cleaning to avoid the risk of electric shock. Failure to follow this warning can cause serious injury, fire, electric shock, or death.
- Do not use volatile substances (benzene, paint thinner, alcohol, acetone, etc.) or detergents with strong chemical components when cleaning the washer. Doing so may cause discoloration or damage to the machine, or may cause a fire.

NOTE

- Never use harsh chemicals, abrasive cleaners, or solvents to clean the washer. They will damage the finish.

Regular Cleaning

Care After Wash

After the cycle is finished, wipe the door and the inside of the door seal to remove any moisture.

- Leave the door open to dry the drum interior.
- Wipe the body of the washer with a dry cloth to remove any moisture.

Cleaning the Exterior

Proper care of your washer can extend its life.

Door:

Wash with a damp cloth on the outside and inside and then dry with a soft cloth.

Exterior:

- Immediately wipe off any spills.
- Wipe with a damp cloth.
- Do not touch the surface or the display with sharp objects.

Care and Cleaning of the Interior

- Use a towel or soft cloth to wipe around the washer door opening and door glass.
- Always remove items from the washer as soon as the cycle is complete. Leaving damp items in the washer can cause wrinkling, color transfer, and odor.
- Run the Tub Clean cycle once a month, or more often if needed, to remove detergent buildup and other residue.

Tub Clean Cycle

- Some environmental and usage conditions can cause a residue to build up in the drum over time and can lead to a mildewy or musty smell. Periodic use of this cycle helps to prevent mildew or a musty smell. Run the Tub Clean cycle once a month, or more often under heavy use conditions or if odor is present.

- 1 Remove any clothing from the tub.
- 2 Put in the manufacturer's recommended amount of a tub cleaning agent.
- 3 Close the door and press the **Power** button to turn the washer on.
- 4 Select the **Tub Clean** cycle from the download cycles to clean the drum.
- 5 Press the **Start/Pause** button to begin the cycle. Selecting any other cycle after Tub Clean has been selected will cause the Tub Clean cycle to be cancelled.
- 6 After the cycle ends, open the door and allow the drum interior to dry completely.

CAUTION

- If children are present, be careful not to leave the door open for too long.

NOTE

- Clean the drum regularly using the Tub Clean option for optimal washing. After approximately 30 cycles, the Main Washer Tub Clean notification will appear to inform that it is time to clean the drum.
- Once a Tub Clean cycle is run, the Main Washer Tub Clean notification will disappear until the next Tub Clean is due.
- To reset the Tub Clean notification without running a Tub Clean cycle, simply run a wash cycle.

| Cleaner | Instructions |
|------------------------|----------------------------------|
| Tub cleaner | Place directly into washer drum. |
| Lime scale remover | |
| Liquid chlorine bleach | |
| Powdered cleaner | |
| Cleaning tablets | |

NOTE

- Never load laundry while using Tub Clean. The laundry may be damaged or contaminated with cleaning products. Make sure to run the Tub Clean cycle only when the drum is empty.
- Leave the door open after finishing the laundry, to keep the drum clean.
- Tub Clean should be repeated monthly.
- If mildew or musty smell already exists, run Tub Clean once a week for three consecutive weeks.
- For other drum cleaning products, follow the cleaner manufacturer's instructions and recommendations.
- Do not exceed the manufacturer's recommended amount when manually dispensing powdered oxygen-based bleach or detergent. Powdered detergent may remain in the drum after cleaning.

Automatic Alert for Tub Clean

When the power is on and the 'Tub Clean' message blinks on the display, it means the washer drum needs cleaning. Use the Tub Clean cycle to clean the washer drum. The frequency of the automatic alert's appearance depends on how often the washer is used, however the message will generally appear every one to two months.

Removing Mineral Buildup

In areas with hard water, mineral scale can form on internal components of the washer. Periodically clean the mineral buildup on the internal components to extend the lifespan of the washer. Use of a water softener is recommended in areas with hard water.

- Use a descaler, such as Washer Magic®, to remove visible mineral buildup on the washer drum.

After descaling, always run the Tub Clean cycle before washing clothing.

- Mineral scale and other spots may be removed from the stainless steel drum using a soft cloth soaked in stainless steel cleaner.
- Do not use steel wool or abrasive cleaners.

NOTE

- If you use a descaler or tub cleaner during the Tub Clean cycle, use the Rinse+Spin cycle to rinse the washer drum before running your next wash cycle.

Cleaning the Door Seal

Clean the door seal once a month to prevent build-up of dirt.

- 1 **Wear rubber gloves and protective goggles.**
- 2 **Dilute 3/4 cup (177 ml) of liquid chlorine bleach in 1 gallon (3.8 L) of water.**
- 3 **Wipe around the door seal.**
Soak a sponge or a soft cloth in this diluted solution and wipe all around the door seal.
- 4 **Wipe dry.**
After cleaning, wipe up any moisture with a dry towel or cloth.
- 5 **Leave the door open to allow the door seal to dry completely.**

CAUTION

- Cleaning the door seal with undiluted bleach may cause malfunction of the door seal and washer parts. You must add water to the bleach before using it.

Cleaning the Water Inlet Filters

If the washer does not fill properly, an error message will show on the display. The inlet valve filter screens could be plugged by hard water scale, sediment in the water supply, or other debris.

CAUTION

- The inlet screens protect the delicate parts of the inlet valve from being damaged by particles that could enter the valves with the water supply. Operating the washer with these filters removed could cause a valve to stick open resulting in flooding and/or property damage.
- Do not use the washer without the inlet filters. If you use the washer without the inlet filters it will cause leaks and malfunction.
- If you use the washer in an area with hard water, the inlet filter may clog due to lime buildup.

- 1 **Turn off both water faucets completely.**
- 2 **Unscrew the hot and cold water hoses from the back of the washer.**
- 3 **Carefully remove the filters from the water valves.**
- 4 **Remove foreign objects and soak the filters in white vinegar or a lime scale remover.**
If using a lime scale remover, follow the manufacturer's instructions. Be careful not to damage the filters while cleaning them.
- 5 **Rinse filters thoroughly and press them back into place.**
- 6 **Flush then reattach the water hoses.**
Before reattaching the hoses, flush the hoses and water lines by running several gallons of water into a bucket or drain, preferably with the faucets wide open for maximum flow.

NOTE

- An '[IE]' message may blink on the display when the water pressure is weak or an inlet filter is clogged with dirt. Clean the inlet filter.

Cleaning the Drain Pump Filter

The washer fails to drain if the drain pump filter is clogged. Periodically clean the drain filter to prevent clogging with foreign objects.

! WARNING

- Opening the drain filter will result in water overflowing if there is water in the washer drum. Use a bucket if the drum is not completely drained before you open the drain filter.
- Using the washer without the drain filter or with an incorrectly assembled drain filter may cause leaks or malfunctioning of the washer.

- 1 Turn off the machine and pull out the plug.
- 2 Press on the circle to open the lower cover as shown below.

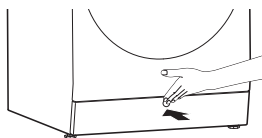

- 3 Unclip the drain hose and remove the plug from the drain hose to drain the remaining water.

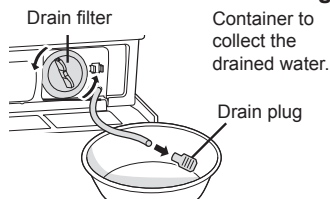

- 4 Clean the pump filter and opening. Twist the pump filter counterclockwise to remove.

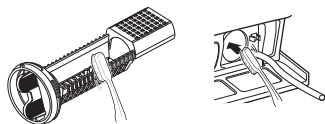

- 5 After cleaning, assemble the hose cap and the pump filter in the original positions.

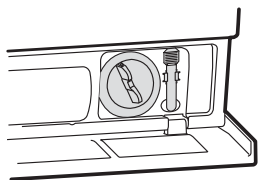

- 6 Close the lower cover.

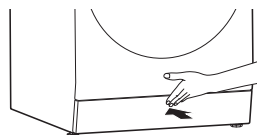

NOTE

- An '[OE]' message blinks on the display when the drain pump filter is clogged with dirt. Clean the drain pump filter.

Cleaning Auto Dispense Tray

Clean the Auto Dispense tray before refilling it or if detergent or softener have hardened with lack of use.

- 1 Press on the circle to open the lower cover as shown below.
- 2 Push in on the top of the Auto Dispense tray to slide it out and use the handle to remove the tray.

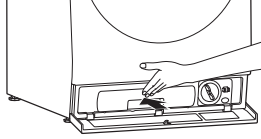

- 3 Turn the reservoir caps counterclockwise to remove them.

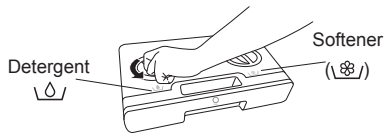

- 4 Turn the check valves on the back of the tray counterclockwise to remove them.

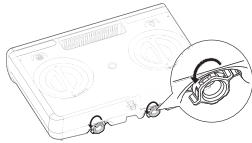

- 5 Clean the Auto Dispense tray and the check valves under running water.

- 6 Assemble the check valves by inserting them and turning them clockwise.
- 7 Fill the detergent reservoir with liquid HE detergent and the softener reservoir with liquid fabric softener. Insert the caps on the reservoirs and turn clockwise until tight.
- 8 Insert the Auto Dispense tray back in the machine until it clicks. Close the lower cover.

Care in Cold Climates

Storing the Washer

If the washer will not be used for an extended period of time and is in an area that could be exposed to freezing temperatures, perform the following steps to protect the washer from damage.

- 1 Turn off the water supply.
- 2 Disconnect hoses from water supply and drain water from hoses.

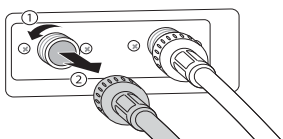

- 3 Plug the power cord into a properly grounded electrical outlet.
- 4 Add 1 gallon of nontoxic recreational vehicle (RV) antifreeze to the empty drum and close the door. Never use automotive antifreeze.
- 5 Press the **Power** button, then select **Spin**.
- 6 Press the **Start/Pause** button to start the drain pump.
- 7 Allow the drain pump to run for one minute, then press the **Power** button to shut off the washer. This will expel some of the antifreeze, leaving enough to protect the washer from damage.
- 8 Unplug the power cord, dry the drum interior with a soft cloth, and close the door.
- 9 Store the washer in an upright position.
- 10 To remove the antifreeze from the washer after storage, run a complete Speed Wash cycle using detergent.
Do not add laundry to this cycle.

When the Water Line is Frozen

- 1 Turn off the faucets connected with the water lines.
- 2 Pour hot water on the frozen faucets to thaw the water lines and remove them.
- 3 Immerse the water lines in hot water to thaw them.
- 4 Connect the water lines with the water inlets of the washer and with the faucets.
See Connecting the Water Lines for details.
- 5 Turn on the faucets.
- 6 Press the **Power** button.
- 7 Press the **Spin** cycle.
- 8 Press the **Start/Pause** button. Verify the water fills properly.

When the Drain Line is Frozen

- 1 Pour hot water in the washer drum and close the door. Wait for 1-2 hours.
- 2 Press the **Power** button after thawing.
- 3 Press the **Spin** cycle to select draining and spinning.
- 4 Press the **Start/Pause** button. Check to make sure the water drains.