

# STEALTH<sup>®</sup>

## TECHNOLOGY



## PRODUCT MANUAL

Installation Instructions, Troubleshooting Guide, and Warranty

For Models:

### STEALTH

- N7717 - Elongated Single Flush Bowl
- N7799 - Elongated Single Flush Bowl with Rear Outlet
- N7716 - Round Single Flush Bowl
- N7717EB - Elongated Dual Flush Bowl
- N7716RB - Round Dual Flush Bowl
- N7714 - Single Flush Tank
- N7715T - Dual Flush Tank

### ONE PIECE

- N7711 - One-Piece Toilet



**NIAGARA**  
CONSERVATION

[www.NiagaraCorp.com](http://www.NiagaraCorp.com)

# INSTALLATION INSTRUCTIONS

To insure proper installation carefully read these instructions and be sure you have the proper tools to complete the job. Vitreous china plumbing products are heavy and fragile. To avoid injury or damage, ask for assistance and handle with extreme care. During installation, make sure the plumbing system is vented adequately and that the soil pipe is clean.

Be very cautious when working with vitreous china plumbing products. Vitreous china can break and chip if you overtighten mounting bolts or nuts. Such breaks and chips are as sharp as glass and should be handled with care. Take care when handling these products.

## RECOMMENDED TOOLS:

- 1/2" x 9/16" Box or Open-End Wrench
- Adjustable Wrench
- Caulking
- Hacksaw
- Level
- Putty knife
- Screwdriver
- Tape Measure

## 1. TURN OFF THE MAIN WATER SUPPLY.

2.

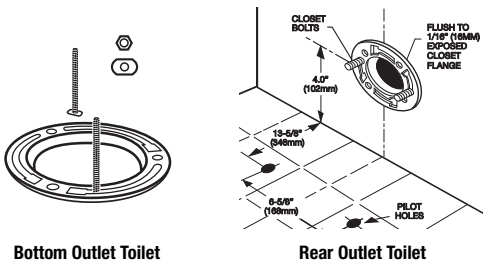

Install new "T" bolts with elongated brass flat washers and thin brass hex-head (jam) nuts.

3.

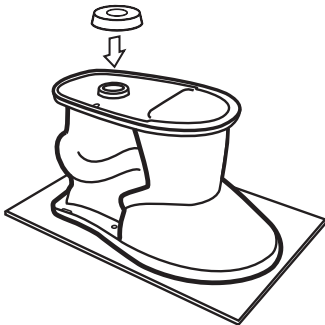

Remove the toilet from the box and set the toilet upside down on a soft surface. (You may use the box for this purpose.) Set the wax ring firmly in place around the outlet of the toilet.

4.



Carefully lower the toilet bowl onto the floor flange while aligning the "T" bolts through the two holes in the toilet bowl foot.

*For the Rear outlet toilet, position bowl squarely to wall and, with a rocking motion, push against ring and flange. Alternately tighten nuts until toilet is firmly anchored.*

**CAUTION: DO NOT OVERTIGHTEN NUTS OR BASE MAY BE DAMAGED!**

5.



Make sure that the toilet bowl is level. If the toilet tilts or is rocking, insert shims under the base.

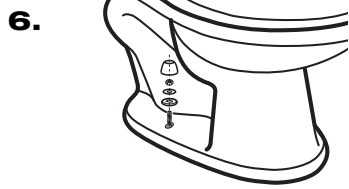

**6.** Install the plastic washer (be sure that the side marked “top” is facing up), round metal washer, and full hex nut. **DO NOT OVERTIGHTEN.** Cut off any excess bolt length and snap the bolt cap in place. Run a bead of caulk around the base of the toilet for a finished look and to meet plumbing codes.

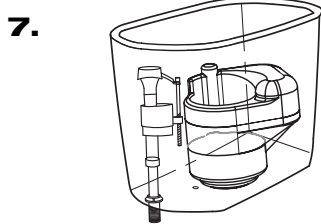

**7.** *(Skip this step for the one-piece toilet)*

Install the toilet tank. (The tank has been factory assembled and has the gasket between the bowl and the bottom of the tank and is ready to set in place.) Place the tank on the toilet bowl. Secure the tank in place with the two (2) metal washers and (2) nuts provided. **DO NOT OVERTIGHTEN.**



**8.** Connect the water supply to the toilet fill valve and hand tighten. Carefully connect the water supply to the shut-off valve.

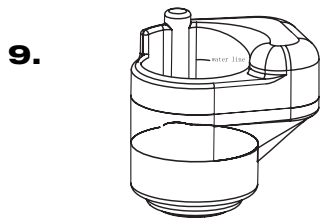

**9.** Open the shut-off valve slowly and check for leaks. Fill to the water line. Adjust the level, if necessary by turning the black screw on top of the float. Turn the screw to the right to lower the water level or to the left to raise the level.

**INSTALLATION AND ADJUSTMENT OF FLUSH BUTTON MECHANISM**

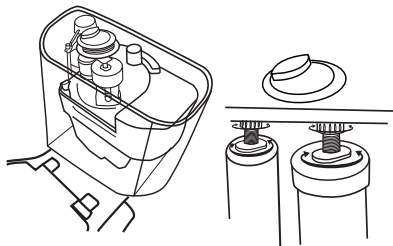

The flush button has been factory assembled in the tank lid. Secure the flush button mechanism into the tank lid by hand tightening the lock nut. The bottom of the push rods leading from the flush buttons should lightly touch, or slightly backed off from, the top of the flush valve.

**To increase the rod length,** turn the rod locknut clockwise to loosen, then rotate the push rod clockwise to increase exposed length. When desired length is achieved turn the rod locknut counter-clockwise, while holding the push rod, till it is tightened.

**To shorten the rod length,** turn the rod locknut clockwise to loosen, then rotate the push rod counter-clockwise decrease exposed length. When desired length is achieved turn the rod locknut counter-clockwise, while holding the push rod, till it is tightened.

NOTE: When activating the half flush mode, both buttons on the flush mechanism will depress. When activating the full flush mode (chrome button), only the chrome button will depress. The flush valve mechanism is setup to prevent the full flush from being activated when the green button is pushed. It is important that the flush rods have equal clearance to assure proper function of the half flush.

**TOILET SEAT INSTALLATION INSTRUCTIONS** (Seat included in Stealth All-In-One and UHET Kit models)

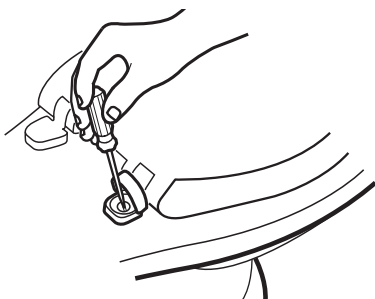

1. Place the seat on the toilet, aligning the holes of the seat with the holes in the back of the toilet bowl.
2. Insert the screw through the holes to secure it with the nut from the bottom of the toilet, with the nut's tapered end on top.
3. Secure nut from the bottom of the toilet, use a regular screwdriver to tight the fit. (See picture)  
CAUTION: DO NOT OVERTIGHTEN THE SCREW AS IT MAY CAUSE DAMAGE ON SEAT.
4. Push the decorative cap down.

# TROUBLESHOOTING GUIDE

---

## PROBLEM: POOR OR SLUGGISH FLUSH

**Possible Cause:** Water supply is blocked.

**Corrective Action:** Shut off water supply, disconnect supply and check water supply valve opening. (Valve is located on wall or floor).

**Possible Cause:** Water level is too low in tank.

**Corrective Action:** Adjust water level in tank to water level mark by turning adjustment screw on Fluidmaster™.

**Possible Cause:** Water supply valve is partially closed.

**Corrective Action:** Open supply valve.

**Possible Cause:** Partially clogged trapway or drain.

**Corrective Action:** Clear passage with an auger. If you are unable to clear blockage, please contact a plumber.

**Possible Cause:** Outlet is partially blocked by wax gasket.

**Corrective Action:** Lift toilet (if your toilet is a back outlet, pull from wall) and replace wax ring gasket.

## PROBLEM: FILL VALVE DOES NOT SHUT OFF

**Possible Cause:** Water level in tank is set too high.

**Corrective Action:** Refer to installation instructions (Step 8) to adjust the water lever.

**Possible Cause:** Debris lodged in the valve.

**Corrective Action:** Shut off water supply valve; remove front cap from the Fluidmaster™ valve by turning counterclockwise; turn water supply on very slowly and flush out the line.

**Possible Cause:** Fill valve seal may need to be replaced.

**Corrective Action:** Shut off water supply; remove the front cap from the Fluidmaster™ valve and replace the rubber seal disk.

## WARNING

*Do not place toilet bowl cleaner tablets in toilet tank. The use of these tablets in this manner may cause leakage and void warranty.*

# NIAGARA CONSERVATION WARRANTY INFORMATION

## Manufacturer's Limited Lifetime Warranty For Vitreous China Products

**PLEASE READ CAREFULLY AND RETAIN FOR YOUR RECORDS.** Niagara Conservation warrants its vitreous china products, excluding plumbing fittings and toilet tank trim products – (see specific warranty exclusions outlined below for these fill valve and flush valve assembly components) to be free from defects in materials or workmanship for the lifetime of this product to the purchaser starting from the date of purchase. Niagara Conservation promises to provide a replacement vitreous china part for any vitreous china part of this product that proves upon our inspection and from the date of purchase, to be defective in material or workmanship. All labor for uninstalling and reinstalling and transportation costs or charges incidental to warranty service is to be borne by the owner. Niagara Conservation provides no warranties, written or oral, beyond those contained in this document.

**EXCLUSIONS:** In no event shall Niagara Conservation be liable for incidental or consequential damages, for damages resulting from improper installation or for damages caused by handling, neglect, abuse or alteration. All implied warranties, including any warranty of fitness for any particular purpose of merchantability, or those that might arise from a course of dealing with the purchaser or usages of trade, are hereby disclaimed or excluded. Niagara Conservation warrants its toilet tank trim: fill valve and flush valve assembly and plumbing fittings products to be free from defects in material or workmanship for a period of ten years from the date of purchase. Niagara Conservation promises to provide replacement toilet tank trim product that proves, upon our inspection and within ten (10) years from the date of purchase to be defective in material or workmanship. All labor for de-installation and re-installation and transportation costs or charges incidental to warranty service is to be borne by the owner. Niagara Conservation shall not be responsible or liable for any failure or damage to its toilet tank trim, plumbing fittings or vitreous china products caused by the use of either chloramines or high concentration of chlorine, lime/iron sediments and/or other minerals not removed from public water during the treatment of public water supplies or caused by toilet tank type cleaners containing chlorine, calcium hypochlorite and/or other chemicals. Only those parts that were included in this toilet purchase are covered by warranty. If this purchase included a toilet seat, Niagara warrants the seat for one (1) year from date of purchase to be free from defect in material or workmanship.

**NOTE:** Some states do not allow limitations on an implied warranty, and some states do not allow exclusions or limitations regarding incidental or consequential damages, so the above limitations may not apply to you. This warranty gives you specific legal rights and you may have other rights which vary from state to state. No person is authorized to change, add to, or create any warranty or obligation other than set forth herein. This is our exclusive written warranty.

To obtain warranty service or a copy of the product warranty, contact your local dealer and/or the contractor from whom you purchased this product.



## WARRANTY REGISTRATION CARD

Purchaser's Name: \_\_\_\_\_

Address: \_\_\_\_\_

Phone: \_\_\_\_\_ Date Purchased: \_\_\_\_\_

Dealer Name: \_\_\_\_\_

Dealer Address: \_\_\_\_\_

Who installed the toilet? Plumber ( ) Self / Spouse ( ) Builder/New House ( ) Other ( )

\* Please provide installer's name and address (optional): \_\_\_\_\_

\_\_\_\_\_  
\_\_\_\_\_

### IMPORTANT

Warranty Registration card must be completed and returned to Niagara Conservation's address below along with proof of purchase for warranty to become effective.

Niagara Conservation  
ATTN: Customer Service Dept  
45 Horsehill Road, Ste 106  
Cedar Knolls, NJ 07927