

PARTS LIST FOR K1737-1 ALL-TERRAIN UNDERCARRIAGE ASSEMBLY

Index of Sub Assemblies
Illustration of Sub Assemblies
Index of Sub Assemblies
Illustration of Sub Assemblies
Index of Sub Assemblies
Illustration of Sub Assemblies
Index of Sub Assemblies
Illustration of Sub Assemblies

K1737-1 ALL-TERRAIN



K1737-1 ALL-TERRAIN UNDERCARRIAGE ASSEMBLY INSTRUCTIONS

WARNING

- Lift only with equipment of adequate lifting capacity.
- Be sure machine is stable when lifting.

FALLING EQUIPMENT can cause injury.

THIS UNDERCARRIAGE IS DESIGNED TO BE USED WITH THE RANGER 8, 9, 8+, 275, 200, 250, ZR-8, ZR-10, 305G, AND WITH THE DC600, DC655, CV 655, DC1000, AND MULTI-SOURCE. THESE WELDERS AS MOUNTED MAY BE EQUIPPED WITH THEIR STANDARD LINCOLN ACCESSORY SETS AND ANY OF THEIR STANDARD LINCOLN OPTIONS.

THIS UNDERCARRIAGE WAS NOT DESIGNED FOR THE MOUNTING OF OTHER EQUIPMENT AND ACCESSORIES OR TO BE USED FOR ANY OTHER MACHINE OR PURCHASE.

WHEN PARKING ON AN INCLINE, TURN THE WELDER AND UNDERCARRIAGE SO AS TO BE ACROSS THE SLOPE. THEN SET THE PARKING BRAKE ACTUATING LEVER COMPLETELY DOWN. PUSH AND PULL ON THE UNDERCARRIAGE HANDLE TO BE CERTAIN THAT THE UNIT WILL NOT ROLL.

BEFORE ASSEMBLY OF UNDERCARRIAGE, READ INSTRUCTIONS CAREFULLY.

- TOOLS REQUIRED:**
- PLIERS OR VISE GRIPS
 - RATCHET DRIVER
 - 3/8" - 1/2" & 9/16" SOCKETS
 - 1/2" & 9/16" OPEN END WRENCH
 - GREASE GUN
 - KNIFE OR CUTTERS

- PLACE FRAME ON TABLE.
- CLEAN ENDS OF AXLES AND INSERT THEM THRU THE APPROPRIATE HOLES.
- PLACE THE FOUR INNER COTTER KEYS INTO AXLE SHAFTS. RUN A SELF TAPPING SCREW THRU THE EYES OF COTTER KEYS AND INTO HOLES IN THE FRAME. BEND KEYS.
- PLACE FRAME WITH THE END OPPOSITE THE HANDLE END ON THE FLOOR. AND THE TOP OF THE FRAME LEANING AGAINST THE CORNER OF THE TABLE. FEED HANDLE THRU HOLES IN FRONT OF FRAME, AND PUSH HANDLE IN AS FAR AS POSSIBLE (THE HANDLE WILL BE OUT OVER THE TABLE). THE SCREW HOLES SHOULD BE NEARLY LINED UP WITH THE HANDLE AND FRAME.
- PUSH THE 5/16" X 1.50" BOLTS AND LOCKWASHERS IN THRU THE FRAME AND THE HANDLE. HOLD THE 5/16" NUTS WITH VISE GRIPS OR PLIERS AND START THE BOLTS INTO THE NUTS. TIGHTEN ALL.
- ASSEMBLE TO THE AXLES COTTER KEYS, WASHERS, WHEELS, WASHERS, AND COTTER KEYS.
- GREASE WHEELS. INFLATE TO 40-50 PSI.
- USING THE 3/8" X 1" BOLTS, 3/8" FLAT WASHERS, LOCK WASHERS, AND NUTS, ATTACH BRAKE ASSEMBLY TO APPROPRIATE HOLE AND SLOT (AT HOLE END, PLACE A WASHER BETWEEN ASSEMBLY AND FRAME. AT SLOT END, PLACE A WASHER BETWEEN ASSEMBLY AND FRAME. TIGHTEN BOTH FRAME MOUNTING BOLTS, LOWER AND RAISE THE ACTUATING ARM, CHECKING THE BRAKE OPERATION WITH THE ARM COMPLETELY DOWN.
- THE BRAKE PAD DRAGS ON THE TIRE. PRY IT ABOUT. *AWAY WITH A SCREWDRIVER OR WRENCH, THEN RECHECK BRAKE OPERATION.
- LOWER THE UNDERCARRIAGE TO THE FLOOR.
- ATTACH WELDER TO UNDERCARRIAGE WITH THE WELDER'S CONTROL PANEL FACING THE HANDLE. LOWER WELDER UNTIL ONE CORNER IS JUST TOUCHING THE UNDERCARRIAGE. START 3/8" X 1" BOLT, 3/8" LOCKWASHER, AND 3/8" NUT. LOWER SLIGHTLY AND START THE OPPOSITE CORNER. LOWER WELDER AND FINISH BOLTING. TIGHTEN ALL. (RANGER 8+ USES ONLY 3 NUTS AND BOLTS).

ITEM PART NO.	DESCRIPTION	QTY
1	L11152	FRAME ASSEMBLY
2	L11125	HANDLE
3	S24584	LIFTING HANDLE
4	T11772-3	16" WHEEL
5	T11772-2	10" WHEEL
6	M19396	AXLE
7	M19470	BRAKE ASSEMBLY
8	L11388PRINT	INSTRUCTIONS
9	CF000019	3/8-16 X 1.00 HEX HD. CAP SCREW
10	CF000067	3/8-16 HEX NUT
11	ET08A-16	3/8" LOCKWASHER
12	S8262-4	3/8" PLAIN WASHER
13	S10750-5	COTTER PIN
14	S8026-54	1/4 X .50 SELF TAPPING SCREW
15	S8262-24	1.00" PLAIN WASHER
16	CF000081	5/16-18 X 1.50 HEX HD. CAP SCREW
17	CF000063	5/16-18 X 2.00 HEX HD. CAP SCREW
18	ET08A-14	5/16" LOCKWASHER
19	CF000029	5/16-18 HEX NUT

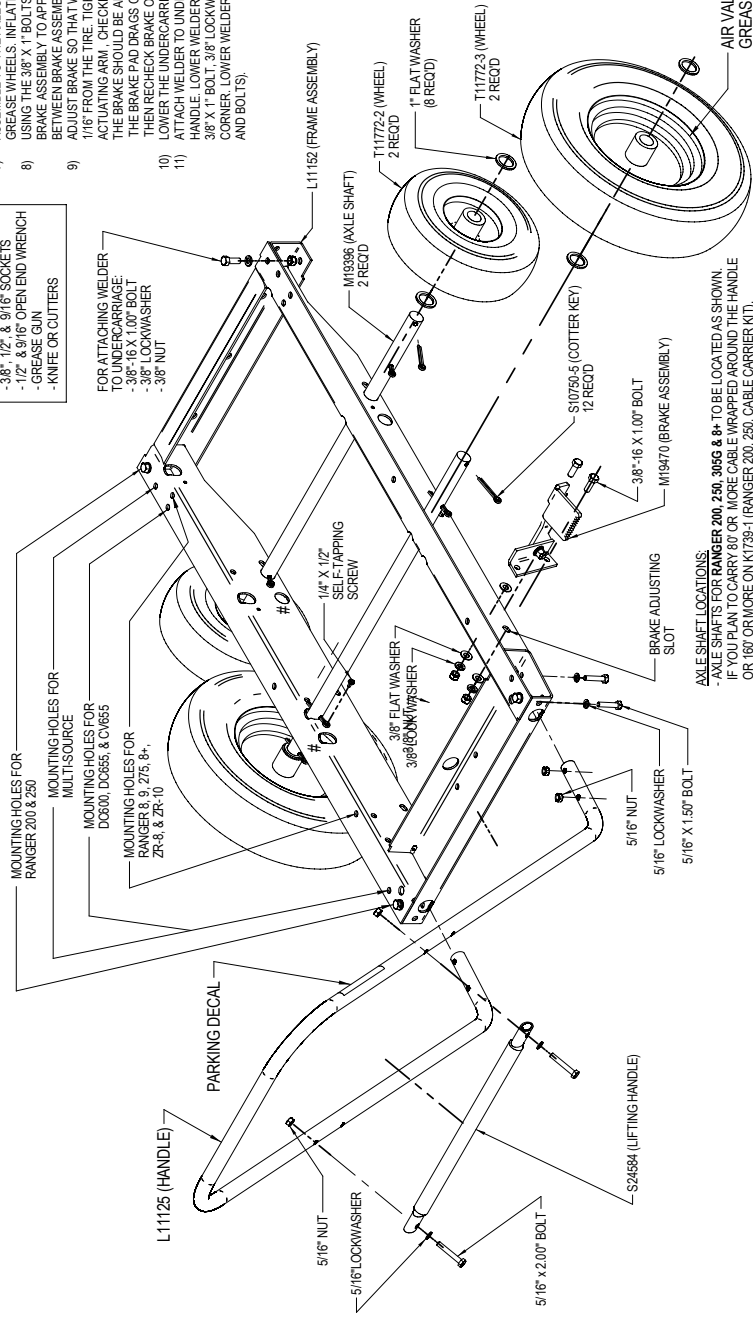

AXLE SHAFT LOCATIONS:

- AXLE SHAFTS FOR RANGER 200, 250, 305G & 8+ TO BE LOCATED AS SHOWN.
- IF YOU PLAN TO CARRY 807 OR MORE CABLE WRAPPED AROUND THE HANDLE OR 160 OR MORE ON K1738-1 (RANGER 200, 250, CABLE CARRIER KIT), USE HOLES DESIGNATED BY *.
- AXLE SHAFTS FOR RANGER 8, 9, 275, ZR-8, ZR-10, DC600, DC655, CV655, DC1000, AND MULTI-SOURCE TO BE LOCATED IN HOLES DESIGNATED BY #.

11-17-2000A
L11368



CLEVELAND, OHIO USA

