



# SPECIALTY CLOSET FLANGES OFFSET

Job Name _____	Item # _____
Location _____	
Engineer _____	Contractor _____
PO # _____	Tag _____
Representative _____	

## SPECIFICATIONS

Oatey specialty closet flanges shall be used in residential and commercial applications requiring offset adjustability from standard installation in DWV systems. These closet flanges offer the highest level of performance to build where structure impedes on building plan. Flange shall have a solvent weld connection over 3" Sch. 40 DWV hub connection which conforms to ASTM D2665 (PVC) or D2661 (ABS). Flange shall allow 1-1/2" offset in any direction, adjustable with 360 degree swivel ring made of 18 gauge corrosion resistant 430 stainless steel, and always anchored to floor with approved fasteners.

## MATERIALS

Flange Body	PVC, ABS
Flange Ring	18 Gauge 430 Stainless Steel

## LISTINGS & CODE APPROVALS



IAPMO File #2896 ASTM D2665
IAPMO File #3905 ASTM D2661

## DIMENSIONS

<b>A</b>	Hub Connection	3" & 4" Sch. 40
<b>B</b>	Offset Distance	1-1/2"
<b>C</b>	Mounting Hole Centers	6"
<b>D</b>	Opening Diameter	4"
<b>E</b>	Hub Depth	1-1/2"
<b>F</b>	Ring Diameter	7"
<b>G</b>	Overall Height	4-1/4"

## PRODUCT SELECTOR

NO HAMMER ARRESTORS		
✓	Product Number	Description
	43605	3"-4" PVC OFFSET CLOSET FLANGE W/ SS RING
	43606	3"-4" ABS OFFSET CLOSET FLANGE W/ SS RING

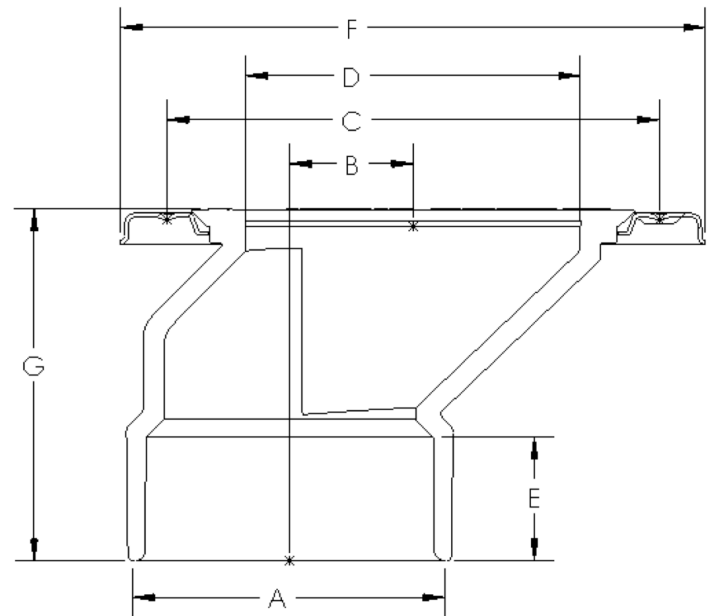

Access BIM/Revit content through [www.Oatey.com](http://www.Oatey.com)