



## Instruction Manual Tower Ceramic Heater



**Model : SH-1508**

It is important that you read these instructions before using your new purchase and we strongly recommend that you keep them in a safe place for future reference.

**Press main power switch on the bottom of unit after it is plug into an outlet.**

# Table of Contents

SPECIFICATIONS.....1

GENERAL SAFETY INFORMATION.....1

PARTS NAME.....2

ASSEMBLY AND USAGE.....2

LCD Display.....3

REMOTE CONTROL.....4

SAFETY FEATURES.....4

MAINTENANCE.....5

YOUR GUARANTEE.....6

## Specifications

<b>Model Number</b>	<b>SH-1508</b>
Dimension	8.7" x 8.7" x 23.8"
Heating Element	Ceramic
Safety	Power Indicator Light, Tip-Over Protection Shut-Off, Current Fuse, Thermostat, Thermal Cutoff
Rated Power	1,500W / 12.5A
Ion Function	Yes
Air Filter	Yes
LCD Display	Blue
Timer	7.5 hours
Color	Silver
Remote Control	64 °F - 90 °F
Approval	ETL

### General Safety Information

Read carefully attempting to assemble, install, operate or maintain the product described. Protect yourself and others by observing all safety information. Failure to comply with instructions could result in personal injury and/or property damage!

1. Read all instructions carefully before using the heater.
2. Use this heater only as described in this manual. Any other use not recommended by the manufacturer may cause fire, electrical shock, or injury to persons.
3. Remove the packaging and ensure that the heater is undamaged. In case of doubt, do not use heater and contact your supplier.
4. Do not allow children play with unit or packaging.
5. Before using the heater, check if the voltage marked on the rating label corresponds to the outlets in your home.
6. Extreme caution is necessary when the heater is used near children or individual and whenever the heater is left operating unattended.
7. Avoid using extension cords as the extension cord may overheat and cause a risk of fire.

8. Do not pull the power cord to disconnect from power source. Always grasp the plug to remove.
9. Do not insert any objects into the heater as it may cause an electric shock, fire, or damage to the heater. Do not block or tamper with the heater in any manner while it is in operation. To prevent a possible fire, do not block air inlet or outlet in any manner. Do not place on soft surface, like bed, where opening may become blocked.
10. Always unplug heater when not in use.

**WARNING:** The main power switch and the on/off switch should not be used as the sole means of disconnecting power. Always unplug the power cord before servicing or moving the unit.

11. This heater is hot when in use. To avoid burn, do not let bare skin touch hot surface. Always use handle when moving this heater. Keep combustible materials, such as furniture, pillows, bedding, papers, clothes and curtains at least 3 feet (0.9m) from the front of the heater and keep them at least 1 foot (0.3m) from the sides and rear.
12. The heater has hot and arcing or sparking parts inside. It must NOT be used in potentially dangerous location such as flammable explosive, chemical-laden or wet atmospheres. This heater is intended for general use only.
13. This heater is not intended for use in wet or damp locations. Never located a heater where it may fall into a bathtub or other water container.
14. Do not use heater outdoors.
15. This heater includes an audible alarm to warn that parts of the heater are getting excessively hot. If the alarm sounds, immediately turn the heater off and inspect for any objects on or adjacent to the heater that may cause high temperatures.

**DO NOT OPERATE THE HEATER WITH THE ALARM SOUNDING**

**WARNING:** To avoid danger of electric shock, unplug from outlet when not in use and before cleaning. If the supply cord is damaged, it must be replaced by a special cord or assembly available from the manufacture or it's service agent.

## PARTS NAME

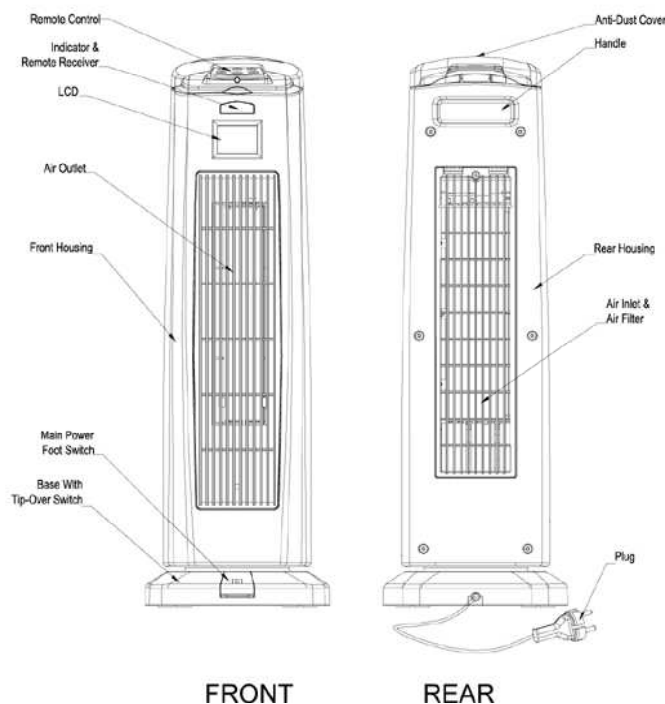

## ASSEMBLY AND USAGE

The heater may be operated by the manual controls located on the heater (as shown in FIGURE 1) or by your remote control (shown in FIGURE 7 ).

- Carefully remove the heater from the plastic bag and the carton.
- Assemble the two detached half pans and fasten the screws on the bottom of the pan (as shown in FIGURE 1). Place the heater on a stable flat surface.
- Plug the power cord into a power socket. Press down the Main Power Foot Switch to "On". The machine will "Beep", the LCD Display will illuminate and the red indicator light will be on. The red indicator light will remain on as long as the Main Power Foot Switch is on and the unit is plugged in

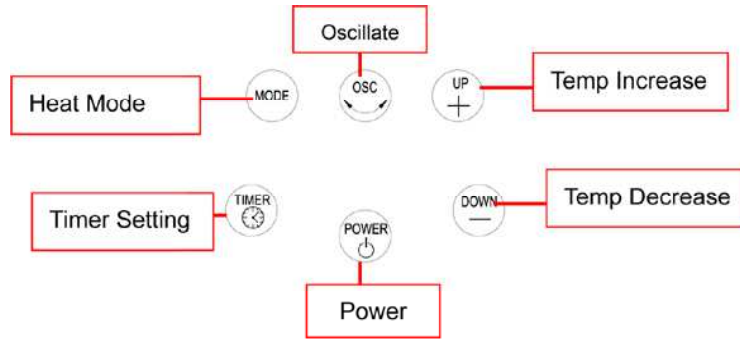

(FIGURE 1)

- POWER:** Using the control panel or remote: Press the POWER button to turn the unit on. The LCD backlight will illuminate and display the current settings. Note: The LCD backlight will fade after 15 seconds of inactivity.
- MODE:** Pressing the mode button will change the heater into a different mode: FAN, LOW HEAT, HIGH HEAT and AUTO (Shown in FIGURE 2)

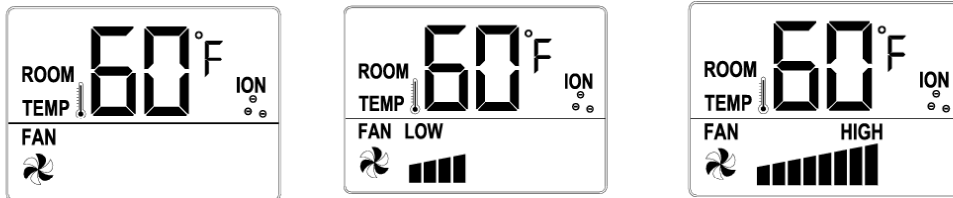

(FIGURE 2)

- TEMPERATURE ADJUSTMENT (AUTO MODE ONLY):** AUTO and Room Temp will be displayed. When adjusting the temperature the display will show SET TEMP. The LCD will continue displaying the ROOM TEMP about 10 seconds after setting is complete. (Shown in FIGURES 3 and 4)

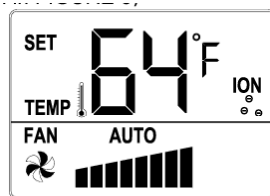

(FIGURE 3)

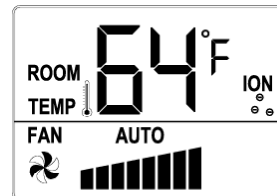

(FIGURE 4)

- A: Use the UP button to increase the desired SET temperature.  
 B: Use the DOWN button to decreased the desired SET temperature  
 C: The heat will cut off when the ROOM temperature reaches 1 degree above the SET temperature

D: The heat will turn on when the ROOM temperature drops 1 degree below the SET temperature

Note: It is normal for the heating element and fan to cycle ON and OFF as the heater maintains the SET temperature

7. OSC: Pressing the 'OSC' button will allow the heater to oscillate. To stop the oscillation, press the 'OSC' button once more. (Auto oscillation is 70 degrees and manual oscillation is 60 degrees). (FIGURE 5)

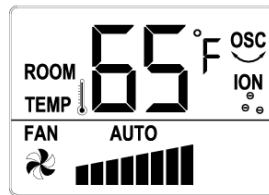

(FIGURE 5)

8. TIMER: The timer function allows you to set the length of operation from 0.5 hour to 7.5 hours. Pressing the 'TIME' button will increase the length of operation by 0.5 hour each time. (As shown in FIGURE 6)

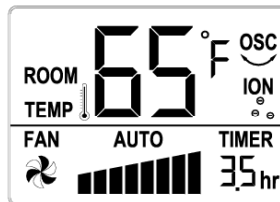

(FIGURE 6)

9. To turn the heater off, press the POWER button. The fan will continue to run for 30 seconds before fully turning off. NOTE: Do not use the Main Power Foot Switch until this cooldown has finished to avoid damage to the unit.

## REMOTE CONTROL

1. Install two "AAA" batteries as shown in FIGURE 7.
2. The Remote Control Power button is labeled as such. All the functions performed with the Remote Control work identically to the Manual Controls.

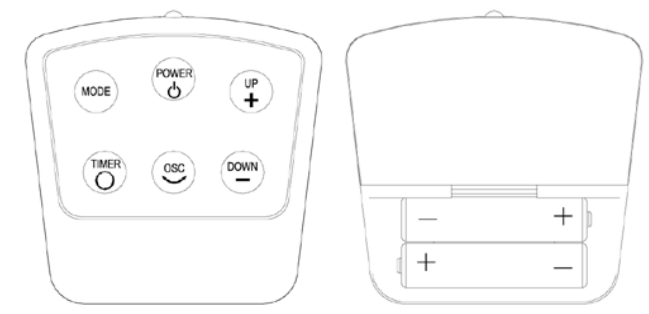

FIGURE 7

## SAFETY FEATURES

1. A thermal overload protector is built in to prevent overheating.
2. When an overheat temperature is reached, the heater will be automatically shut off. It can only resume operation when the user resets the unit. (See reset instruction below)
3. If the unit is tilted, a safety system will automatically cut off the power, put the unit in a vertical position and it will operate again.

**To Reset Heater:**

1. Unplug the heater and wait 5-10 minutes for the unit to cool down.
2. Then, turn on the unit again and operate normally.

4

**MAINTENANCE**

**WARNING:** ALWAYS UNPLUG THE CORD BEFORE MOVING OR SERVICING, DO NOT IMMERSE HEATER IN WATER.

**CLEANING:** IMPORTANT! DO NOT IMMERSE HEATER IN WATER!  
Take the Air Inlet and the Air Filter off, clean the Air Inlet with the vacuum brush attachment on your Vacuum cleaner, and wash the Air Filter in warm water and dry it. DO NOT DRY AIR FILTER IN DIRECT SUNLIGHT. Clean the body of the Heater with a soft cloth.

**CAUTION:** Do not use gasoline, benzene, thinner, harsh cleaners, etc. as they will damage the heater. NEVER use ALCOHOL or SOLVENTS.

**STORAGE:** Store the heater with these instructions in the original in a cool, dry place.

**DEFECTIVE NOTICE**

If this product is defective or not working properly  
Please DO NOT return to your retail store  
Please contact us directly with any Service or Technical Assistance  
Contact us toll free at:

**SUNPENTOWN INTERNATIONAL INC.**  
**1(800) 330-0388**  
**14625 Clark Ave. City of Industry, CA 91745**



## Your Guarantee

If this product is found to be faulty as a result of faulty materials or workmanship within one year from date of purchase, it will be repaired free of charge.

This guarantee is subject to the following terms:

- Sunpentown must be notified of the fault.
- Proof of purchase must be presented to Sunpentown's nominated representative.
- The warranty will be void if the product is modified, misused or repaired by an unauthorized person.
- The warranty after repair will not be extended beyond the original one-year period.
- All replacement parts will be new or reconditioned.
- Parts, which are replaced, become the property of Sunpentown.
- The warranty applies for the use of the product in the USA only.

### What is NOT COVERED:

- Warranty does not include freight charges.
- Damage due to installation error, product abuse and/or misuse.
- Incidental or consequential damage caused by possible defects with this product.
- Labor cost incurred for the installation and/or removal of a possible defective unit.
- Damage to product caused by improper power supply voltage, accident, fire, floods or acts of nature.
- Failure of product resulting from unauthorized modifications to the product.
- Improper installation or failure to perform the necessary maintenance.
- Normal wear and tear on parts or replacement of parts designed to be replaced.
- Damage to personal property from use of product.
- Replacement or repair of household fuses, circuit breakers, wiring or plumbing.

This GUARANTEE is in addition to your Statutory Rights

**SUNPENTOWN INTERNATIONAL INC.**  
**14625 Clark Ave. City of Industry, CA 91745**  
**Tel: 800-330-0388**  
**service@sunpentown.com**  
**[www.sunpentown.com](http://www.sunpentown.com)**