

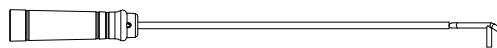

Item #1000 000 000
Model # FPW-304600

USE AND CARE GUIDE

DAVENPORT SLATE FIRE PIT

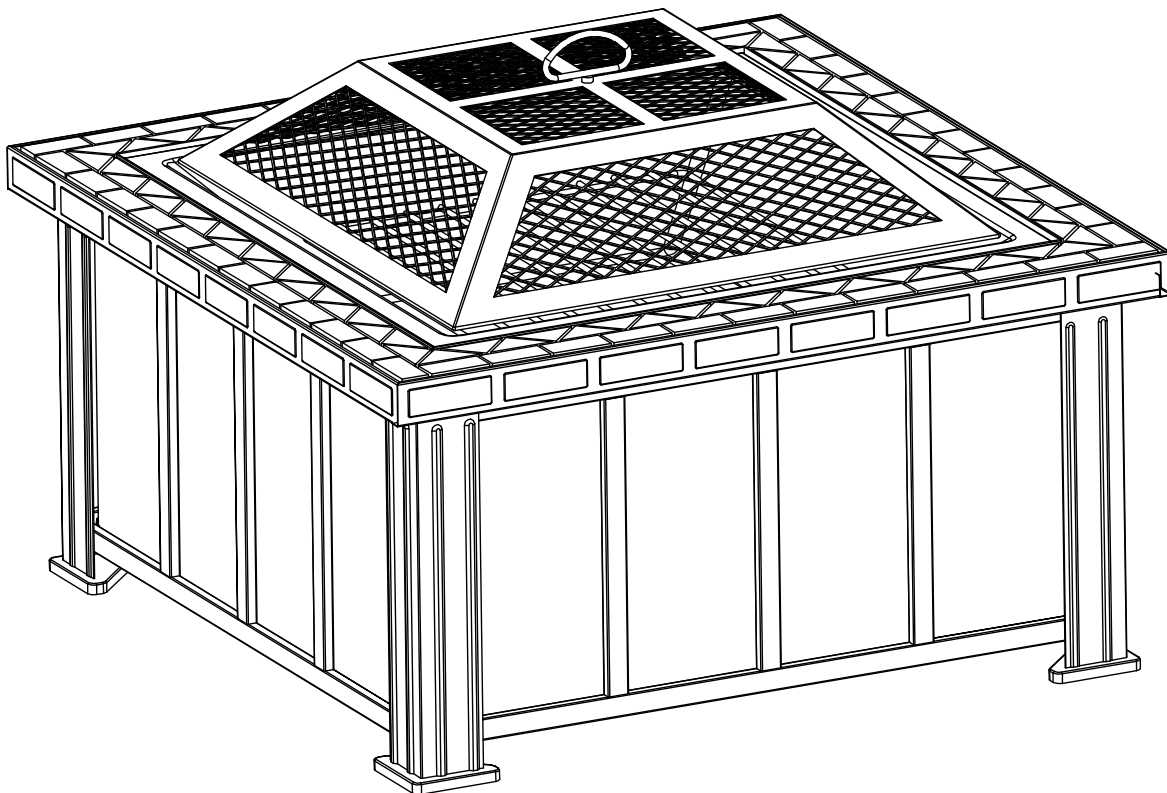

Questions, problems, missing parts? Before returning to the store,
call Hampton Bay Customer Service
8 a.m. - 7 p.m., EST, Monday – Friday, 9 a.m. – 6 p.m., EST, Saturday

1-855-HD-HAMPTON

HAMPTONBAY.COM

THANK YOU

We appreciate the trust and confidence you have placed in Hampton Bay through the purchase of this fire table. We strive to continually create quality products designed to enhance your home. Visit us online to see our full line of products available for your home improvement needs. Thank you for choosing Hampton Bay!

Table of Contents

Table of Contents	2
Safety Information	2
Warranty	3
Care and Cleaning	3
Pre-Installation	3
Hardware	3
Package Contents	3
Assembly	4

Safety Information



WARNING: Fire pit is for outdoor use only. Never leave a fire unattended. Do not allow children or pets near the fire pit without supervision. Do not use the fire pit to cook food. Lift mesh wire cover by using the poker when the fire pit is in use.



WARNING: Never leave the fire unattended.



CAUTION: Burn only wood or charcoal in the fire pit. Do not use gasoline or kerosene to start the fire in your fire pit. Use only an acceptable method of lighting the fire such as a match or lighter. Do not use the fire pit on a wood deck or other combustible surfaces such as dry grass, leaves, mulch, etc.



CAUTION: Place the fire pit no closer than 5 ft. from walls during use.



CAUTION: Do not attempt to move the fire pit while it is hot or in use.



WARNING: FUELS USED IN WOOD OR CHARCOAL BURNING APPLIANCES, AND THE PRODUCTS OF COMBUSTION OF SUCH FUELS, CAN EXPOSE YOU TO CHEMICALS INCLUDING CARBON BLACK, WHICH IS KNOWN TO THE STATE OF CALIFORNIA TO CAUSE CANCER, AND CARBON MONOXIDE, WHICH IS KNOWN TO THE STATE OF CALIFORNIA TO CAUSE BIRTH DEFECTS OR OTHER REPRODUCTIVE HARM. For more information go to: www.P65Warnings.ca.gov.

ADVERTENCIA: LOS COMBUSTIBLES USADOS EN EQUIPOS PARA QUEMAR MADERA O CARBÓN, ASÍ COMO LOS PRODUCTOS DE TAL COMBUSTIÓN, PUEDEN EXPONERTE A SUSTANCIAS QUÍMICAS, ENTRE ÉLLAS EL NEGRO DE HUMO Y EL MONÓXIDO DE CARBONO, QUE EL ESTADO DE CALIFORNIA RECONOCE COMO CAUSA, RESPECTIVAMENTE, DE CÁNCER Y DE MALFORMACIONES CONGÉNITAS Y OTROS DAÑOS AL SISTEMA REPRODUCTOR. Para más información, visite www.P65Warnings.ca.gov

Warranty

WHAT IS COVERED

This product is covered under a 2 year limited warranty against defects in materials and workmanship from the date of purchase.

WHAT IS NOT COVERED

This warranty does not cover damage due to neglect, abuse, or weather related damage.

Contact the Customer Service Team at 1-855-HD-HAMPTON or visit www.HAMPTONBAY.com.

Care and Cleaning

- Use a mild soap and water for normal cleaning. Do not use janitorial or alcohol-based cleaners. Some cleaners may be marked as natural, but ingredients may cause discoloration or have an adverse reaction to your finish.
- Rinse with clean water and dry with a soft, absorbent cloth towel.

Pre-Installation

PLANNING INSTALLATION

Assemble the product on a soft surface to prevent damage during assembly. Before assembling make sure all parts are present. Compare parts with the hardware and package contents list and diagram on page 3. If any part is missing or damaged, do not attempt to assemble the product or return to the place of purchase. Contact our customer service toll free at 1-855-HD-HAMPTON for replacement parts.

HARDWARE INCLUDED



NOTE: Hardware shown not actual size.

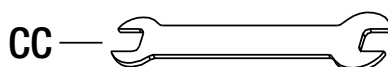
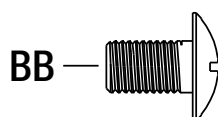
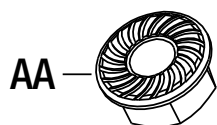

Part	Description	Quantity
AA	M6 Flange Nut	5
BB	M6 x 8mm Bolt	8
CC	Wrench	1

Pre-Installation (continued)

PACKAGE CONTENTS

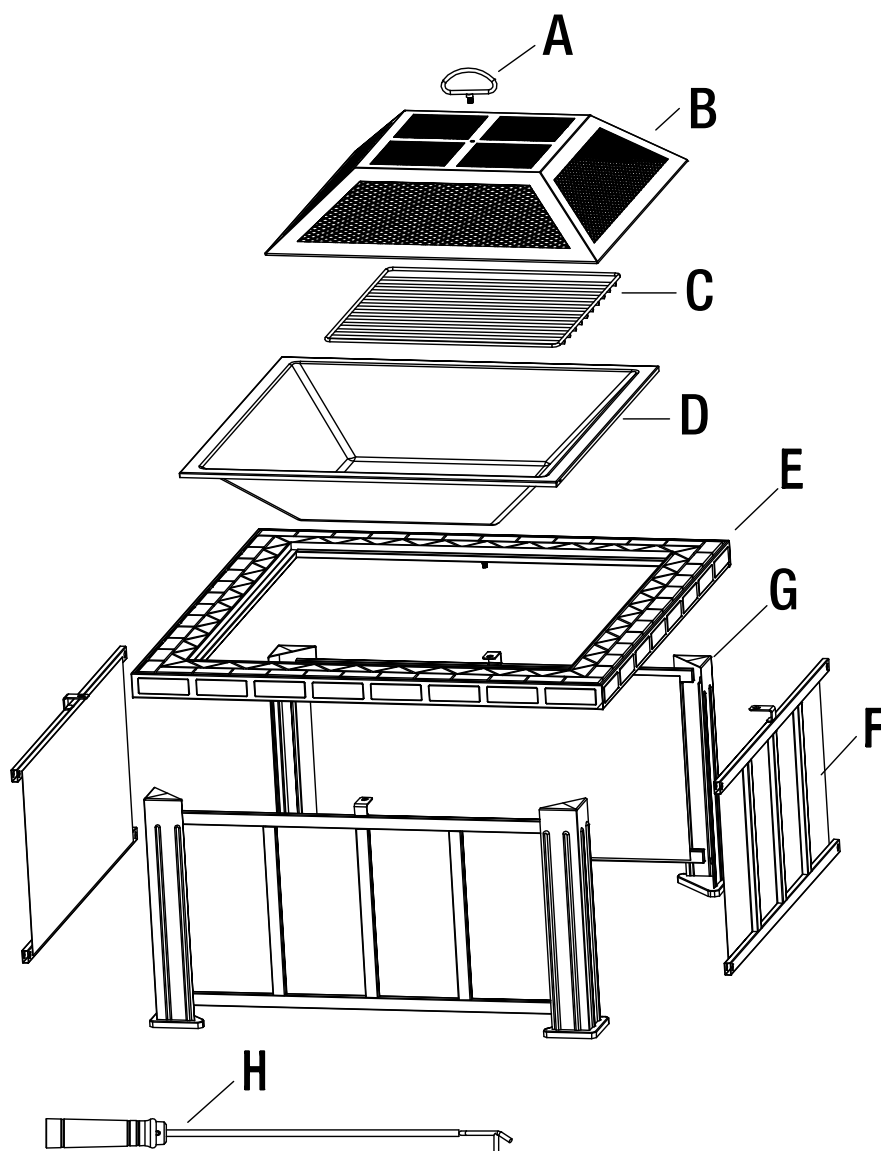

Part	Description	Quantity
A	Handle	1
B	Mesh Wire Cover	1
C	Grate	1
D	Fire Bowl	1
E	Tabletop	1
F	Panels	2
G	Panels with Legs	2
H	Poker	1

Assembly

1 Assembling the Lid

- Insert the handle (A) into the hole in the mesh wire cover (B).
- Secure with an M6 nut (AA) from underneath the mesh wire cover (B).
- Tighten with the wrench (CC).

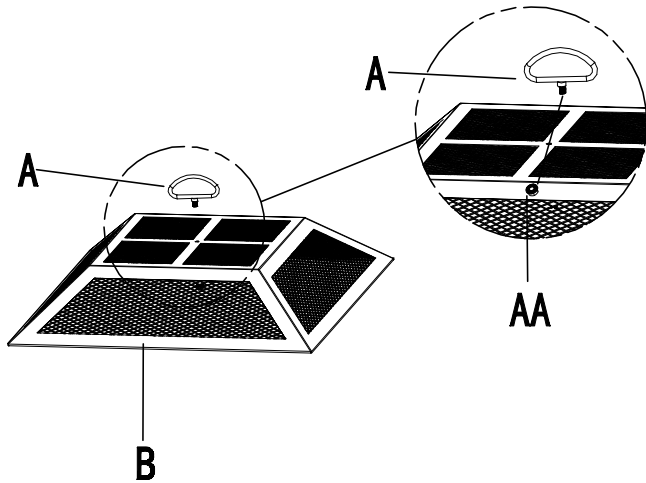

2 Assembling the Base

- Attach panels (F) to panels with legs (G) using the M6x8mm bolts (BB).
- Repeat for all four corners.

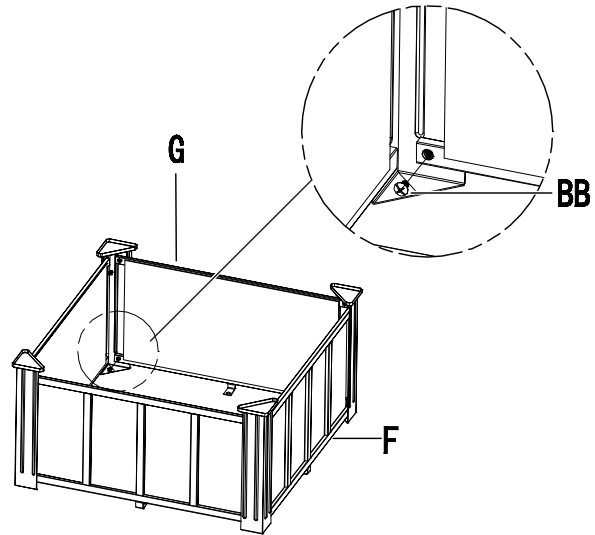

3 Assembling the Legs

- Turn the tabletop (E) over on a flat, clean surface.
- Attach the panels (F) and panels with legs (G) to the tabletop (E) using M6 flange nuts (AA).
- Tighten all connections.

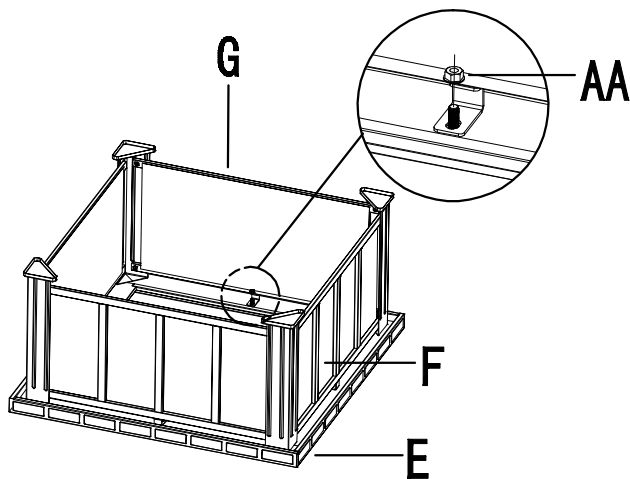

4 Completing the Assembly

- Turn the base over and place the fire bowl (D), grate (C), and mesh wire cover (B) within the fire pit.
- Keep the poker (H) near your fire pit for easy access.
- Your fire pit is now ready for use!

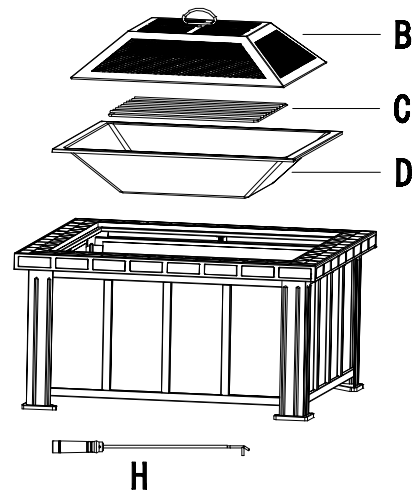



Questions, problems, missing parts? Before returning to the store,
call Hampton Bay Customer Service
8 a.m. - 7 p.m., EST, Monday-Friday, 9 a.m. - 6 p.m., EST, Saturday

1-855-HD-HAMPTON

HAMPTONBAY.COM

Retain this manual for future use.