

Manual Of Electronic Keypad Lock

I TECHNICAL PARAMETERS

- Working voltage: 5VDC
- Working current: $\leq 160\text{mA}$
- Static current: $\leq 120\mu\text{A}$
- Code capacity: 50 groups
- Code extent: 4~12 digits
- Unlocking time delay: 3 seconds
- Battery: 3.7V 18650 chargeable lithium battery
- Battery capacity: 2000mAh
- Alarm when the voltage $\leq 3.1\text{V}$
- Battery duration (fully charged): 6 months

II INSTALLATION

1. Lock Diagram (figure 1)

- ① Digital keypad
- ② Handle
- ③ Keyhole cover plate
- ④ Keyhole
- ⑤ USB interface
- ⑥ Double lock knob
- ⑦ Rotating wheel
- ⑧ Back panel
- ⑨ Front panel

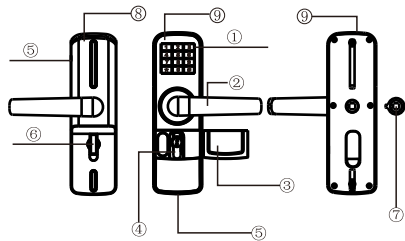

Figure 1

Note: There is a dot on the rotating wheel, please make sure it faces towards the handle when installing, otherwise the lock cannot work.

2. Installation for new doors

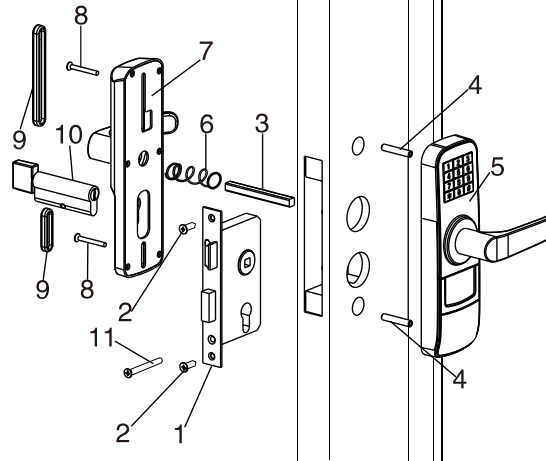

Figure 2

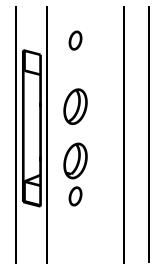

Figure 3

- ①. Please verify and drill out the door according to the installation diagram and figure 3.
- ②. Install the lock body: (figure 2)
Install the lock body "1" into the door hole and tighten it by screw "2".
- ③. Install the panels: (figure 2)
A. Take out the nut "4" from the fittings package and turn it to the stud of the front panel "5". (Note: Please make sure the round end is inward.)
B. Put the spring "6" into the hole of the back handle, inset the square pin "3" into the lock body "1", pull out the power wire of the back panel through the door hole, then align the panel hole to the square pin "3" and position the back panel on the door.

C. Align the front panel hole to the square pin "3" and position the panel "5" on the door, connect the wires.

D. Align the screw "8" to the screw hole of the front panel and tighten it.

E. Cover the black Silastic bar "9".

F. Insert the cylinder "10" into the lock body from the calabash shaped hole of the back panel, and tighten it by screw "11".

④. Activate the lock: (figure 4)

Use the suction cup "c" to separate the keyhole cover plate "a" from the front panel, and put the cover plate close to the "*" button of the digital keypad, you will see the blue backlight which shows the lock has been activated successfully.

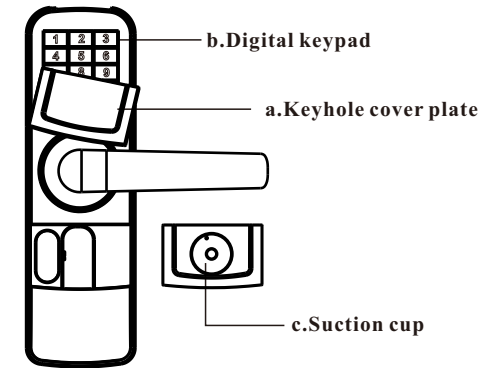
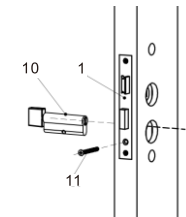

Figure 4

3. Installation for old doors

①. Dismantle the panels of the old lock, retain the lock body.

②. Install the new panels. (follow steps: 2 Installation for new door - ③ and ④)



III PROGRAMMING

Note: Before your programming, please put the keyhole cover plate close to the "*" button of the digital keypad to activate the PCB.

Programming code is "6668888", all operations of step 1-5 are need to be done under programming mode.

There is a super password function, it means you can input any numbers before or after the right code to open the lock.

After entering the programming mode, it will exit this mode automatically if no operation within 8 seconds .

1. Set up user codes

Press "*6668888#", then press "1", the red light will blink quickly, input a user code (4-12 digits), confirm with "#", then input for a second time, press "#" to confirm, a long beep means the new user code has been set successfully, short beeps for three times means failure.

Note: each user have an ID number, the system will automatically rank the ID number from 1-50.

2. Delete user codes

Press "*6668888#", then press "2", input the ID number or code you want to delete, press "#" to confirm,two short beeps means the code is deleted successfully, short beeps for three times means failure.

3. Delete all user codes

Press "*6668888#", then press "3", then press "333", a long beep for three times means all user codes are deleted.

4. Enable and disable of unlocking by two groups of codes

①. Press "*6668888#", then press "4", and then press "2", the function is enabled, in this mode, the lock need to be unlocked by 2 groups of codes.

②. Press "*6668888#", then press "4", and then press "1" to exit this mode, then each group of code is able to unlock the lock.

5. Quiet mode

①. Press "*6668888 #", then press "5",then press "2", a long beep means quiet mode has been set, in this mode, no prompt voice when operating.

②. Press "*6668888 #", then press "5", then press "1", a long beep means it has exit the quiet mode, there is prompt voice when operating.

6. Change the user code (no need to operate under programming mode)

Press "*", then press"#", input the old code and press "#" to confirm, then input the new code, press "#" to confirm, then input the new code again, press "#" to confirm, a long beep means the modify is successful, short beeps for three times means failure.

7. Change the programming code

Press "*",then press"#", input the old programming code and press "#" to confirm, then input the new code, and press "#" to confirm, then input the new code for a second time with "#" to confirm, a long beep means the modify is successful, short beeps for three times means failure.

8. Setting of normally open function

Input a code to unlock the lock, before the motor is reversed, press "#" for more than 2 seconds, you will hear 2 long beeps which means the setting is successful, the lock will keep unlocking, just turn the handle and open the door. In this mode, if you unlock the door with a code for one time, then the lock will back to the normal mode.

9. Factory default setting

Press the resetting button on the back panel for 1 second, you will hear a long beep, then all settings and data are deleted, the initial programming code backs to "6668888".

IV UNLOCK THE LOCK

1. From outside:

1.1 Input a code and "#", after a long beep, then turn the handle.

Super password function is available; it means you can input any numbers before and after the right code to open the lock. For example, if the code is 6668888, you can input 12366688886578 to open the lock.

1.2 Inset the key to the keyhole and turn 90°, then turn the handle.

2. From inside:

Just turn the internal handle and you can use the double lock knob to ensure safety.

3.Unlocking by two groups of codes:

Unlocking way: input the first group of codes, press "#"to confirm, red lights blink quickly means success, then input the second group of codes within 8 seconds. Press "#"again to confirm, a long beep and the voice of motor driving means success. Three short beeps means failure. There is also super password function for this unllocking mode.

V CHARGE

If the voltage is below 3.1V, you will hear short beeps for 6 seconds after unlocking; it prompts you to charge the battery. The backlight of "0" button will be in red when charging and when the backlight of "#" button is in blue, it means the battery is full (it will take about 5 hours).

Note: there are two charge ports, one is in the bottom of the front panel, and the other one is in the side of the back panel.

VI COMMON FAILURE AND MANAGEMENT

1. No response when press buttons

You need to activate the PCB to work at the first time. Please follow step 2 **Installation for new door -④**.

If still no response, please check whether wires of panels are connected well; also please check the power wire of the back panel.

2. A steady beep after unlocking

The battery voltage is too low. Please use a power bank or Android charger to charge the battery.

3. Cannot unlock after inputting code and turning the handle

Make sure your code is correct. The factory preset code is "6668888". If the code is correct, please check whether the rotating wheel is installed correctly. Installation methods please follow **1 Lock Diagram -⑦**.

VII ORIGINAL PACKING LIST

Front panel: 1 PC	Back panel: 1 PC
Lock body: 1 PC	Cylinder: 1 PC
Fittings: 1 Bracket	Screwdriver: 1 PC
Diagram: 1 PC	Manual: 1 PC