

# Singel Lever Basin Faucet

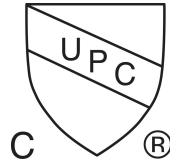

Model No.:YPG301

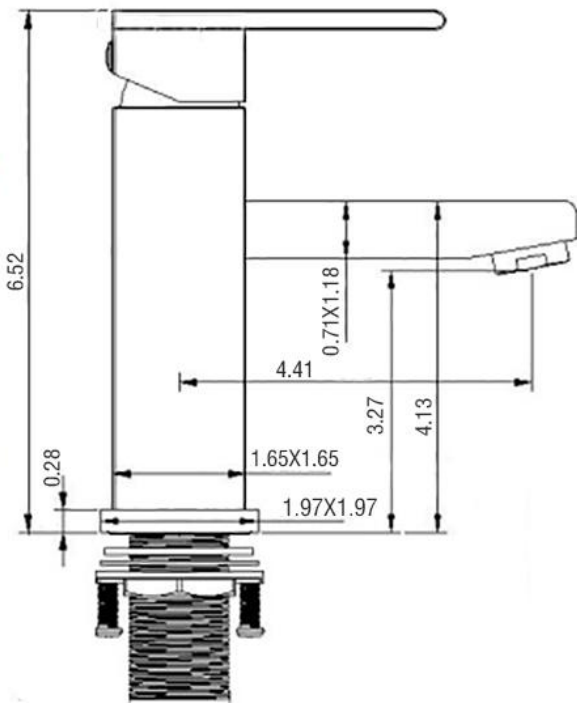

ALL SIZE IN INCH

## Features:

- 1.Material: low lead brass
- 2.Handle:zinc
- 3.Aetator:ABS
- 4.Valve: ceramic valve
- 5.100% pressure system tested.
- 6.CUPC approve

## Flow Rate:

1.2 GPM@ 60PSI

## Available Finishes:

Chrome

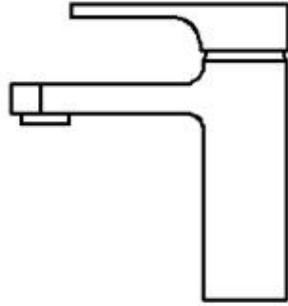

## Lavatory Faucet Installation

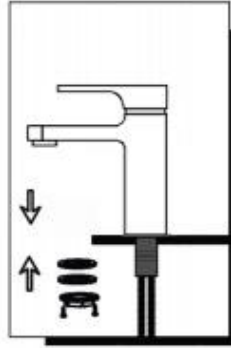

1. Install faucet through center hole, assembly washer and metal washer onto faucet, and tighten with lock nut.

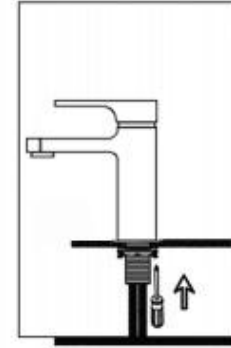

2. Tighten by screwing two screws if needed.

### INSTALLATION MANUAL

#### Tools You Will Need:



Plumber's putty



Pipe tape



Philips Screwdriver



Pliers



Adjustable wrench

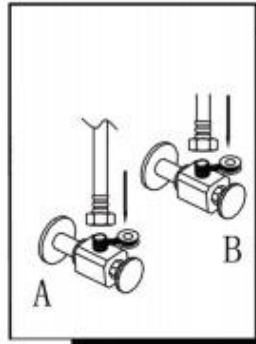

3. Attach two flexible hoses to water supply.

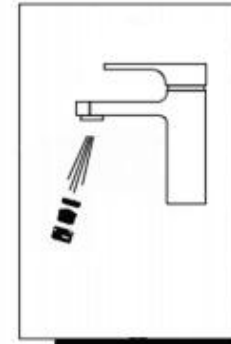

4. After installing faucet, remove aerator assembly and open the hot and cold water supplies. Check for leaks. Turn on faucet handle for one minute to flush debris from faucet. Close the handle and re-assemble the aerator.