

Please check contents **before assembly**. If any items are missing or damaged, **do not take the unit back to the store**. Call 1-800-427-5136 for customer service, we will save you time by correcting any problems directly for you.

Bench Components
(Quantities for 2 Benches)

4 - Leg Supports
2-Leg Spreaders
8 - Legs
2 Bench Tops

NOTE: Cracks or Checks in logs are part of the natural beauty of cedar logs and should not be considered defects.

Hardware & Tools
(Quantities for 2 Benches)

20- Screws
#2 Phillips Screw-driver
Rubber Mallet or Hammer w/ block of wood

NOTE: Using a battery Or electric power drill will make assembly easier and faster.

NOTE: Read all instructions before starting.

Helpful Tips:

- Use a rubber mallet (or a block of wood between the hammer and the unit) to drive doweled ends into holes as far as possible.
- If you have hardware left over after completing your unit, it most likely has been assembled incorrectly, and may not be safe to use. Please call Customer Service at 800-427-5136 for assistance.
- Use a good quality penetrating oil or wood deck sealer with a UV inhibitor and an anti-fungal.
- If staining or finishing before assembling, tape off all dowel ends. (Finishes will cause the dowels to swell, making assembly difficult.)

STEP 1 Insert a leg support into the hole of two of the legs. Next insert the leg support into the hole on the two remaining legs. Insert leg spreader into the hole on each of the leg supports. Use a rubber mallet to drive the leg assembly together. See figure 1.

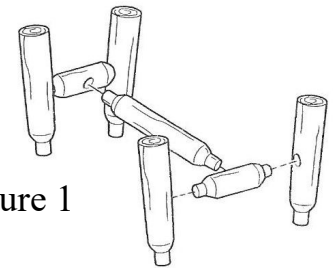

Figure 1

STEP 2 Place the bench top on a clean flat surface. Align the doweled ends of the leg assembly with the holes in the bench top as shown in figure 2.

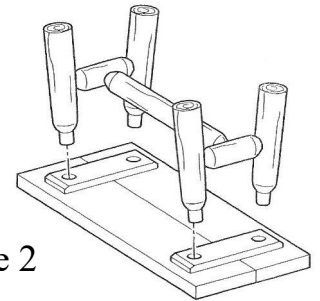

Figure 2

STEP 3 Secure dowel joints in place with screws perpendicular to the doweled end as shown in figure 3. Attach a screw in the areas indicated by arrows, on both ends.

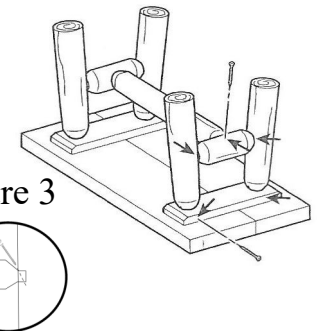

Figure 3

Your bench is now assembled and ready to use immediately, or a quality exterior penetrating finish can be applied.



Look for assembly videos on



<https://www.youtube.com/watch?v=2aIRcC09o2Q>