



Preparation

Tools Required for Assembly: (Not included)

- Pencil
- Electrical drill
- 1/4" Masonry drill bit (for tile anchor)
- Level
- Safety glasses

Items Included in the Package

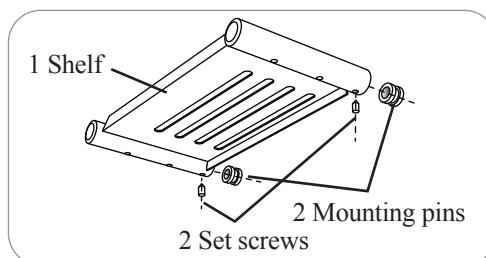

Installation Instructions

CAUTION: Tile anchors are for tile, granite, marble, cement surfaces only.

1. Hold the shelf up against desired position on wall.
Outline the end of the posts. **(Fig.1)** Use a level for accuracy.
2. Using the enclosed Allen Wrench, loosen two set screws at the end.
Remove two mounting pins from the posts. **(Fig.2)**
DO NOT loosen the other set screws.
Position the mounting pins inside the outlines drawn in Step 1.
Mark the holes as accurate as possible into the center. (Fig. 3)
3. Drill pilot holes into the tiles where the tile anchors will be inserted.
Use 1/4" Masonry drill bit. Insert tile anchors into the holes.

CAUTION: Accuracy is an essential part of a successful installation.
Make sure the holes are drilled straight as marked.

4. Place the mounting pins over the tile anchors.
Insert the enclosed screws over the mounting pins and tighten. **(Fig.4)**
5. Place the shelf over the mounting pins.
Use enclosed Allen Wrench to tighten the set screw. **(Fig.2)**

Care and Maintenance

To maintain the beautiful luster finish, please use soft damp cloths when cleaning and never use any cleaning solvents.

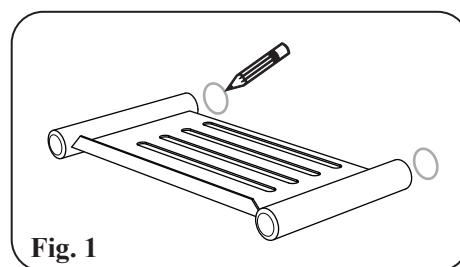

Fig. 1

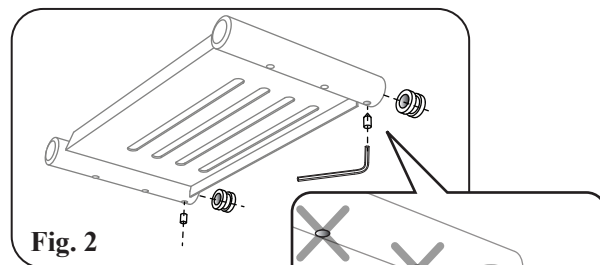

Fig. 2

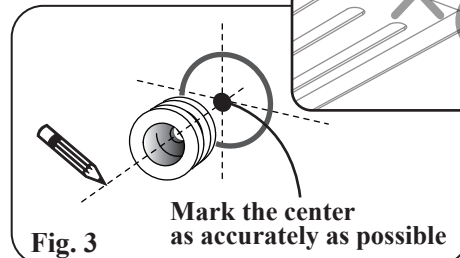

Fig. 3

Mark the center as accurately as possible

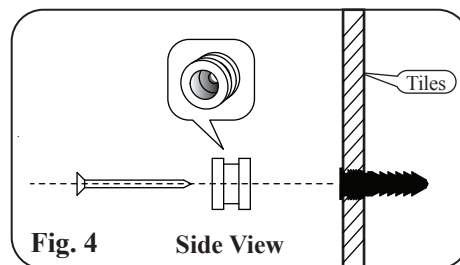

Fig. 4

Side View