

## WS-P-16 Guide: Getting Started

This portable water softener comes with new resin and is ready for use as soon as backwashing is completed.

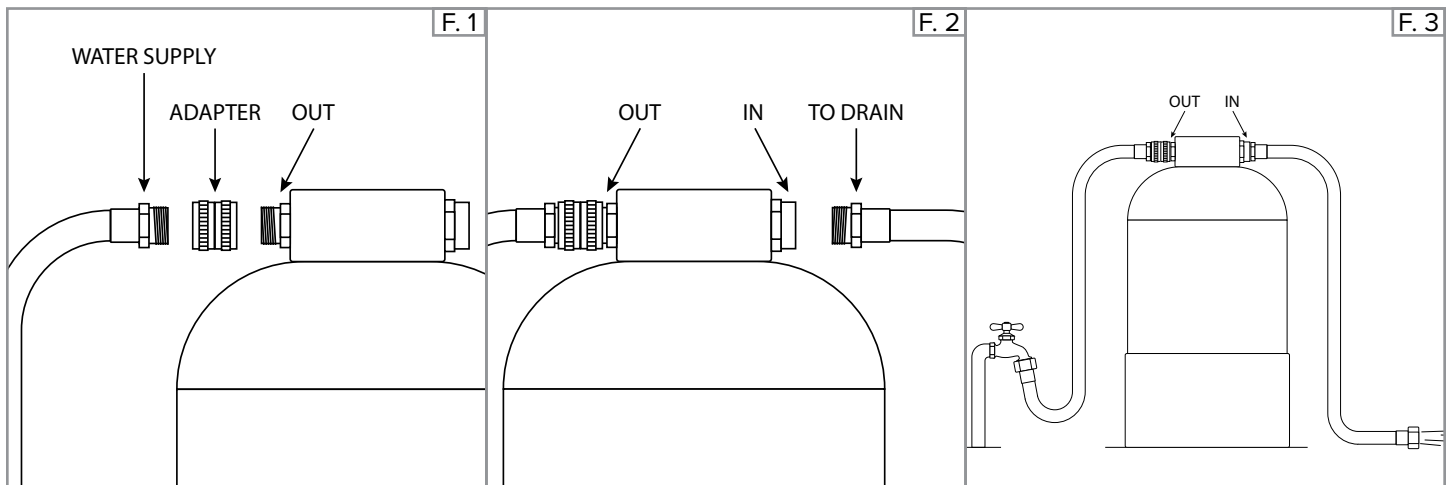

### Pre-Flush

1. Connect your incoming water hose to the "OUT" port on the unit. Use the supplied female fitting if needed. (F. 1)
2. Connect an additional garden hose to the "IN" port on the unit and run it to a drain, driveway or grass area. (Optional: if a garden hose is not available, place the unit on a flat surface or grass with area to release water). **Insure the unit is upright and leveled.** (F. 2)
3. Turn the water on and flush the unit for 5 minutes, until the water flows clear. During your first use/wash, you might see some color in your water. This is normal as the resin is new and will release particles on initial first flush. (F. 3)
4. Complete. You can now connect the unit.

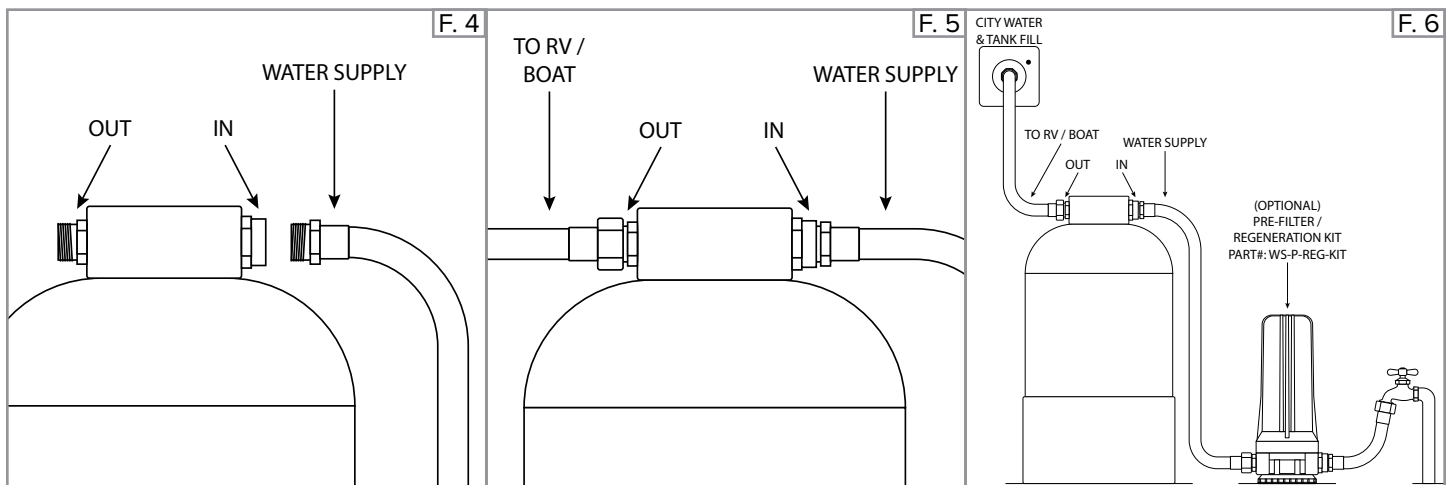

### Connecting the unit

1. Connect your incoming water hose to the "IN" port on the unit. (F. 4)
2. Connect a garden hose to the "Out" port on the unit. (F. 5)
3. Connect the other end of the hose to your "IN" port on your recreational vehicle. (F. 6)
4. If installing this unit for travel, ensure that the unit is secured to your recreational vehicle to avoid damage to the unit and to the inside of your recreational vehicle. Securing the unit with any strap, is recommended.
5. The unit must be installed upright - never install the unit on its side.
6. Complete. Your system is now ready to use.

## Regenerating Instructions Using the WS-P-REG-KIT Kit (Sold Separately)

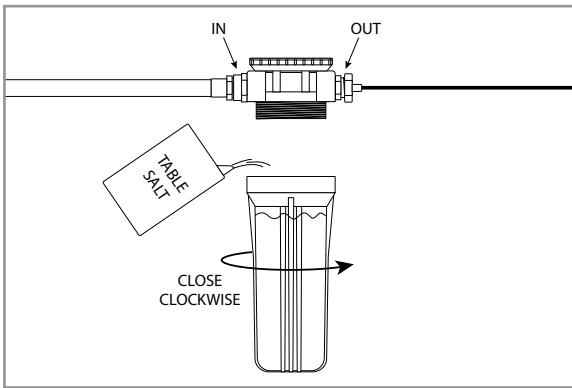

1. Remove pre-filter if installed. Fill the WS-P-REG-KIT housing with 3 - 4 lbs (2 boxes) of Standard Table Salt and close clockwise. Insure to clean salt from o-ring for a secure seal.
2. Connect the incoming water line to the "IN" port on the WS-P-REG-KIT housing.
3. Connect one end of the Brine Hose to the "OUT" port of the WS-P-REG-KIT housing.
4. Connect the other end of the brine hose to the "OUT" port of the WS-P-16 unit. Connection should be on the "OUT" to "OUT" ports.

5. Stand Regen Unit on floor.
6. Turn water on slowly until only a pencil size stream is slowly flowing from the unit for 20-30 minutes. This water contains high amounts of salt, **do not drain on grass, flowers or trees.**
7. After 20-30 minutes, turn water on all the way for an additional 10 minutes.

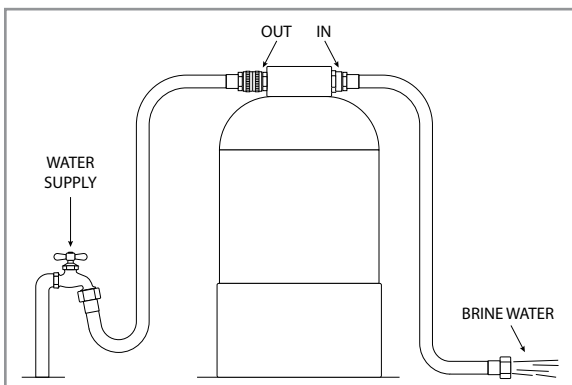
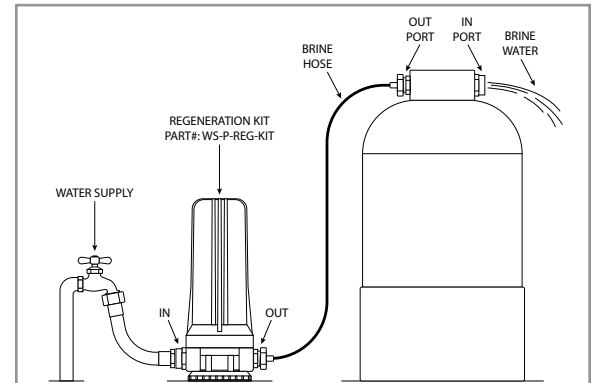

8. Turn off water and disconnect the incoming water line from the Regeneration Kit and connect it directly to the "OUT" port of the WS-P-16 unit then, turn the flow all the way on for 1-2 minute.
9. Once the unit has no salt water coming out, your unit is ready for use!
10. Rinse the WS-P-REG-KIT unit to remove remaining salt and place the pre-filter back in housing. The WS-P-REG-KIT can now be used as a pre-filter.

### Regenerating Instructions Without the WS-P-REG-KIT Kit:

1. Disconnect hoses and lay the unit on its side to drain water out, then stand upright.
2. Remove the head of unit by turning counterclockwise and pour 4 lbs of table salt directly into the unit.
3. Replace the head of the unit after salt has been added.
4. Let the unit stand for 40-50 minutes and agitate/shake every 10 minutes.
5. Connect your incoming hose to the "OUT" port on the unit. Connect an additional hose to the "IN" port on the unit or place the unit on a driveway if a hose is not available, insure the unit is upright and leveled. This water contains high amounts of salt, **do not drain on grass, flowers or trees.**
6. Turn water on slowly until only a pencil size stream is flowing from the unit for 10-15 minutes, then turn the flow all the way on for 1-2 minute.
7. Once the unit has no salt water coming out, your unit is ready for use!

### Tips

- Always regenerate before storing.
- Never let the unit freeze or dry out
- Divide 16,000 by your local water hardness to determine gallons between regenerations.
- Replacement Resin Part #: MED-CAT-025/2