

PRODIGY

User Manual

P700 / P770

Introduction

How to Use

Maintenance

Troubleshooting

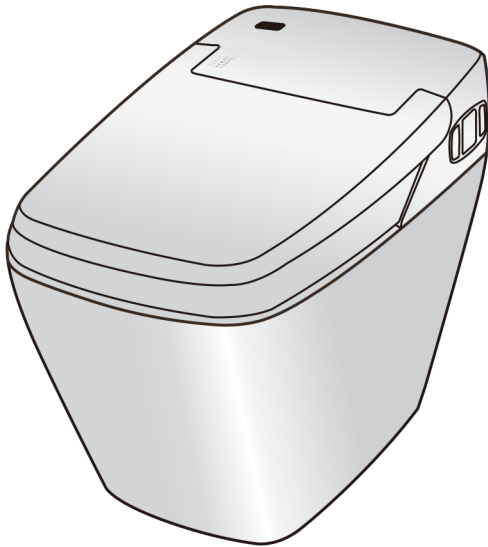

Please read this manual carefully for proper use.
This manual includes warranty and customer service information.

Table of Contents

Functions.....	3
Parts.....	4
Economy Features.....	6
Safety Guidelines.....	7
Preparing For Use.....	8
How To Use.....	10
Adjusting Temperature.....	11
Adjusting and Using Functions.....	12
Flushing.....	14
Maintenance.....	15
Troubleshooting.....	17
Warranty.....	21
Specifications.....	22

Functions

	Function	Descriptions
Standard	Posterior Wash	Cleanse posterior.
	Feminine Wash	Cleanse feminine area.
	Enema	Helps relieve constipation.
	Dry	Activates dryer.
	Water Pressure	Adjust water pressure.
	Nozzle Position	Adjust nozzle position.
	Oscillating	Cleanse with back and forth nozzle movement.
	Pulsating	Rhythmic stream of water for thorough cleansing.
	Rhythm	Combines oscillating and pulsating features.
	Seat Temperature	Adjust seat temperature.
	Water Temperature	Adjust water temperature.
	Dry Temperature	Adjusts dryer temperature.
	Remote Control	Operates all bidet functions.
	Operation Light	Indicates current operation. (power, seat sensor, power saving, seat temp, water temp)
Water Saving	Full flushing	1.6 gallon flush.
	Small flushing	1.05 gallon flush.
Comfort	Deodorant	Reduces bathroom odors.
	Remote Control Flushing	Full flushing and small flushing available by remote control.
	Auto Flushing	Automatically flushes the toilet when the user stands up.
	Auto lid OPEN / CLOSE (P770)	Stand in front of the toilet to automatically open the lid. Move away from the toilet to automatically close the lid.
	Night Light	Automatic sensors detect motion and activate the night light. This function can be enabled or disabled on the remote control.
Safety	Power Saving	Saves power when not in use.
	Antishort Circuit	Automatically turns off power when a short circuit occurs.
	Burn Protecting	Seat temperature turns off to protect user from burns after 30 minutes of use.
	Antibacterial	Specially coated nozzle, seat, and lid protects against bacteria.
	Emergency Button	Emergency button bypasses the remote control. (power, posterior, feminine, auto flush)
	Manual Flush Button	Activates a manual flush. Can be used during a power failure.
	Self Checking	Automatically detects any malfunctions before use.
Sanitary	Nozzle Cleaning	Automatically cleans nozzle before & after use.
	Nozzle Button	Extends nozzle for manual cleaning.
	Anti Pollutant Coating	Special non-stick coating on bowl.

Parts

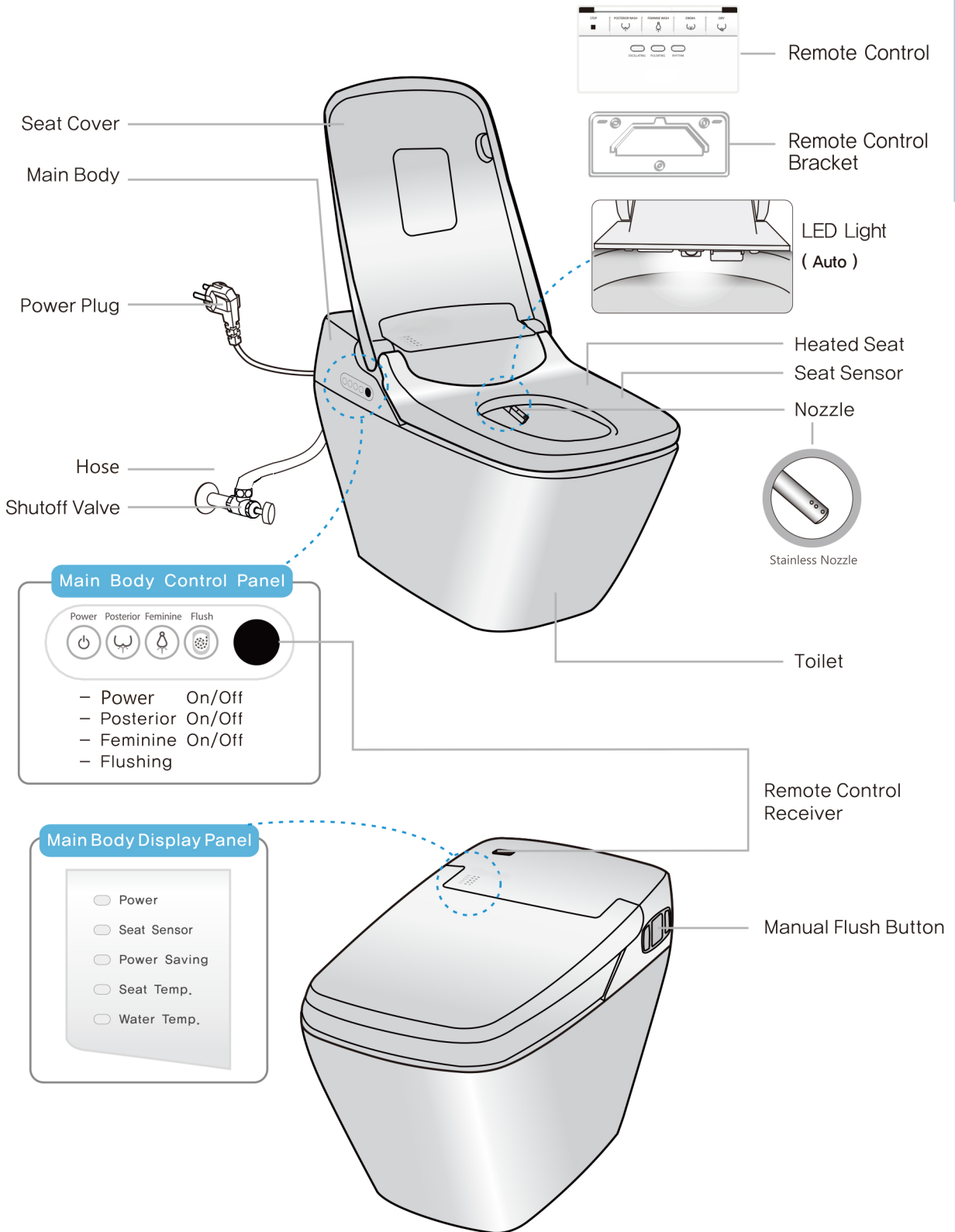

Remote Control

< TOP >

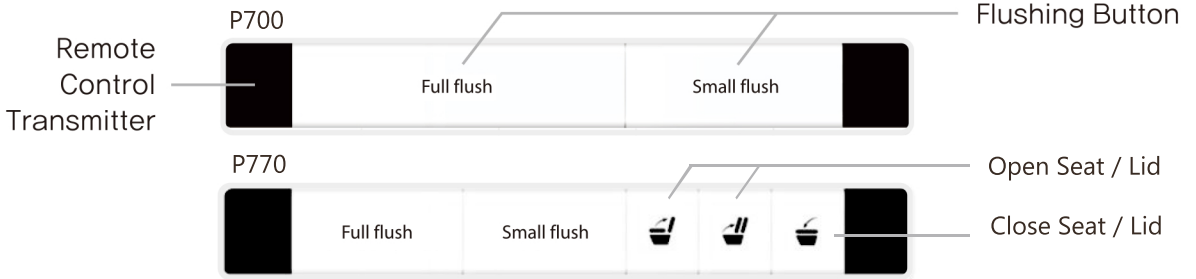

< COVER CLOSE >

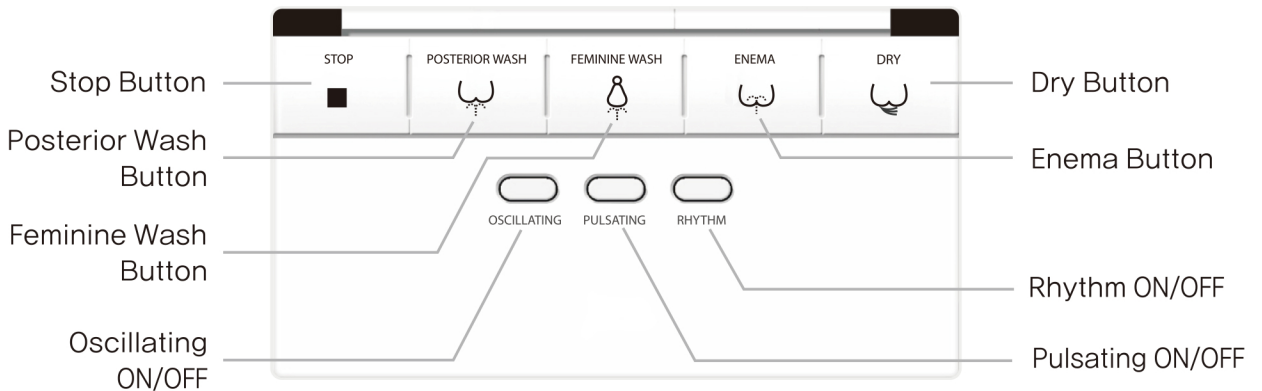

< COVER OPEN >

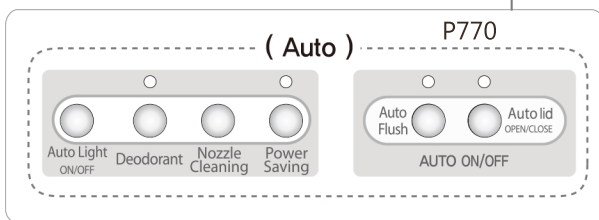
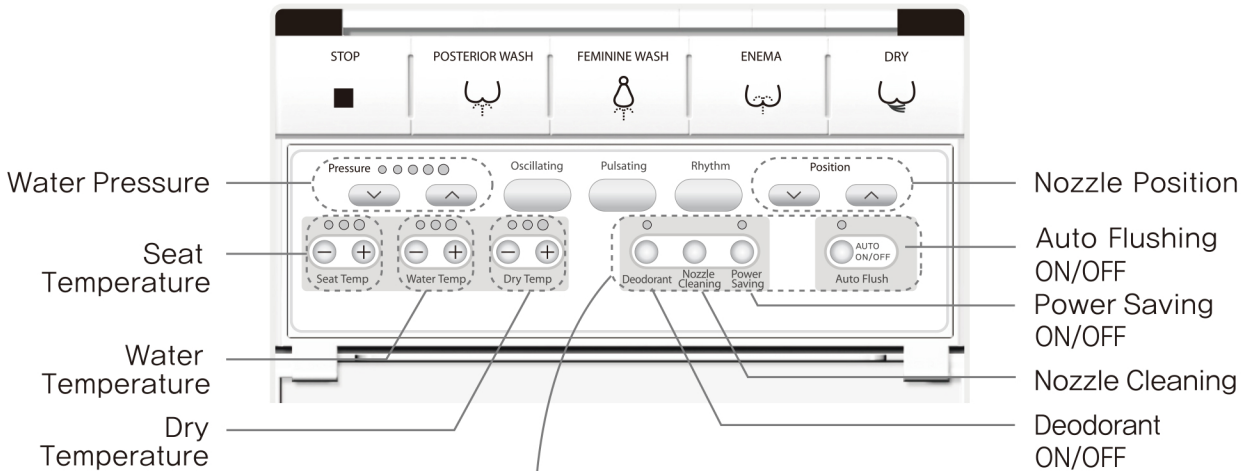

Economy Features

● Power Saving Mode

When active, the temperature will be maintained at 86°F. Using the seat disables this feature for one hour.

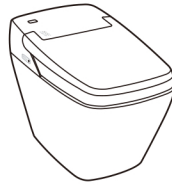

● Turn off the power during extended travel to save energy. (2+ days)



● Use the preferred flush button.

Save water by pressing the appropriate flush button for each use.

P700

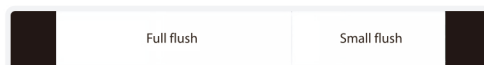

P770



Safety Guidelines



Warning



The following actions are not recommended and can cause product malfunctions and or safety hazards:

- Touching the power cord with wet hands.
- Placing fire sources near the product.
- Stepping on or placing heavy objects on the product.
- Blocking the dryer.
- Placing foreign objects into the toilet other than toilet paper.
- Cleaning the unit with harsh chemicals or detergents.

Notice: Observe electrical safety standards. Make sure the unit is properly grounded.

Discontinue use of the unit, unplug the power cable, and close the shutoff valve in any of the following circumstances:



- Water is leaking from the main body or hose connections.
- The product is broken, cracked, or producing an unusual sound.
- The product is overheating, or emitting smoke or a foul odor.

Continued use of the unit when it is not functioning properly can cause leaks or electric shock.

Connect the hose tightly to prevent leakage.

If water leaks, close the shutoff valve immediately.

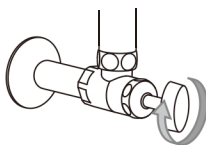

Turn the valve clockwise.

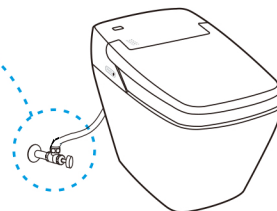

Make sure the temperature of the bathroom does not fall under 40°F. When water freezes, it can break the water supply line or internal components and cause malfunctions.

Preparing For Use

Notice

Turn off the power  on the main body when replacing batteries or cleaning the product.

1 Place the batteries into the remote control

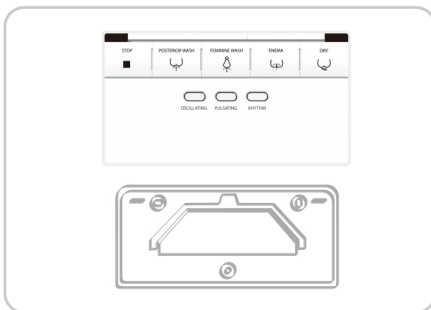

1. Remove the remote from the bracket by holding both sides and lifting up.

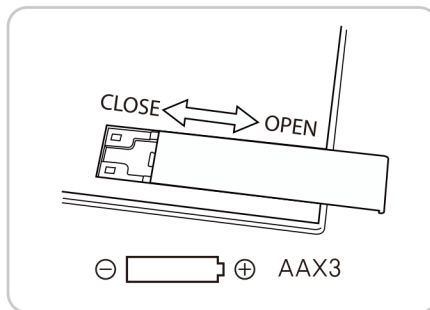

2. Open the battery cover on the back.
3. Put 3 AA batteries in order.
4. Close the cover.

Proper Battery Care

● Observe the following to prevent battery breakage or leaks.

- Remove batteries when not using the remote control for a long time.
- Do not use rechargeable batteries.

Settings (temperature, auto flush) may reset after replacing the batteries. Configure the settings again.

2 Check if the power plug is connected

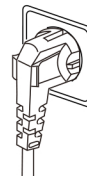

3 Adjust water flow with the shutoff valve

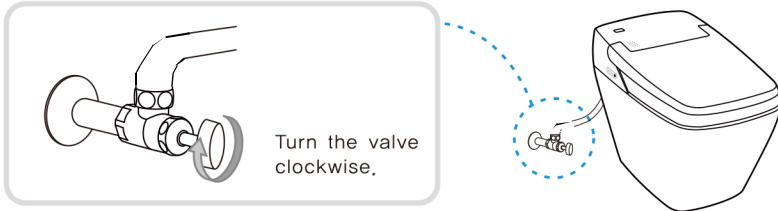

If the water pressure is too high, water may splash or overflow when flushing the toilet. Turn the water shutoff valve clockwise to reduce pressure.

Check

4 Check the display panel

● Is the operation light on?

● Is the seat light on?



If not on, press the Power button  to turn on the light.

If not on, open the remote control cover and press Seat Temperature to turn it on.

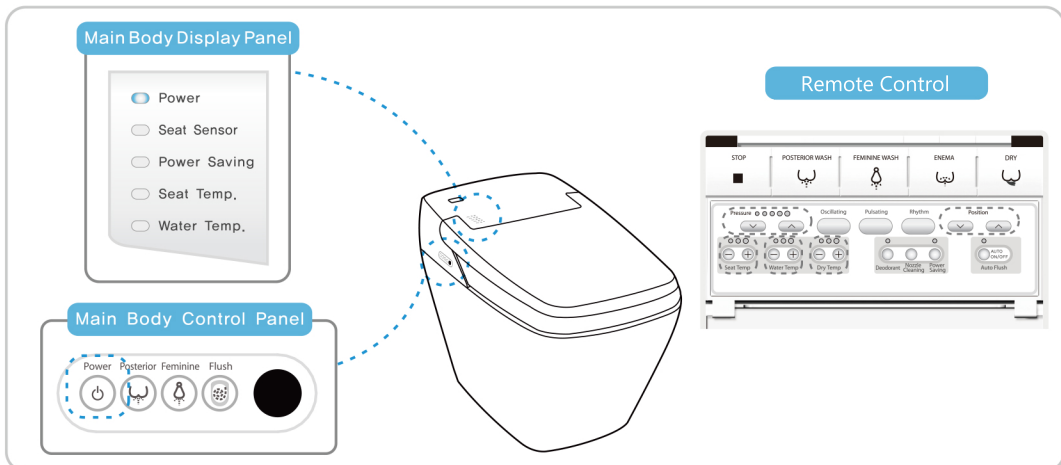

How to Use

Sit on the seat

- The sensor light will turn on.
- Only operates after being occupied.

2



- Press one of the cleansing functions above on the remote control.
- Adjust the nozzle position and water pressure to your preferred settings.
- Each function operates for one minute.



Dry - Operates dry feature for 3 minutes.

3



Stop

- Stops all cleaning and dry functions.

4



Flush



Optional Comfort Settings



Option 1 Oscillating

Nozzle moves back and forth to cleanse.

1. Press the button to wash.
2. Press Oscillating.
- Nozzle moves while washing.
3. Press again.
- Stop Oscillating.

Option 2 Pulsating

Stream water more rhythmically.

1. Press the button to wash.
2. Press Pulsating.
- Spray pulsates while washing.
3. Press again.
- Stop Pulsating.

Option 3 Rhythm

Combines oscillating and pulsating.

1. Press the button to wash.
2. Press Rhythm.
- Spray water rhythmically.
3. Press again.
- Stop Rhythm.

Notice

Sit towards the center of the seat to prevent water from splashing.

Adjusting Temperature

- The temperature of the seat and dryer can be adjusted with the remote control.

1 Open the remote control cover.

2 Adjust the temperature.

Use **-** **+** button to adjust the temperature of the seat, water, and dryer up to 3 levels.

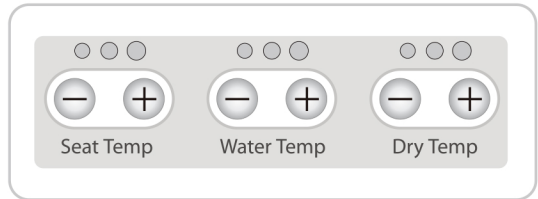

Seat Temperature

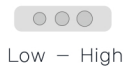

Water Temperature



Dryer Temperature

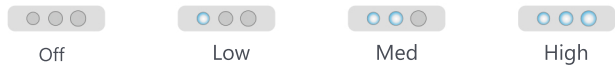
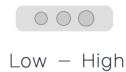

- When you activate the seat temperature, the seat light will be turned on in the display area of the main body.

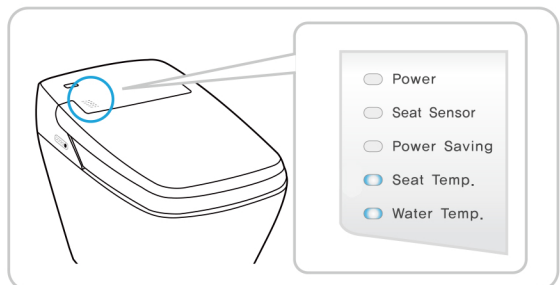

- When you activate the water temperature, the water light will be turned on in the display area of the main body.



Adjusting and Using Functions



- The water pressure and nozzle position can be adjusted with the remote control.

Adjust water pressure

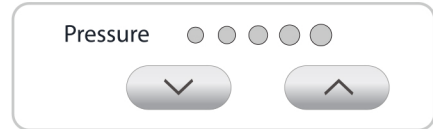

- The water pressure can be adjusted up to 5 different levels with  and  buttons. Adjust the water pressure to your preference.



Adjust nozzle position

- While using the Posterior or Feminine wash, press  or  button to adjust the nozzle position to your body.
- The nozzle begins at the middle position each time you activate a wash.



Clean Nozzle

- Press the  button for 3 seconds to extend the nozzle without sitting on the seat.
- Using a toothbrush, clean the nozzle and press the  button again when finished.

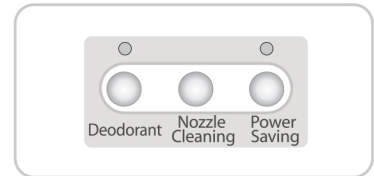

*Do not push or pull the nozzle forcibly.



Deodorant

- Press the  button to turn on the function.
- It deodorizes automatically when sitting.
(It works for up to 20 minutes while occupied, and another 1 minute after standing up.)
- Press the  button again to turn off the function.

Power Saving

- Press the  button to turn on the power saving light on the main body.
- In power saving mode, the water temperature and seat temperature will be maintained at 86°F.
- To cancel the power saving mode, press the  button again to turn off the display light.
- Power saving mode automatically turns off when seated and turns back on when you stand up.

Seat and Lid Operation (P770 Only)

There are 2 ways to operate the seat and lid:
Automatic and remote control.



Remote Controlled Open/Close of Toilet Seat and Lid

- Choose the seat or lid function by pressing the corresponding button on the remote control.

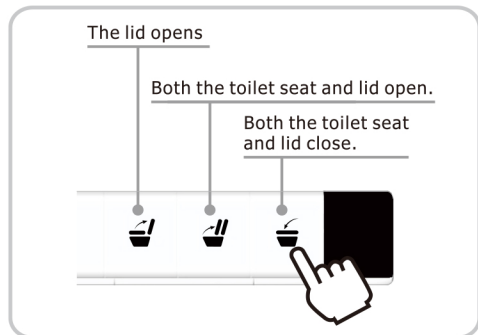

Automatic Open/Close of Toilet Seat and Lid

- When you stand in front of the toilet, the lid automatically opens, and when you move away from the toilet, the lid automatically closes.

(P770 Only)

Activate the automatic open/close feature on your remote.

Press the Auto lid button to turn the function on. The light indicates the function is on.

Press again to turn the function off.

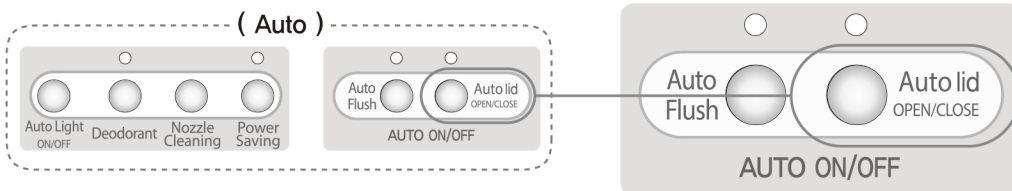

Auto Seat and Lid open/close button.

Flushing

There are 3 ways to flush the toilet: Remote Control, Auto Flush, and Manual Flush.

Remote Control Toilet Flush



Press the full flush or small flush button on the remote control.

Auto Flush

Press the  button to turn the light on.

The toilet will automatically flush after standing up.

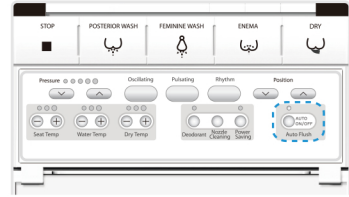

Manual Flush



Press the **Flush button**  on the control panel of main body.

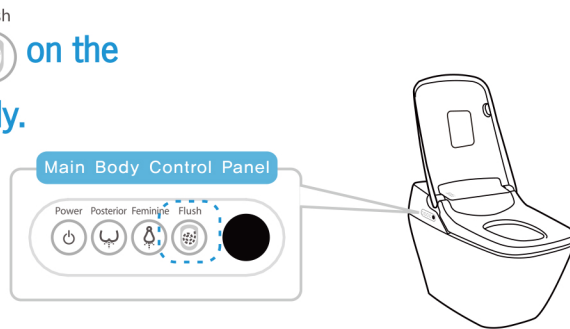

Bowl Cleaning

1. Press the Bowl cleaning button for 3 seconds.
2. Press the Flush button for 5 seconds.
3. Press the Bowl cleaning button again for 3 seconds.

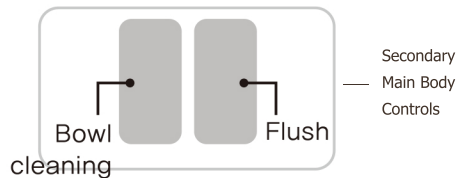

- ※ Bowl cleaning function cleans the inner ceramic bowl.
- ※ Flush function jets high pressure water to flush down debris in the bowl.

Maintenance

Carefully read the following procedures.

Turn off the Auto Flush feature before performing any maintenance.



Regular Maintenance

◆ Main Body, Seat and Lid.

Routine Cleaning

- Clean with a wet cloth.

Deep Cleaning

- Clean with a soft wet cloth and mild detergent. Dry thoroughly after cleaning.

Do not use harsh detergents when cleaning to avoid discoloring.

The BioMist Bidet Cleaner is the recommended cleaning method.

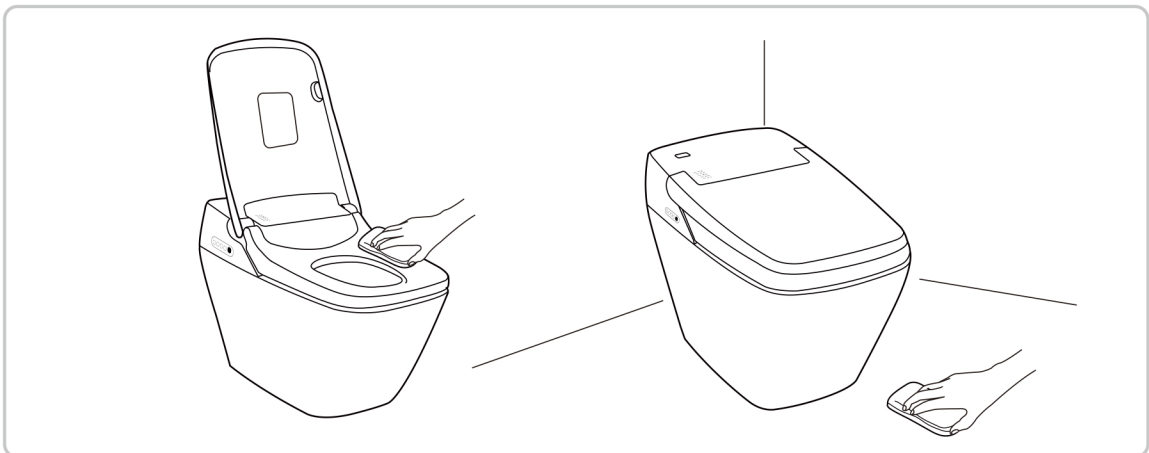

Deodorizer Filter (as necessary)

- Take the following steps when cleaning the deodorizer filter.

1 Remove the filter

- Locate the filter beneath the bidet and pull it forward.

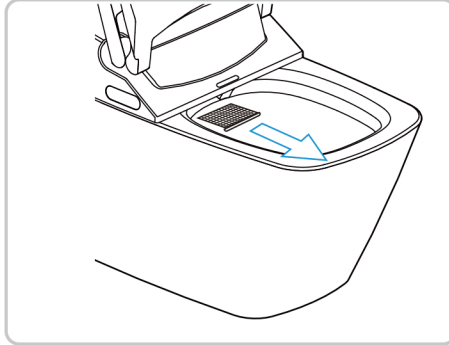

2 Clean

- Using a toothbrush, remove dust particles from the filter.

3 Resecure the filter

- Push back until it clicks.

※ Do not use without the filter.

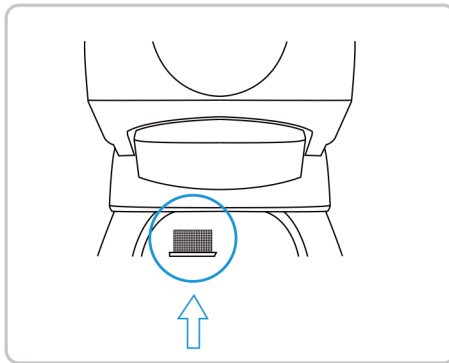



Troubleshooting

If the product is not functioning properly, check the following troubleshooting tips. If the problem persists, please contact Bio Bidet support.

Power supply

Trouble	Possible Causes	Solution
The unit is not working.	Is the power out or circuit breaker off?	Wait until the power is restored, or turn on the circuit breaker.
	Is the operation light on the display panel off?	Turn on the power  in the control panel of the main body.

Posterior wash, Feminine wash, Enema, Kid function

Trouble	Possible Causes	Solution
Water is not spraying out.	Is the shutoff valve closed?	Open the valve.
	Is the seat sensor being activated?	Make skin contact with the seat sensor.
	Is the hose crimped?	Reposition the hose.
Water pressure is too low.	Is the water pressure set too low?	Increase the water pressure and clean the nozzle.
	Is there any debris in the hose?	Turn off the water shutoff valve and clean the hose out.
Water is cold.	Is the temperature set to a low level or turned off?	Adjust with   buttons on the remote control.
	Is power saving mode turned on?	The water temperature is set lower and increases when seated.
Water stops in the middle of cleansing.	The cleansing functions automatically stop after five minutes of use.	Press a cleansing function button again.
	Is the seat sensor activated?	Make skin contact with the seat sensor.

Trouble	Possible Causes	Solution
Water flows into the toilet for a few seconds near the nozzle when first sitting down.	When the seat sensor is on, it releases some water before spraying. If you change the position while seated, the sensor will turn on and off, and release some additional water.	-

Seat Sensor

Trouble	Possible Causes	Solution
The posterior wash or deodorant function works without sitting on the seat.	Is the seat sensor blocked with a wet towel?	Remove the wet towel.
	Is the seat sensor wet?	Wipe the water with a dry cloth.

Auto Flushing

Trouble	Possible Causes	Solution
Auto flushing is not working.	Is the auto flushing turned off? (When off, the flushing indication on the remote control display panel is off.)	Press auto flushing  button on the remote control again to turn it on

Heated Seat

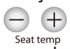
Trouble	Possible Causes	Solution
The seat is not warm.	Is the seat temperature set too low?	Adjust seat temperature with  buttons on the remote control.
	Is power saving mode turned on?	The seat is kept at a lower temperature until activated.

Remote Control

Trouble	Possible Causes	Solution
Remote control is not working.	Are the batteries running low?	Replace old batteries with new ones.
	Are the batteries inserted incorrectly?	Re-insert the batteries properly.
	Is the transmitter or receiver blocked?	Remove the objects blocking transmitters.
	Is the transmitter or receiver dirty?	Wipe the affected areas clean.
	Is the seat sensor activated?	Make skin contact with the seat sensor.



Flushing by Remote Control

Trouble	Possible Causes	Solution
I can't flush the toilet with remote control.	Are the batteries running low?	Replace old batteries with new ones.
	Did you press the button consecutively?	This function cannot be used consecutively. You will need to wait for about 10 seconds for next flush.
	Is the transmitter or receiver dirty?	Wipe the affected areas clean.



Deodorization

Trouble	Possible Causes	Solution
Deodorizer is not working at all.	Is the seat sensor activated?	Refer to the location of Seat Sensor on page 9.
Deodorizer is not very effective.	Is the deodorizer filter clogged?	Clean the deodorizer filter.
Deodorizer is not working at all.	Is the main body light on?	Set the deodorizer filter.

Drying

Trouble	Possible Causes	Solution
Dryer temperature is too low.	Is the air temperature set to a low level?	Adjust the air temperature with   buttons on the remote control.
The dryer stops in progress.	Did you activate another function?	Press  again.
	It may stop if the user changes position while sitting.	Refer to the location of Seat Sensor.
The warm air drying function is not working at all.	Is the seat sensor activated?	Refer to the location of Seat Sensor.

Power Saving

Trouble	Possible Causes	Solution
Power saving is not working.	Is it unplugged?	The setting may take up to 24 hours to function normally.
	Did you change the batteries?	
	Did you change the batteries?	Press the  button or  button again to turn it on.
	Did the power go out?	

Others

Trouble	Possible Causes	Solution
The toilet is not flushing sufficiently.	Is the shutoff valve open enough?	Open the shutoff valve sufficiently.
	Is there any debris in the hose?	Turn off the water shutoff valve and clean out the hose.
The flushing water is not supplied.	Is the water shutoff valve closed?	Open the shutoff valve sufficiently.
	Is the water supply suspended?	Wait until the water supply is resumed.

Warranty

We warrant our products to be free from manufacturing defects under normal use and service for a period of time limited to 3 years from the date of purchase.

This warranty covers 100% of all Bio Bidet parts and Bio Bidet labor costs associated with the product.

Our obligation to you under this warranty is limited to parts, repair, or replacement, at our option, of defective products or parts, provided the products were properly installed and used in accordance with the instructions. We reserve the right to make inspections in order to determine the cause of any defects. We will not charge for labor or parts in connection with warranty repairs or replacement performed by our technicians. We are not responsible for the cost of removal, return, 3rd party repair services, and/or reinstallation of products.

This warranty does not apply to:

- a) Damage or loss from a fire, earthquake, flood, etc.
- b) Damage or loss resulting from any unreasonable use, abuse, negligence, or improper maintenance.
- c) Damage or loss from improper installation, removal, repair, or modification.
- d) Damage or loss resulting from sediment or other matters contained in your water system.

For more warranty service information, please contact Bio Bidet.

Only the original purchaser may submit a claim under this warranty.

This warranty is our only warranty covering your product. Repair or replacement as provided under this warranty shall be the exclusive remedy available to you. We shall not be responsible for the loss of the product or other incidental or consequential damage or expenses you may incur, or for labor or other costs due to installation, removal, third party repairs, or other expenses not previously stated. Except to the extent prohibited by applicable, any implied warranties, including that of merchantability or fitness for use, are expressly limited to the duration of this warranty.

Warranty Services:

Please keep your purchase record to validate your warranty.

The following information may be necessary for various services: Purchaser Name, Address, Telephone Number, Product Model, Purchase Date.

Support agents are available Mon-Fri, 9:00 AM - 5:00 PM CST

Phone: 847-458-2334 Email: support@biobidet.com Chat: [biobidet.com](https://www.biobidet.com)

Specifications

Model No.		P700	P770
Rated Voltage		AC 120V, 60Hz	
Rated Power Consumption		703W	
Power Cord Length		1.5m (5feet)	
Toilet	Water Consumption	Full flush: / Small flush:	
	Flushing System	Siphon jet, Tornado flushing	
Wash Unit	Posterior Wash	Max 0.31gal / min	
	Feminine Wash	Max 0.31gal / min	
	Enema	Max 0.31gal / min	
	Water Temperature	Adjustable, 93°F - 104°F	
	Water Tank	0.31 gal	
	Heater Capacity	600W	
	Safety Device	Thermal cutoff, Overheating prevention circuit, Temperature sensor	
Heated Seat	Seat Temperature	Adjustable, 93°F - 104°F	
	Heater Capacity	55W	
	Safety Device	Thermal cutoff, Temperature sensor	
Dry	Hot Air Temperature	Adjustable, 93°F - 138°F	
	Heater Capacity	250W	
	Safety Device	Thermal cutoff, Temperature overheat preventer (manual recovery bimetal)	
Deodorization		Automatic deodorizer	
Lighting		—	Auto LED light
Auto lid		—	Auto lid
Water Pressure		Min : 1.5kgf/cm ² (0.15Mpa) [with 20ℓ/min flow] Max : 7.5kgf/cm ² (0.75Mpa)	
Waterproof rating		IPX4	
Inlet water Temperature		41°F - 95°F	
Ambient Temperature		41°F - 104°F	
Dimension		W 410mm x L 720mm x H 525mm	
Weight		59 lbs (Bidet: 17 lbs, Toilet: 42 lbs)	

MEMO



PRODIGY