

AS3350 – AS3450 series

Upright vacuum cleaner; household type

# Owner's Guide

*Thank you for purchasing your new Eureka vacuum!*

## Important instructions

To view an assembly video, go to [youtube.com/EurekaCleanUSA](https://youtube.com/EurekaCleanUSA).  
If you have questions about your new vacuum, please contact our customer service helpline at **1-800-282-2886**.  
*We're here to help!*

## Guía del Propietario

*¡Gracias por la compra de su nueva aspiradora Eureka!*  
Para ver un video sobre cómo armar, visite [youtube.com/EurekaCleanUSA](https://youtube.com/EurekaCleanUSA).  
Si tiene alguna pregunta sobre su nueva aspiradora, por favor contacte a nuestra línea de ayuda de atención al cliente llamando al **1-800-282-2886**.  
*¡Estamos aquí para ayudarle!*

## Le Guide du Propriétaire

*Merci d'avoir acheté votre nouvel aspirateur Eureka!*  
Pour visualiser la vidéo d'assemblage, rendez-vous à l'adresse [youtube.com/EurekaCleanUSA](https://youtube.com/EurekaCleanUSA). Si vous avez des questions au sujet de votre nouvel aspirateur, veuillez contacter notre Ligne d'aide du Service à la clientèle au **1-800-282-2886**.  
*Nous sommes là pour vous aider!*



[www.eureka.com](http://www.eureka.com)

© 2016 Electrolux Home Care Products, Inc. Printed in China PN A06207501\_rev1

**eureka**®

# Where to find important vacuum information

## Keep this information

Write the model, type and serial number here:

Date of purchase (keep your receipt) \_\_\_\_\_

Model number and type \_\_\_\_\_

Serial number \_\_\_\_\_

Find these numbers on a label on the middle back side of the vacuum cleaner. Refer to these numbers when ordering parts and accessories or if service is needed.



## This Owner's Guide provides important instructions to prolong the life of your Eureka vacuum cleaner.

**Registration:** To register your product visit [www.eureka.com](http://www.eureka.com) and click on the 'Register Your Product' link in the top right corner.

**Inspection:** Carefully unpack and inspect your new Eureka vacuum cleaner for shipping damage. Each unit is tested and thoroughly inspected before shipping. For instructions regarding any shipping damage, call Eureka Customer Service **HELPLINE 1-800-282-2886** immediately.

## Contents

Important safeguards . . . . .	3
What comes in the carton . . . . .	4
How to assemble your vacuum cleaner . . . . .	4
How to identify parts of your vacuum cleaner . . . . .	5
How to use your vacuum cleaner . . . . .	6
Thermal cut-off and problem solving . . . . .	7
The Eureka limited warranty . . . . .	7
How to order replacement parts . . . . .	20

 Follow caution information wherever you see this symbol.



Eureka stands by our Clean Promise seal.  
Learn more at [www.eureka.com/cleanpromise](http://www.eureka.com/cleanpromise)

# IMPORTANT SAFEGUARDS

When using an electrical appliance, basic precautions should always be followed, including the following:

## READ ALL INSTRUCTIONS BEFORE USING THIS VACUUM CLEANER WARNING



To reduce the risk of fire, electric shock, or injury:

- Do not use outdoors or on wet surfaces.
- **Do not leave vacuum cleaner when plugged in.** Turn off the switch and unplug the electrical cord when not in use and before servicing.
- Do not allow to be used as a toy. Close attention is necessary when used by or near children.
- Use only as described in this manual. Use only manufacturer's recommended attachments.
- Do not use with damaged cord or plug. If vacuum cleaner is not working as it should, has been dropped, damaged, left outdoors, or dropped into water, return it to a service center before using.
- Do not pull or carry by cord. Do not use cord as a handle. Do not close a door on cord or pull cord around sharp edges or corners. Do not run vacuum cleaner over cord. Keep cord away from heated surfaces.
- Do not use extension cords or outlets with inadequate current carrying capacity.
- Turn off all controls before unplugging.
- Do not unplug by pulling on cord. To unplug, grasp the plug, not the cord.
- **Cord rewind models:** Hold plug when rewinding into cord reel. Do not allow plug to whip when rewinding.
- Do not handle plug or vacuum cleaner with wet hands.
- Do not put any object into openings. Do not use with any opening blocked; keep free of dust, lint, hair, and anything that may reduce airflow.
- This vacuum cleaner creates suction and contains a revolving brushroll. Keep hair, loose clothing, fingers, and all parts of body away from openings and moving parts.
- Do not place vacuum cleaner on furniture or stairs as the brushroll may cause damage. Use extra care when cleaning stairs. Place vacuum cleaner on floor with the handle in storage position while using attachments.
- Do not pick up anything that is burning or smoking, such as cigarettes, matches, or hot ashes.
- Do not use without dust cup, filter, screen and exhaust filter in place.
- Belt pulleys can become hot during normal use. To prevent burns, avoid touching the belt pulley when servicing the drive belt.
- Do not use to pick up flammable or combustible liquids such as gasoline, or use in areas where they may be present.
- Store your vacuum cleaner indoors in a cool, dry area.
- Keep your work area well lighted.
- Unplug electrical appliances before vacuuming them.
- Unplug before connecting turbo nozzle.
- Do not press Brushroll Clean pedal more than recommended. See "How to maintain brushroll" in this guide.
- **WARNING:** This product contains chemicals known to the State of California to cause cancer, birth defects or reproductive harm. WASH HANDS AFTER HANDLING.

## SAVE THESE INSTRUCTIONS

To reduce the risk of electric shock, this appliance has a polarized plug (one blade is wider than the other). This plug will fit in a polarized outlet only one way. If the plug does not fit fully into the outlet, reverse the plug. If it still does not fit, contact a qualified electrician to install the proper outlet. Do not change the plug in any way.



### Motor

**Do Not Oil** the motor or the brushroll at any time. The bearings are permanently lubricated and sealed.

# What comes in the carton

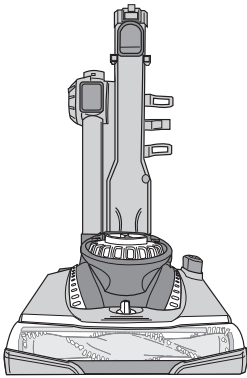

Vacuum cleaner

OWNER'S  
GUIDE

Important  
safeguards

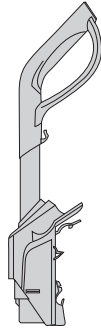

Handle

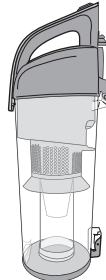

Dust cup

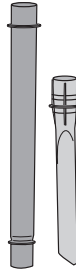

Extension wand  
and crevice tool



Dusting brush



Turbo nozzle

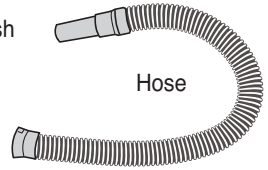

Hose

# How to assemble your vacuum cleaner

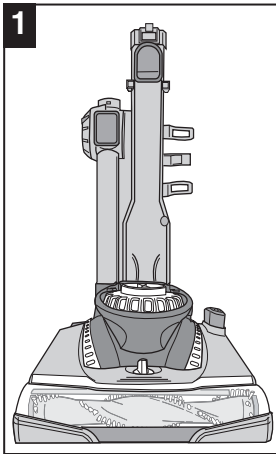

1

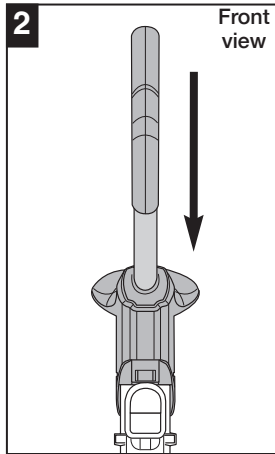

Front  
view

2

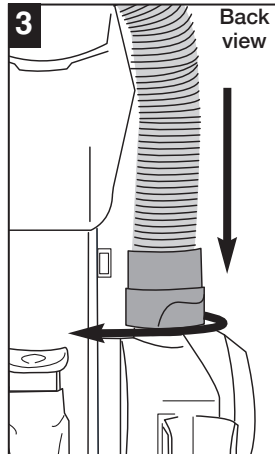

Back  
view

3

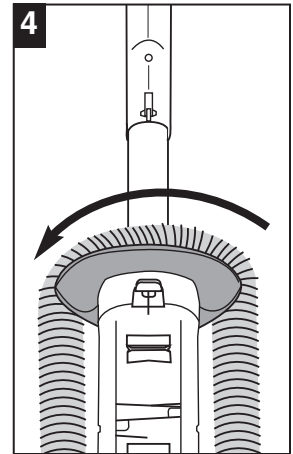

4

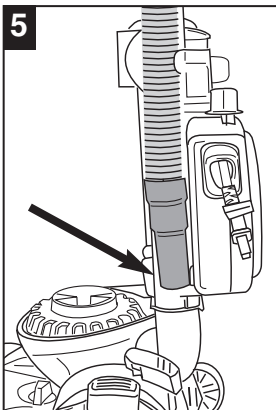

5

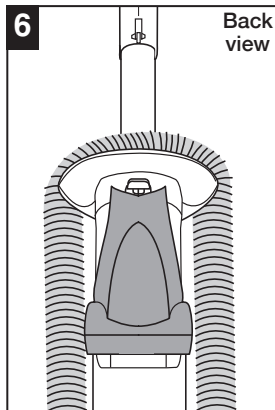

Back  
view

6

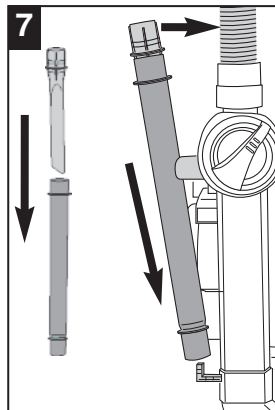

7

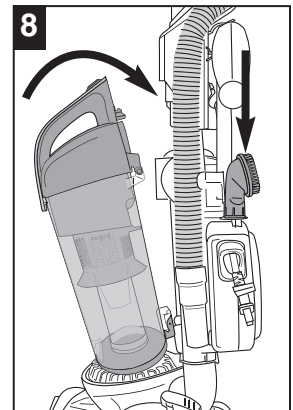

8

# How to identify parts of your vacuum cleaner

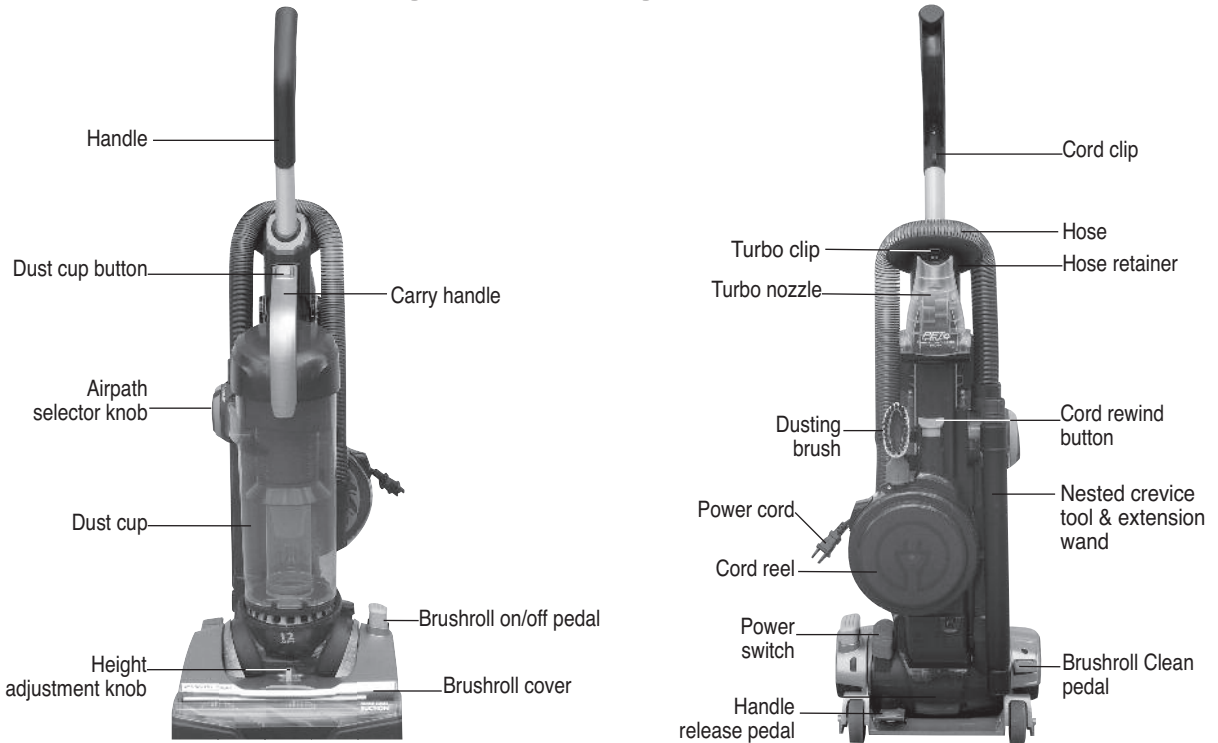

ENGLISH

For maintenance instructions, see [www.eureka.com](http://www.eureka.com)

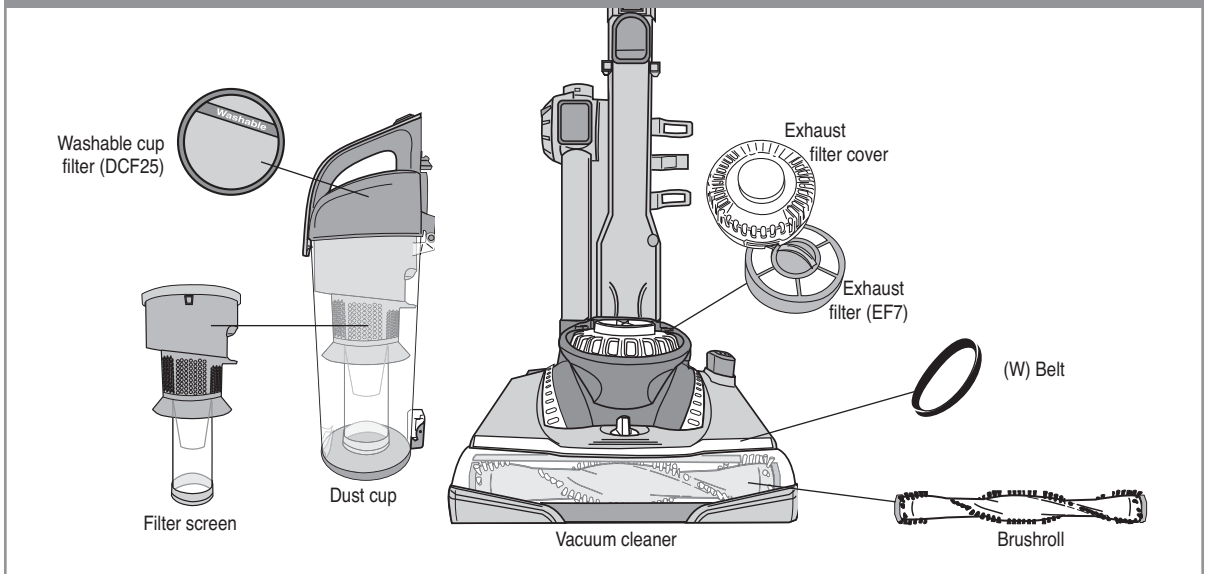

# How to use your vacuum cleaner

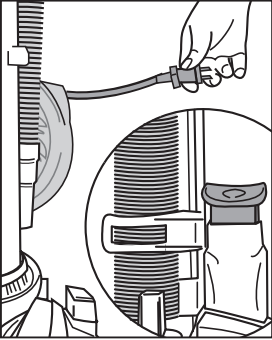

Pull out cord to desired length. Press button to rewind cord.

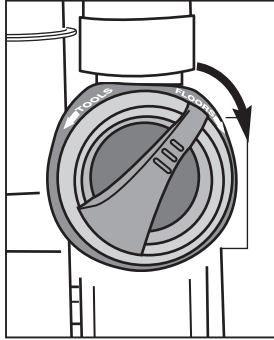

To vacuum floors, turn air path knob to 'FLOORS.'

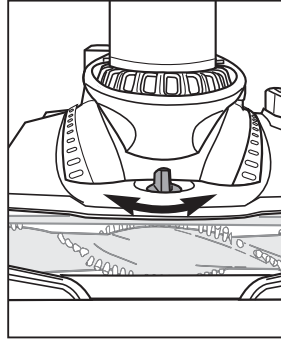

Turn knob to adjust height for bare floor and Low to High pile carpet.

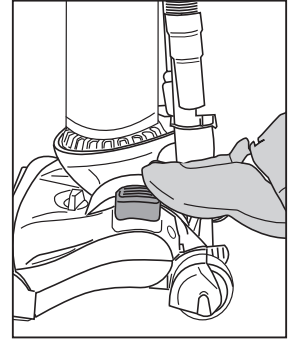

Step on pedal to turn brush roll on for carpet or off for bare floors.

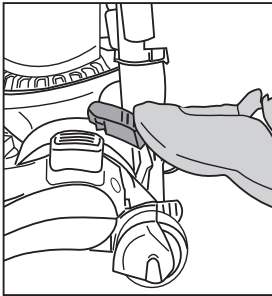

Step on power switch to turn on; step on again to turn off.

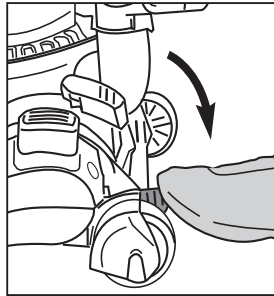

Step on handle release to lower handle into position.

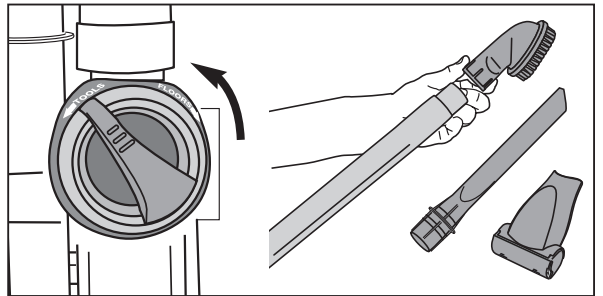

To use tools, turn air path knob to 'TOOLS.' Attach dusting brush, crevice tool or turbo nozzle to end of hose or wand.



**Empty dust cup after every use. Clean filters frequently.**

**Clean brushroll frequently.**

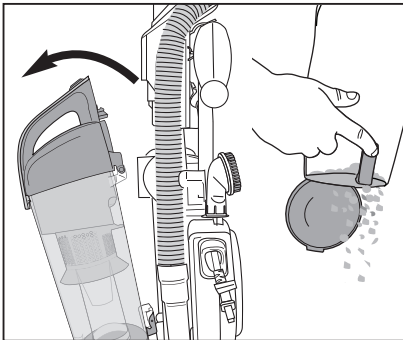

To empty debris, push button and pull out dust cup. Press lever to release bottom lid.

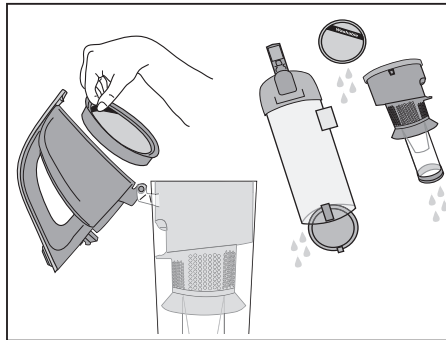

Pull latch to lift up cover. Lift out foam filter and filter screen; shake off dust. Rinse foam filter, screen and dust cup. Dry thoroughly. Reinstall filters and dust cup.

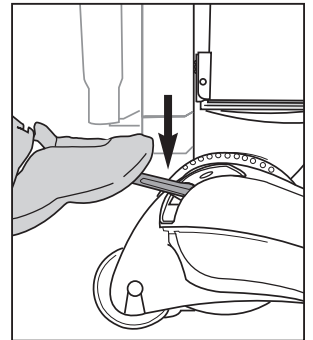

Turn on vacuum; with the brushroll turning, step on Brushroll Clean pedal. Clean manually as needed.

# Problem solving

**⚠ Make sure vacuum is turned off and power cord is unplugged.**

## ⚠ NOTICE: Thermal cut-off

This vacuum cleaner has a special thermostat that protects the vacuum in case of motor overheating. **If the vacuum suddenly shuts off**, proceed as follows: 1) Push the power switch to off and unplug the vacuum. 2) Check the vacuum for a possible source of overheating such as a full dust cup, blocked hose or clogged filter. If these conditions are found, fix them and wait at least **30 minutes** before attempting to use the vacuum. 3) After the 30 minute period, plug the vacuum back in and turn on the switch. If the vacuum still does not work, call the Eureka customer service helpline.

Problem	Solution
<b>Motor will not start.</b>	<ul style="list-style-type: none"> <li>• Push plug securely into outlet, try another outlet or check circuit breaker.</li> <li>• Step on power switch to turn vacuum on.</li> </ul>
<b>Vacuum does not clean carpet or bare floor.</b>	<ul style="list-style-type: none"> <li>• Turn air path selector knob to 'FLOORS.'</li> <li>• Empty dust cup, clean and/or change filter.</li> <li>• Clean or replace filters regularly to maintain suction. See Eureka.com/Maintenance-AirSpeed.</li> <li>• <b>For carpet</b>, be sure brushroll is on and lower handle into position for vacuuming.</li> <li>• <b>For bare floors</b>, step on pedal to turn off brushroll.</li> </ul>
<b>No suction at the end of hose.</b>	<ul style="list-style-type: none"> <li>• Make sure airpath selector knob is set to 'TOOLS.'</li> <li>• Remove clogs from the hose that restrict the airflow. See Eureka.com/Maintenance-AirSpeed.</li> </ul>
<b>Burning smell; brushroll will not turn.</b>	<ul style="list-style-type: none"> <li>• Check brushroll for debris.</li> <li>• Replace broken or out of shape belt. See Eureka.com/Maintenance-AirSpeed.</li> </ul>
<b>Cord will not rewind fully.</b>	<ul style="list-style-type: none"> <li>• Pull out entire cord removing any kinks, and push cord rewind button to rewind completely.</li> </ul>
<b>Turbo nozzle will not turn.</b>	<ul style="list-style-type: none"> <li>• Check turbo nozzle for debris.</li> <li>• Make sure air path selector knob is set to 'TOOLS.'</li> </ul>
<b>Vacuum is hard to push.</b>	<ul style="list-style-type: none"> <li>• Adjust vacuum height knob to a higher position.</li> </ul>
<b>Brushroll needs cleaning.</b>	<ul style="list-style-type: none"> <li>• Turn on vacuum; with the brushroll turning, step on Brushroll Clean pedal.</li> <li>• A loud noise while pressing Brushroll Clean pedal is normal.</li> <li>• For obstructions larger than hair or thread, clean brushroll manually.</li> </ul>

ENGLISH

## The Eureka limited warranty

Eureka warrants this vacuum cleaner to be free from defects in material and workmanship for a term of five years for normal household use. Warranty is granted only to the original purchaser and members of immediate household.

This warranty is good for five years from the date of purchase only when the vacuum cleaner is used in the accordance with Eureka operating instructions. **Note:** refurbished or remanufactured products have a one year limited warranty.

### This warranty does not cover

- Parts of the vacuum that require replacement under normal use such as disposable dust bags, filters, drive belts, light bulbs, brushroll, bristles, impellers and cleaning.
- Damages or malfunctions caused by negligence, abuse, and use not in accordance with the Owner's Guide.
- Defects or damages caused by unauthorized service or the use of other than Genuine Eureka, ARM & HAMMER™ and Filtrite™ by 3M parts.

### What Eureka will do

Eureka will, at its option, repair or replace a defective vacuum or vacuum part that is covered by this warranty. As a matter of warranty policy, **Eureka will not refund the consumer's purchase price.**

### Obtaining warranty service

To obtain warranty service you must return the vacuum or vacuum part along with "proof of purchase" to any Eureka Authorized Warranty Station. For Eureka Authorized Warranty Station or Service Information, visit [www.eureka.com](http://www.eureka.com), write or telephone toll free:

**USA: 1-800-282-2886**

Electrolux Home Care  
North America Service Division  
P.O. Box 2900  
Peoria, IL 61612

**Mexico: (55) 5343-4384**

Electrolux Home Care

**Canada: 1-800-282-2886**

Electrolux Home Care  
North America Service Division  
5855 Terry Fox Way  
Mississauga, Ontario L5V 3E4

### Obtaining warranty service outside your community

You must pay the shipping charges to the Eureka Authorized Warranty Station.

**Return shipping charges** will be paid by the Warranty Station. When returning parts for repair, please include the model, type and serial number located on the rating plate on the lower backside of the vacuum.

### Further limitations and exclusions

Any warranty that may be implied in connection with your purchase or use of the vacuum, including any warranty of Merchantability or any warranty for Fitness For A Particular Purpose is limited to the duration of this warranty. Some states do not allow limitations on how long an implied warranty lasts, so the above limitations may not apply to you.

Your relief for the breach of this warranty is limited to the relief expressly provided above. In no event shall the manufacturer be liable for any consequential or incidental damages you may incur in connection with your purchase or use of the vacuum.

Some states do not allow the exclusion or limitation of incidental or consequential damages, so the above limitation or exclusion may not apply to you.

This warranty gives you specific legal rights. You may also have other rights, which may vary by state.

The ARM & HAMMER name is a trademark of Church and Dwight Co., Inc. 3M and Filtrite are trademarks of 3M Company, used by Electrolux Home Care Products, Inc. under license.











# eureka®

ORDER GENUINE EUREKA ACCESSORIES AND REPLACEMENT PARTS  
 COMMANDE ACCESSOIRES ET PIÈCES DE RECHANGE D'ORIGINE EUREKA  
 PEDIDO ACCESORIOS Y REPUESTOS LEGÍTIMOS EUREKA

Visit / Visitez / Visite : [www.eureka.com](http://www.eureka.com)

By Phone / Au Téléphone / Por Teléfono : 1-800-282-2886

	DCF-25 Dust Cup Filter <i>DCF-25 Filtro del Recipiente para Polvo</i> <i>DCF-25 Filtre à Récipient À Poussière</i>	67600
	EF-7 Filter <i>Filtro EF-7</i> <i>Filtre EF-7</i>	091541
	W Belt <i>Courroie W</i> <i>Correa W</i>	Models with On/Off Brush Roll Pedal <i>Modelos con interruptor de Encendido / Apagado del cepillo circular</i> <i>Modèles avec interrupteur Marche / Arrêt du rouleau de brosse</i> 86389
	Combination Brush <i>Brosse Combinaison</i> <i>Cepillo Combinado</i>	090221
	Crevice Tool <i>Outil de Coin</i> <i>Accesorio para Rincones</i>	090230
	Extension Wand <i>Tube de Rallonge</i> <i>Tubo de Extensión</i>	090199
	Turbo Nozzle <i>Turbo-Brosse</i> <i>Boquilla Turbo</i>	81295
	Pet Turbo Nozzle <i>Turbo-Brosse Pour Animaux</i> <i>Boquilla Turbo Para Mascotas</i>	84148