

Avant 3 and 4 Bath

BA1045, BA1046 1.0



Wall

GENERAL PRODUCT INFORMATION:

These fixtures are intended to be installed utilizing NEC compliant junction boxes.



This product is suitable for damp locations.

Incandescent lamps may be dimmed with a standard incandescent dimmer. LED lamps may be dimmed with a LED dimmer. Consult lamp manufacturer for additional information.

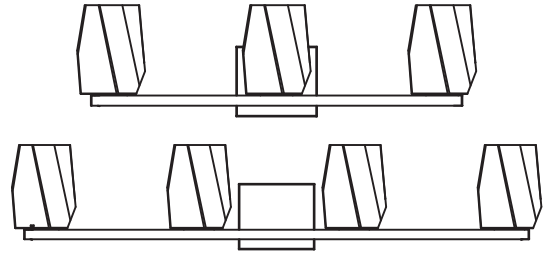

CAUTION - RISK OF FIRE
 This product must be installed in accordance with the applicable installation code by a person familiar with the construction and operation of the product and the hazards involved.
 Use minimum 90°C supply conductors.

Install the Fixture

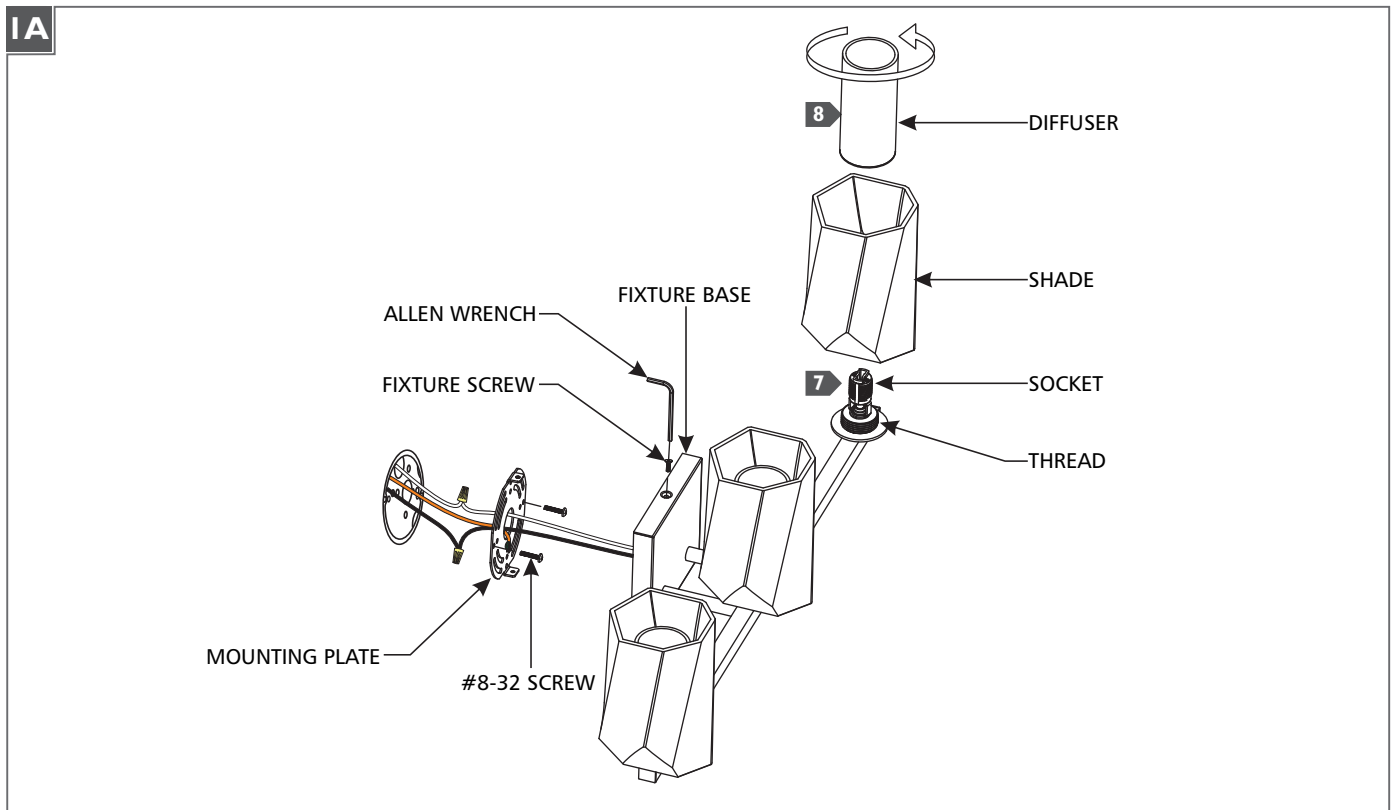

- 1** Remove the fixture screws located on the top and bottom of the fixture base using the provided Allen Wrench, then remove the mounting plate from the fixture base.
- 2** Install the mounting plate onto the electrical box with the two #8-32 screws provided.
- 3** Connect the fixture to suitable ground in accordance with local electrical codes.
- 4** Connect the white fixture wire to the neutral power line wire with a wire nut.
- 5** Connect the black fixture wire to the hot power line wire with a wire nut.
- 6** Properly place all wires and wire nut connections into the electrical box, mount the fixture back onto the mounting plate, and reinstall fixture screws (reversal of step 1A).
- 7** Install the lamps by pushing them into the sockets. Refer to the label on the socket for Max Wattage information.
- 8** Install the shades by placing them over the sockets and secure them in place by screwing the diffusers to the threads around the socket.

SAVE THESE INSTRUCTIONS!

LBL

7400 Linder Ave, Skokie, IL 60077

800.323.3226 - 847.626.6300

www.lblighting.com

© 2018 LBL Lighting. All rights reserved. The "LBL Lighting" graphic is a registered trademark of LBL Lighting. LBL Lighting reserves the right to change specifications for product improvements without notification.

A Generation Brands Company