

“Thermoquiet® “Acoustic” – Radiant Barrier
Acoustic/ Thermal - Drywall wall lamination
Wall Assembly Installation option
 – STC 19 - IIC 68 (Stand alone)

Structure 1- **Internal sound wall** - Standard 2” x 4” wood stud construction
 1 x Single layer standard 5/8” drywall on both sides with or without standard

**Thermoquiet® -Flex-
 Acoustic lamination**



STC rating **without Thermoquiet® - 32-36 WITH Thermoquiet® - 51 - 55**

Structure 2 - Standard 2 x 4 wood stud construction
 Double layer - 2 x Type X 5/8” drywall on both sides with standard R13 – 4”
 fibergalss pink insulation.

**Thermoquiet® -Flex-
 Acoustic lamination**

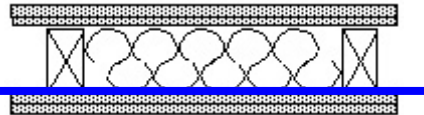

STC rating **without Thermoquiet® - 43- 45 WITH Thermoquiet® - 62- 64**

Structure 3 - Standard double stud 2” x 4” wood stud construction with 1” center AIR GAP.
 1 x Single layer standard 5/8” drywall on both sides with standard R13 – 4”
 fibergalss pink insulation in both stud cavities .

**Thermoquiet® -Flex-
 Acoustic lamination**

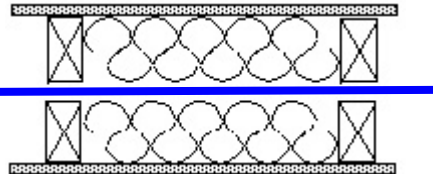

STC rating **without Thermoquiet® - 56-59 WITH Thermoquiet® - 75- 78**



Structure 4 - Standard double stud 2" x 4" wood stud construction with 1" center AIR GAP.
Double layer - 2 x Type X 5/8" drywall on both sides with standard R13 - 4" fibergalss pink insulation in both stud cavities .

**Thermoquiet® -Flex-
 Acoustic lamination**

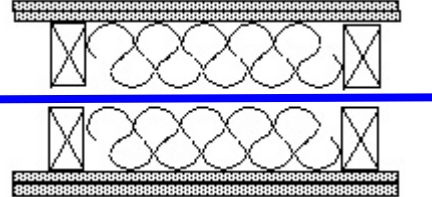

STC rating **without Thermoquiet®** - 58-63 **WITH Thermoquiet®** - 77-82

Structure 5 - **(1 hour fire rating- Partition Wall)** - Standard double stud 2" x 4" wood stud construction with 1" center AIR GAP.

1 x Single layer Type X 5/8" drywall on both sides with standard R13 4" Roxul or equivalent sound insulation in one stud cavity only

**Thermoquiet® -Flex-
 Acoustic lamination**

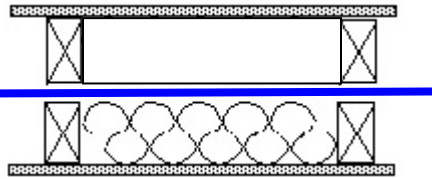

STC rating **without Thermoquiet®** - 52-55 **WITH Thermoquiet®** - 71-74

Structure 6 - **(2 Hour fire rating – Fire Rated Partition Wall)** Standard double stud 2" x 4" wood stud construction with 1" center AIR GAP.

Double layer - 2 x Type X 5/8" drywall on both sides with standard R13 - 4" Roxul or equivalent sound insulation in one stud cavity only .

**Thermoquiet® -Flex-
 Acoustic lamination**

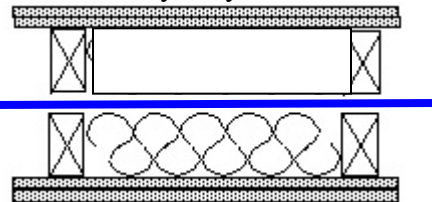

STC rating **without Thermoquiet®** - 54-59 **WITH Thermoquiet®** - 73-78

67255

