

ULTRA FAUCETS

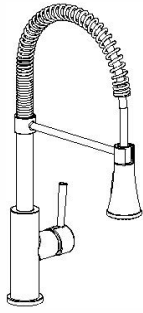

INSTRUCTION

Single Handle Spring Spout Kitchen Faucet With Spray

Model NO.: UF17200
UF17203
UF17205

Tools:

- Adjustable Wrench
- Pliers
- Pipe Wrench
- Screwdriver
- Teflon Tape



Maintenance:

Your new kitchen faucet is designed for years of trouble-free performance. Keep it looking new by cleaning it periodically with a soft cloth. Avoid abrasive cleaners, steel wool and harsh chemicals as these will dull the finish and void your warranty.

Preparation / Assembly

1

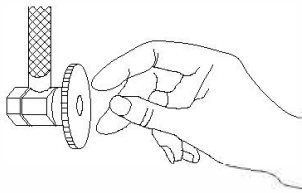

Shut off water supplies. Remove old faucet. Clean sink surface in preparation for the new faucet.

2

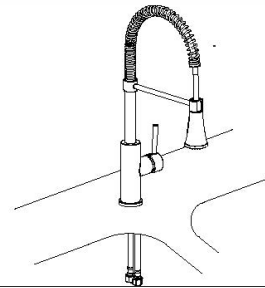

Place optional Flange on the bottom of the new faucet before positioning faucet through mounting hole.

3

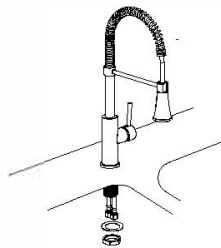

Screw the mounting stud into the body. Secure the faucet to the sink by installing steel washer and nut onto it. Tighten with wrench.

4

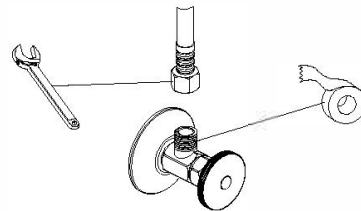

Apply pipe tape onto threads of water supplies. Use wrench when tightening the hose connection, do not overtighten.

5

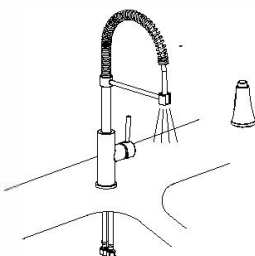

Important: After installation is completed. Turn on water supply and allow both hot and cold water to run for at least one minute each. While water is running, check for leaks. Reinstall Spray head. Your new faucet is now ready to use.

Exploded Drawing
RP(Replacement Parts)

Model NO.: UF17200
UF17203
UF17205

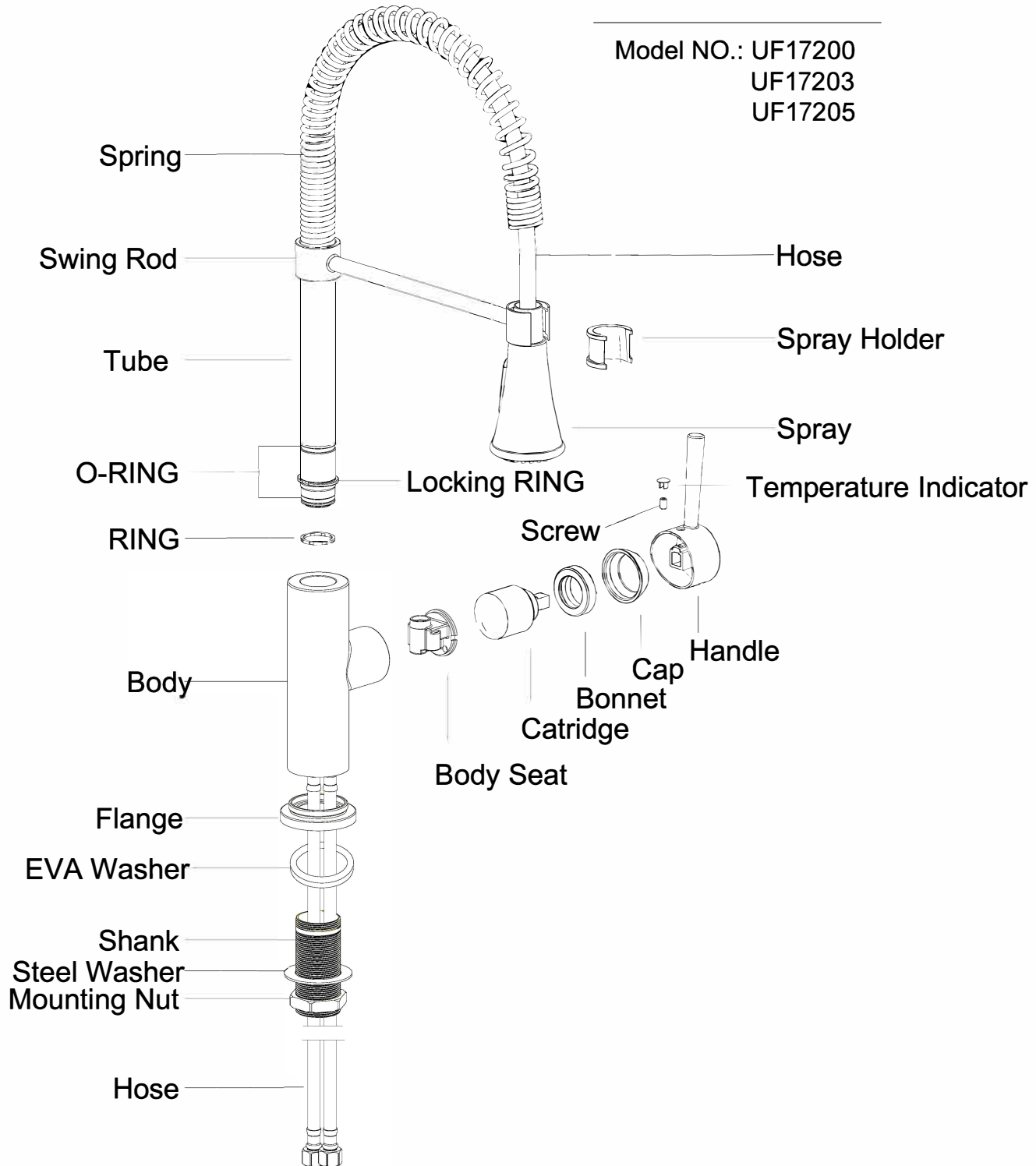

Limited Lifetime Warranty

Ultra Faucets warrants to the original purchaser that its products will be free from defects in workmanship and materials. All Ultra Faucets are provided with a life time limited warranty. This warranty does not cover any other labor or service charges associated with the removal, repair, or reinstallation of Ultra Faucets products. This express warranty does not apply to products that have been damaged as a result of misuse, abuse, negligence, accident, faulty installation or maintenance practices and/or used in any manner contrary to those recommended by the manufacturer.