

iTouchless®

sensor activated 

Automatic Open / Close Toilet Seat

USER MANUAL



innovation for everyone™

**Any Problem? DO NOT RETURN TO STORE.
Call 1-800-660-7978 first.**

WARNING!
THIS DEVICE MAY
Save your 
Marriage!

Thank you for ordering the Sensor Toilet Seat from iTouchless. Through daily use, you will discover its many benefits. Please provide feedback to us through our website.

Included Parts (Fig.1):

- 2 x Metal Screws
- 2 x Rectangular Washers
- 2 x Adjustment Brackets
- 2 x Large Fastener (Try to use these first)
- 2 x Small Fastener (not shown -Use these only if the Large Fastener doesn't fit)
- 2 x Large Plastic Bolt Cap (Use these with the Large Fastener)
- 2 x Small Plastic Bolt Cap (not shown: Use these with the Small Fastener)
- 2 x Hexagonal Metal Bolt

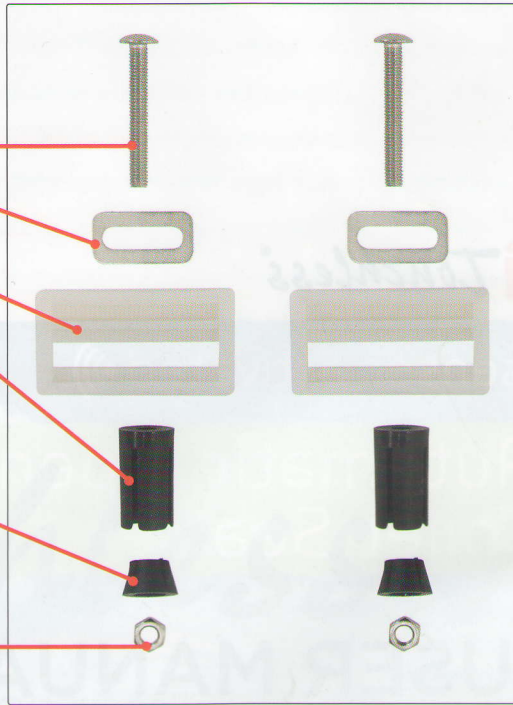
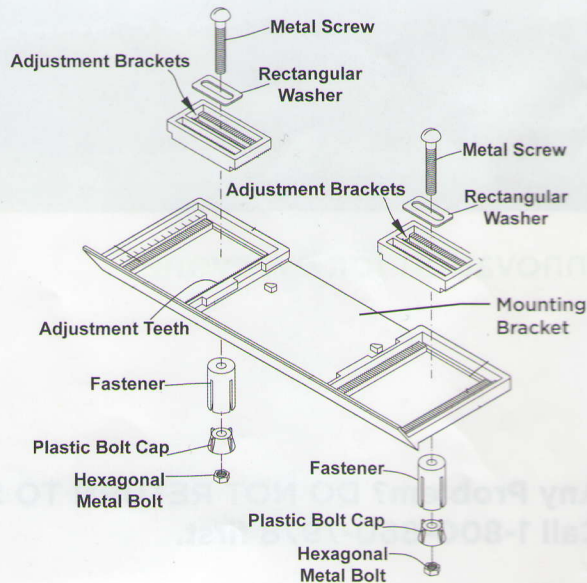
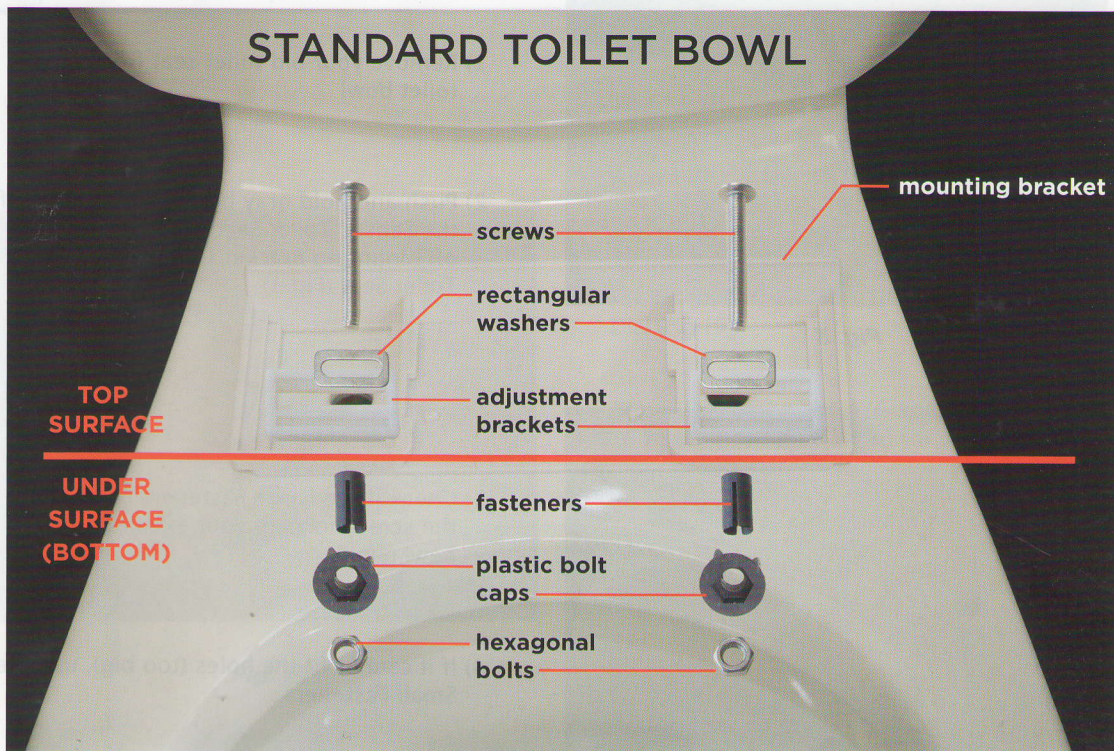

Fig. 1

- 1 x Rechargeable Battery
- 1 x A/C Adapter Charger
- 1 x User Manual
- 1 x Sensor Toilet Seat with attached mounting bracket (Need 1 x Phillips head screwdriver)



When the sensor toilet seat is working abnormally or the opening speed of the Cover and Seat is slower than normal, the Battery may need to be charged. The component that is on top of the back of the toilet seat.



Installation parts illustration (Fig 2):

WARNING

DO NOT SIT ON LID COVER!



quick installation guide

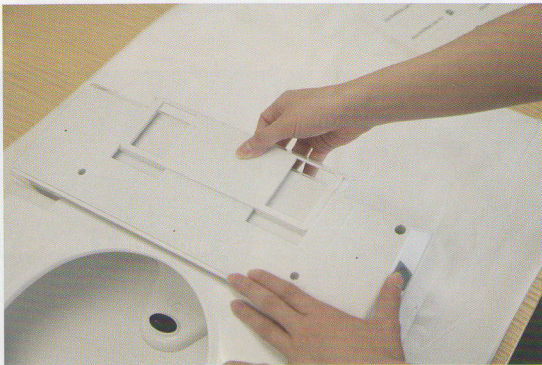

Fig. 3

- 1) Remove your old toilet seat from your toilet bowl
- 2) Push and hold gray button on the side of the Sensor Toilet Seat. Release and slide off Mounting Bracket from the Sensor Toilet Seat (Fig.3)

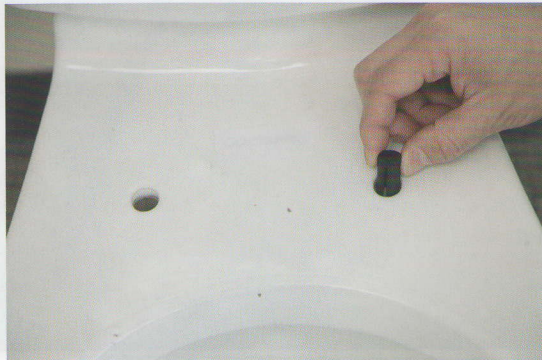

Fig. 4

- 3) Check if the Large Fasteners can fit into the screw holes of your existing toilet bowl (Fig.4)
- 4) If it cannot fit the holes (too big), use the Small Fasteners



Fig. 5

- 5) Place and align the Mounting Bracket on your toilet bowl (Fig.5)

(continued on next page)



Fig. 6

6) Place the Adjustment Brackets onto the Mounting Bracket (Fig.6)

7) Put the Rectangular Metal Washers onto the Adjustment Brackets (Fig.6)

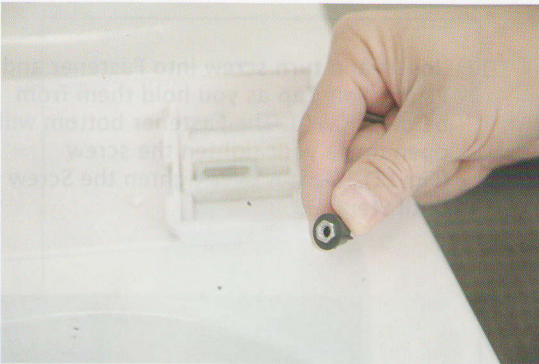

Fig. 7

8) Put the Hexagonal Metal Bolts into the Plastic Bolt Caps (Fig.7)

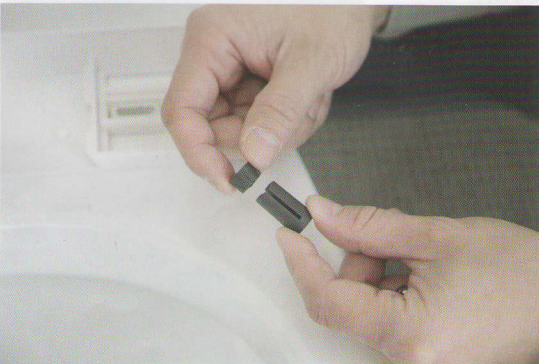

Fig. 8

9) Put Plastic Bolt Caps into the Fasteners (Fig.8)

(continued on next page)

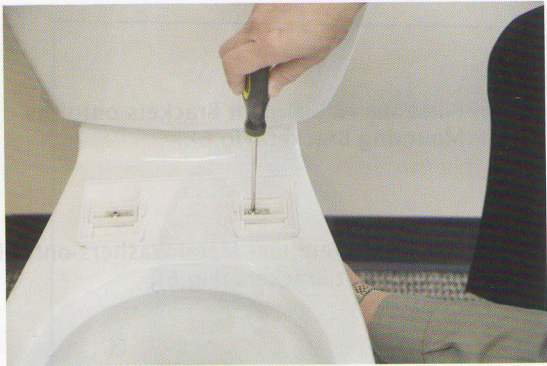

Fig. 9

10) Insert Screw through the Rectangular Metal Washer and Adjustment Brackets and through the toilet bowl hole. (Fig.9).

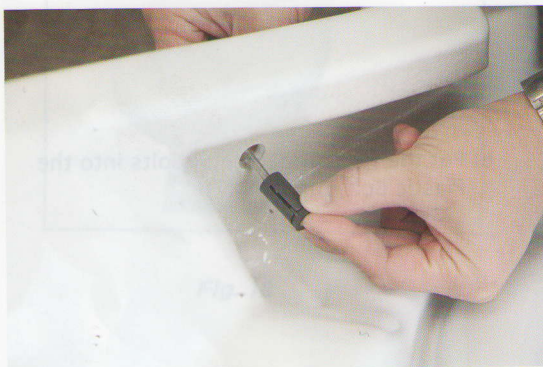

Fig. 10

Hold both the Fastener and the Plastic Bolt Cap like this and connect the Screws from the top of the toilet bowl

11) Insert and turn screw into Fastener and Plastic Bolt Cap as you hold them from below (Fig.10). The Fastener bottom will open up as your tighten the screw (Fig.11). Do not over tighten the Screw until Step 13.



Fig. 11

(continued on next page)

quick installation guide



Sensor Ranges:

- Front Sensor (when the Cover is closed): 4 to 6 inches
- Top Sensor (when the Cover is opened): 2 to 4 inches
- Occupant Sensor (in the center of the Cover): adjustable 18 - 39 inches
- Occupant Motion Sensor (in the center of the Cover): fixed 120 degree detection angle

12) Repeat the steps 10 and 11 for the other side

13) Align the Mounting Bracket on toilet bowl. Tighten the Screws.



Fig. 12

14) Push and hold gray button while sliding the Sensor Toilet Seat into the Mounting Bracket (Fig. 12)

15) Insert Battery to the battery compartment.



Fig. 13

After installation, the Sensor Toilet Seat should be aligned on the toilet bowl (Fig.13)

To Remove the Sensor Toilet Seat:

- 1) Push and hold the gray release button.
- 2) Slide out the Sensor Toilet Seat (Fig. 14)

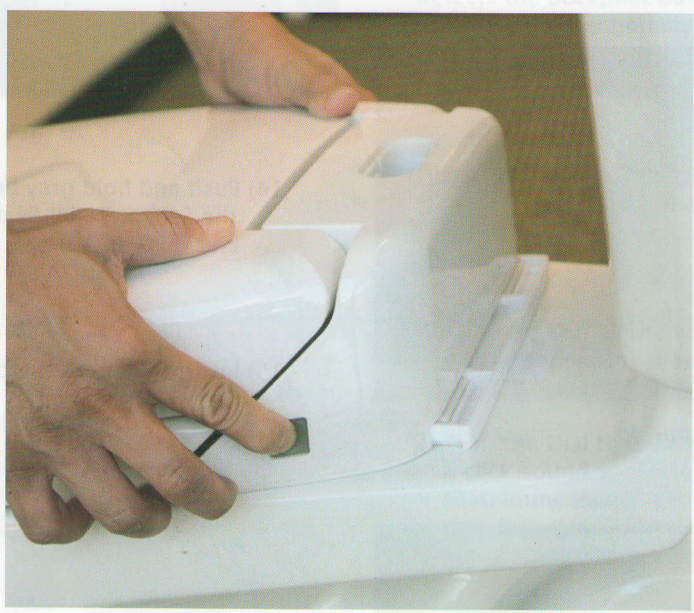

Fig. 14

specifications



Sensor Ranges:

- Front Sensor (when the Cover is closed): 4 to 6 inches
- Top Sensor (when the Cover is opened): 2 to 4 inches
- Occupant Sensor (in the center of the Cover): adjustable 18 - 39 inches
- Occupant Motion Sensor (in the center of the Cover): fixed 120 degree detection angle

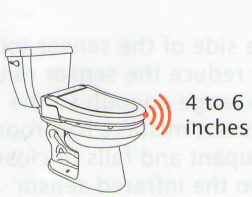

Front Sensor



Top Sensor

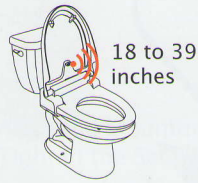

Occupant Sensors



45° upward



note: second occupant motion sensor - 120 degree horizontally and vertically

Sensor Positions:

- Front Sensor: 45 degree angle upward
- Top Sensor: Points straight up
- Occupant Sensor: Points horizontally
- Motion Sensor: 120 degree horizontally

Note: The sensors are the latest "beam" type infrared sensor. Simply break the beam as you approach (it will activate quickly). DO NOT wave at the sensors as they will not activate in order to prevent unintentional opening.

Touchless Toilet Seat

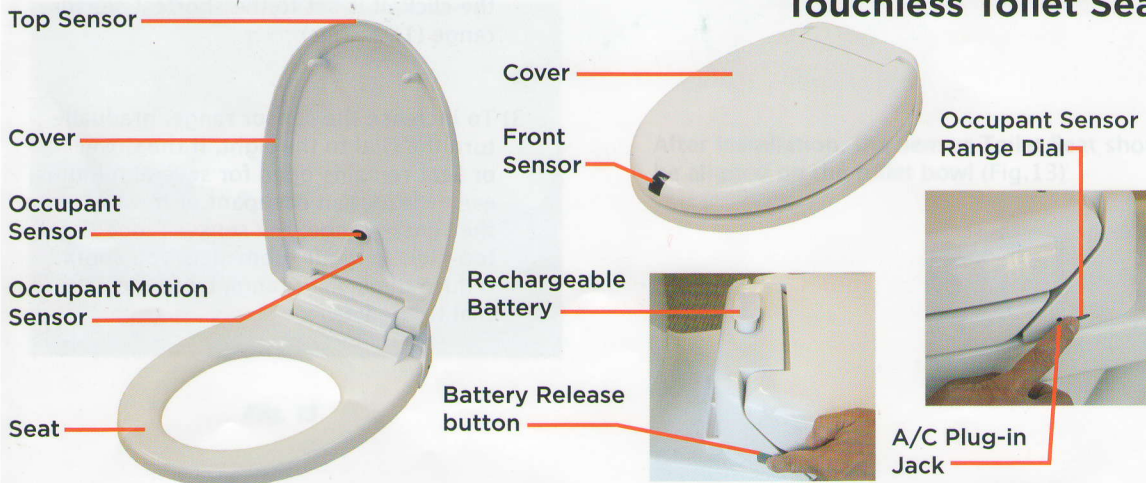

occupant sensor range adjustment

iTouchless®

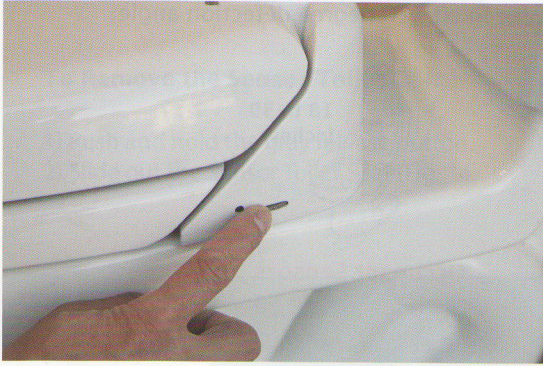

Fig. 15

Use the Dial on the side of the sensor toilet seat to increase or reduce the sensor range (Fig.15). Lower the range enough so the infrared beam does not mistake bathroom fixtures for an occupant and fails to close, and high enough so the infrared sensor detects the occupant during use and does not close unintentionally.

- 1) Turn the Dial all the way to the left to turn off the sensor toilet seat
- 2) Turn the Dial to the right to hear and feel a click sound to turn on the sensor toilet seat. Immediately after the dial has passed the click, it is set to the shortest sensor range (18 inches).
- 3) To increase the sensor range, gradually turn the Dial to the right. If the Cover or Seat remains open for several minutes, even without an occupant or movement in the sensor range, the sensor range is set too high for your room size: you should reduce the sensor range by turning the Dial to the left.



Fig. 16

1) Approach within the range of the Front Sensor, the Cover will open automatically (Fig.16)

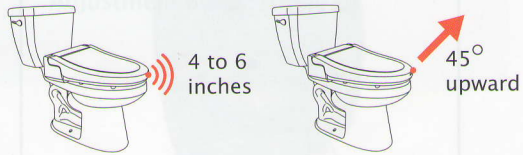

2) When the Cover is opened, put hand within the range of the Top Sensor to lift up the Seat automatically (Fig.17)



Fig. 17

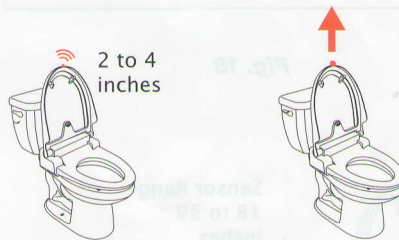

9) Put Plastic Bolt Caps into the Fasteners (Fig. 8)

(continued on the next page)



Fig. 18



Sensor Range:
18 to 39
inches

note: second occupant
motion sensor - 120 degree
horizontally and vertically

3) When the Seat is opened, put hand within the range of the Top Sensor to put the Seat down (Fig.18)

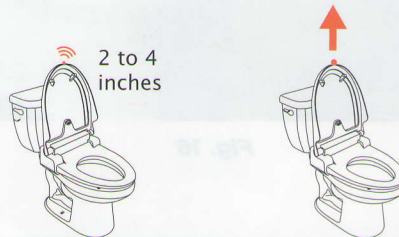

4) Both Seat and Cover will close automatically after the Occupant and Motion Sensor no longer detect an occupant and movement (blue LED light will stop blinking) for 30 seconds.

5) If only the Cover is opened, it will automatically close after both sensors no longer detect an occupant and movement for 15 seconds

6) To open or close the Seat put hand within the range of the Top Sensor at least 2 seconds after previous activation. The Seat will open or close depending on its current state.

charging the battery

iTouchless®

When the sensor toilet seat is working abnormally or the opening speed of the Cover and Seat is slower than normal, the Battery may need to be charged. The rechargeable Battery is located in the battery compartment that is on top of the back of the toilet seat.

To Charge:

If you have an electric outlet near the Sensor Toilet Seat, you can charge the Battery while it is in the battery compartment without turning off the power. Simply plug the charger into the A/C plug-in hole located next to the sensor Dial (Fig 19).

The LED light on the A/C adaptor will turn from RED to GREEN when the battery is fully charged.

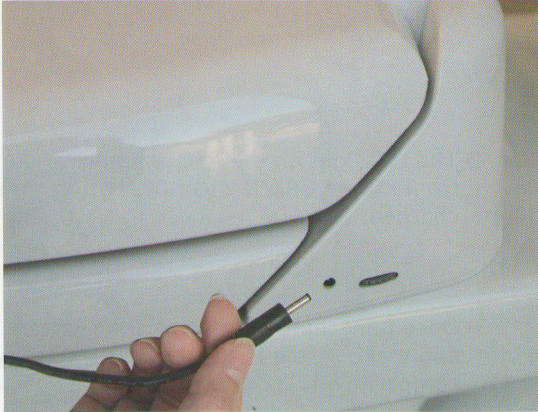

Fig. 19

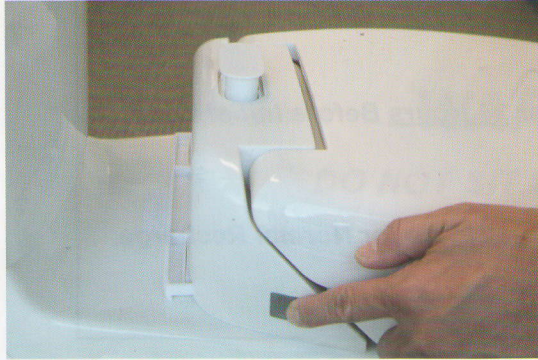

Fig. 20

If you do not have an electric outlet near the Sensor Toilet Seat, please follow the steps below to charge the battery.

- 1) Turn off the sensor toilet seat by turning the Dial all the way to the left until a click sound is heard and felt.
- 2) Push the gray release button to eject the Battery from the compartment. (Fig 20)

(continued on the next page)

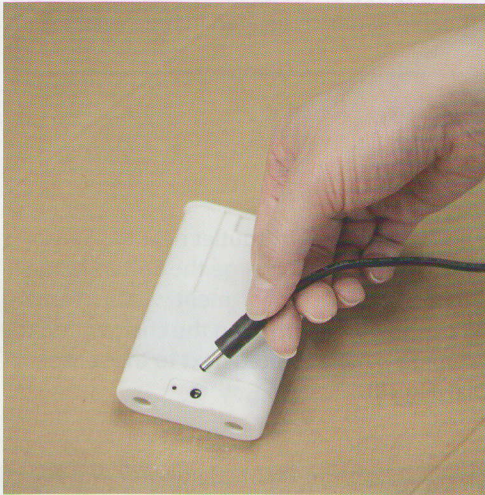

Fig. 21

3) Plug in the A/C power adaptor to the hole on the Battery and charge it in any electric outlet. (Fig.21)

4) The LED light on the A/C adaptor will turn from RED to GREEN when the battery is fully charged.

5) Once fully charged, re-insert the Battery and make sure it is secured in the battery compartment.

FOR BEST PERFORMANCE:



- Charge Battery for 24 Hours Before Initial Use

- Charge Battery for 8 Hours for Normal Recharge

RETURN POLICY



Due to the hygienic nature of this product, we cannot accept any returns for any unit that has been installed or used due to government regulations. This is a universal policy for all dealers of hygienic products. For the safety of our customers, iTouchless cannot accept product returns if the Installation Hardware Kit has been opened or if other signs of use are detected. **Once the bag of the Installation Hardware Kit has been opened, the product will be deemed non-returnable.** We also cannot accept returns of products without all originally-shipped components (installation package, instructions, etc.)

If the product has not been installed or used, and if the bag of the Installation Hardware Kit has not been opened, then we will accept returns within 30 days of the purchase date. Simply send us the package FREIGHT PREPAID by an insured carrier such as UPS or FedEx. Returned products are to be returned in the original condition with all originally packaged components. Customer is responsible for return shipping costs and refund amount is subject to a 15% restocking fee. Before returning, please contact us at www.iTouchless.com to request a RMA# and shipping instructions. We will NOT ACCEPT packages without RMA#s.

If item(s) are received in a non-resellable condition, the item may be refused for credit, depending on the condition of the item (e.g., product is damaged, shows signs of use, has been written on, has missing packaging, parts, warning labels or instructions).

Any Problems? DO NOT RETURN TO STORE. Call 1-800-660-7978 first.





iTouchless®

innovation for everyone™