



Assembly Instructions For

F2479/8+4 (E) 12/09

Extra PIN Qty.	PIN PART	PIN DESCRIPTION
12		S Hook
6		Bowtie pin
6		Head Pin

	①	②	③	④	⑤ 6 bead	⑥	⑦	⑧ 10 bead	⑨ 12 bead	⑩	⑪	⑫
Required	X1	X12	X4	X4	X8	X8	X32	X8	X8	X8	X8	X1
Extra		1	1	1	1	2	8	1	1	2	2	1

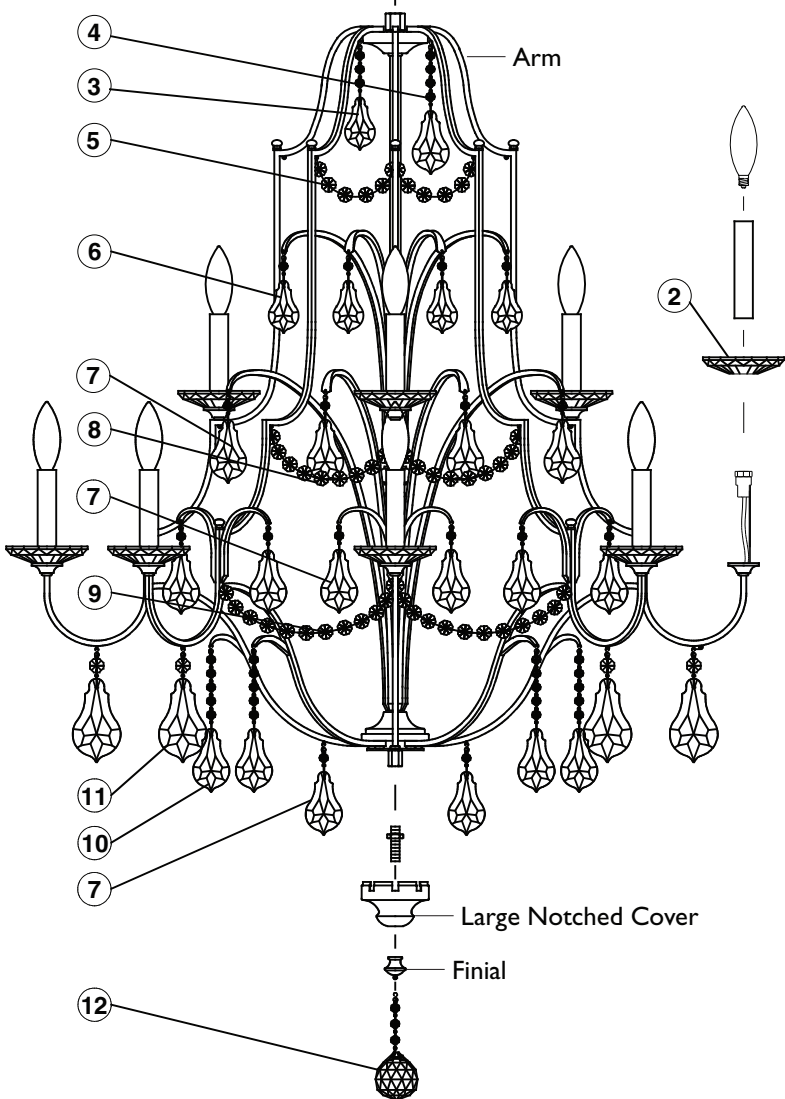
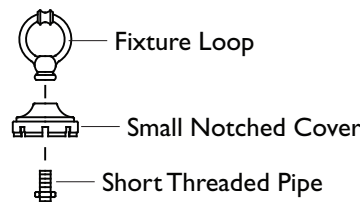
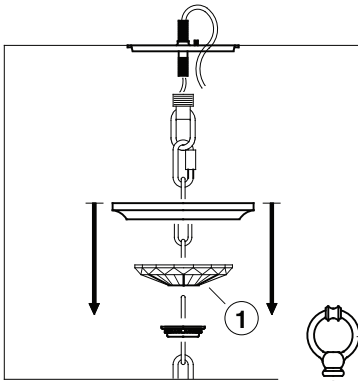

IMPORTANT

TURN OFF THE POWER AT THE MAIN FUSE OR CIRCUIT BREAKER BOX BEFORE STARTING INSTALLATION

Carefully unpack and identify all parts before assembly. Bulbs not included.

- Turn arms so they are equally spaced apart from each other.
- Install a hex nut onto one end of the short threaded pipe leaving about 3/8" (10mm) of thread exposed. Then install same end of pipe by screwing onto top of fixture. Tighten hex nut.
 - Slip small notched cover and fixture loop through fixture wires.
 - Install the small notched cover on top of fixture, making certain arms are locked onto it's notches, by fastening with fixture loop.
 - Install a hex nut onto one end of short threaded pipe leaving about 3/8" (10mm) of thread exposed. Then install same end of pipe by screwing onto bottom of fixture. Tighten hex nut.
 - Slip large notched cover through the installed threaded pipe and secure by fastening with finial. Make certain arms are locked onto it's notches before tightening finial.
- Follow enclosed supplement installation instructions for electrical and fixture installation onto house outlet box. If you do not have an outlet box at desired location to attach the fixture then hire a qualified electrician to create one. **IMPORTANT: WHEN FOLLOWING SUPPLEMENT INSTRUCTIONS STEP #6, MAKE CERTAIN TO SLIDE CRYSTAL BOBECHÉ (IN BETWEEN COLLAR RING AND CANOPY) DOWN THE CHAIN.** See above illustration.
- Install crystal bobèche by slipping through sockets.
 - Install candle tube by slipping through sockets.
 - Install type-B, candelabra base, of 60 Watt maximum bulbs (not included).
- Hang all crystal glass parts as shown on drawing. **NOTE:** To replace broken crystal or pin, extras are included in hardware bag. Replace by gently bending open pin, remove broken crystal or pin, hook new one, then close back pin. Avoid bending pin into sharp angle.