

Catalog Number
Notes
Type

FEATURES & SPECIFICATIONS

INTENDED USE — The 6" Wafer™ LED Downlight with Switchable White provides high-quality light output and efficiency featuring a switch for easy color temperature adjustment - while eliminating the need for recessed housings. The innovative, slim design allows for easy retrofit, remodel or new construction installation from below the ceiling. The Wafer LED downlight is wet location listed – making it ideal for use in a breadth of outdoor residential, hospitality, commercial and multifamily applications.

CONSTRUCTION — Aluminum die cast outer frame. Durable, powder coat paint to prevent rust. FT4 plenum rated cable connector to connect from module to remote driver box. IC rated driver with convenience and value of two remote selectable color temperature options, each with a setting choice to choose either 2700K, 3000K, and 3500K or 3000K, 4000K, and 5000K using the switch. The isolated driver integrated inside steel remote box with four 7/8" knockouts with slots for pryout. Suitable for pulling wires with the 12 cubic-inch wiring compartment to accommodate up to (6) 14 gauge insulated conductors; making the Wafer LED Downlights much easier to wire in 2in/2out (plus ground) daisy-chain applications and contractor friendly.

PATENT PENDING.

INSTALLATION — Ideal for shallow ceiling plenum; no housing required. Steel spring clip for easy installation. 6" cut out template is provided to ensure a correct sized hole is cut into ceiling for proper installation of the trim. Size of hole should not exceed 6 1/4 inches for this product. Suitable for installation in t-grid and drop ceiling applications. 2" plenum space required for installation of the remote driver box.

OPTICS — Edge-lit LED technology uses light guided plate to distribute light. Polycarbonate lens provides even illumination throughout the space.

ELECTRICAL — Connect directly to 120V power supply via provided UL recognized driver. High efficient driver with power factor > 0.9. Ambient operating temperature: -40°F (-40°C) to +104°F (+40°C). Dimming down to 10% with most standard incandescent dimmers (see list of approved dimmers). Replaces 75W incandescent for 1150L lumens and 100W incandescent for lumens.

LISTINGS — CSA certified to US and Canadian safety standards. ENERGY STAR® certified product. Wet location. Air Tight certified in accordance with ASTM E283-2004. NOM Certified. Can be used to comply with California Title 24 Part 6 High Efficacy LED light Source Requirements.

WARRANTY — 5-year limited warranty. Complete warranty terms located at: www.acuitybrands.com/CustomerResources/Terms_and_conditions.aspx

Note: Actual performance may differ as a result of end-user environment and application. All values are design or typical values, measured under laboratory conditions at 25 °C. Specifications subject to change without notice.

Specifications	
Aperture:	4.9 (12.4)
Ceiling opening:	6 (15.2)
Overlap trim:	6.7 (17)
Height:	1.1 (2.8)

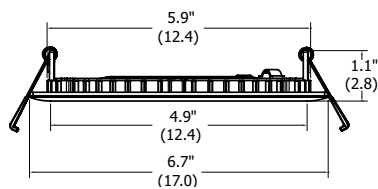

All dimensions are inches (centimeters) unless otherwise indicated.



Wafer LED Recessed Downlight

WF6

6" LED Switchable White Color Temperature

IC/Non-IC
New Construction/Remodel

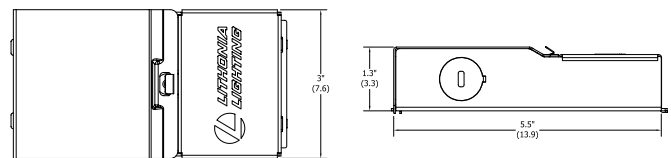

ORDERING INFORMATION

For shortest lead times, configure product using **standard options (shown in bold)**.

Example: WF4 LED 30K40K50K 90CRI MW

WF6 Series	Lamp	CCT/W/Lumens ¹	CRI	Finish
WF6 6" wafer-thin LED downlight	LL Low Lumen	27K30K35K 2700K/10W/830L 3000K/10W/900L 3500K/10W/860L 30K40K50K 3000K/10W/850L 4000K/10W/920L 5000K/10W/880L	90CRI 90CRI	MW Matte White MB Matte Black BN Brush Nickel ORB Oil-Rubbed Bronze
	LED LED	27K30K35K 2700K/14W/1040L 3000K/14W/1150L 3500K/14W/1110L 30K40K50K 3000K/14W/1090L 4000K/14W/1190L 5000K/14W/1120L		

Accessories: Order as separate catalog number.	
WF8643 Pan U	Universal new construction pan
WFJB U	Remodel joist bar



Notes
1 Total system delivered lumens.

WF6 Switchable White 6" LED Wafer Module

PHOTOMETRICS

Distribution Curve Distribution Data Output Data Coefficient of Utilization Illuminance Data at 30" Above Floor for a Single Luminaire

WF6 LED 27K30K35K, 2700K LEDs, input watts: 14, delivered lumens: 1074, LM/W=77, test no. ISF 36826P7

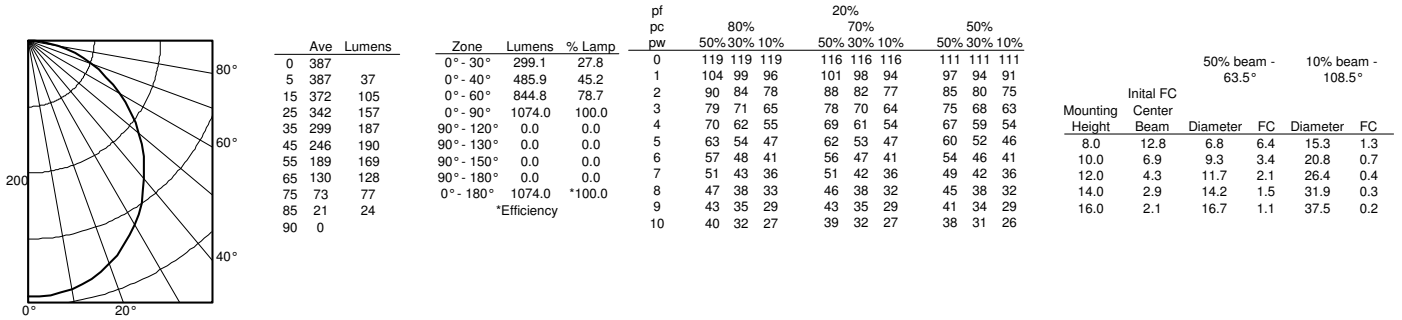

WF6 LED 27K30K35K, 3000K LEDs, input watts: 13, delivered lumens: 1207, LM/W=93, test no. ISF 36826P8

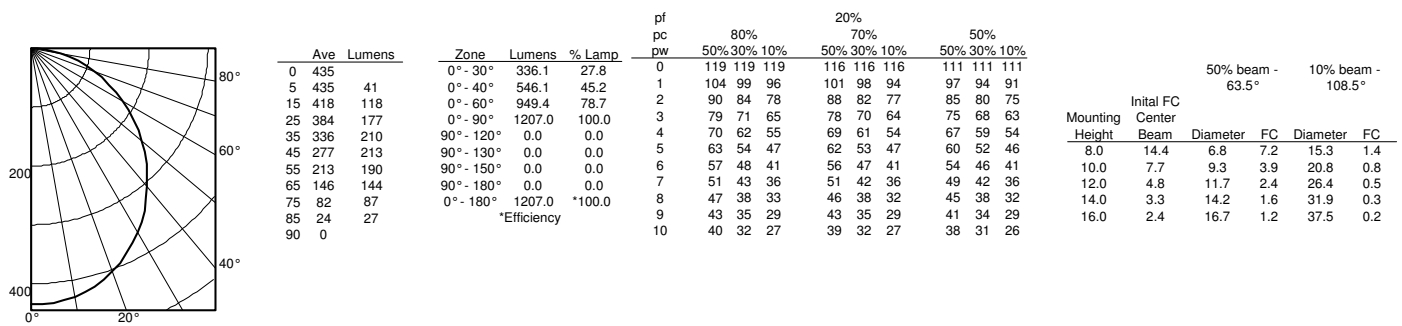

WF6 LED 27K30K35K, 3500K LEDs, input watts: 14, delivered lumens: 1141, LM/W=82, test no. ISF 36826P9

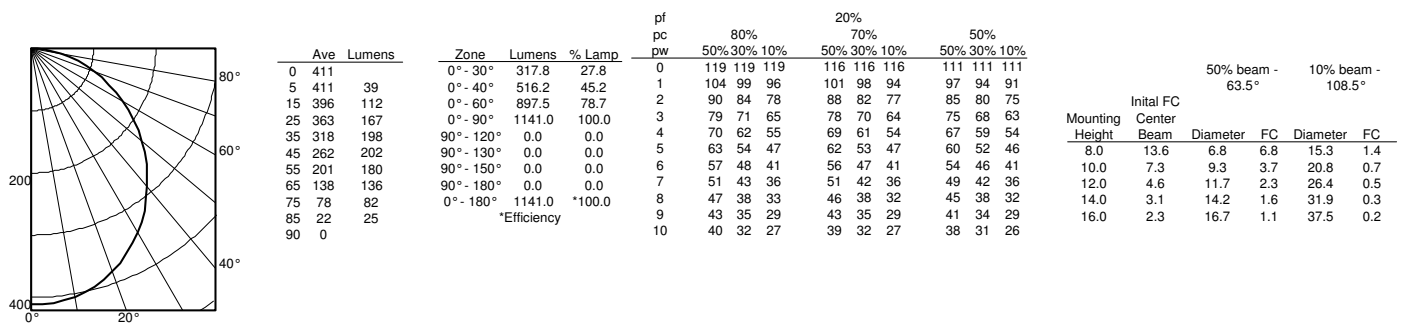

WF6 Switchable White 6" LED Wafer Module

PHOTOMETRICS

Distribution Curve Distribution Data Output Data Coefficient of Utilization Illuminance Data at 30" Above Floor for a Single Luminaire

WF6 LED 30K40K50K, 3000K LEDs, input watts: 14, delivered lumens: 1099, LM/W=79, test no. ISF 36826P10

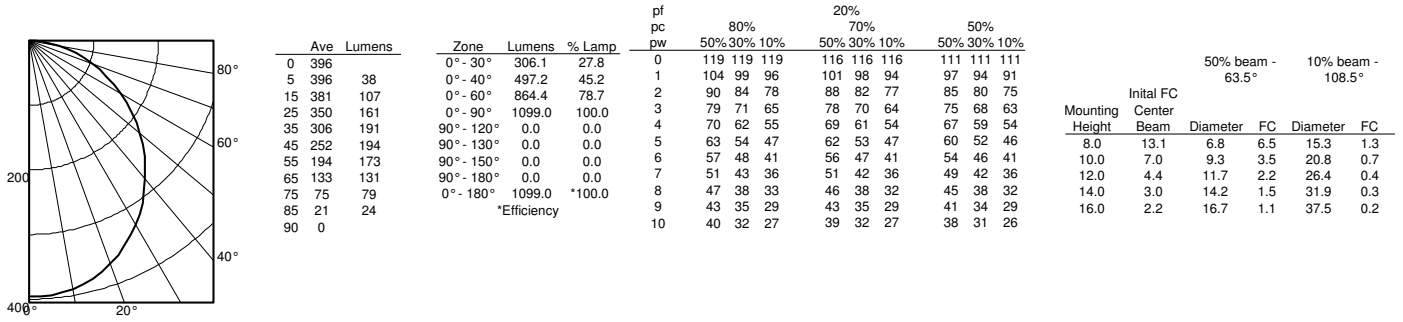

WF6 LED 30K40K50K, 4000K LEDs, input watts: 13, delivered lumens: 1199, LM/W=92, test no. ISF 36826P11

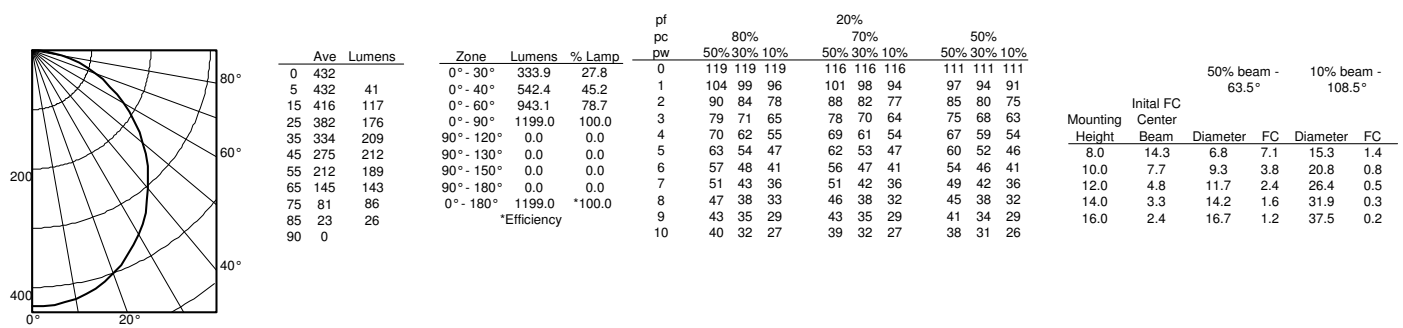

WF6 LED 30K40K50K, 5000K LEDs, input watts: 14, delivered lumens: 1127, LM/W=81, test no. ISF 36826P12

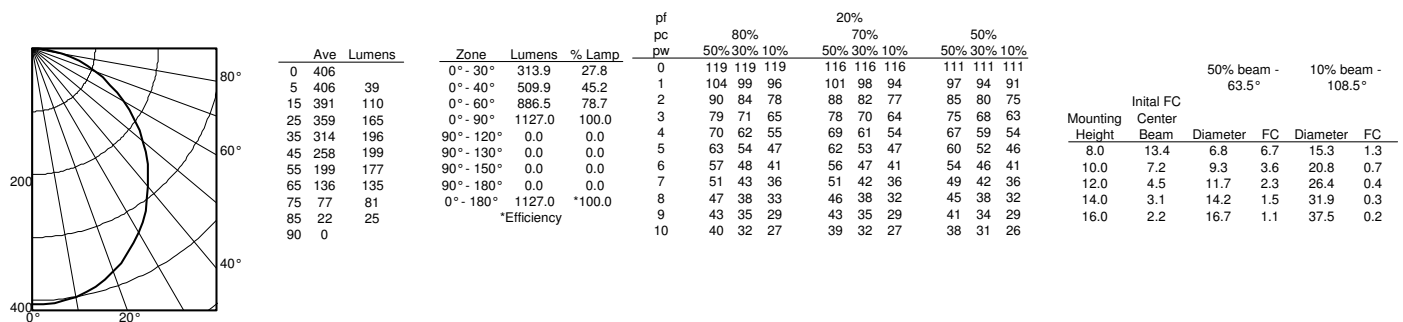

WF6 Switchable White 6" LED Wafer Module

PHOTOMETRICS

Distribution Curve	Distribution Data	Output Data	Coefficient of Utilization	lluminance Data at 30" Above Floor for a Single Luminaire				
WF6 LL LED 27K30K35K, 2700K LEDs, input watts: 10, delivered lumens: 839, LM/W=84, test no. ISF 36826P13								
	Ave Lumens	Zone Lumens % Lamp	pf pc pw	80% 50% 30% 10%	20% 50% 30% 10%	50% 50% 30% 10%	50% beam - 63.5°	10% beam - 108.5°
	0 303	0° - 30° 233.7 27.8	0 119 119 119	116 116 116	111 111 111	111 111 111		
	5 302 29	0° - 40° 379.7 45.2	1 104 99 96	101 98 94	97 94 91	85 80 75		
	15 291 82	0° - 60° 660.2 78.7	2 90 84 78	88 82 77	85 80 75	75 68 63		
	25 267 123	0° - 90° 839.3 100.0	3 79 71 65	78 70 64	67 59 54	67 59 54		
	35 234 146	90° - 120° 0.0 0.0	4 70 62 55	69 61 54	67 59 54	67 59 54		
	45 192 148	90° - 130° 0.0 0.0	5 63 54 47	62 53 47	60 52 46	60 52 46		
	55 148 132	90° - 150° 0.0 0.0	6 57 48 41	56 47 41	54 46 41	54 46 41		
	65 102 100	90° - 180° 0.0 0.0	7 51 43 36	51 42 36	49 42 36	49 42 36		
	75 57 60	0° - 180° 839.3 *100.0	8 47 38 33	46 38 32	45 38 32	45 38 32		
	85 16 18	*Efficiency	9 43 35 29	43 35 29	41 34 29	41 34 29		
90 0		10 40 32 27	39 32 27	38 31 26	38 31 26			
Mounting Height	Initial FC Center Beam	Diameter FC	Diameter FC	Diameter FC	Diameter FC			
8.0	10.0	6.8 5.0	15.3 1.0					
10.0	5.4	9.3 2.7	20.8 0.5					
12.0	3.4	11.7 1.7	26.4 0.3					
14.0	2.3	14.2 1.1	31.9 0.2					
16.0	1.7	16.7 0.8	37.5 0.2					

Distribution Curve	Distribution Data	Output Data	Coefficient of Utilization	lluminance Data at 30" Above Floor for a Single Luminaire				
WF6 LL LED 27K30K35K, 3000K LEDs, input watts: 9.7, delivered lumens: 926, LM/W=95, test no. ISF 36826P14								
	Ave Lumens	Zone Lumens % Lamp	pf pc pw	80% 50% 30% 10%	20% 50% 30% 10%	50% 50% 30% 10%	50% beam - 63.5°	10% beam - 108.5°
	0 334	0° - 30° 257.8 27.8	0 119 119 119	116 116 116	111 111 111	111 111 111		
	5 333 32	0° - 40° 418.8 45.2	1 104 99 96	101 98 94	97 94 91	85 80 75		
	15 321 90	0° - 60° 728.2 78.7	2 90 84 78	88 82 77	85 80 75	75 68 63		
	25 295 136	0° - 90° 925.8 100.0	3 79 71 65	78 70 64	67 59 54	67 59 54		
	35 258 161	90° - 120° 0.0 0.0	4 70 62 55	69 61 54	67 59 54	67 59 54		
	45 212 164	90° - 130° 0.0 0.0	5 63 54 47	62 53 47	60 52 46	60 52 46		
	55 163 146	90° - 150° 0.0 0.0	6 57 48 41	56 47 41	54 46 41	54 46 41		
	65 112 111	90° - 180° 0.0 0.0	7 51 43 36	51 42 36	49 42 36	49 42 36		
	75 63 67	0° - 180° 925.8 *100.0	8 47 38 33	46 38 32	45 38 32	45 38 32		
	85 18 20	*Efficiency	9 43 35 29	43 35 29	41 34 29	41 34 29		
90 0		10 40 32 27	39 32 27	38 31 26	38 31 26			
Mounting Height	Initial FC Center Beam	Diameter FC	Diameter FC	Diameter FC	Diameter FC			
8.0	11.0	6.8 5.5	15.3 1.1					
10.0	5.9	9.3 3.0	20.8 0.6					
12.0	3.7	11.7 1.8	26.4 0.4					
14.0	2.5	14.2 1.3	31.9 0.3					
16.0	1.8	16.7 0.9	37.5 0.2					

Distribution Curve	Distribution Data	Output Data	Coefficient of Utilization	lluminance Data at 30" Above Floor for a Single Luminaire				
WF6 LL LED 27K30K35K, 3500K LEDs, input watts: 9.9, delivered lumens: 893, LM/W=90, test no. ISF 36826P15								
	Ave Lumens	Zone Lumens % Lamp	pf pc pw	80% 50% 30% 10%	20% 50% 30% 10%	50% 50% 30% 10%	50% beam - 63.5°	10% beam - 108.5°
	0 322	0° - 30° 248.5 27.8	0 119 119 119	116 116 116	111 111 111	111 111 111		
	5 321 31	0° - 40° 403.7 45.2	1 104 99 96	101 98 94	97 94 91	85 80 75		
	15 309 87	0° - 60° 701.9 78.7	2 90 84 78	88 82 77	85 80 75	75 68 63		
	25 284 131	0° - 90° 892.3 100.0	3 79 71 65	78 70 64	67 59 54	67 59 54		
	35 249 155	90° - 120° 0.0 0.0	4 70 62 55	69 61 54	67 59 54	67 59 54		
	45 205 158	90° - 130° 0.0 0.0	5 63 54 47	62 53 47	60 52 46	60 52 46		
	55 157 140	90° - 150° 0.0 0.0	6 57 48 41	56 47 41	54 46 41	54 46 41		
	65 108 107	90° - 180° 0.0 0.0	7 51 43 36	51 42 36	49 42 36	49 42 36		
	75 61 64	0° - 180° 892.3 *100.0	8 47 38 33	46 38 32	45 38 32	45 38 32		
	85 17 20	*Efficiency	9 43 35 29	43 35 29	41 34 29	41 34 29		
90 0		10 40 32 27	39 32 27	38 31 26	38 31 26			
Mounting Height	Initial FC Center Beam	Diameter FC	Diameter FC	Diameter FC	Diameter FC			
8.0	10.6	6.8 5.3	15.3 1.1					
10.0	5.7	9.3 2.9	20.8 0.6					
12.0	3.6	11.7 1.8	26.4 0.4					
14.0	2.4	14.2 1.2	31.9 0.2					
16.0	1.8	16.7 0.9	37.5 0.2					

WF6 Switchable White 6" LED Wafer Module

PHOTOMETRICS

Distribution Curve	Distribution Data	Output Data	Coefficient of Utilization	Illuminance Data at 30" Above Floor for a Single Luminaire										
WF6 LL LED 30K40K50K, 3000K LEDs, input watts: 10, delivered lumens: 855, LM/W=85, test no. ISF 36826P16														
	Ave Lumens	Zone Lumens % Lamp	pf pc pw	80%			20%			50%			50% beam - 63.5° 10% beam - 108.5° Initial FC Mounting Height Center Beam Diameter FC Diameter FC	
	0	308	0° - 30° 238.1 27.8	0	119	119	119	116	116	116	111	111		111
	5	308	0° - 40° 386.9 45.2	1	104	99	96	101	98	94	97	94		91
	15	296	0° - 60° 672.6 78.7	2	90	84	78	88	82	77	85	80		75
	25	272	0° - 90° 855.1 100.0	3	79	71	65	78	70	64	75	68		63
	35	238	90° - 120° 0.0 0.0	4	70	62	55	69	61	54	67	59		54
	45	196	90° - 130° 0.0 0.0	5	63	54	47	62	53	47	60	52		46
	55	151	90° - 150° 0.0 0.0	6	57	48	41	56	47	41	54	46		41
	65	104	90° - 180° 0.0 0.0	7	51	43	36	51	42	36	49	42		36
	75	58	0° - 180° 855.1 *100.0	8	47	38	33	46	38	32	45	38		32
	85	17	*Efficiency	9	43	35	29	43	35	29	41	34		29
90	0		10	40	32	27	39	32	27	38	31	26		

WF6 LL LED 30K40K50K, 4000K LEDs, input watts: 10, delivered lumens: 923, LM/W=92, test no. ISF 36826P17														
	Ave Lumens	Zone Lumens % Lamp	pf pc pw	80%			20%			50%			50% beam - 63.5° 10% beam - 108.5° Initial FC Mounting Height Center Beam Diameter FC Diameter FC	
	0	333	0° - 30° 257.0 27.8	0	119	119	119	116	116	116	111	111		111
	5	332	0° - 40° 417.5 45.2	1	104	99	96	101	98	94	97	94		91
	15	320	0° - 60° 725.9 78.7	2	90	84	78	88	82	77	85	80		75
	25	294	0° - 90° 922.9 100.0	3	79	71	65	78	70	64	75	68		63
	35	257	90° - 120° 0.0 0.0	4	70	62	55	69	61	54	67	59		54
	45	212	90° - 130° 0.0 0.0	5	63	54	47	62	53	47	60	52		46
	55	163	90° - 150° 0.0 0.0	6	57	48	41	56	47	41	54	46		41
	65	112	90° - 180° 0.0 0.0	7	51	43	36	51	42	36	49	42		36
	75	63	0° - 180° 922.9 *100.0	8	47	38	33	46	38	32	45	38		32
	85	18	*Efficiency	9	43	35	29	43	35	29	41	34		29
90	0		10	40	32	27	39	32	27	38	31	26		

WF6 LL LED 30K40K50K, 5000K LEDs, input watts: 10, delivered lumens: 886, LM/W=87, test no. ISF 36826P18														
	Ave Lumens	Zone Lumens % Lamp	pf pc pw	80%			20%			50%			50% beam - 63.5° 10% beam - 108.5° Initial FC Mounting Height Center Beam Diameter FC Diameter FC	
	0	319	0° - 30° 246.8 27.8	0	119	119	119	116	116	116	111	111		111
	5	319	0° - 40° 400.9 45.2	1	104	99	96	101	98	94	97	94		91
	15	307	0° - 60° 697.1 78.7	2	90	84	78	88	82	77	85	80		75
	25	282	0° - 90° 886.2 100.0	3	79	71	65	78	70	64	75	68		63
	35	247	90° - 120° 0.0 0.0	4	70	62	55	69	61	54	67	59		54
	45	203	90° - 130° 0.0 0.0	5	63	54	47	62	53	47	60	52		46
	55	156	90° - 150° 0.0 0.0	6	57	48	41	56	47	41	54	46		41
	65	107	90° - 180° 0.0 0.0	7	51	43	36	51	42	36	49	42		36
	75	60	0° - 180° 886.2 *100.0	8	47	38	33	46	38	32	45	38		32
	85	17	*Efficiency	9	43	35	29	43	35	29	41	34		29
90	0		10	40	32	27	39	32	27	38	31	26		

WF6 Switchable White 6" LED Wafer Module

ENERGY DATA

WF6 LED 27K30K35K			
Color Temperature	2700K	3000K	3500K
Lumens	1070	1150	1110
CRI	90	90	90
Rated wattage	14.1	13.4	13.9
Lu/Watts	75.9	85.8	79.9
Min. starting temp	-40°C (-40°F)	-40°C (-40°F)	-40°C (-40°F)
EMI/RFI	FCC Title 47 CFR, Part 15, Class B	FCC Title 47 CFR, Part 15, Class B	FCC Title 47 CFR, Part 15, Class B
Sound rating	Class A Standards	Class A Standards	Class A Standards
Input voltage	120V	120V	120V
Min. power factor	0.98	0.98	0.98
Input frequency	50/60 Hz	50/60 Hz	50/60 Hz
Input power	120V	120V	120V
Input current	0.12A	0.12A	0.12A

WF6 LL 27K30K35K			
Color Temperature	2700K	3000K	3500K
Lumens	830	900	860
CRI	90	90	90
Rated wattage	10	9.7	9.9
Lu/Watts	83.0	92.8	86.9
Min. starting temp	-40°C (-40°F)	-40°C (-40°F)	-40°C (-40°F)
EMI/RFI	FCC Title 47 CFR, Part 15, Class B	FCC Title 47 CFR, Part 15, Class B	FCC Title 47 CFR, Part 15, Class B
Sound rating	Class A Standards	Class A Standards	Class A Standards
Input voltage	120V	120V	120V
Min. power factor	0.98	0.98	0.98
Input frequency	50/60 Hz	50/60 Hz	50/60 Hz
Input power	120V	120V	120V
Input current	0.08A	0.08A	0.08A

WF6 LED 30K40K50K			
Color Temperature	3000K	4000K	5000K
Lumens	1090	1190	1120
CRI	90	90	90
Rated wattage	13.8	13.4	13.9
Lu/Watts	79.0	88.8	80.6
Min. starting temp	-40°C (-40°F)	-40°C (-40°F)	-40°C (-40°F)
EMI/RFI	FCC Title 47 CFR, Part 15, Class B	FCC Title 47 CFR, Part 15, Class B	FCC Title 47 CFR, Part 15, Class B
Sound rating	Class A Standards	Class A Standards	Class A Standards
Input voltage	120V	120V	120V
Min. power factor	0.98	0.98	0.98
Input frequency	50/60 Hz	50/60 Hz	50/60 Hz
Input power	120V	120V	120V
Input current	0.12A	0.12A	0.12A

WF6 LL 30K40K50K			
Color Temperature	3000K	4000K	5000K
Lumens	850	920	880
CRI	90	90	90
Rated wattage	9.9	9.8	10
Lu/Watts	85.9	93.9	88.0
Min. starting temp	-40°C (-40°F)	-40°C (-40°F)	-40°C (-40°F)
EMI/RFI	FCC Title 47 CFR, Part 15, Class B	FCC Title 47 CFR, Part 15, Class B	FCC Title 47 CFR, Part 15, Class B
Sound rating	Class A Standards	Class A Standards	Class A Standards
Input voltage	120V	120V	120V
Min. power factor	0.98	0.98	0.98
Input frequency	50/60 Hz	50/60 Hz	50/60 Hz
Input power	120V	120V	120V
Input current	0.08A	0.08A	0.08A

WF6 Switchable White 6" LED Wafer Module

LIGHTING PERFORMANCE DATA



LOW LUMEN

LIGHTING PERFORMANCE DATA DONNÉES SUR LE RENDEMENT DE L'ÉCLAIRAGE	
Light Appearance (CCT) Aspect de la lumière (CCT)	
2700K soft white blanc doux	
830 lumens 83 lumens per watt	
3000K warm white blanc chaud	
900 lumens 90 lumens per watt	
3500K neutral white blanc neutre	
860 lumens 86 lumens per watt	
Watts	10
Color Accuracy (CRI)	90
Précision des couleurs (CRI)	

LIGHTING PERFORMANCE DATA DONNÉES SUR LE RENDEMENT DE L'ÉCLAIRAGE	
Light Appearance (CCT) Aspect de la lumière (CCT)	
3000K warm white blanc chaud	
850 lumens 85 lumens per watt	
4000K cool white blanc froid	
920 lumens 92 lumens per watt	
5000K daylight blanc neutre	
880 lumens 88 lumens per watt	
Watts	10
Color Accuracy (CRI)	90
Précision des couleurs (CRI)	



HIGH LUMEN

LIGHTING PERFORMANCE DATA DONNÉES SUR LE RENDEMENT DE L'ÉCLAIRAGE	
Light Appearance (CCT) Aspect de la lumière (CCT)	
2700K soft white blanc doux	
1070 lumens 76 lumens per watt	
3000K warm white blanc chaud	
1150 lumens 82 lumens per watt	
3500K neutral white blanc neutre	
1110 lumens 79 lumens per watt	
Watts	14
Color Accuracy (CRI)	90
Précision des couleurs (CRI)	

LIGHTING PERFORMANCE DATA DONNÉES SUR LE RENDEMENT DE L'ÉCLAIRAGE	
Light Appearance (CCT) Aspect de la lumière (CCT)	
3000K warm white blanc chaud	
1090 lumens 78 lumens per watt	
4000K cool white blanc froid	
1190 lumens 85 lumens per watt	
5000K daylight blanc neutre	
1120 lumens 80 lumens per watt	
Watts	14
Color Accuracy (CRI)	90
Précision des couleurs (CRI)	