

CHAMBERLAIN®

MULTI-FUNCTION JUMP STARTER

MODEL CA1000

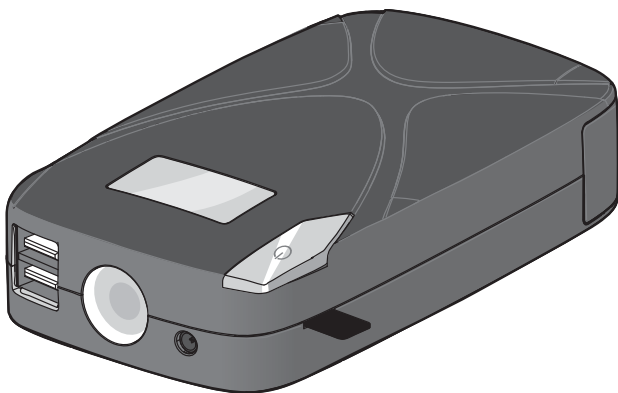

www.chamberlain.com

The Chamberlain Group, Inc.
845 Larch Avenue
Elmhurst, Illinois 60126-1196

INTRODUCTION

Thank you for purchasing the Chamberlain Multi-Function Jump Starter. Backed by Chamberlain's commitment to quality and innovation, you now have the security of knowing you won't be left stranded if your vehicle won't start because of a dead battery. In addition, the Chamberlain Multi-Function Jump Starter can be used every day to charge or power your mobile electronics. Visit www.chamberlain.com to learn more about Chamberlain and what we do to provide products that empower you and give you peace of mind.

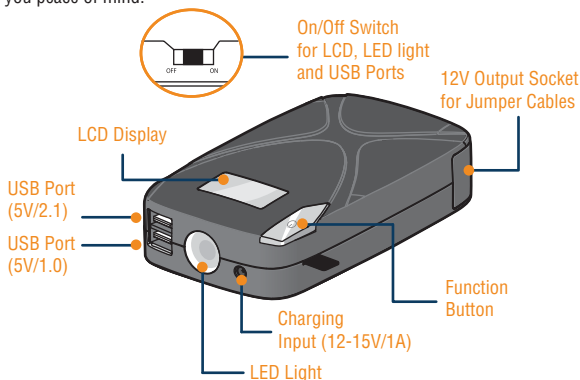

INCLUDES



Wall Charger



12V Car Charger

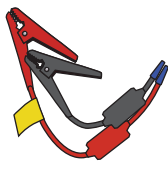

Jumper Cables

SAFETY INFORMATION



WARNING

Mechanical



WARNING

Electrical

When you see these Safety Symbols and Signal Words on the following pages, they will alert you to the possibility of the risk of injury or property damage. When you see this Signal Word on the following pages, it will alert you to the possibility of risk of injury or damage to the Jump Starter. Read them Carefully.

IMPORTANT OPERATION INSTRUCTIONS



WARNING

To reduce the risk of SEVERE INJURY or PROPERTY DAMAGE:

1. READ AND FOLLOW ALL INSTALLATION WARNINGS AND INSTRUCTIONS.

2. **SAVE THESE INSTRUCTIONS.**

Battery Warnings

1. RISK OF EXPLOSIVE GASES:
 - Car batteries can generate explosive gases during normal battery operation. It is important that you follow the instructions each time you use the starter.
 - To reduce risk of battery explosion, follow ALL instructions and warnings on the Jump Starter and the vehicle manufacturer instructions when jump starting a vehicle.
2. DO NOT touch eyes while working near batteries.
3. NEVER smoke or allow a spark or flame in the vicinity of battery or engine.
4. DO NOT drop ANY metal tools onto the battery. It might spark or short-circuit battery or other electrical part that may cause explosion.
5. NEVER wear watches, rings, bracelets, or necklaces when working with car batteries. Batteries can produce a shortcircuit current high enough to weld a ring or the like to metal, causing a severe burn.
6. Do NOT use or charge Jump Starter if damaged, cracked, or swollen.

Usage Warnings

1. DO NOT plug the jumper cables into the Jump Starter prior to attaching to the vehicle battery terminals.
2. DO NOT touch the red and black jumper clamps together or connect both to the same piece of metal to prevent physical injury or damage to the vehicle or the Jump Starter.
3. DO NOT pull on the car charger cable when removing it.
4. Disconnect the jump starter from the battery after starting the vehicle.
5. DO NOT attempt to jump start a vehicle more than 3 consecutive times.
6. DO NOT operate the Jump Starter if ANY cord, plug, or jumper cable is damaged.

Product Warnings

1. DO NOT store with the jumper clamps attached to each other.
2. DO NOT disassemble this product.
3. DO NOT insert screwdrivers or other items into the product.
4. DO NOT expose to rain or snow.
5. Remove from your vehicle and store in your home if the temperature falls outside of -5F to 140F (-20C to +60C).
6. Except for USB cables DO NOT use ANY other cords/ cables NOT provided with this product.
7. This product is not intended to be used by children.

OPERATION AND FEATURES

CHARGING THE JUMP STARTER

1. Connect 12V car charger or the wall charger to the charging input for the Jump Starter.
2. Slide the On/Off switch to the 'On' position. The LCD display will light up and begin to flash, indicating normal charging has begun. The LCD display says "IN" while charging.
3. The Jump Starter will be fully charged in 2 – 3 hours and the LCD display will show 100%.
4. Slide the On/Off switch to the 'Off' position and disconnect the 12V car charger.

NOTE: Charge the Multi-Function Jump Starter every 30 days or whenever the charge level drops below 85% to be sure your Multi-Function Jump Starter will be ready when you need it.

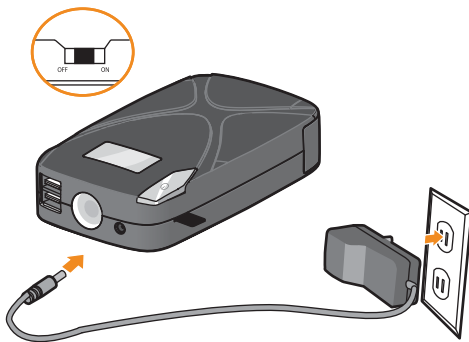

OR

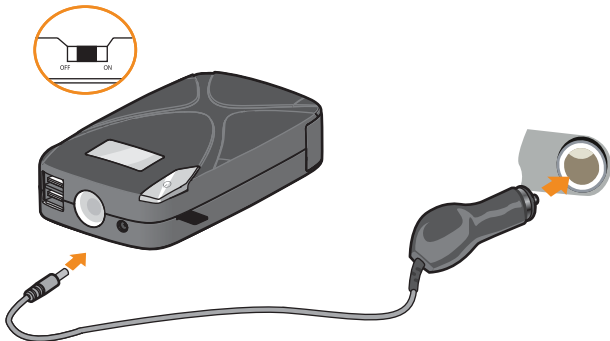

JUMPSTARTING A VEHICLE

WARNING

To reduce the risk SEVERE INJURY or PROPERTY DAMAGE:

- Attach jumper cables to a battery and vehicle chassis as indicated below. Jump Starter is intended for a NEGATIVELY GROUNDED vehicle.
- DO NOT touch the red and black jumper clamps together.
- Keep jumper cables away from moving engine parts.
- Stay clear of fan blades, belts, pulleys, and other parts that can cause injury to persons.
- Check polarity of battery posts. Positive is red, and negative is black.
- ONLY connect red (POSITIVE) clamp from jump starter to POSITIVE post of the car battery (POS, P, +, RED) and the black (NEGATIVE) clamp from jump starter to NEGATIVE post of the car battery (NEG, N, -, BLACK). DO NOT connect jumper clamp to carburetor, fuel lines, or sheet-metal body parts.
- After the vehicle has started, disconnect the jumper cables from the Jump Starter prior to removing the jumper clamps from the battery posts.
- DO NOT attempt to jump start your vehicle more than three consecutive times. If the vehicle will not start after three attempts, consult a mechanic.

1. Slide the On/Off switch to the 'On' position. Check the charge level displayed on the LCD display. The minimum charge required to jump start a vehicle is 40%. It is not necessary to have the switch in the "On" position to jump start a vehicle.
2. Connect the red jumper clamp to the positive (+) terminal on the car battery.
3. Connect the black jumper cable clamp to the negative (-) terminal on the car battery.
4. Connect the battery clamp assembly plug to the 12V Jump Starter.
5. Start the vehicle. If the vehicle does not start within few seconds, turn the key off and wait a minute before attempting to start the vehicle again.

NOTE: DO NOT attempt to jump start your vehicle more than three consecutive times. If the vehicle will not start after three attempts, consult a mechanic.

1. Once the vehicle is running, disconnect the jumper cables from the Jump Starter.
2. Remove the jumper clamps from the vehicle's positive and negative terminals.
3. Slide the On/Off switch to the 'Off' position if it is ON.
4. Be sure to recharge the Jumper Starter prior to using it again.

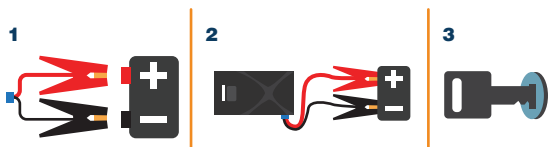

CHARGING A MOBILE DEVICE:

1. Connect a mobile device cable to the appropriate USB port on the Jump Starter. Consult your mobile device's manufacturer for proper charging power specifications.
2. Slide the On/Off switch to the 'On' position. Press and release the Function button to begin charging.
3. Time required to achieve a full charge varies based on the size of the battery in the mobile device and the USB charging port used.

NOTE: Most devices will work with either USB port but may charge at a slower rate.

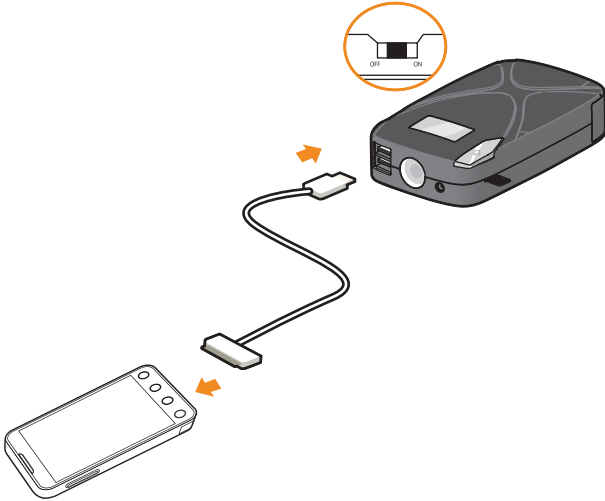

USING THE EMERGENCY LED LIGHTING:

Slide the On/Off switch 'On' position. Press and hold the Function button for 3 seconds until the LED light glows steadily. Once the LED light is turned on, press and release the Function button to cycle through the following modes.

- LED flashes an SOS distress signal.
- LED flashes in strobe mode.
- LED light turns off.
- LED glows steadily.

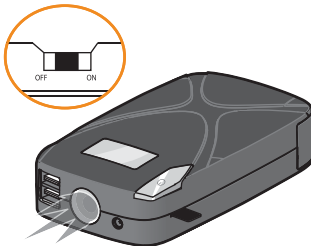

TROUBLESHOOTING

The Jump Starter will not turn on.

Charge the Jump Starter.

The Jump Starter will not charge.

Make sure to use the 12V car charger or wall charger provided. The LCD display says "IN" when it is charging the Jump Starter.

The Jump Starter will turn on, but will not jump start my vehicle.

Slide the On/Off switch to the 'On' position. Press and release the Function button. Verify the charge level of the Jump Starter is at least 40%. Do not attempt to jump start your vehicle more than three consecutive times. If the vehicle still will not start, consult a mechanic.

SPECIFICATIONS

Output voltage: 12V

Start Current: 200A

Peak Current: 400A

Cycle life: 1000 times

USB output: 5V 2.1 A/1.0 A

Charge input: 12-15V/1A

Operating temperature range: -5°F to 140°F (-20°C to +60°C)

Dimensions: 5.3" X 3.05" X 1.28"
(134.7mm X 77.5MM X 32.6mm)

NOTICE: To comply with FCC rules, adjustment or modifications of this digital device are prohibited. THERE ARE NO OTHER USER SERVICEABLE PARTS. Any changes or modifications not expressly approved by the party responsible for compliance could void the user's authority to operate the equipment.

This device complies with Part 15 of the FCC rules. Operation is subject to the following two conditions: (1) this device may not cause harmful interference, and (2) this device must accept any interference received, including interference that may cause undesired operation.

WARRANTY

ONE YEAR LIMITED WARRANTY

PLEASE DO NOT RETURN TO THE STORE

If you have questions or need help call 1-800-528-9131.

WWW.CHAMBERLAIN.COM

