

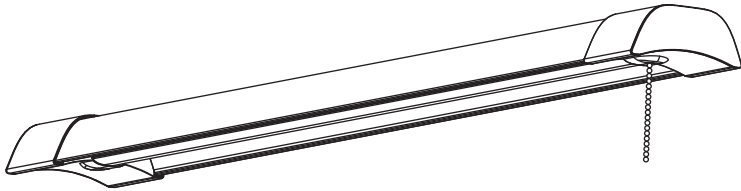

USE AND CARE GUIDE

4 FT. LED SHOP LIGHT



Questions, problems, missing parts, before returning to the store,
call Commercial Electric Customer Service
8 a.m. – 6 p.m., EST, Monday - Friday

1-877-527-0313

HOMEDEPOT.COM

THANK YOU

We appreciate the trust and confidence you have placed in Commercial Electric through the purchase of this LED Light. We strive to continually create quality products designed to enhance your home. Visit us online to see our full line of products available for your home improvement needs. Thank you for choosing Commercial Electric!

Table of Contents

Table of Content	2	Tools Required	4
Safety Information	2	Hardware Included	4
Troubleshootin	2	Installation	5
Warranty	3	Link the Fixtures	7
Pre-Installation	4		
Planning Installation.....	4		

Safety Information



WARNING: Carefully read and understand the information given in this manual before beginning the assembly and installation. Failure to do so could lead to electric shock, fire, or other injuries which could be hazardous or even fatal.



WARNING: Ensure the electricity to the wires you are working on is shut off. Either remove the fuse or turn off the circuit breaker.



- WARNING:**
1. Use hook to support chain, not the electrical cord.
 2. Do not install on radiant-heating type ceiling.
 3. Voltage and current rating of shoplight: 120VAC 1200mA 50W 60HZ
 4. Maximum 2 units to be interconnected.
 5. The maximum distance to the receptacle is determined by the 5 foot length of cord provided.
 6. The terminal of the last fixture needs to be closed by the end cap. Live parts cannot touch hands.
 7. Starts reliably to 0°F



WARNING: This product must be installed in accordance with the applicable installation code by a person familiar with the construction and operation of the product and the hazards involved.



WARNING: The unit is intended to be installed directly beneath a ceiling-mounted receptacle, and that excess cord should be kept out of the work space, such as by securing it to one of the supporting chains with a cable tie.



WARNING: Changes or modifications not expressly approved by the party responsible for compliance could void the user's authority to operate the equipment.



NOTICE: Added weight of the device may cause instability of a free-standing portable luminaire. This device is not intended for use with emergency exits.



WARNING: This equipment has been tested and found to comply with the limits for a Class B digital device, pursuant to Part 15 of the FCC Rules. These limits are designed to provide reasonable protection against harmful interference in a residential installation.

This equipment generates, uses and can radiate radio frequency energy and, if not installed and used in accordance with the instructions, may cause harmful interference to radio communications.

However, there is no guarantee that interference will not occur in a particular installation. If this equipment does cause harmful interference to radio or television reception, which can be determined by turning the equipment off and on, the user is encouraged to try to correct the interference by one or more of the following measures:

- Reorient or relocate the receiving antenna
- Increase the separation between the equipment and the receiver.
- Connect the equipment into an outlet on a circuit different from that to which the receiver is connected.
- Consult the dealer or an experienced radio/TV technician for help.



CAUTION: A caution that the hooks are to engage the chain only and not the electric cord shall be included.

Troubleshooting

Minor problems often can be fixed without the help of an electrician.



WARNING: Before doing any work on the fixture, shut off power supply at the circuit panel to avoid electrical shock.

Problem	Possible Cause	Corrective Action
The fixture does not light.	The power is off.	Check if power supply is on.
	There is a bad wire connection.	Check the wiring.
	The switch is defective.	Test or replace the switch.

Warranty

WHAT IS COVERED

The manufacturer warrants this lighting fixture to be free from defects in materials and workmanship for a period of five (5) years from date of purchase. This warranty applies only to the original consumer purchaser and only to products used in normal use and service. If this product is found to be defective, the manufacturer's only obligation, and your exclusive remedy, is the repair or replacement of the product at the manufacturer's discretion, provided that the product has not been damaged through misuse, abuse, accident, modifications, alterations, neglect, or mishandling.

WHAT IS NOT COVERED

This warranty shall not apply to any product that is found to have been improperly installed, set-up, or used in any way not in accordance with the instructions supplied with the product. This warranty shall not apply to a failure of the product as a result of an accident, misuse, abuse, negligence, alteration, faulty installation, or any other failure not relating to faulty material or workmanship. This warranty shall not apply to the finish on any portion of the product, such as surface and/or weathering, as this is considered normal wear and tear.

The manufacturer does not warrant and specifically disclaims any warranty, whether express or implied, of fitness for a particular purpose, other than the warranty contained herein. The manufacturer specifically disclaims any liability and shall not be liable for any consequential or incidental loss or damage, including but not limited to any labor / expense costs involved in the replacement or repair of said product.

Contact the Customer Service Team at 1-877-527-0313 or visit www.HomeDepot.com.

Specifications

Model No.	Volts (V)	Frequency (Hz)	Watts (W)	Current(mA)
WS-LF1aA50DL1	120	50/60	50	1050

Pre-Installation

PLANNING INSTALLATION



WARNING: Shut off power at the circuit breaker or fuse panel before removing the old fixture.

If you are unfamiliar with electrical installations, we recommend you have a qualified electrician do your installation.

PRODUCT DESCRIPTION AND CHARACTERISTICS

LED Shop Light can be mounted to the shop or garage ceiling and requires little space. It is energy-saving, environmentally friendly, and used for emitting soft and even distribution of light.



NOTE: Keep your receipt and these instructions for proof of purchase.

TOOLS REQUIRED

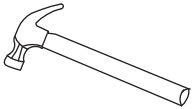

Hammer

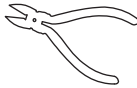

Wire cutter

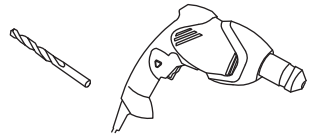

Power Drill



Pencil



Ruler

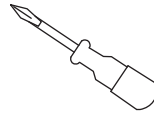

Phillips screwdriver



NOTE: Hardware not shown to actual size.

HARDWARE INCLUDED



AA



BB

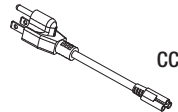

CC



DD



EE



KK



FF



GG



HH



II

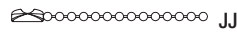

JJ

Part	Description	Quantity
AA	Fixture	1
BB	Suspension Wire	2
CC	5ft Power Cord	1
DD	dry wall anchor	2
EE	Mounting Screw M4x32mm	2

FF	Cable gripper	2
GG	Cable fitting	2
HH	Locking screw	2
II	Linkable connector	1
JJ	36in expansion pull chain	1
KK	Fixture connect screw	1

1 Mounting to drywall

- Drill two holes in the ceiling with a spacing of 4.09in apart.
- Use a hammer to knock the dry wall anchors (DDx2) into the holes.

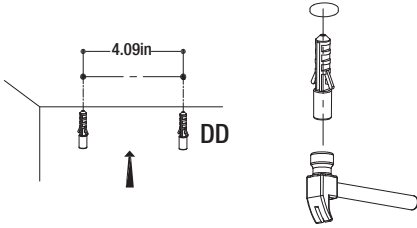

2 Attaching the suspension wires to the ceiling

- Place mounting screws (EE) inside the cable fitting (GG).
- Screw assembly into dry wall anchor (DD).
- Change screw label from FF to EE.

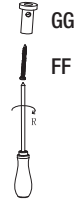

3 Assembly cable gripper (FF)

- Locate the end of suspension wire (BB) without the enclosed tip.
- Thread cable gripper (FF) onto suspension wire (BB) with screw thread facing down.
- Pull cable gripper (FF) to the end of suspension wire (BB).
- Thread fixture connect screw (KK) into cable gripper (FF).

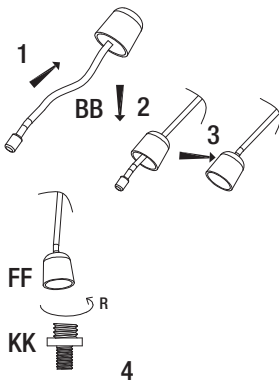

4 Determine the installation length.

- Thread the locking screw (HH) onto the suspension wire (BB), and pull down to desired hanging length. To adjust length upward, press center adjustment button on locking screw (HH).
- Thread suspension wire (BB) through hole on cable fitting (GG).
- Screw locking screw (HH) into cable fitting (GG).
- For a finished look, cut the extra wire from top of cable fitting (GG).

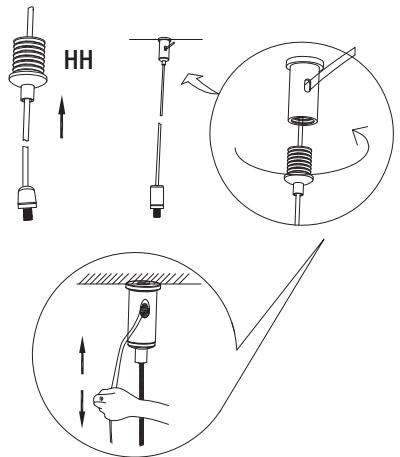

5 Attaching suspension wire to fixture.

- Hang the fixture body to the ceiling by screwing the cable gripper (FF) to the threading on the fixture body located on both ends.

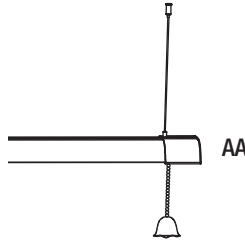
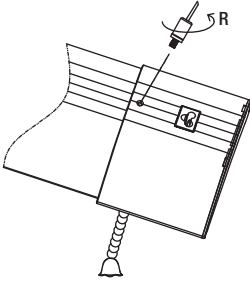

6 Connecting fixture to power supply.

- After installation, plug the power cord (CC) into the power outlet.
- If connecting fixture to junction box, turn off power.
- Use a wire stripper to cut the plug end off of the power cord and strip the wire.
- Connect the three wires coming from the power supply cord to the junction box (black to black, white to white, and green/ground to ground).
- Screw the mounting plate to junction box.
Note: Mounting plate is not included.
- Turn power back on when installation is complete.
- Pull chain down to turn on light fixture.

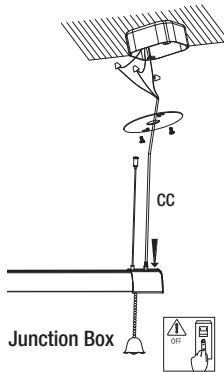
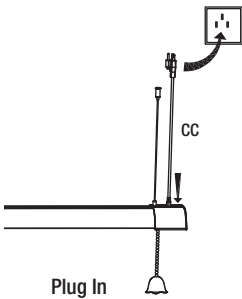

Link the fixtures

- 1** Remove the side cover of fixture end cap with a screwdriver.

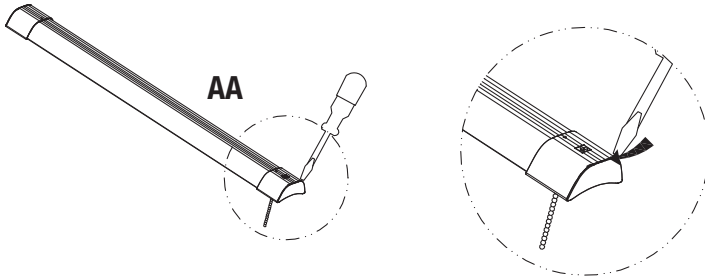

- 2** Pull out wires with quick connects and attach fixtures using the linkable connector (II).

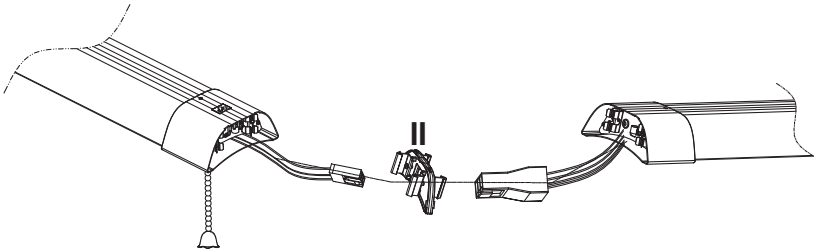

- 3** Follow installation Step 6 to power the fixture.

- Note: Linkable up maximum to 4 fixtures

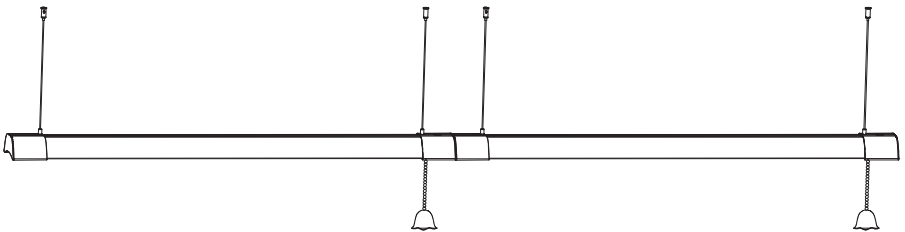



**Questions, problems, missing parts, before returning to the store,
call Commercial Electric Customer Service
8 a.m. – 6 p.m., EST, Monday - Friday**

1-877-527-0313

HOMEDEPOT.COM

Retain this manual for future use.