

Outdoor Storage Center

Need extra storage for your lawn mower or gardening tools and supplies? With Simpson Strong-Tie® connectors, it's easy for you to get all of your outdoor goods organized. This sturdy storage center can be completed, from start to finish, in just one day.

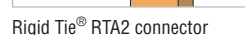

Check out our installation and building tip videos at diydoneright.com.

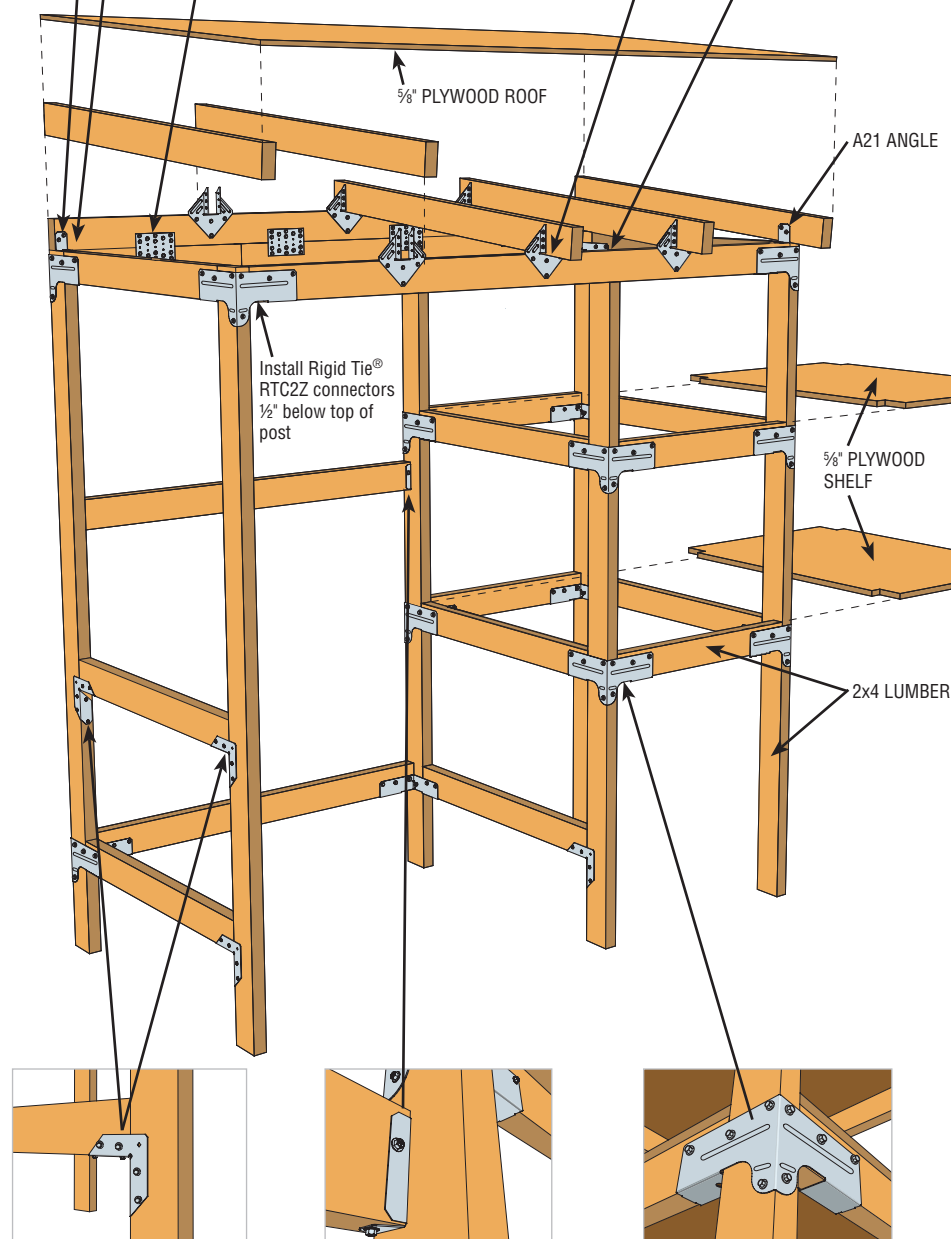
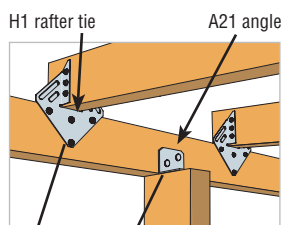
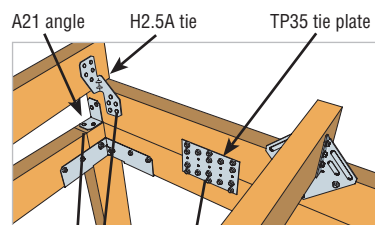

Rigid Tie® RTA2 connector



FB24 bracket

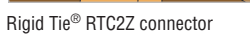

Rigid Tie® RTC2Z connector



TOOLS YOU NEED

- Saw
- Screw gun
- #2 Phillips head bit
- 1/4" hex drive socket
- Tape measure
- Clamps
- Framing square
- Hammer
- Straight edge

Connectors are easy to install and strong enough to support even the heaviest boxes, tools or machinery, and can be finished with paint to blend with the style of your home.

RIGID TIE® RTC2Z CONNECTOR INSTALLATION INSTRUCTIONS

1. CUT LUMBER AND PLYWOOD TO SIZE.

Since all of your cuts are straight cuts, Simpson Strong-Tie® connectors simplify building with wood.

2. INSTALL CONNECTOR ON VERTICAL POST.

Mark height, clamp connector to post and attach with Simpson Strong-Tie® #9x1 1/2" Strong-Drive® SD Connector screws.

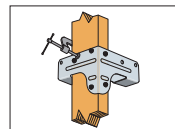

3. CONNECT HORIZONTAL RAIL ON EACH SIDE.

Use a clamp to help hold the wood in the seat of the connector during installation.

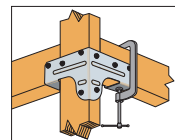

4. NOTCH CORNERS OF PLYWOOD SHELVES.

Use a piece of 2x4 on each corner of the shelf, trace and cut to accommodate corner posts.

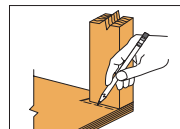



MATERIALS AND CUTTING DIAGRAM

Outdoor Storage Center

SIMPSON
Strong-Tie

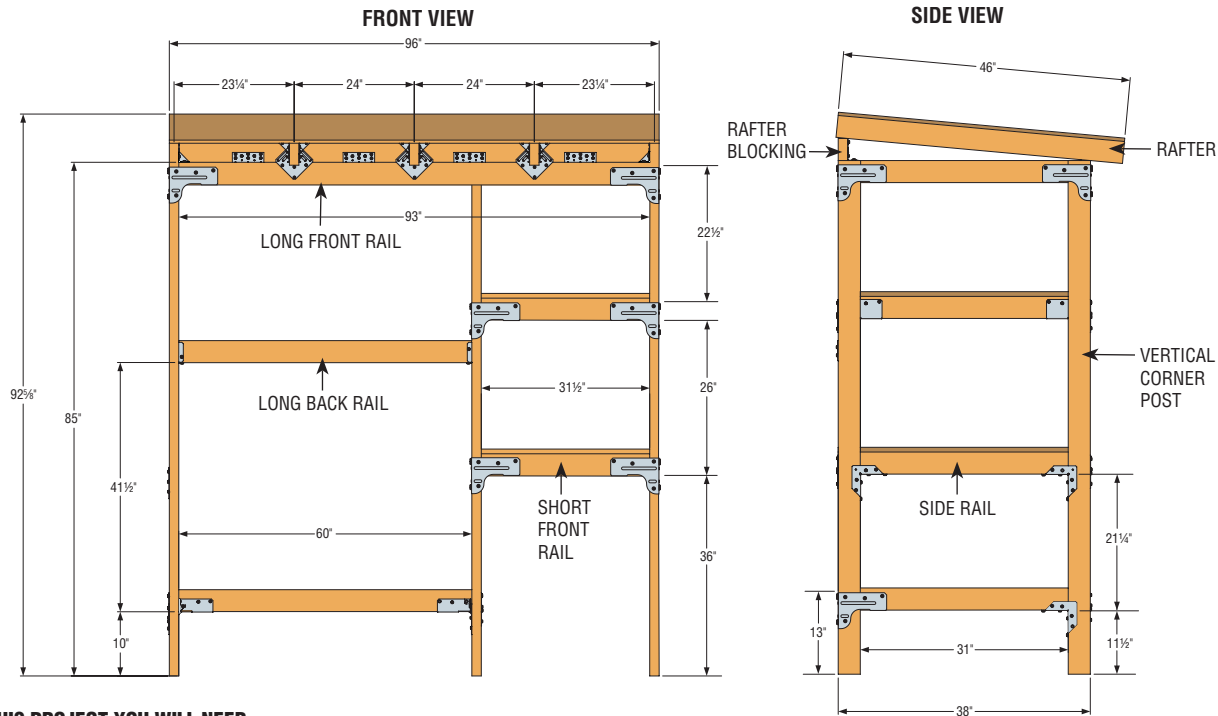

FOR THIS PROJECT YOU WILL NEED:

LUMBER

- (18) – pieces of 2x4 8 ft. lumber
- (1) – 4 ft. x 4 ft. sheet of 5/8" plywood
- (1) – 4 ft. x 8 ft. sheet of 5/8" plywood

SIMPSON STRONG-TIE® CONNECTORS*

- (14) – Rigid Tie® RTC2Z connectors
- (4) – TP35 tie plates
- (6) – A21 angles
- (2) – FB24Z brackets
- (2) – H2.5A ties
- (6) – H1 rafter ties
- (4) – RTA2Z connectors

FASTENERS

- (5) – **BOXES** Simpson Strong-Tie®
- #9x1 1/2" Strong-Drive® SD Connector screws
- (48) – #8x1 1/4" flat-head screws

CUT FROM 2x4 x 8' LUMBER

- (6) – 85" VERTICAL CORNER POSTS → (6x)
- (1) – 96" LONG BACK RAFTER BLOCKING → (1x, no cut)
- (2) – 93" LONG FRONT/BACK TOP RAIL → (2x)
- (2) – 60" LONG BACK RAIL & 31" SIDE RAILS → (2x)
- (4) – 31 1/2" SHORT FRONT/BACK RAILS & (2) – 31" SIDE RAILS → (2x)
- (5) – 31" SIDE RAILS (Results in extra scrap rail) → (2x)
- (5) – 46" RAFTERS (Results in extra scrap rafter) → (3x)

CUT FROM 4' x 8' PLYWOOD

- (1) – 96" x 46" PLYWOOD ROOF
- (2) – 38" x 33" SHELVES

Cut roof and both shelves from (2) 4'x8' sheets of 5/8" plywood. Attach with flat-head #8x1 1/4" screws at 8" spacing.

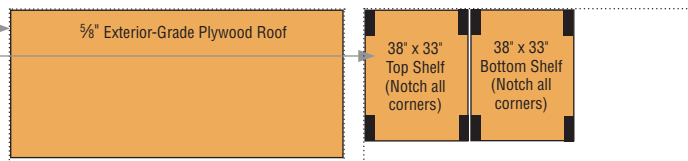

Use 2x4 x 8' preservative-treated lumber, or non-treated lumber with exterior-grade stain or paint. Dimensions can be modified to fit your specific needs. Use roofing material of your choice. Underlayment and asphalt shingles are recommended. Follow manufacturer's instructions for installation.

***CORROSION INFORMATION:** We recommend using our ZMAX® galvanized product for best results on exterior projects and those using preservative-treated wood. These products have a "Z" at the end of the model number (eg. RTC2Z). ZMAX® coated products provide additional corrosion resistance, which is advisable but not required, for non-structural projects like the one shown above. Visit www.strongtie.com/info for critical information.

The construction plan for this project is designed to be completed by people with basic carpentry skills in standard situations. If your situation is unique, talk with someone with detailed carpentry or construction experience before starting your project. Particular attention was paid to the steps and details in this plan, but they cannot be guaranteed to be error free. Simpson Strong-Tie shall not be responsible for any possible loss, damage or injury resulting directly or indirectly from the information contained here.

© 2017 Simpson Strong-Tie Company Inc. • P.O. Box 10789, Pleasanton, CA 94588

DIY-CSOUTSTR17 12/16 exp. 12/20

(800) 999-5099
strongtie.com