



Please visit our website at [www.NightOwlSP.com](http://www.NightOwlSP.com) for all manuals, software, and firmware updates. There are also How-To videos with step-by-step instructions for connecting your device.

### BEFORE YOU GET STARTED YOU WILL NEED



DVR



Camera

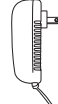

DVR Power Adapter



Camera Power Adapter



Mouse



Ethernet

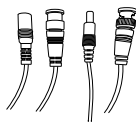

Video/Power



Power Splitter



HDMI



Monitor (not included)



Router (not included)

### CONNECTING THE DVR TO A MONITOR

Using HDMI:

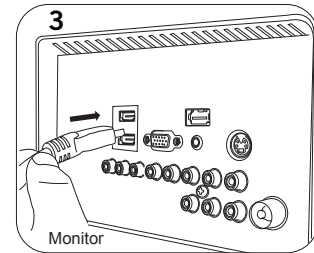
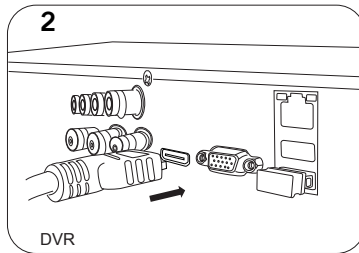
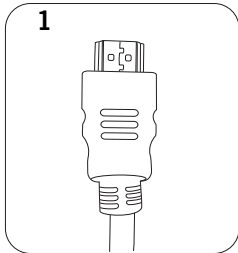

### CONNECTING THE MOUSE TO YOUR DVR

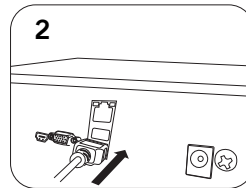
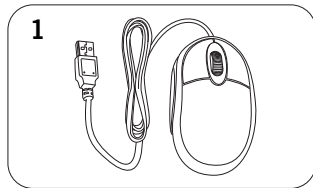

### CONNECTING CAMERAS TO YOUR DVR

**NOTE:** Connect the cameras to the DVR before mounting to ensure that they work properly. Similar resolution cameras (720p, 960H, etc.) **MUST** be installed on adjacent channels (e.g. 1 & 2, 3 & 4). Failure to do so will result in signal loss until corrected.

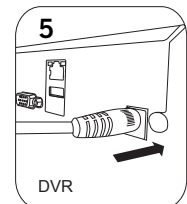
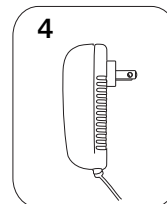
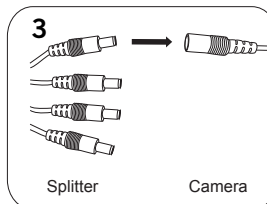
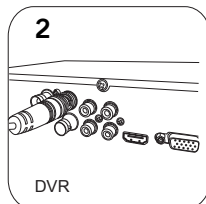
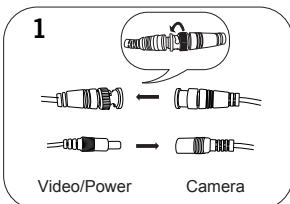



### WIRING DIAGRAM

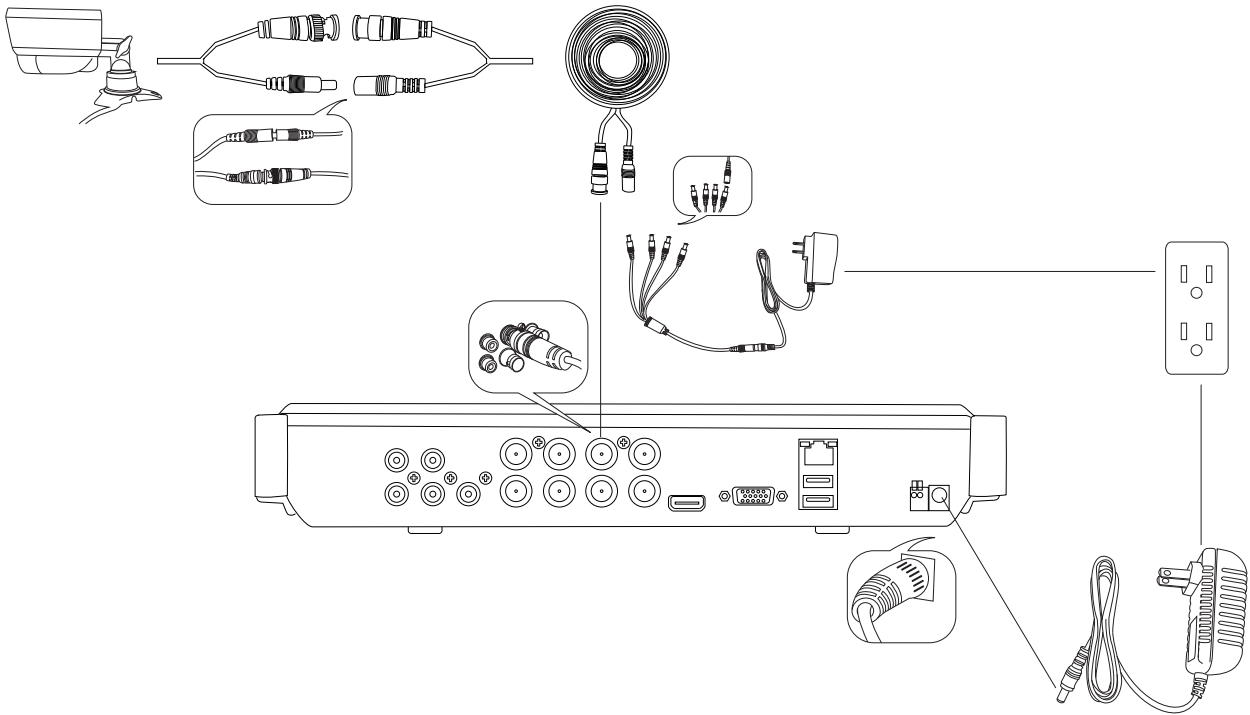

### CONNECTING WITH THE NIGHT OWL APP (SMARTPHONE)

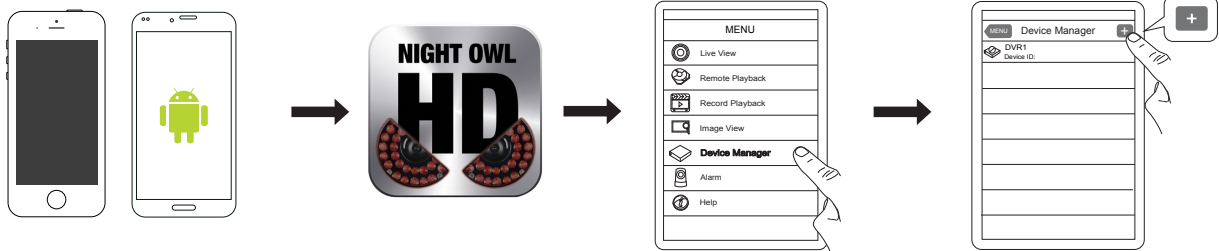

### CONNECTING WITH THE NIGHT OWL APP (TABLET)

