



USE & CARE MANUAL

Please Read These Instructions Carefully Before Using This Appliance
Keep This Manual For Future Reference



DISHWASHER

MODEL : COS-DIS6502



TABLE OF CONTENTS

IMPORTANT SAFE GUARDS	1
SPECIFICATIONS	2
FEATURES OF YOUR NEW DISHWASHER	3
<i>OPERATING THE CONTROL PANEL</i>	5
INSTALLATION REQUIREMENTS	7
<i>ENCLOSURE REQUIREMENTS</i>	8
<i>DRAIN REQUIREMENTS</i>	9
<i>ELECTRICAL REQUIREMENTS</i>	10
INSTALLATION INSTRUCTIONS	12
PARTS LIST	20
EXPLODED VIEW	23

IMPORTANT SAFEGUARDS

SAVE AND READ THESE INSTRUCTIONS

WHEN USING ELECTRICAL APPLIANCES, BASIC SAFETY PRECAUTIONS SHOULD ALWAYS BE FOLLOWED INCLUDING THE FOLLOWING.

Please install your dishwasher properly and follow the installation guide.

- Water supply temperature should be 120°F or 149°F.
- Dispose of the discarded appliance and packing material properly.
- The dishwasher must be grounded, or it can result in a risk of electric shock.
- If there is any damage to the dishwasher, please contact to your retailer. Do not attempt to repair or replace any part by yourself.

1. Read all instructions before using the dishwasher.
2. The manual does not cover every possible condition and situation that may occur.
3. Use the dishwasher only for intended function as described in this manual.
4. When loading items to be washed:
 - Load sharp items and knives so that they are not likely to damage the door seal and tub.
 - Load sharp items and knives with the handles up to reduce the risk of cut-type injury.
5. Do not wash plastic items unless marked dishwasher-safe or the equivalent, if not marked, check with manufacturer for recommendation, items that are not dishwasher-safe may melt and create a potential fire hazard.
6. If the dishwasher drains into a food disposer, make sure disposer is completely empty before running dishwasher.
7. Do not tamper with control.
8. Do not operate your dishwasher unless all enclosure panels are in the properly place.
9. Do not touch the heating element during or immediately after use, especially if the sanitize option has been selected.
10. Do not let children abuse, sit or stand on door or racks of a dishwasher.
11. Under certain conditions, hydrogen gas may be produced in a hot water system that has not been used for two weeks or more. Hydrogen gas is explosive. If the hot water system has not been used for such a period, before using on all hot water faucets and let water flow from each for several minutes. This will release any accumulated hydrogen gas. Hydrogen gas is flammable. Do not smoke or use an open flame during this time.
12. Do not store or use combustible materials, gasoline or other flammable vapors and liquids in the vicinity of this or any other appliance.
13. Use only detergents or rinse agents recommended for use in a dishwasher and keep them out of the reach of children.
14. Keep young children and infants away from dishwasher when it is operating.
15. Do not use the dishwasher if it has a damaged power line or plug, and do not plug the dishwasher into a damaged outlet. Failure to observe these instructions may result in electrical shock.
16. Remove the door to the washing compartment when removing an old dishwasher from service or discarding it.

SAVE THESE INSTRUCTIONS FOR HOUSEHOLD USE ONLY

SPECIFICATIONS

Capacity: 14 place settings

Dimensions (W x D x H): 23.9 x 25.6 x 33.7 in.

Weight: 94 lbs

Power Supply: 120 volts, 60 Hz

Rated Power Usage: Wash Motor: 50W, Heater: 840W

Water Feed Pressure: 20 ~ 120 psi



- 1. Top Light
- 2. Upper Spray Arm
- 3. Middle Spray Arm
- 4. Vortex Wash Arm
- 5. Low Spray Arm
- 6. Rinse Aid Dispenser
- 7. Detergent Dispenser

- 8. Cup Shelf
- 9. Adjustable Upper Rack
- 10. Tub Gasket
- 11. Silverware Basket
- 12. Bottom Rack
- 13. Heating Element

FEATURES OF YOUR NEW DISHWASHER

Filter System

Your dishwasher has a multiple Filter System. In the Filter System, there are four filter-meshes. It can separate soiled water and clean water in different chambers. The multiple filter system helps your dishwasher to get better performance with less water and less energy.



Adjustable Upper Rack

The Upper Rack can be raised or lowered to accommodate loading taller dishes in either rack. The Upper Rack clearance height **H1** goes from 8" to 10". The Bottom Rack clearance height **H2** is 11" to 13".

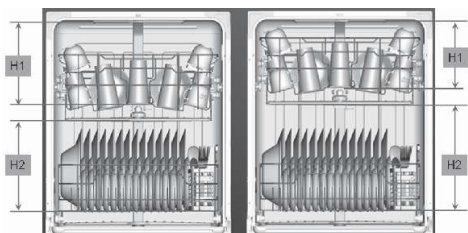

Smart Wash System

Your dishwasher has a Smart Wash System. When a partial load of lightly soiled dishes is placed in the unit, a wash cycle similar to a short wash will automatically be performed. When a full load of heavily soiled dishes is placed in the unit, a heavy wash cycle will automatically be performed. It can determine the type of cycle required to clean the dishes and will clean more efficiently every time.

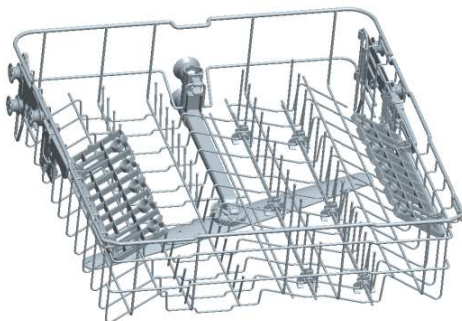
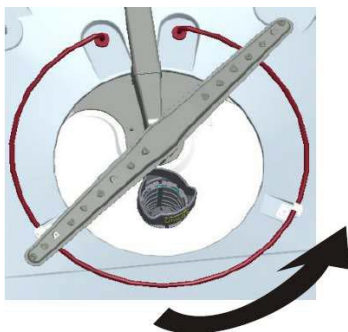

How Your Dishwasher Cleans

Your dishwasher cleans by spraying a mixture of hot water and detergent through the spray arms against soiled surfaces.

The dishwasher fills with water covering the filter area. Water is then pumped through the multiple filter and spray arms. Soiled water goes down the drain as the water is pumped out and replaced with clean water.

The number of water fills will vary with the cycle being used.

Getting Started

1. Load dishwasher.
2. Add detergent.
3. Add rinse aid, if needed.
4. Close door latch.
5. Select desired CYCLE. The indicator light above the touchpad will glow when selected.
6. Select desired OPTIONS. The indicator light above the touchpad will glow when selected.
7. Run the hot water faucet nearest the dishwasher until the water is hot. Turn the water off afterwards.
8. To start, press START/CANCEL on the touchpad.

NOTE: Selections will only be activated when the door is firmly closed.

NOTE: The dishwasher is programmed to remember your last cycle so you do not have to reset each time. To start the dishwasher using the same cycle and options selected on the previous wash, just press START/CANCEL on the touchpad.

Wash Cycle Selections

Cycle times are approximate and will vary with options. Hot water is necessary to activate dishwasher detergent and clean fatty food particles. An automatic sensor will check the incoming water temperature and if it is not hot, the timer will be delayed for automatic water heating in the main wash of all cycles. This happens even when HI-TEMP WASH is selected and a higher temperature is guaranteed to handle heavier food particles.

Operating the Control Panel



Wash Cycle Selections

1. POTS & PANS

This cycle is for hard-to-clean, heavily soiled pots, pans, and dishes.

2. NORMAL WASH

This cycle is for regularly soiled dinner dishes or silverware.

3. CHINA CRYSTAL

This cycle is for lightly soiled china and crystal.

4. QUICK WASH

This cycle is for lightly soiled and pre-rinsed dishes and silverware.

5. RINSE ONLY

This cycle is for pre-rinsing dishes or glasses. This is only a rinse that keeps food from drying on your dishes and reduces odor buildup in your dishwasher until you are ready to wash a full load. Do not use detergent.

6. ENERGY SAVER

For lightly soiled or pre-rinsed dishes and silverware.

Functions

7. AIR EXCHANGE

When the AIR EXCHANGE FUNCTION is selected, the dishwasher will exchange the air every 6 hours to keep the air in the dishwasher fresh.

8. STEAM WASH

For use with heavily soiled items, this STEAM option adds 30 minutes to the cycle time. The option is available with the "POTS & PANS" and "NORMAL WASH" cycles

9. CHILD LOCK

You can lock all controls to prevent children from accidentally changing the dishwasher cycle or starting the dishwasher. Press the "STEAM WASH" and the "VORTEX WASH" simultaneously to select or cancel the function. After the function is selected, the corresponding indicator light will turn on.

10. VORTEX WASH

Use this option when you want to wash pots and pans, durable serving bowls, and other large, very dirty, hard to clean dishes. To use the Vortex wash, place the dishes face down in the lower rack directly above the vortex wash arm in the back left corner.

11. HEATING DRY

When the HEATING DRY function is selected, the heater will be enabled during the drying process.

12. SANITIZED

When the SANITIZE function is selected, the temperature of water will be maintained at 158°F.

13. HI TEMP WASH

When selected, the water temperature will be maintained at 140°F.

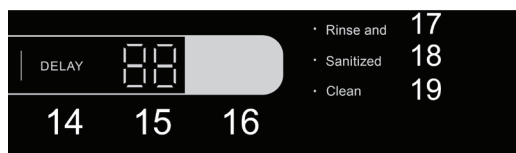

14. DELAY

Allows setting a delay for the dishwasher to start from 1 to 24 hours.

15. DISPLAY

Displays the remaining hours and minutes of the current running cycle, delay in hours, and error codes.

16. START/CANCEL

Begins and ends the current cycle. Pressing CANCEL during a cycle will start a 60 second drain and then shut off.

17. Rinse aid indicator light

Lights up when the rinse aid is used during a cycle.

18. Sanitized indicator light

Lights up when the SANITIZE function is enabled. Opening the door will turn off the function after 30 seconds.

19. Clean indicator light

Turns on when a cycle is finished. Opening the door will turn off the function after 30 seconds.

Cycle Progress Indicator

Located on right side of the front of the dishwasher, these lights indicate the progress of the current wash cycle while the dishwasher is running.

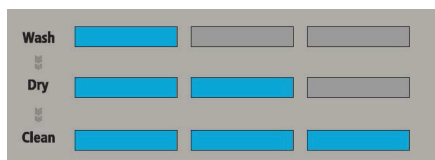

Wash: When the dishwasher is in a wash or rinse portion of a cycle, the Wash lights are illuminated.

Dry: When the dishwasher is in a drying portion of a cycle, the Wash and Dry lights are illuminated.

Clean: After the dishwasher has completed all portions of a cycle, all indicator lights are illuminated. If you open the door when the Cleaning lights are illuminated, all the lights will turn off after 30 seconds.

INSTALLATION REQUIREMENTS

Parts supplied:

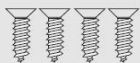

Wood screws (4)

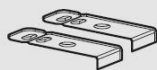

Top mounting clips (2)



Hose clamp



Drain hose

Tools needed:



Phillips screwdriver



1/4 in. and 5/16 in.
Nut driver



Level



Flashlight



Gloves



Bucket



Adjustable wrench

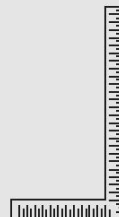

Carpenter's
square

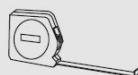

Measuring tape



Safety glasses

New installations only



Tubing cutter



Hole saw set

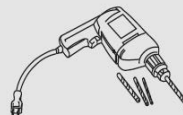

Drill and bits

Materials needed:



90° Elbow, ferrule and compression
nut. (3/8 NPT external thread on one
end. Other end sized to fit water
supply line)



Teflon thread
seal tape



Wire nuts (UL listed)

New installations only



Screw-type hose clamps



Electrical cable or power
cord (See *Electrical
Requirements* section)



Hot water line (min.
3/8 in. copper) kit



Waste tee for
house plumbing
(if applicable)



Hand shut-off
valve



Strain relief (for
electrical connections)



Coupler for extending
drain line (if applicable)



Air gap (if
required)

- The cabinet opening must be at least 24 in. wide.
- The maximum height of the opening is 35 in.
- The dishwasher must be installed so that the drain hose is no more than 10 feet in length, for proper drainage.
- The dishwasher must be fully enclosed on the top, sides, and back, and must not support any part of the enclosure.

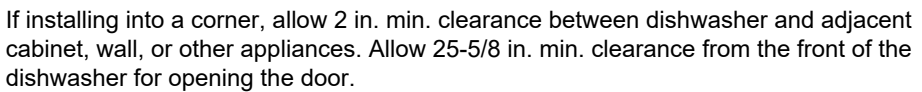

Drain Requirements

- Follow all local codes and ordinances.
- Do not exceed 10 ft. of drain hose.
- Do not connect the drain lines from other devices to the dishwasher drain hose.
- The dishwasher must be connected to a waste line with an air gap (not provided) or a 32 in. high (min.) drain loop, depending on local codes and ordinances, to prevent back flow into the dishwasher.
- An air gap must be used if the waste tee or garbage disposal connection is less than 18 in. above the floor, to prevent siphoning.

Drain Preparation

The type of drain installation required depends on the answers to the following questions:

- Do local codes or ordinances require an air gap?
- Will the waste tee or garbage disposal connection be less than 18 in. (45.72 cm) above the floor?
- Will installation have a drain loop less than 32 in. (81.28 cm) above the floor?

If the answer to **ANY** of these questions is **YES**, **Method 1 MUST be used**. Otherwise either Method 1 or Method 2 may be used.

Install the waste tee or garbage disposal connection and air gap according to manufacturer's instructions.

Method 1 - Air gap with a waste tee or garbage disposal connection

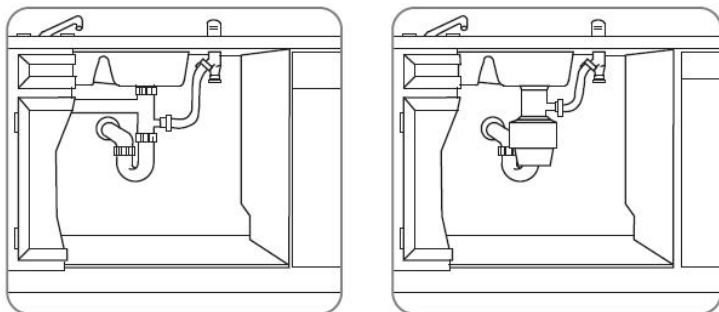

Method 2 - High drain with a waste tee or garbage disposal connection

You must provide a method to attach the drain hose to the underside of the countertop.

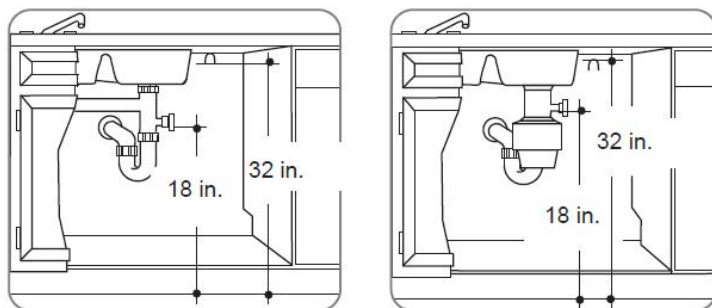

Electrical Requirements

- This appliance must be supplied with 120V, 60 Hz., and connected to its own, properly grounded branch circuit, protected by a 15 or 20 ampere circuit breaker or time delay fuse.
- Wiring must be two wire with ground.
- If the electrical supply does not meet the above requirements, call a licensed electrician before proceeding.

Warning

FOR PERSONAL SAFETY:
Remove the house fuse or open the circuit breaker before beginning the installation. Do not use an extension cord or adapter plug with this appliance.



GROUNDING INSTRUCTIONS

Grounding Instructions – Cable Direct

This appliance must be connected to a grounded metal, permanent wiring system, or an equipment grounding conductor must be run with the circuit conductors and be connected to the equipment ground-ing terminal or lead on the appliance.

Grounding Instructions – Power Cord Models

This appliance must be grounded. In the event of a malfunction or breakdown, grounding will reduce the risk of electrical shock by providing a path of least resistance for electric current. The plug must be plugged into an appropriate outlet that is installed and grounded in accordance with local codes and ordinances.



WARNING

The improper connection of the equipment grounding conductor can result in a risk of electric shock. Check with a qualified electrician or service representative if you are in doubt that the appliance is properly grounded.

Direct Wire Method

- The cable must be routed as shown in "Cabinet Preparation and Wire Routing", and extend a minimum of 24 in. from the rear wall.
- Use flexible, armored or nonmetallic sheathed, copper wire with grounding wire that meets the wiring requirements for your home and local codes and ordinances.
- Use a UL Listed/CSA Approved strain relief.

Power Cord Method

- Install a 3-prong grounding type receptacle. The wall outlet can be installed in a cabinet or on a wall adjacent to the undercounter space in which the dishwasher is to be installed.
- The recommended power cord length is 54 in. min. and 64 in. max.

Cabinet Preparation and Wire Routing

- The wiring may enter the opening from either side, the rear, or the floor within the shaded area.
- The electrical connection is on the right front of the dishwasher.
- Drill a 1-1/2 in. maximum diameter hole to run the electrical cable through the wall of the cabinet.
- The hole must be free of sharp edges. If the cabinet wall is metal, the hole edge must be covered with a bushing or rubber grommet.

Cable direct connections may pass through the same hole as the drain hose and hot water line, but power cords with plugs must pass through a separate hole.

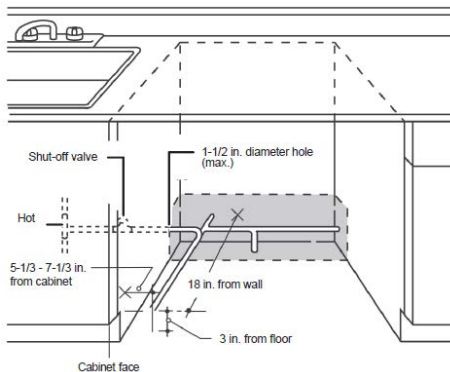
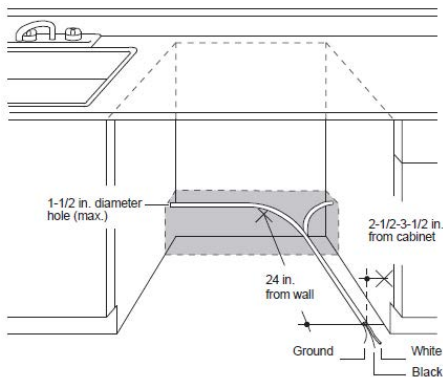

Preparing the Hot Water Line

- The water connection is on the left side of dishwasher.
- The hot water line may enter the opening from either side, the rear, or the floor within the shaded area.
- The hot water line may pass through the same hole as the electrical and drain hose. Or, you can drill an additional 1-1/2 in. maximum diameter hole for the hot water line.
- **If a power cord with a plug is used, the hot water line may not pass through the same hole as the power cord.**

Connecting the Water Line to the Water Supply

1. Turn off the water supply
2. Install a hand shut-off valve in an accessible location, such as under the sink. This is optional, but strongly recommended, and may be required by local codes.
3. Install the hot water inlet line, using at least 3/8 in. O.D. copper tubing. Route the line as shown in the figure above and extend it forward at least 18 in. from the rear wall of the enclosure.
4. Adjust the water heater to a temperature of from 120° F to 150° F.
5. Flush the water line to clean out any debris.

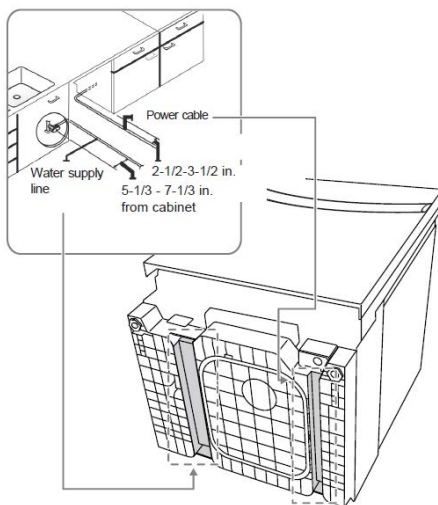

NOTE: The hot water pressure must be between 20 and 120 psi.

INSTALLATION INSTRUCTIONS

Step 1: Check the door balance

1. Hold the top of the dishwasher firmly.
2. Open the door slowly, then release it. If the door drops, increase the spring tension. If the door closes, decrease the spring tension.
3. Continue moving the spring pin until the door is balanced. Adjust both springs to the same tension.

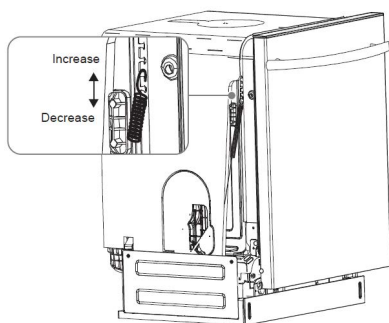

Step 2: Adjust the leveling legs

1. Move the dishwasher close to the installation location and lay it on its back.
2. Measure the installation height and the dishwasher height.
3. Extend the leveling legs out from the dishwasher base 1/4 in. (6.35 mm) less than the installation height.

Adjust to 1/4 in. less than the installation height.

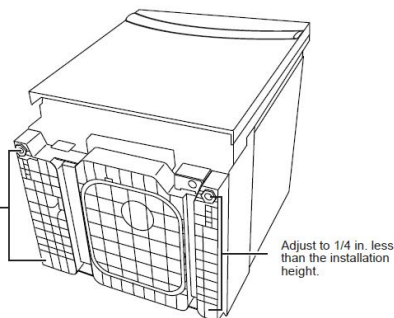

Step 3: Remove the toekick

Remove the two toekick screws with a Phillips screwdriver, then remove the toekick.

Use adjustable wrench and Philips screwdriver.

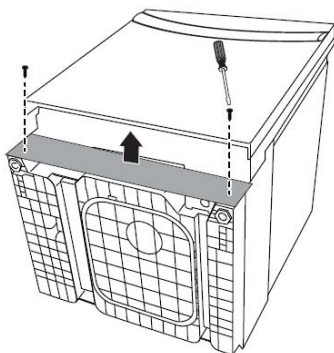

Step 4: Install the power cord

Skip this step if the dishwasher will be direct wired.

1. Remove the junction box cover on the right front of the dishwasher.
2. Connect the incoming white (or ribbed) wire to the dishwasher's white wire, the black (or smooth) wire to the dishwasher's black wire, and the ground wire to the dishwasher's green wire. Use cUL/UL listed wire nuts of the appropriate size.
3. Replace the junction box cover on the right front of the dishwasher. Be sure that the wires are not pinched

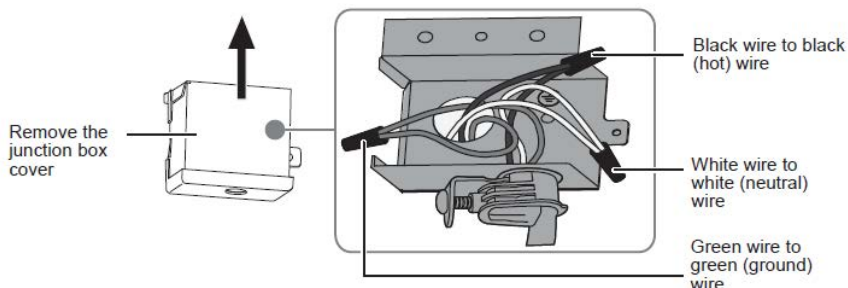

Step 5: Install the 90° water supply elbow

1. Wrap the male thread of the 90° elbow with Teflon thread seal tape. Do not use plumber's putty.
2. Install the 90° elbow onto the water valve. Do not overtighten the 90° elbow. The water valve bracket could bend or the water valve fitting could break.
3. Position the end of the elbow to face the bottom right side of the dishwasher.

Use Philips screwdriver, power cord, wire nuts, adjustable wrench, 90° elbow, and Teflon thread tape.

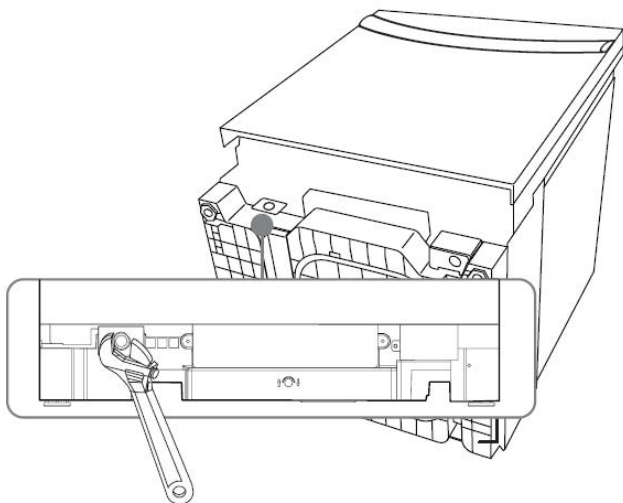

Step 6: Install the drain hose

1. Turn the dishwasher upright.
2. Slide a screw-type hose clamp onto the drain hose.
3. Install the drain hose to the dishwasher drain outlet on the back of the dishwasher, then tighten the screw-type hose clamp.

Use Philips screwdriver, screw-type hose clamps, and drain hose.

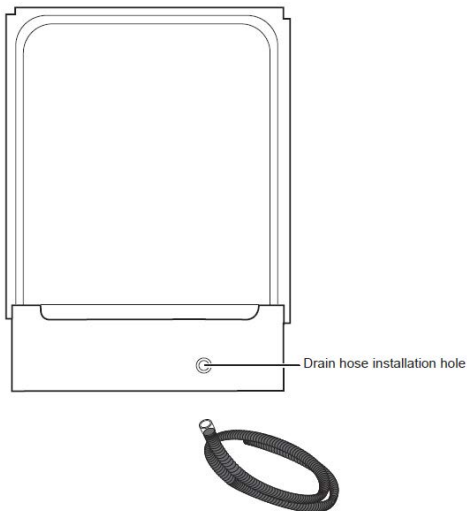

Step 7: Inserting the drain hose through the cabinet

Insert the drain hose into the hole in the cabinet wall. If a power cord is used, guide the end through a separate hole.

Tip: Position the water line and house wiring on the floor to avoid interfering with the base of the dishwasher.

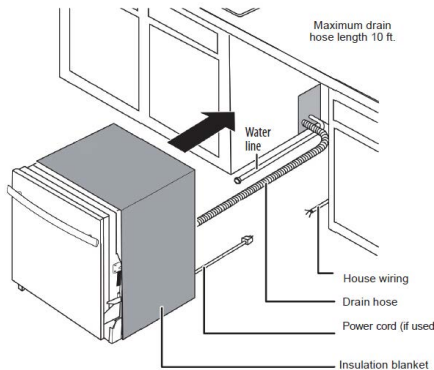

Step 8: Slide the dishwasher partially into the cabinet

Caution: Do not push against the front panel with your knees. Damage will occur.

1. Position the dishwasher in front of the opening, then slide the dishwasher into the opening a few inches at a time.
2. Pull the drain hose through the opening under the sink as you proceed. Stop when the dishwasher is a few inches in front of the adjacent cabinetry.
3. Make sure that the drain hose is not kinked under the dishwasher and that there is no interference with the water line, wiring, or any other component.



Step 9: Position the dishwasher under the countertop

1. Make sure that the wires are secure under the dishwasher and not pinched or in contact with door springs or other dishwasher components.

TIP: Check tub insulation blanket, if equipped. It should be positioned so it is not bunched up or interfering with door springs. Check by opening and closing the door.

2. Push the dishwasher into the cabinet. The front corners of the dishwasher door should be flush with the cabinet doors. **Be careful not to dent the front panel with your knees or damage the countertop or cabinets with dishwasher parts.**

Step 10: Level the dishwasher

IMPORTANT: The dishwasher must be level for proper dish rack operation and wash performance.

Use adjustable wrench and level.

1. Open the door, then place a level on the door and on the rack track inside the tub to make sure that the dishwasher is level.

2. Level the dishwasher by adjusting the four leveling legs individually.

TIP: Pull the lower rack out about halfway. Make sure that the rack does not roll forward or back into the dishwasher. If the rack rolls in either direction, you must level the dishwasher again.

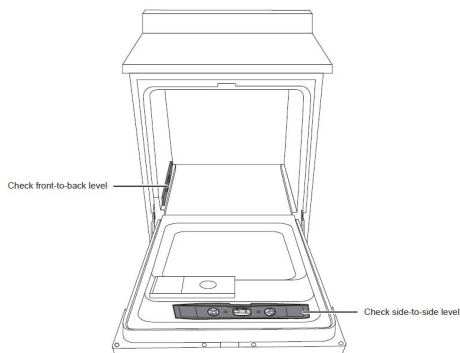

3. If the door hits the tub, the dishwasher is not installed correctly. Adjust the leveling legs to align the door to the tub.

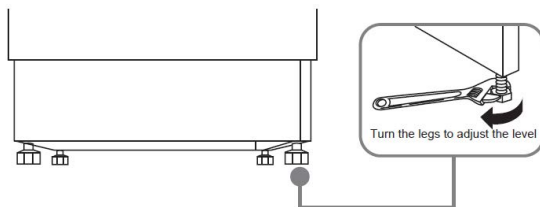

Step 11: Securing the dishwasher to the countertop

- For countertops made of wood or materials that won't be damaged by drilling, use Method 1.
- For countertops made of granite, marble, or other materials that could be damaged by drilling, use Method 2.
- If the gap between the control panel and the cabinet is less than 0.4 in. (10 mm), use Method 2.

Method 1

1. Insert the long top mounting clips into the slot.
2. Bend the brackets to secure them to the dishwasher tub.
3. Secure the dishwasher to the countertop through the holes in the brackets, using the screws provided.

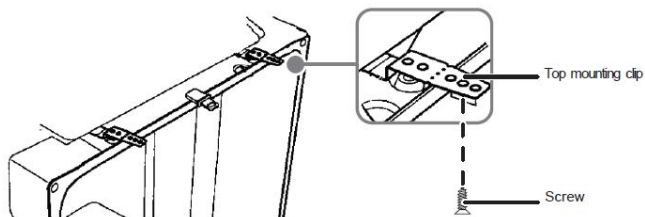

Method 2

1. Remove the plastic tub caps from the inside of the dishwasher tub.
2. Drive a wood screw through the hole in the side of the dishwasher into the cabinet frame.

IMPORTANT: Drive the screws straight and flush. Protruding screw heads will scratch the top of the control panel and interfere with the door closing.

3. Reinsert the plastic tub caps.

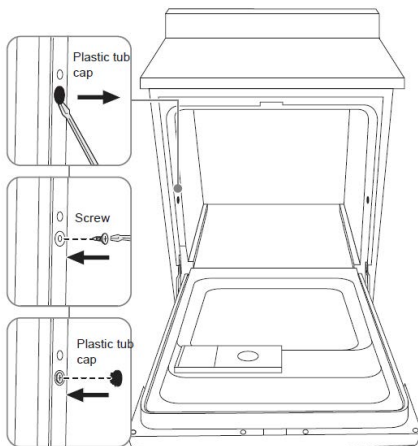

Use Philips screwdriver, wood screws (2 per side), top mounting clips (2).

Step 12: Connecting the water supply line

1. Slide the compression nut, then the ferrule over the end of the water supply line.
2. Insert the water supply line into the 90° elbow.
3. Slide the ferrule against the 90° elbow and secure it with the compression nut.

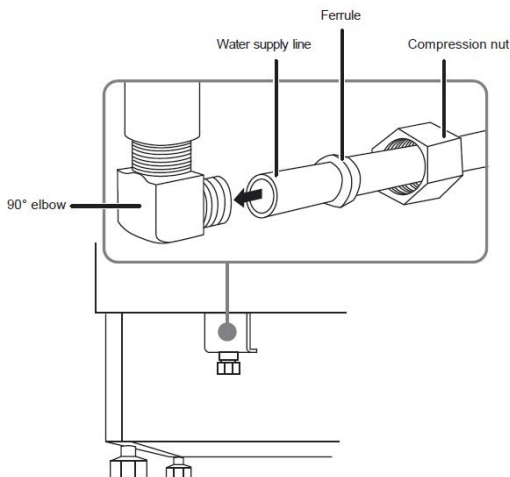

IMPORTANT: Make sure that the door spring does not rub or contact the water supply line or drain hose. Test by opening and closing the door. Reroute the lines if interference occurs.

Use adjustable wrench, waterline kit, and Teflon thread seal tape.

Step 13: Connecting the drain hose

IMPORTANT: Follow all local codes and ordinances.

1. Cut on the marked line as required for your installation. The drain hose's molded end will fit 5/8", 3/4" or 1" diameter connections on the air gap, waste tee, or garbage disposal.

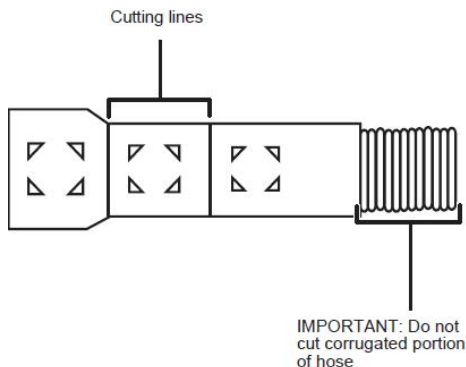

Step 14: Connecting the electrical power

Turn off the electricity to the dishwasher's electrical circuit. **Skip this step if your dishwasher is equipped with a power cord.** Make sure that the electrical power is turned off at the source.

Warning

- If your house wiring is not 2-wire with a ground, a ground must be provided by the installer.
- If your house wiring is aluminum be sure to use cUL/UL Listed anti-oxidant compound and aluminum-to-copper connectors.



1. Remove the junction box cover from the power supply junction box on the wall.
2. Locate the three dishwasher wires, (white, black, and green) with stripped ends, then insert the dishwasher wires through the small hole in the junction box.
3. Secure the house wiring to the bottom of the junction box with a strain relief fitting.
4. Use wire nuts to connect incoming ground to green, white to white, and black to black.
5. Replace the junction box cover. Make sure that no wires are pinched under the cover.

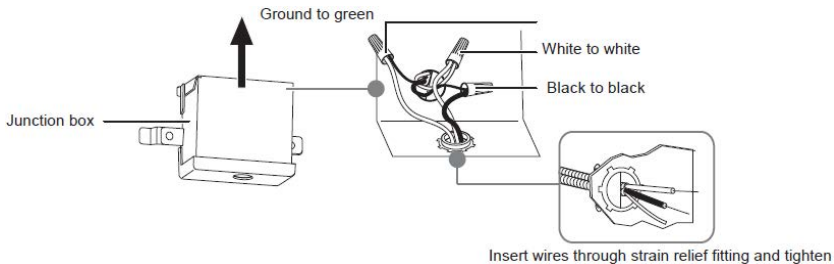

Use Philips screwdriver, strain relief (for electrical connections), and wire nuts (UL listed).

Step 15: Performing a pre-test check

- Make sure that power is turned OFF.
- Open the door and remove all foam and paper packaging.
- Check the door opening and closing. If the door does not open and close freely, or tends to fall, check the spring adjustments. See "Step 1: Check the door balance".
- Make sure that the wiring is secure under the dishwasher and not pinched or in contact with door springs or other components. See "Step 9: Position the dishwasher under the countertop".
- Check the door alignment with the tub. If the door hits the tub, level the dishwasher. See "Step 10: Level the dishwasher".
- Pull the lower rack out about half way. Make sure that it does not roll back or forward on the door. If the rack moves, adjust the leveling legs. See "Step 10: Level the dishwasher".
- Check the door alignment with the cabinet. If the door hits the cabinet, reposition or relevel the dishwasher. See "Step 10: Level the dishwasher".
- Make sure that water supply and drain lines are not kinked or in contact with other components. Any contact with the motor or dishwasher frame could cause a noise. See "Step 8: Slide the dishwasher partially into the cabinet".
- Turn on the sink hot water faucet and verify the water temperature. Incoming water temperature must be between 120°F and 150°F. A minimum of 120°F temperature is required for best wash performance. See "Preparing the hot water line".
- Add a half gallon (2 l) of water to the bottom of the dishwasher to lubricate the pump seal.
- Turn on the water supply. Check for leaks. Tighten connections if needed.
- Remove any protective film (if present) from the control panel and door.

Step 16: Wet testing the dishwasher

1. Turn on the power supply (or plug the power cord into the outlet, if equipped).
2. Turn on your dishwasher.
3. Close the door, select the RINSE ONLY cycle, and press START/CANCEL.
4. Make sure that water enters the dishwasher. If water does not enter the dishwasher, check to be sure that water and power are turned on.
5. Check for leaks under the dishwasher. If a leak is found, turn the power supply off, then tighten connections. Restore power after the leak is corrected.
6. Check for leaks around the door. A leak around the door could be caused by door rubbing or hitting against adjacent cabinetry. Reposition the dishwasher if necessary. See "Step 9: Position the dishwasher under the countertop".
7. When the dishwasher is draining, check the drain lines. If leaks are found, turn power off at the breaker and correct plumbing as necessary.
8. Restore the power after corrections are made. See "Step 12: Connecting the water supply line".
9. Open the dishwasher door and make sure that most of the water has drained. If not, check that the disposer plug has been removed and/or the air gap is not plugged. See "Step 13: Connecting the drain hose". Also check the drain line for kinking.
10. Run the dishwasher through another fill and drain cycle. Check for leaks and correct if required.

PARTS LIST

No.	Part No.	Description	Qty.
101		control panel cover	1
102	17176000021387	PCB assembly	1
103	12176000004941	control panel	1
104	12176000002915	light diffuser	1
105	16076000002710	decorative PVC	1
106	12176000003000	cycle step display	1
107	12276000001817	handle pad	2
108	12976000001097	decorative handle	1
109	12276000006351	outer door	1
203	17476000000048	door switch	1
204	12276000005303	inner door	1
205	12976000000202	door spring	2
206	12976000000391	door cable	2
207+208	12276000001753	door gemel assembly (left)	1
210	12676000000764	seal under the door	1
211	12276000001830	hinge join board	1
212	17476000001467	dispenser	1
213+208	12276000001787	door gemel assembly (right)	1
300-1	12176000009535	inner light nut	2
300-2	12676000000745	inner light gasket	2
300-3	17476000001081	inner light	2
301	12676000000503	sound absorbing cotton	1
302	12676000000365	cabinet seal kit	1
304	12176000010393	slide bracket support	4
305	12176000003492	guide plate assembly	4
308	12176000010456	rail support assembly	2
309	12176000008444	basket guider support holder	4
310	12176000003561	sleeve cover	2
311	12176000008428	rail block (back)	2
312	12276000001333	sword fork frame upper basket guider (left)	1
313	12276000001343	sword fork frame upper basket guider (right)	1
314	12676000002681	tank gasket	1
315	12276000002203	door lock hook	1
319	17476000001525	heater	1
320	12176000008429	cutlery shelf guider link stopper (back)	2
321	12276000001365	rail assembly	1
322	12276000001355	rail assembly	1
400+413	12176000003928	air intake device	1
401	12176000003911	air breather assembly	1
402	12676000000713	air breaker washer	3
403	12176000009578	air breaker nut	3
404	12676000000621	inlet valve pipe	1
405	12676000000954	inner drain pipe	1

406	12676000000180	inner drain pipe	1
407	12676000000179	inlet pipe	1
408	12176000009745	foot	4
409	12176000008450	tub support	2
410	12176000008440	tub link	2
411	17476000001149	pressure switch	1
412	12276000001019	base side panel	2
414	12176000008578	base side panel support	2
415	17476000001140	inlet valve	1
416	12176000013106	pcb seat	1
417	17176000009730	main pcb	1
418	12176000013107	PCB seat	1
419	12176000003496	float holder	1
420	12176000003086	base cover	1
421	12876000000050	sleeve cover	1
422	12276000005420	baseboard	1
423	12176000003865	lower front crosspiece	1
424	12276000001798	junction box A	1
425	12176000003059	base tray	1
426	12676000001011	waterproof case	1
427	12176000003834	fan box	1
428	11002015001676	fan motor	1
429	12176000002613	fan cover	1
430	12176000008632	cooler pipe	1
431	12276000001800	junction box B	1
432	12676000000628	PVC pipe	1
433	17476000001137	overflow switch	1
501+502+503+504+505+518	12176000013098	inner pipe	1
506	12176000013129	feeding dispenser cap	1
507	12176000013130	water dispenser	1
509+510	12276000006062	lower sprayer	1
511	12176000009150	lower spray nut	1
512	12176000008657	sprayer seat	1
513+514+515+516	12176000013099	upper sprayer	1
517	12176000009246	upper sprayer pipe	1
519	12176000009152	vortex sprayer arm	1
601	12176000003649	cylinder filter	1
602	12176000009643	filter handle	1
603	12276000001513	plane filter assembly	1
604	12676000000823	sump gasket	1
605	12176000003567	distributary valve cover	1
605a	12176000009480	connect pipe	1
607+608+610+612	12176000015664	sump assembly	1
609	11001011000221	permanent magnet synchronous pump	1

611	17176000000297	thermal resistor	1
613	17176000000312	turbidity sensor	1
614	12676000000113	inlet pipe	1
615	121760000002600	up pump body	1
616	126760000000181	outlet pipe	1
617	122760000001316	blade	1
618	121760000008809	impeller	1
619	126760000000787	pump o-ring gasket	1
620	121760000002594	under pump body	1
621	110010100000090	induction pump	1
622	121760000010421	bracket	1
623	121760000003489	half load plate	1
624	126760000001042	half load cover	1
625	110020140000026	synchronous motor	1
626	174760000001123	micro switch	1
627	126760000000784	seal	1
628	121760000008770	cam	1
629	126760000000838	seal	1
630	121760000009511	nut	1
631	121760000008696	vortex sprayer arm connector	1
632	126760000000678	vortex sprayer arm pipe	1
701	121760000015683	cutlery assembly	1
702	121760000013100	cutlery basket	1
703	129760000000859	upper basket	1
801+802+803+804+806	129760000002042	lower basket assembly	1
805	129760000000265	accessory bag	1
807	174760000000646	wiring harness	1
808	126760000000126	drain-pipe	1

EXPLODED VIEW

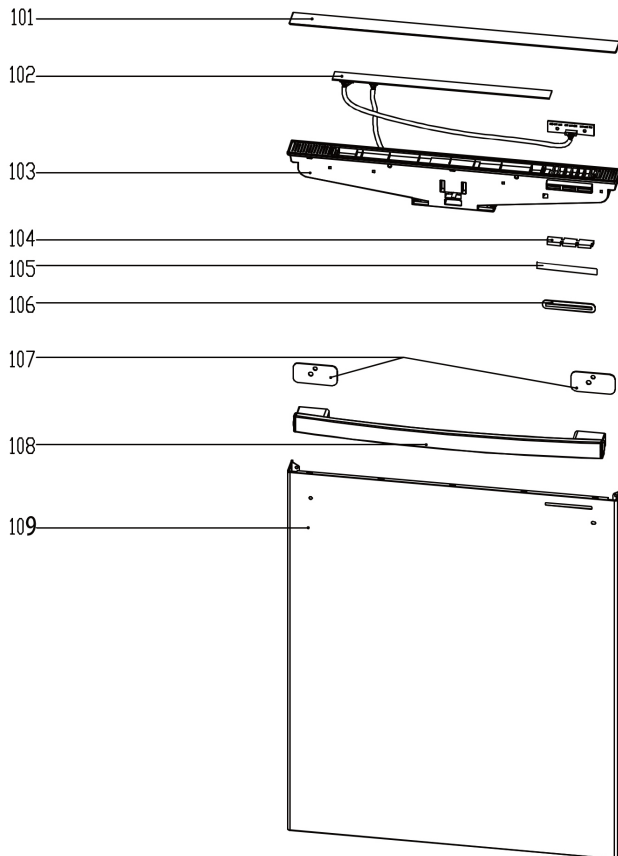

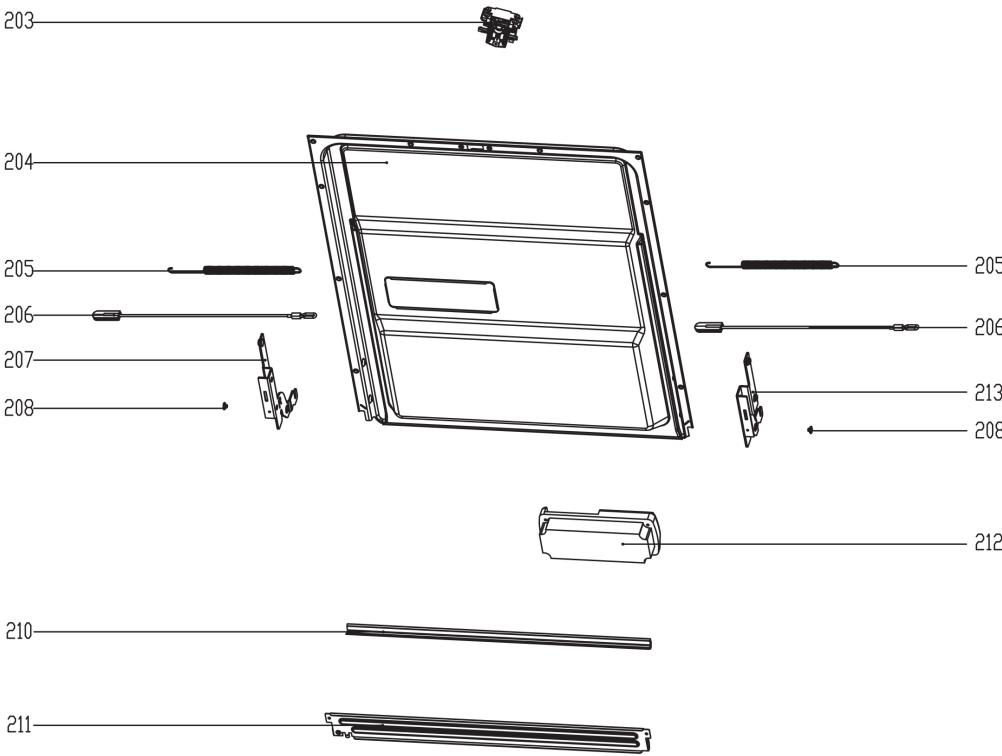

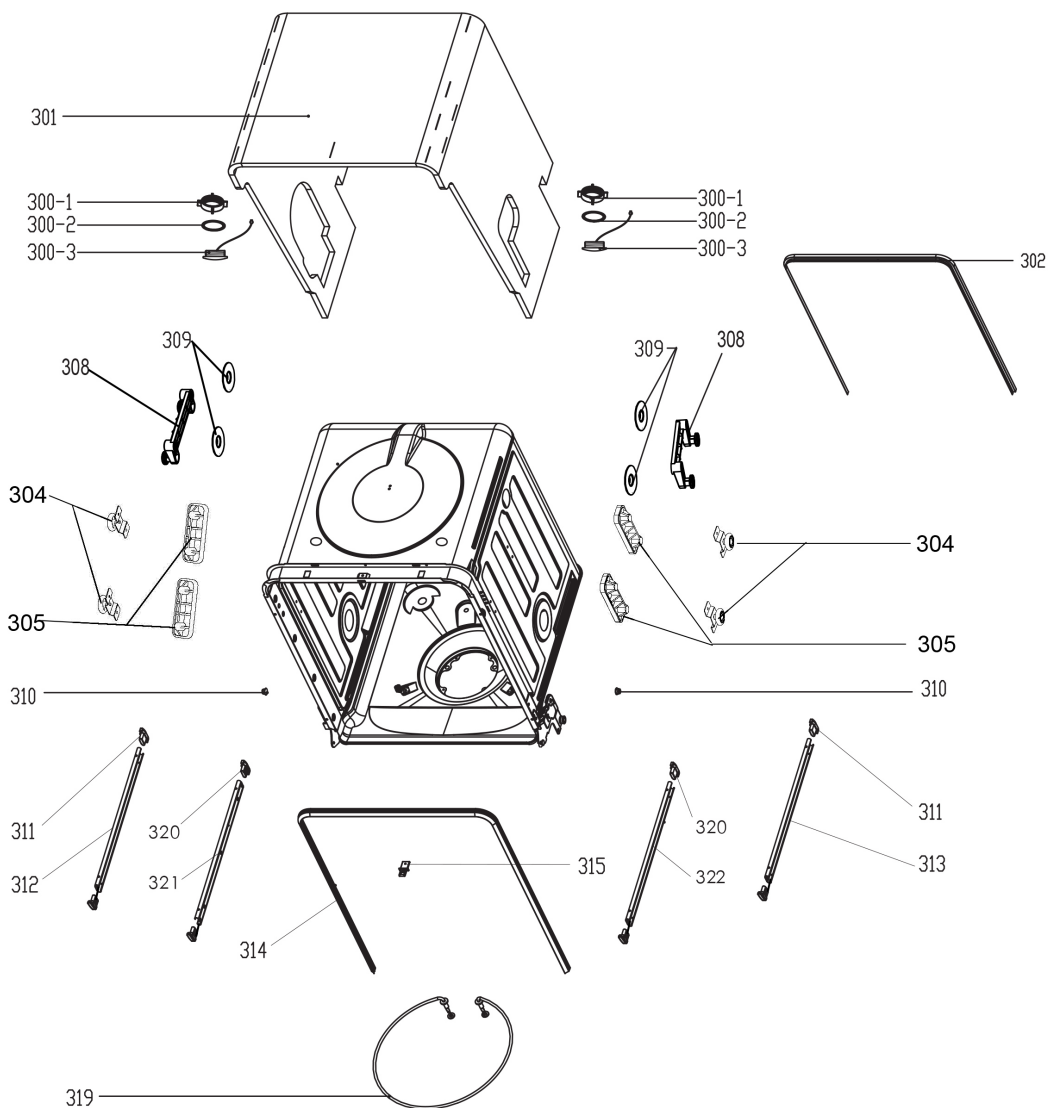

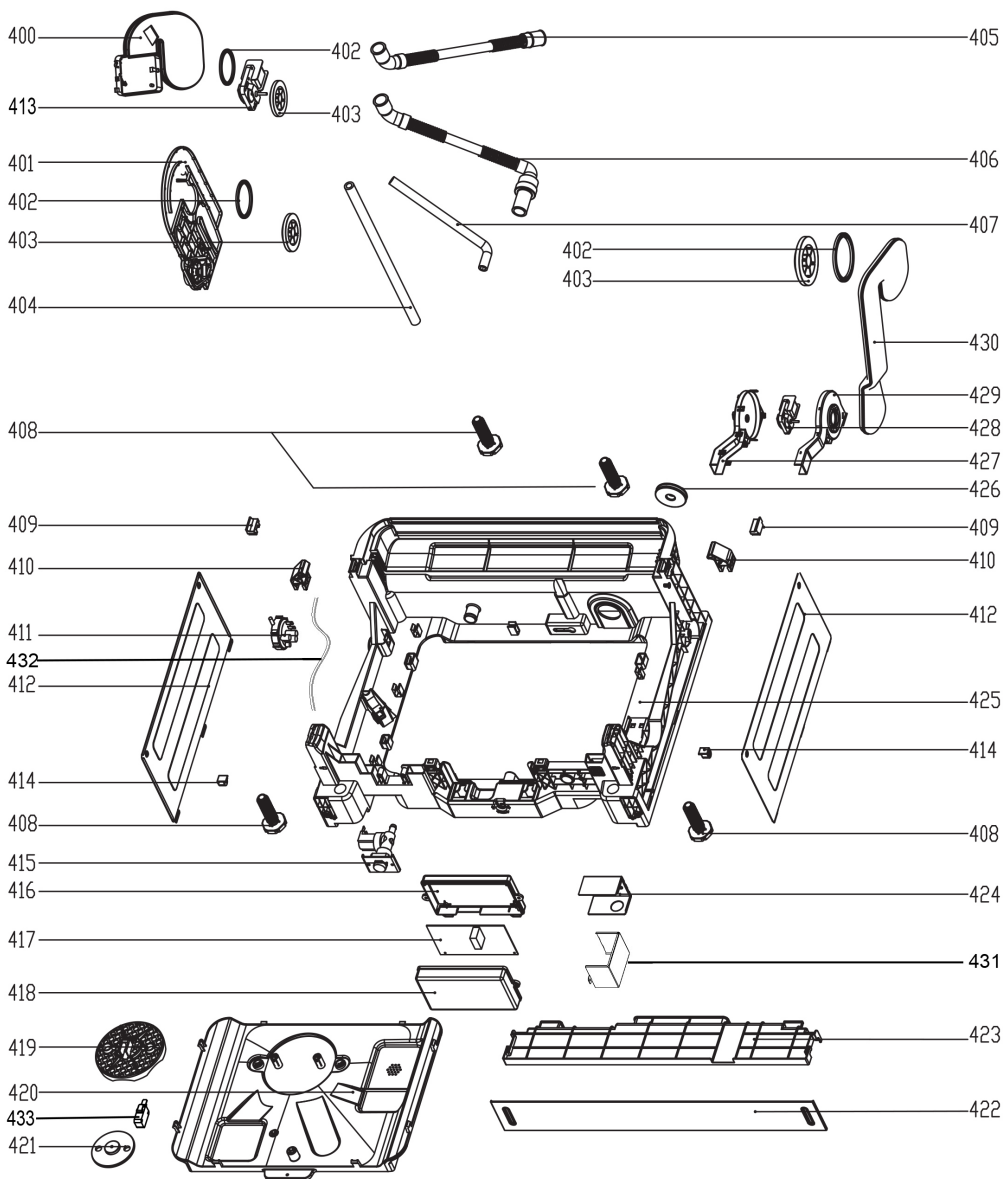

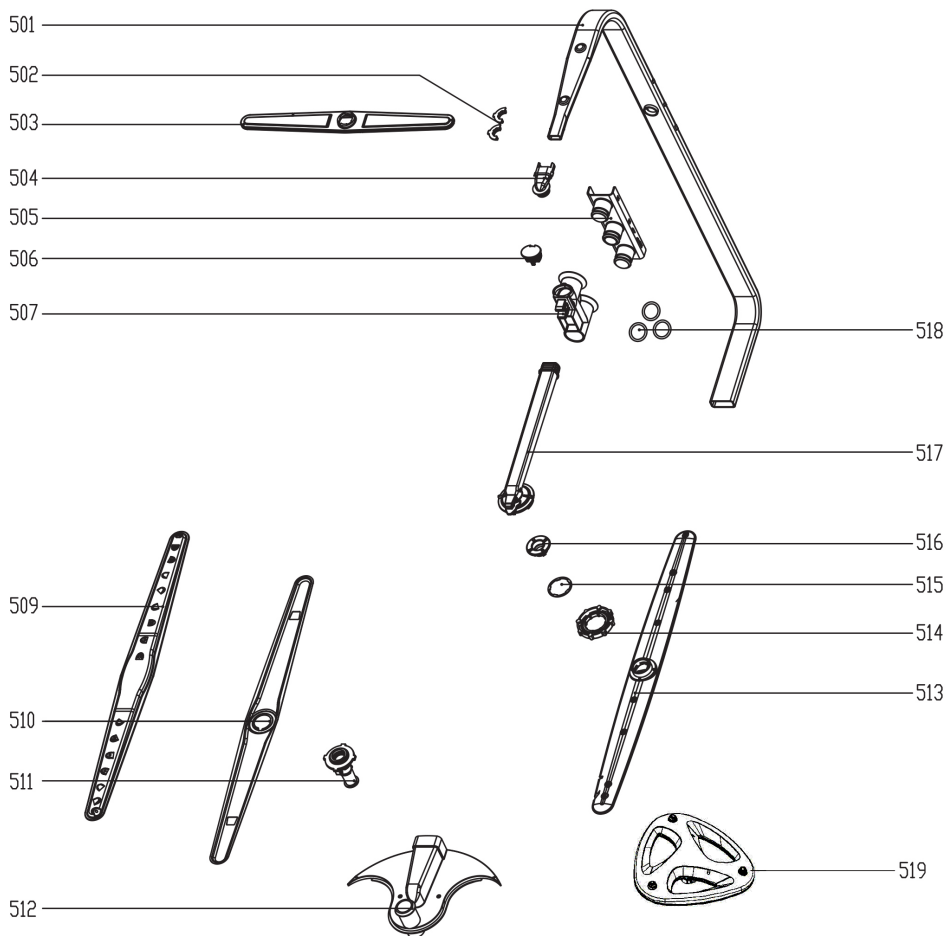

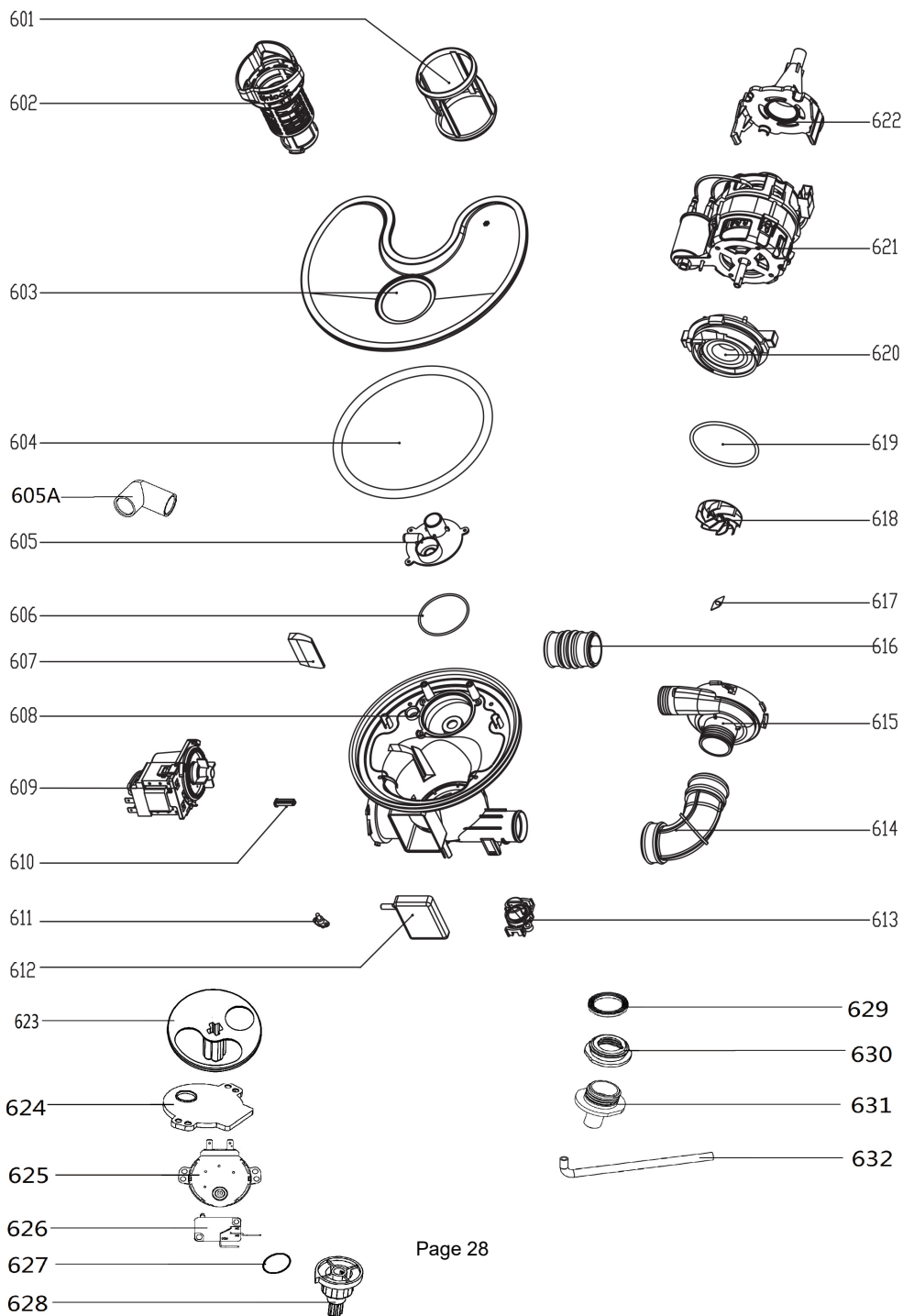

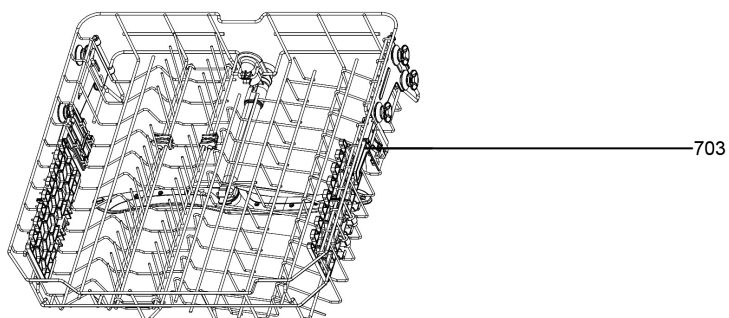
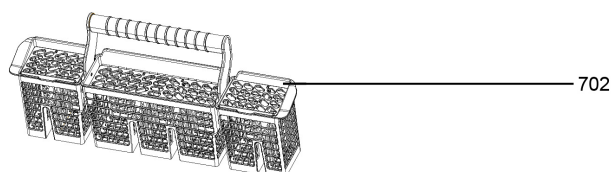
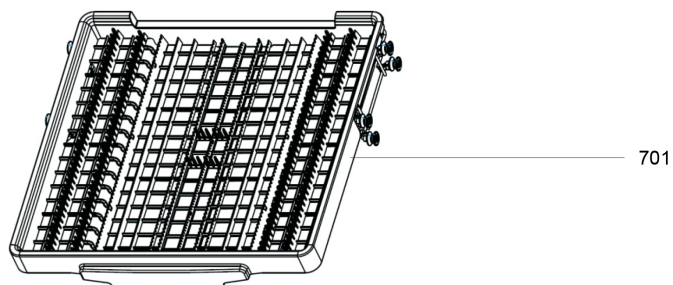

805

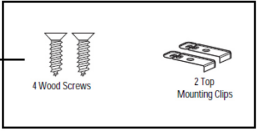

801

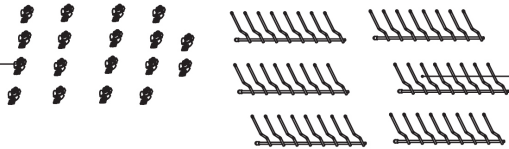

806

802

803

804

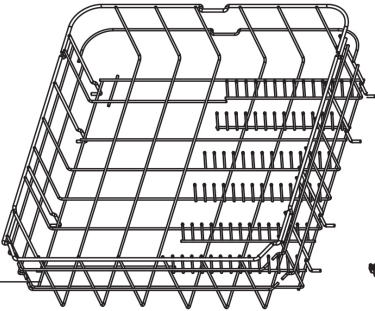

802

803

808

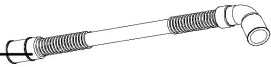

807



WARRANTY AND SERVICE



For full warranty details on this product please visit:

<http://www.cosmoappliances.com/warranty>

Warranty Support: 1-855-877-4085

Product Information: 1-888-784-3108