

KITCHEN AND BATH SOLUTIONS

Company Overview

LifeArt Cabinetry offers a broad range of cabinet styles, both framed and frameless, at a variety of price points. This benefit allows our customers to choose the perfect combination of features for their needs and budgets.



Working directly with our manufacture plant oversea and service center conveniently located in Georgia and New Jersey enables us to bring you cost efficient products with high quality control and local customer support from start to finish. With years of experience and refinement, we are confident that we will deliver quality products and service that you and your customer can count on.



www.LifeArtCabinetry.net

DOOR STYLES AND FEATURES



Anchester_1 Anchester_2 Anchester_3 Birmingham Cambridge Edinburgh



Heidelberg Kingston Oxford Wurzburg Princeton Princeton_2



Lancaster_1 Lancaster_2 Lancaster_3 Yorktown

Model A1, A2, A3, B, C, E, H, K, O, W
 Full Overlay Euro-Style Cabinets (Frameless)
 Five-Piece Solid Maple Doors & Drawer Fronts
 MDF Center Panel For A1, A2, A3, B, O, W
 Dovetail Drawer Box Construction
 Soft Close Drawers and Doors
 3/4" Plywood Box and Shelves
 Color Matched Interior & Exterior
 Metal Drawers for A1, A2, A3
 Solid Wood Drawers for C & E

24 HOURS
 Turnaround Time!

Model P, P2, L1, L2, L3, Y
 Full Overlay Framed Cabinets
 Five-Piece Solid Maple Doors and Drawer Fronts
 MDF Center Panel
 1/2" Plywood Box Construction
 Solid Wood Dovetail Drawers
 Full Extension Soft Closed Undermount Glides
 Soft Closed Hinges
 3/4" Adjustable Plywood Shelving
 Clear Coated Natural Maple Finished Interior



KITCHEN AND



BIRMINGHAM



EDINBURGH



CAMBRIDGE



OXFORD



HEIDELBERG



PRINCETON



WURZBURG

BASE CABINET

BASE CABINET - 1 DRAWER
1 DOOR, 1 ADJUSTABLE SHELF

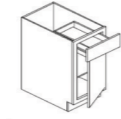

B09 B12
B15 B18
B21

BASE CABINET - 1 DRAWER
2 DOORS, 1 ADJUSTABLE SHELF



B24 B36
B27 B39
B30 B42
B33

NOTE: FRAMED B33-B42 HAS 2 DRAWERS

BASE DRAWER CABINET
3 DRAWERS

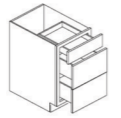

DB12-3 DB27-3
DB15-3 DB30-3
DB18-3 DB33-3
DB21-3 DB36-3
DB24-3

SINK BASE CABINET
1 DUMMY DRAWER, 2 DOORS



SB24 SB36
SB27 SB39
SB30 SB42
SB33

NOTE: FRAMED SB33-SB42 HAS 2 DUMMY DRAWERS

BASE WASTE BASKET CABINET
1 DRAWER, 1 PULL-OUT DOOR

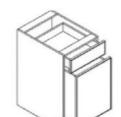

BWBK18(FRAMED)
BWBK18-2(FRAMELESS)
NOTE:
TRASH CAN SOLD
SEPERATELY

LAZY SUSAN CABINET - 2 FULL
HEIGHT FOLDING DOORS



BLS33
BLS36

NOTE: METAL LAZY SUSAN
SPINNER SOLD SEPERATELY

BASE DIAGONAL CABINET
1 DOOR, 1 ADJUSTABLE SHELF



BDC36

NOTE: THIS CAN ALSO BE USED AS A
CORNER SINK BASE CABINET, JUST
LEAVE OUT THE SHELF

BASE BLIND CORNER CABINET
1 DOOR, 1 DRAWER,
1 ADJUSTABLE SHELF (FRAMELESS)

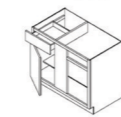

BBC39
BBC42
BBC45

NOTE: BBC39 DOOR 12" WIDE
BBC42 DOOR 12" WIDE
BBC45 DOOR 12" WIDE

BASE BLIND CORNER CABINET
1 DOOR, 1 DRAWER,
1 ADJUSTABLE SHELF (FRAMED)



BBC36
BBC39
BBC42

NOTE: MUST PULL 3"
FROM THE WALL
BBC36 DOOR 12" WIDE
BBC39 DOOR 15" WIDE
BBC42 DOOR 18" WIDE

BASE CABINET

BASE SPICE RACK CABINET
1 FULL HEIGHT DOOR
(PULL-OUT) 3 FIXED SHELVES

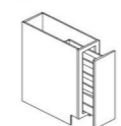

BSR09

BASE SPICE DRAWER(NO SLIDES)
5 SPICE DRAWER

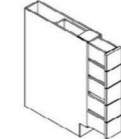

BSDC06

BASE END ANGLE CABINET
1 DOOR, 1 FAKE DRAWER,
1 ADJUSTABLE SHELF



BEA12L
BEA12R

(FRAMELESS) (FRAMED)

BASE OPEN END SHELF 12"
NO DOOR, 1 FIXED SHELF



BOES12L
BOES12R

NOTE: BOES12L IS ON THE LEFT
& BOES12R IS ON RIGHT

3 7/8" KNEE DRAWER - 1 DRAWER

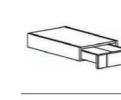

KDD24
KDD30
KDD36

BASE KITCHEN-SIZE DRAWER
1 DRAWER



BKD24
BKD30
BKD36

NOTE: FIRST DRAWER OF DB

BASE VANITY-SIZE DRAWER
1 DRAWER



DKD 24
DKD 30
DKD 36

NOTE: FIRST DRAWER OF VBD

WALL CABINET

WALL CABINET - 1 DOOR
2 ADJUSTABLE SHELVES



W0930
W1230
W1530
W1830
W2130

WALL CABINET - 2 DOORS
2 ADJUSTABLE SHELVES

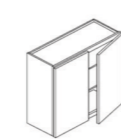

W2430
W2730
W3030
W3330
W3630

WALL CABINET

WALL CABINET - 1 DOOR
2 ADJUSTABLE SHELVES



W0936
W1236
W1536
W1836
W2136

WALL CABINET - 2 DOOR
2 ADJUSTABLE SHELVES

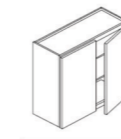

W2436
W2736
W3036
W3336
W3636

WALL CABINET - 1 DOOR
3 ADJUSTABLE SHELVES



W0942
W1242
W1542
W1842
W2142

WALL CABINET - 2 DOORS
3 ADJUSTABLE SHELVES



W2442
W2742
W3042
W3342
W3642

WALL CABINET - 2 DOORS
NO SHELF

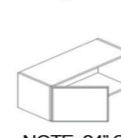

W2412 W2415 W2418
W3012 W3312 W3612
W3015 W3315 W3615
W3018 W3318 W3618
W3021 W3321 W3621

NOTE: 24" SHORT CABINETS NOT
AVAILABLE IN B,H,K

WALL CABINET - 2 DOORS
1 ADJUSTABLE SHELF

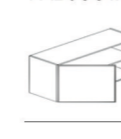

W3024
W3324
W3624

WALL CABINET - 2 DOORS
NO SHELF

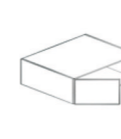

W3612-24
W3615-24
W3618-24
W3621-24

WALL CABINET - 2 DOORS
1 ADJUSTABLE SHELF

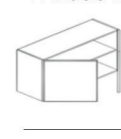

W3624-24

WALL DIAGONAL CORNER
1 DOOR, 2 ADJUSTABLE SHELVES



WDC2430
WDC2436
WDC2436-15

WALL CABINET

WALL DIAGONAL CORNER
1 DOOR, 3 ADJUSTABLE SHELVES



WDC2442
WDC2442-15

WALL STEM GLASS HOLDER



SGH3012
SGH3612

NOTE: SGH3012 HAS 8 SLOTS,
SGH3612 HAS 10 SLOTS

WALL WINE RACK CABINET

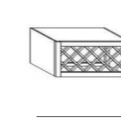

WRC3015
WRC3018
WRC3615
WRC3618

WALL OPEN END SHELF
NO DOOR, 2 FIXED SHELVES

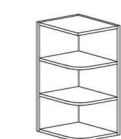

WOES1230
WOES1236

WALL OPEN END SHELF
NO DOOR, 3 FIXED SHELVES

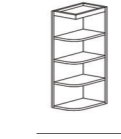

WOES1242

WALL SMALL DRAWER CABINET
2 DRAWERS

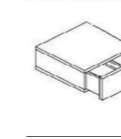

WSD1206

WALL SMALL DRAWER CABINET
3 DRAWERS

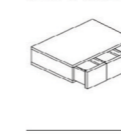

WSD1806

WALL END ANGLE CABINET
1 DOOR, 2-3 SHELVES

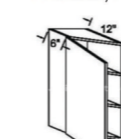

WEA1230
WEA1236
WEA1242

WALL MULLION DOOR CABINET
1 DOOR, 2 ADJUSTABLE
SHELVES, GLASS NOT INCLUDED



WMD1230
WMD1530
WMD1830
WMD2130

WALL CABINET

WALL MULLION DOOR CABINET
2 DOORS, 2 ADJUSTABLE
SHELVES, GLASS NOT INCLUDED



WMD2430
WMD2730
WMD3030
WMD3330
WMD3630

WALL MULLION DOOR CABINET
1 DOOR, 2 ADJUSTABLE
SHELVES, GLASS NOT INCLUDED



WMD1236
WMD1536
WMD1836
WMD2136

WALL MULLION DOOR CABINET
2 DOOR, 2 ADJUSTABLE
SHELVES, GLASS NOT INCLUDED



WMD2436
WMD2736
WMD3036
WMD3336
WMD3636

WALL MULLION DOOR CABINET
1 DOOR, 3 ADJUSTABLE
SHELVES, GLASS NOT INCLUDED



WMD1242
WMD1542
WMD1842
WMD2142

WALL MULLION DOOR CABINET
2 DOORS, 3 ADJUSTABLE
SHELVES, GLASS NOT INCLUDED



WMD2442
WMD2742
WMD3042
WMD3342
WMD3642

WALL MULLION DOOR CABINET - 2 DOORS,
NO SHELVES, GLASS NOT INCLUDED



WMD2412 WMD3012
WMD2415 WMD3015
WMD2418 WMD3018

NOTE: NOT AVAILABLE IN B, H, K

WALL DIAGONAL MULLION DOOR
CABINET - 1 DOOR, 2 ADJUST-
ABLE SHELVES, GLASS NOT
INCLUDED



WDCMD2430
WDCMD2436
WDCMD2436-15

WALL DIAGONAL MULLION DOOR
CABINET - 1 DOOR, 3 ADJUST-
ABLE SHELVES, GLASS NOT
INCLUDED



WDCMD2442
WDCMD2442-15

WALL DISH - HOLDER CABINET

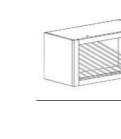

WCD3015

TALL CABINET

TALL PANTRY, 1 UPPER DOOR
AND, 1 LOWER DOOR



PC1884
PC1890
PC1896

NOTE: ALL FRAMED TALL CABINETS
COME WITH 27" DEPTH

TALL PANTRY - 2 UPPER DOORS
AND 2 LOWER DOORS

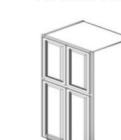

PC2484
PC2490
PC2496
PC3084
PC3090
PC3096

NOTE: ALL FRAMED TALL CABINETS
COME WITH 27" DEPTH

DOUBLE OVEN CABINET
2 UPPER DOORS AND
1 LOWER DRAWER

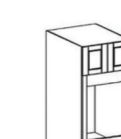

DOC3084
DOC3090
DOC3096

NOTE: FRAMLESS DOC
OPENING 28 1/2" X 56 1/4"
(INSIDE DIMENSION) CABINET
COMES WITH TRIM MATERIAL
FRAMED DOC OPENING
26 3/4" X 49 1/2"

NOTE: ALL FRAMED TALL CABINETS
COME WITH 27" DEPTH

VANITY CABINET

VANITY DRAWER BASE
CABINET - 3 DRAWERS

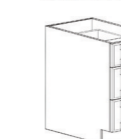

VBD12-3
VBD15-3
VBD18-3
VBD21-3

VANITY SINK BASE CABINET
1 DUMMY DRAWER, 2 DOORS

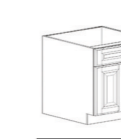

VSF24
VSF27
VSF30
VSF36

VANITY SINK BASE CABINET
1st DUMMY DRAWER, 1 DOOR

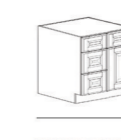

VSD 30-L
VSD 30-R

MOLDINGS & ACCESSORIES

DECORATIVE DOOR PANEL

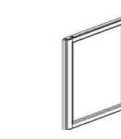

D1230W
D1236W
D1242W
D2430B

MOLDINGS & ACCESSORIES

FLUTED FILLER

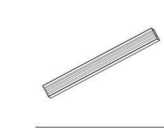

RWF330
RWF336
RWF342
RWF396

FILLER

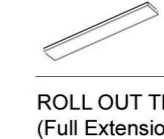

WF330 WF396
WF336 WF642
WF342 WF696

ROLL OUT TRAY
(Full Extension Track Included)



ROT18 ROT30
ROT21 ROT33
ROT24 ROT36
ROT27

FINISHED PANEL - FINISHED
EDGE AT ALL SIDES

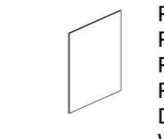

PNL2496 3/4" THICK
PNL2796 3/4" THICK
PNL3596 3/4" THICK
PNL4896 3/4" THICK
DWR (L/R)
WITH 2" RETURN
BP4896 1/8" THICK

CORBEL - STAIN FINISH LEAF DESIGN

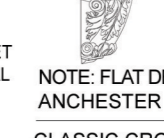

COR-S
COR-M
COR-L

NOTE: FLAT DESIGN IS AVAILABLE FOR
ANCHESTER COLLECTIONS ONLY

CLASSIC CROWN MOLDING



CCM8

NOTE: MODEL H & K COME
WITH ROPE ON CCM8

ANGLED CROWN MOLDING



ACM8

NOTE: ACM8 IS FOR SHAKER
STYLES ONLY

COUNTER TOP MOLDING



CTM8

NOTE: CTM8 IS FOR SHAKER
STYLES ONLY

OGEE MOLDING



OGM8

NOTE: LENGTH OF ALL
MOLDINGS MADE OF FINGER -
JOINTED MATERIAL

VALANCE



VAL36
VAL42
VAL48
VAL60

VALANCE DECO FLOWER



DECO FLOWER(S)
DECO FLOWER(M)
DECO FLOWER(L)

MOLDINGS & ACCESSORIES

LIGHT RAIL MOLDING



IV18

NOTE: IV18 IS NOT AVAILABLE
FOR ALL SHAKER STYLES

CORNER LIGHT RAIL MOLDING



IVITC06

CTMTC06
AVAILABLE FOR
ALL SHAKER STYLES

OUTSIDE CORNER MOLDING

