

Professional Wall Mounted Accessories Fitting Instructions

Thank you for purchasing this Croydex product. Please follow the fixing and care instructions to ensure your accessory is fitted safely and retains its high quality finish. **Please retain this leaflet for future reference.**

Fixing Pack Contents

Fixing Screws x 2 (4) (Double Mounting)
Wall Plug X 2 (4) (Double Mounting)

Contents supplied will vary depending on the product. The quantities shown, in brackets above, are for double bracket fixings.

NOTE - The wall plugs supplied are for solid walls only; use appropriate fixings for cavity walls

Tools Required

Drill; Pencil; 6mm masonry drill bit; 6mm ceramic drill bit (optional); Spirit Level; Cross head screwdriver; Small flat head screwdriver; Tape measure

KEEP DIY TOOLS OUT OF THE REACH OF CHILDREN

Safety and Care Advice

1. Always take care when using an electric drill, particularly in the bathroom. Always check for hidden cables and pipework before drilling. Always use a residual current circuit breaker (RCCB) when using mains powered tools and take extreme care if there is any water in the working area.
2. Always wear suitable eye protection when drilling.
3. If the product is to be fitted on a ceramic tiled wall, a ceramic drill bit should be used. Do not drill mounting holes in the grouted area between tiles. Mask the area around the hole with tape before drilling to prevent damage to the tile.
4. Do not use the product as a grab bar.

Instructions for items with single and double mounting point:

1. For wall mounted accessory product, assemble where required, and place and mark its position on the wall by accurately drawing around the circumference of the wall bracket. (See Fig.1)
2. Remove the fixing bracket from the product by loosening the small grub screw. (See Fig.1)
3. Centre the fixing bracket within the outline and use it as a template to mark the screw positions on the wall surface. (See Fig.1)
4. For direct fitting of products without fixing brackets use the product as a template to mark the screw positions on the wall surface. (See Fig.2 & 3)
5. Drill the holes to a depth of 35mm in the marked positions using a 6mm masonry drill. If the product is to be fitted onto a ceramic tiled wall, a ceramic drill bit should be used.

6. Insert the wall plugs flush to the surface of the wall. If fitting to a tiled surface, the wall plugs should be inserted below the surface of the tile to avoid cracking.
7. Insert the screws provided through the wall fixing bracket and screw onto the wall. Ensure the wall bracket is level. **DO NOT OVERTIGHTEN.**
8. Place the product onto the fixing bracket and tighten the grub screw as shown. (Fig. 1.)

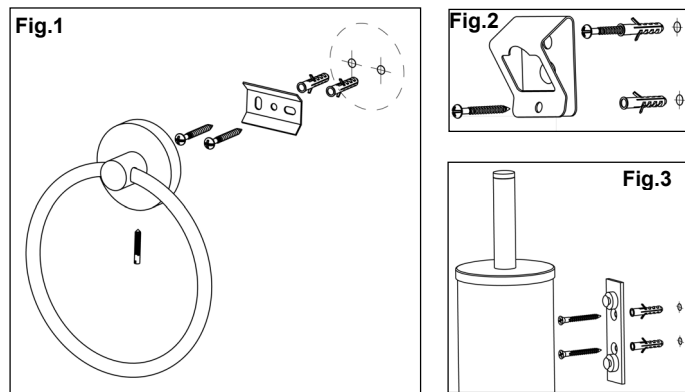

Additional Information

Maximum safe working load for the shelf is 5kg. This load must be evenly distributed across the surface area of the shelf.

Product Care Advice

- To retain the best quality finish, clean product regularly with a soft damp cloth.
- Do not use abrasive or chemical cleaners, as these will damage the product.
- Do not place hot objects onto the surface of the glass.
- Do not position glass components in close contact with a heat source

For details of the other items in the Croydex range please visit our website: www.croydex.co.uk

Croydex Limited, Central Way, Andover, Hants, SP10 5AW, UK
Tel: +44 (0) 1264 365881. Fax: +44 (0) 1264 356437
Website: www.croydex.co.uk. E-mail: info@croydex.co.uk

WMA 047 R01