

Ozeri®

Ultra Wind 42"™

Adjustable Oscillating Tower Fan

With Smart LCD & Remote Control

Model No: OZF1

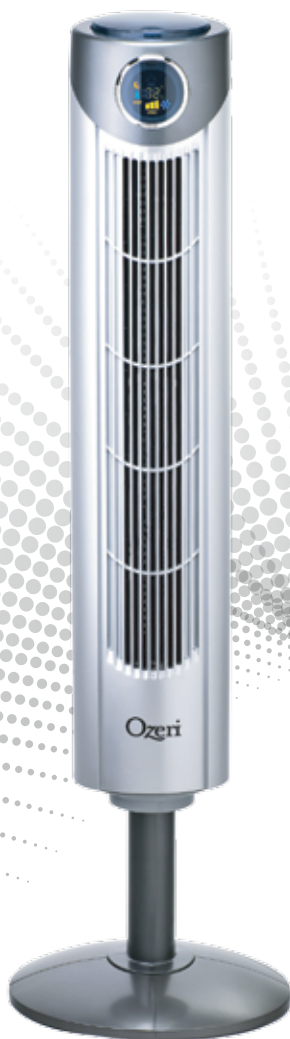

The images in this manual are for illustration purposes only and may vary slightly from actual product.

Important Safety Instructions

Thank you for purchasing the Ozeri Ultra 42" Fan. This product has passed extensive quality assurance tests for residential use. Every care has been taken to ensure that it reaches you in perfect condition.

Warning: When using electric appliances, basic safety precautions should be followed to reduce the risk of fire, electric shock and personal injury, including (but not limited to) the following:

Read all these instructions before attempting to operate this product and save these instructions for future reference:

- THIS FAN HAS A POLARIZED PLUG (ONE BLADE IS WIDER THAN THE OTHER). TO REDUCE THE RISK OF ELECTRICAL SHOCK, THIS PLUG IS INTENDED TO FIT IN A POLARIZED OUTLET ONLY ONE WAY. MATCH THE WIDE BLADE OF THE PLUG TO THE WIDE SLOT OF THE OUTLET. FULLY INSERT. IF THE PLUG DOES NOT FIT FULLY IN THE OUTLET, REVERSE THE PLUG. IF IT STILL DOES NOT FIT, CONTACT A QUALIFIED ELECTRICIAN. DO NOT ATTEMPT TO BYPASS THIS SAFETY FEATURE.
- Use this fan only as described in this manual.
- Check the voltage indicated on the rating plate. This fan is designed for a 120V-60Hz electric supply. Make certain the power source conforms to these electric requirements. Make sure the room where this fan will be used has a working smoke detector.
- Do not use an electrical extension cord with this fan. Do not plug the fan into a power strip. The use of such devices may create electric and/or fire hazards.
- Do not force your fingers through the front of the case. Do not allow any foreign objects through the front of the case.
- This product is not a toy. Do not allow children to tamper with the fan.
- Be careful not to allow hair, curtains, tablecloth, clothes or other nearby objects block the airways of the fan or to enter the openings of the fan. This can cause damage and/or injuries.
- Do not use this or any fan if the cord is found to be or becomes damaged. Periodically check the electric cable of this fan. If the electric cable is damaged, it must be replaced by the

manufacturer, its after-sales service or by a similar qualified person in order to avoid danger.

- Do not use this fan if it falls and/or becomes damaged in any way. If the fan becomes damaged, it must be replaced by the manufacturer, its after-sales service or by a similar qualified person in order to avoid danger.
- Do not use this fan outside, or in any commercial, industrial or agricultural setting. This fan is only for residential use. Do not use this fan with any solid state speed control devices.
- Do not use this fan in a damp area such as a bathroom.
- Do not use this fan on a window, ledge, or on any unstable platform. The fan should only be used standing on its base. Never lay the fan on its side.
- Do not use this fan next to a window or anywhere where exposure to rain or moisture is possible. This may create an electric hazard.
- Do not place the electrical cord under any objects, such as carpets, throw rugs or runners. Do not place electrical cord in areas of foot traffic where there is a risk of stumbling or tripping over it.
- The fan must always be unplugged when not in use. Before unplugging the fan, first ensure it has been turned off.
- Do not operate the fan in an area where gasoline, paint supplies or any flammable liquids or explosive chemicals are used or stored.
- Do not try to repair or disassemble this fan. Doing so will void the warranty and may result in damage and/or personal injury. There are no end-user serviceable parts.
- Remote control devices for other appliances may interfere with this fan and vice-versa. If this occurs, move the fan to another location.
- Always store the remote control inside the fan's remote control compartment.
- This fan is not suitable for use in agricultural facilities and hazardous locations. This fan does not meet the requirements of NEC Article 547-7 and 500 (2002).
- **Keep this fan and all electrical appliances out of reach of children at all times.**

WARNING: Always turn off and unplug the fan when leaving the area. Never leave children unsupervised with access to this fan. There are no serviceable parts in this fan. Do not attempt to disassemble or repair this product.

Parts of the Fan

1. Remote Control Compartment with Control Panel
2. LCD Display
3. Grille
4. Extension Column (can be used to extend the height of the fan)
5. Base
6. Remote Control

Assembly Instructions

Check contents – keep packaging and user instructions for future reference.

NOTE: For shipping purposes, the support column and the base both have 2 separate halves which need to be assembled.

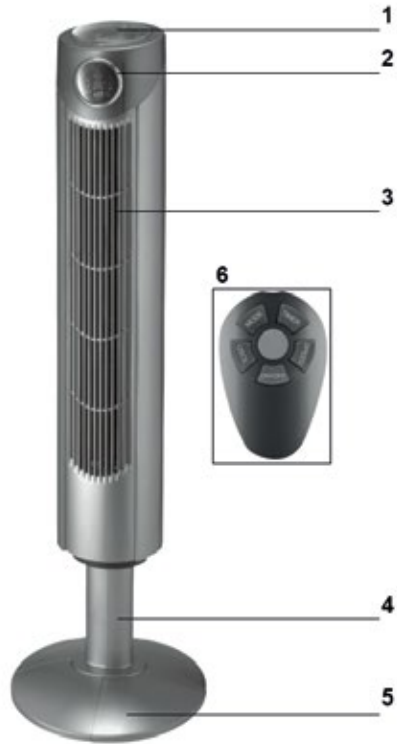

STEP 1:

Assemble the extension column by finding the two longer plastic pieces and snapping them together. If you wish to use the fan without the added height, proceed to Step 2, followed by Step 4.

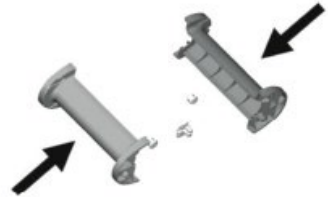

STEP 2:

Assemble the base by finding the two half-circle plastic pieces and sliding them together so that they interlock.

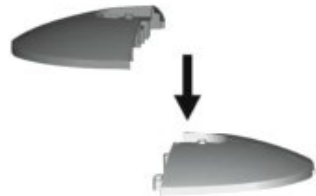

STEP 3:

Affix the support column to the main fan body. Hold the support column upright (the side with screw holes on top) and thread the power cord through it. Bring the support column up to the bottom of the fan's main body and

align the support column to the main fan body so that the screw holes on both pieces are matching. Secure with 1/4" screws provided.



STEP 4:

Affix the base onto the assembly completed in Step 3 in a similar fashion. Hold the base upright (the side with a smooth surface) and thread the power cord through the center hole. Bring it up to meet the extension column and ensure that the screw holes on both are aligned. Secure together with nut wing-nut screws provided. If using without the extension column, attach directly to main fan body.

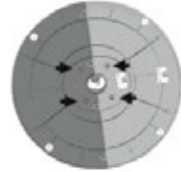

COMPLETED FAN (WITH EXTENSION COLUMN)

CAUTION: THIS FAN MUST OPERATE IN THE UPRIGHT POSITION ONLY. DO NOT LAY FAN ON ITS SIDE OR IN ANY OTHER POSITION. DOING SO MAY CAUSE DAMAGE TO THE FAN AND/OR PERSONAL PROPERTY. DO NOT USE THIS FAN WITHOUT ITS BASE.



Operating Instructions

1. Remove the cable tie and unravel the cord set before operation.
2. DO NOT use outdoors.
3. Plug fan into a 120v, 60Hz outlet.

The control panel and the remote of this fan are equipped with an LCD display and 6 functions (Power, Speed, Oscillation, Timer+, Timer- and Mode). For your convenience, the buttons on the remote are designed to function in the same way as the keys on the fan's control panel. The LCD display has lights that illuminate to indicate the fan's active functions.

On/Off: Press this button to power the fan ON. When the fan is ON, the power light on the LCD display will be illuminated. Once the fan is ON, you may proceed to set the following functions. To power OFF, press this button again.

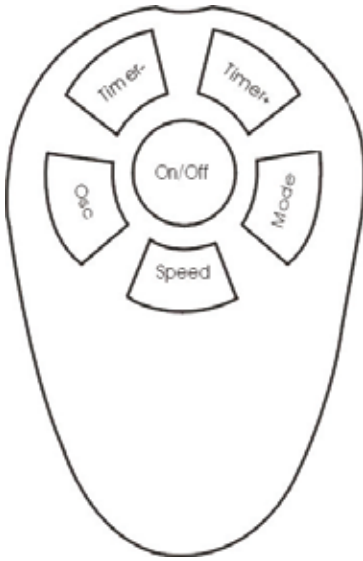

REMOTE CONTROL

Osc: To activate the oscillation function for widespread breeze distribution, simply press this button. To turn off the oscillation function for a targeted breeze setting, press the button again.

Timer+: This button sets the duration of operation before the fan automatically turns OFF. Pressing this button will increase the time of operation in 1 hour increments to a maximum of 12 hours. The total time selected is indicated by the light(s) illuminating at 1H, 2H, 3H, etc., on the LCD display.

Timer-: This button sets the duration of operation before the fan automatically turns OFF. Pressing this button will decrease the time of operation in 1 hour decrements from 12 hours to a minimum of 1 hour. The total time selected is indicated by the light(s) illuminating at 1H, 2H, 3H, etc., on the LCD display.

Speed: Choose from 3 comfort settings (HIGH, MED, LOW) by pressing this button until the speed you want is indicated on the LCD display.

Mode: Choose from 3 different breeze patterns (Sleep, Nature, Normal) by pressing this button until the type of breeze desired is indicated on the LCD display.

Night Mode LCD: This fan offers a night mode feature whereby all icons on the LCD are dimmed except for the moon icon. To activate the night mode feature, press and hold the MODE button on the fan's control panel for 3 seconds. To deactivate, press any button briefly and the LCD will awake to its full display.

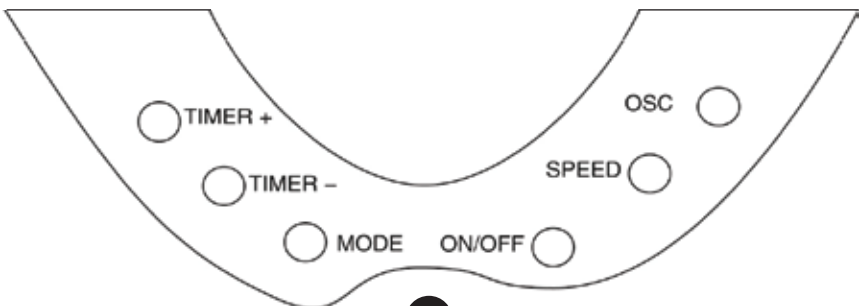

Color LCD Display

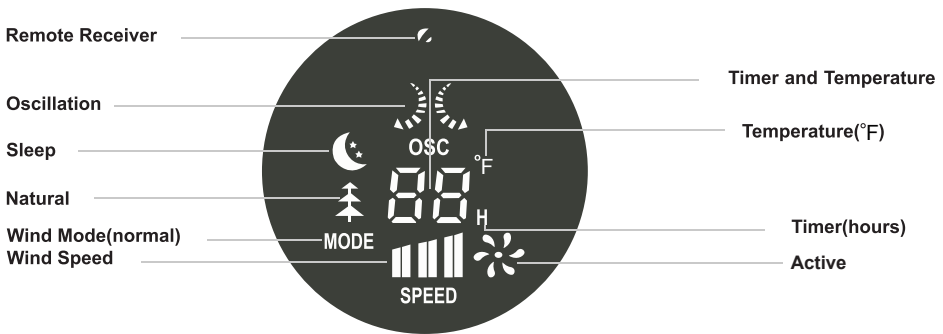

Note: For fans purchased in the USA, the LCD will display the room temperature in Fahrenheit.

Guidelines for using the remote control

- The remote control must be pointed towards the receiver on the fan in order to work.
- The remote control may not operate in a room where a heavy machine is operating.
- Do not block the line of sight between the remote control and the receiver.
- Handle the remote control with care. Do not drop the remote control on the floor or bang it against hard objects.

Guidelines for use of batteries

- If the remote control will not be used for a long period of time, remove the batteries from the battery compartment.
- The remote control uses two AAA batteries, both of which should be new and replaced at the same time when they run out.
- Clean the battery contacts and also those of the device prior to battery installation.
- Ensure the batteries are installed correctly with regard to polarity, matching +/- sides of the battery to corresponding indications on the remote control.
- Remove used and dead/discharged batteries promptly.

Fan Specifications

- Model Number: OZF1
- Voltage: 120V / 60Hz
- Wattage: 55 Watt
- Oscillation Angle: 80°
- Weight: 4.70 kg (10.3 lb)
- Fan Plug Fuse Type: 2.5 Amp, 125 Volt
- Dimensions: D31cm x W31cm x H105 cm
(H89 cm without extension column)

CAUTION: THIS FAN HAS A POLARIZED PLUG (ONE BLADE IS WIDER THAN THE OTHER). TO REDUCE THE RISK OF ELECTRICAL SHOCK, THIS PLUG IS INTENDED TO FIT IN A POLARIZED OUTLET ONLY ONE WAY. MATCH THE WIDE BLADE OF THE PLUG TO THE WIDE SLOT OF THE OUTLET. FULLY INSERT. IF THE PLUG DOES NOT FIT FULLY IN THE OUTLET, REVERSE THE PLUG. IF IT STILL DOES NOT FIT, CONTACT A QUALIFIED ELECTRICIAN. DO NOT ATTEMPT TO BYPASS THIS SAFETY FEATURE.

NOTE: THIS FAN IS EQUIPPED WITH A FUSE. ALWAYS UNPLUG THE FAN BEFORE REPLACING FUSES. IF THIS FAN LOSES POWER AND YOU SUSPECT THE FUSE IN THE PLUG HAS BLOWN, UNPLUG THE FAN, THEN SLIDE THE FUSE DOOR FOUND ON THE SIDE OF THE PLUG TO THE OPEN POSITION. SLIDE THE FUSE DOOR OUTWARD UNTIL THE BLOWN FUSE IS FULLY VISIBLE. REMOVE THE BLOWN FUSE AND SNAP THE REPLACEMENT FUSE INTO PLACE. FULLY CLOSE THE FUSE DOOR. ONLY REPLACE WITH A FUSE RATED AT 2.5 AMPS, 125 VOLTS.

Fig.1

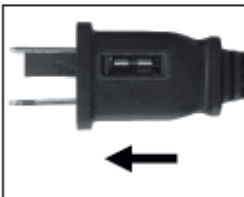
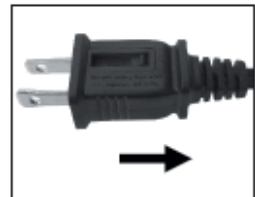

Fig.2



Fig.3



Cleaning Instructions

1. Always disconnect the cord from the electrical outlet before cleaning your fan.
2. Dust may be removed by using a vacuum cleaner along the back of the fan where the plastic grille covers the air intake.
3. Wipe the exterior surfaces of the fan occasionally with a damp cloth (not dripping wet) and dry thoroughly with a soft dry cloth before operating the fan.
4. Do not use harsh cleaners or materials to clean this unit, doing so will cause damage.

CAUTION: DO NOT ALLOW WATER TO RUN INTO THE INTERIOR OF THE FAN AS THIS COULD CREATE A FIRE OR ELECTRIC SHOCK HAZARD. THE FAN MOTOR IS FACTORY LUBRICATED FOR LIFE AND WILL REQUIRE NO FURTHER LUBRICATION. NO OTHER USER MAINTENANCE IS REQUIRED OR RECOMMENDED. IF SERVICE IS REQUIRED, SEND YOUR FAN TO THE NEAREST AUTHORIZED SERVICE CENTER.

To Store

1. Follow cleaning instructions 1-4 above.
2. Retain the original packaging to store your fan.
3. Always store in a dry place.
4. Never store while still plugged in.
5. Never wrap cord tightly around the fan or put any stress on the cord where it enters the fan as it could cause the cord to fray or break.

Troubleshooting

If your fan fails to operate, please follow these procedures prior to contacting customer service:

PROBLEM	PROBABLE CAUSE	SOLUTION
Fan is not turning on.	<p>A. Fan is not plugged into a 120V AC, 60Hz polarized outlet/receptacle.</p> <p>B. Breaker/fuse has been tripped.</p> <p>C. Fuse inside plug of fan is blown.</p>	<p>A. Ensure unit is in the OFF position. Plug in unit and attempt to turn on again.</p> <p>B. Please check your electrical box to confirm the breaker has not been “tripped”. Ensure unit is in OFF position. Plug in unit and attempt to turn on again. Attempt to plug unit in another receptacle in the house</p> <p>C. First unplug fan from outlet, then replace fuse by following fuse replacement instructions in this manual.</p>
Fan is on but air coming out of it is not strong enough.	There is dust build up at the back of the fan.	Turn fan OFF and unplug. Using a crevice tool attachment, vacuum over the grilles located at the back of the fan to remove dust build-up. Plug in unit and turn fan back ON to resume normal operation.

WARRANTY INFORMATION

Your Ozeri Ultra Fan™ is warranted to the original owner for 1 year from the date of purchase against defects in material and workmanship under normal use and service. Should your Ozeri Ultra Fan prove defective within 1 year from the date of purchase, return the defective product, freight prepaid along with an explanation of the claim to "Ozeri." Please pack your Ozeri Ultra Fan carefully to avoid damages in transit. Under this warranty, Ozeri will repair or replace any parts found to be defective due to a manufacturer's defect. This warranty extends only to personal use and does not extend to any product that has been used for commercial use, rental use, or use which is not intended. There are no warranties other than that expressly set forth herein. This warranty is not transferable. Ozeri is not responsible in any way for damages, losses or inconveniences caused by equipment failure or by user negligence, abuse, or use not in accordance with the "User Guide" or any additional safety, use, or warnings included in the product materials. Further, Ozeri is not liable for incidental or consequential damages of any nature resulting from the use of this product and any liability shall not exceed the purchase price of the product.

This Warranty gives you specific legal rights. You may also have other rights which vary from state to state.

THIS WARRANTY DOES NOT APPLY TO THE FOLLOWING

- Damage due to accident, misuse, abuse, alterations or vandalism.
- Improper or inadequate maintenance.
- Unauthorized modification or commercial use.
- Damage in return transit
- Unsupervised use by children

Ozeri Customer Service:

Phone: 1-877-299-1296

Email: support@ozeri.com

(Ozeri™ and its subsidiaries assume no liability for damage caused by the use of the Ozeri Ultra Fan other than for its intended use or as instructed above and in the User Manual.)