

01. Safety Precautions

IMPORTANT SAFEGUARDS

- ☒ • When using electrical products, especially when children are present, basic safety precautions should always be followed.

READ ALL INSTRUCTIONS BEFORE USING

- ☒ • In the case 120V 60Hz: Power supply must be a 15 Amp GFCI outlet.
- ☒ • The electrical cord must be connected to a GFCI outlet.
- ☒ • The GFCI outlet should be 1ft. above the floor.
- ☒ • Install only in well-ventilated areas to avoid excess humidity.
- ☒ • Do not install in narrow toilet stalls or in shower stalls.
- ☒ • Install only where direct contact with water is minimized.
- ☒ • Do not install near any heat source
- ☒ • Avoid using extension cords if possible. Consult with a certified electrician where extension cords are necessary.

DANGER – To reduce the risk of electrocution:

- ☒ • Do not use while bathing.
- ☒ • Do not place or store product where it can fall or be pulled into a tub or sink.
- ☒ • Do not place in or drop into water or other liquid.
- ☒ • Do not reach for a product that has fallen into water. Unplug immediately.

WARNING – To reduce the risk of burns, electrocution, fire or injury to persons:

- ☒ • Close supervision is necessary when this product is used by, on, or near children.
- ☒ • Use this product only for its intended use as described in this manual.
- ☒ • Only use attachments recommended by the manufacturer.
- ☒ • Never operate this product if it has a damaged cord or plug, if it is not working properly, has been dropped or damaged, or dipped into water. Return the product to a service center for examination and repair.
- ☒ • Keep the cord away from heated surfaces.
- ☒ • Never drop or insert any object into any opening or hose.
- ☒ • Do not use outdoors or operate where aerosol (spray) products are being used or where oxygen is being administered.
- ☒ • Connect this product to a properly grounded outlet only. See grounding instructions.
- ☒ • Unplug this product before filling. Fill (reservoir) with water only.

SAVE THESE INSTRUCTIONS

01. Safety Precautions

GROUNDING INSTRUCTION

DANGER - Improper use of the grounding plug can result in a risk of electric shock.

This product has a three-prong grounding plug, which must be plugged into an outlet that is properly installed and grounded. In the event of an electrical short circuit, grounding reduces the risk of electric shock by providing an escape wire for the electric current. If repair or replacement of the cord or plug is necessary do not connect the grounding wire to either flat blade terminal. The wire with insulation having an outer surface that is green with or without yellow stripes is the grounding wire. Check with a qualified electrician or service person if the grounding instructions are not completely understood, or if in doubt as to whether the product is properly grounded.

This product is for use on a nominal 120V circuit, and has a grounding plug that looks like the plug illustrated in sketch A in Figure 1. A temporary adapter, which looks like the adapter illustrated in sketches B and C, may be used to connect this plug to a 2-pole receptacle as shown in sketch B if a properly grounded outlet is not available.

The temporary adapter should be used only until a properly grounded outlet (sketch A) can be installed by a qualified electrician. The green colored rigid ear, plug, or the like extending from the adapter must be connected to a permanent ground such as a properly grounded outlet box cover. Whenever the adapter is used, it must be held in place by the screw.

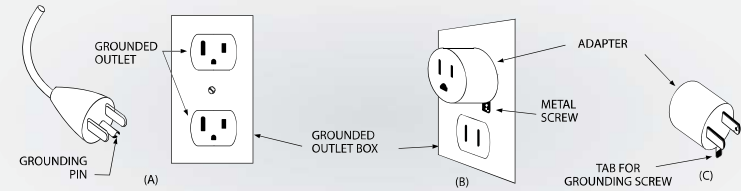
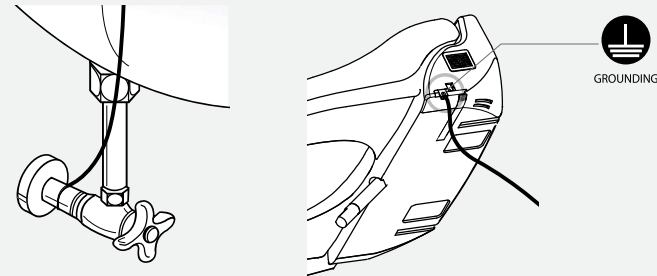

Figure 1.

Optional Grounding Instructions



02. Parts & Configuration

Main Body

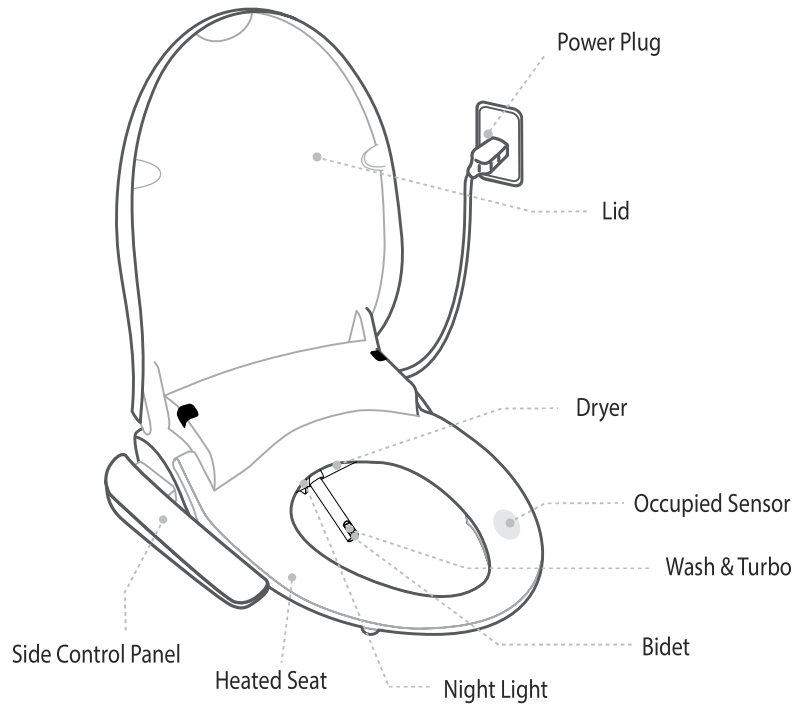

Toilet Seat type	Distance A
Round	16.9 ~ 17.7" (430 ~ 450mm)
Elongated	17.2 ~ 18.1" (450 ~ 470mm)

Operation panel

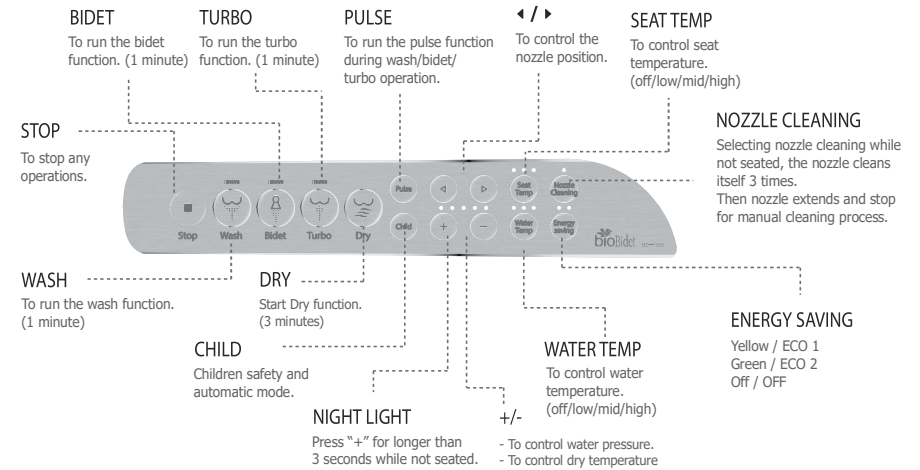

Installation Parts

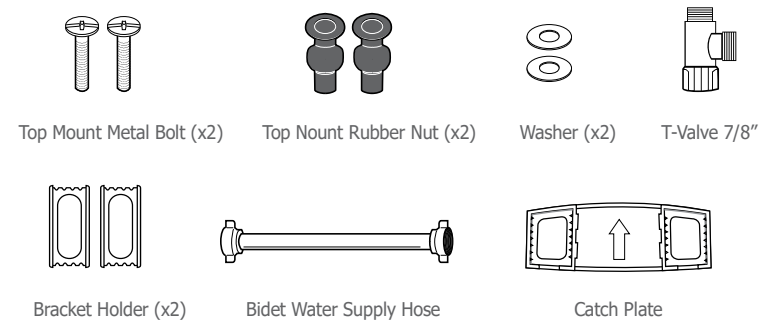

03. Installation

1 Remove the seat from the existing toilet body.

- ▶ Release the nuts, and then remove the seat and cover from it.
- ▶ Store the seat in a proper place for future use.
- ▶ Turn off the water.

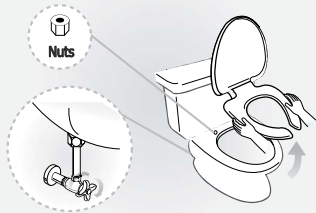

2 Remove the existing water hose and then install T-valve to the bottom of the toilet tank. Ensure the rubber washer is properly seated and attach the original water hose to the T-valve.

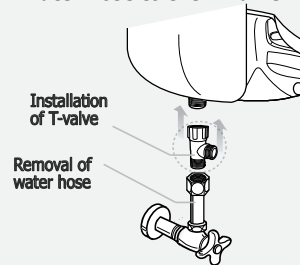

3 Fix the catch plate onto the toilet.

- ▶ Point the arrow on the catch plate towards the toilet tank.

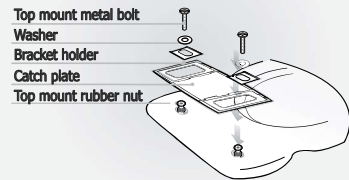

4 Push the main body toward the catch plate completely.

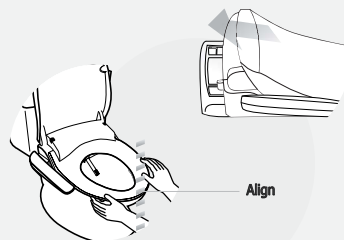

- ▶ Push it until you hear a "click".
- ▶ When the product is not installed well, it may cause leakage.
- ▶ Adjust as needed before tightening bolts.*

*Do not overtighten bolts.

5 After installing the T-valve, connect the supplied bidet hose from the center of the T-valve to the bidet.

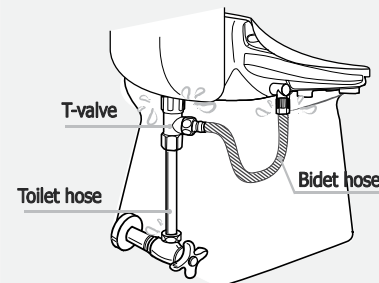

*Do not overtighten connections.

6 Turn on the water and check for leaks.

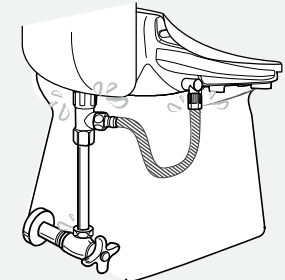

7 Plug in and be sure that the nozzle comes out and retracts when powered on.

- ▶ Don't plug the power cord with wet hands. Risk of electric shock.

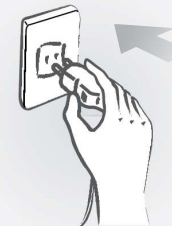

※ Using inline carbon filter

Use of external water filter is only recommended in areas with known hard water issues. If a filter is used, it must be replaced every 3 months.

This product is designed and intended for use exclusively with BioBidet DIB water filters. The purchase or use of any other water filter is not the responsibility of BBC Innovation. As such, any use of non DIB water filters is prohibited and will void the warranty for those BioBidet products. BioBidet will not be responsible for any resulting damages or claims related to the misuse or distribution of non BioBidet DIB filters.