



Item #1001 857 644

Model #D11230-TB

# USE AND CARE GUIDE

---

## LEMON GROVE BISTRO TABLE

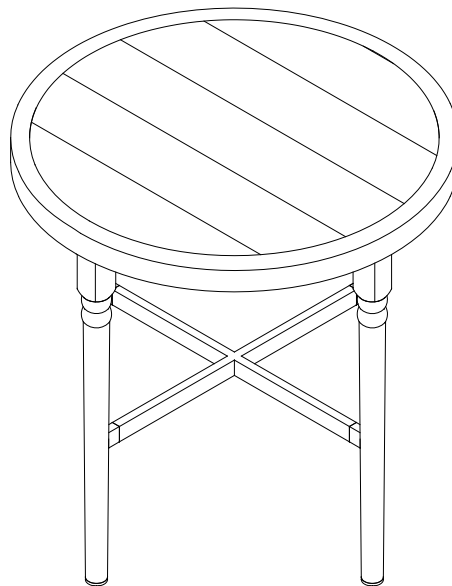

Questions, problems, missing parts? Before returning to the store,  
call Hampton Bay Customer Service  
8 a.m. - 7 p.m., EST, Monday-Friday  
9 a.m. – 6 p.m. EST, Saturday

**1-855-HD-HAMPTON**

**HAMPTONBAY.COM**

---

### **THANK YOU**

*We appreciate the trust and confidence you have placed in Hampton Bay through the purchase of this bistro table. We strive to continually create quality products designed to enhance your home. Visit us online to see our full line of products available for your home improvement needs. Thank you for choosing Hampton Bay!*

# Table of Contents

Table of Contents.....	2	Assembly.....	5
Safety Information.....	2	Care and Cleaning.....	6
Warranty.....	2		
What is Covered.....	2		
What is Not Covered.....	2		
Pre-Assembly.....	3		
Planning Assembly.....	3		
Hardware Included.....	3		
Package Contents.....	4		

# Safety Information



**WARNING:** Do not place heavy items on the table top.



**WARNING:** Do not sit or stand on the table top.

# Warranty

**THIS IS A RESIDENTIAL WARRANTY ONLY AND THIS WARRANTY DOES NOT APPLY TO COMMERCIAL USE**

**5 YEAR FRAME LIMITED WARRANTY**

**WHAT IS COVERED**

We warrant the frame to be free of manufacturing defects to the original purchaser for five years.

**WHAT IS NOT COVERED**

It remains the customer's responsibility for freight and packaging charges to and from our service center. This warranty does not cover commercial use, hardware, acts of nature, fire, freezing, and abusive use. In addition, purchased parts are not covered under this warranty. We reserve the right to make substitutions with similar merchandise, if the model in question is no longer in production.

For a copy of our full limited warranty, please contact our customer service team below.

Contact the Customer Service Team at 1-855-HD-HAMPTON or visit [www.hamptonbay.com](http://www.hamptonbay.com).

# Pre-Assembly

## PLANNING ASSEMBLY

Please read this entire instruction manual prior to assembly.

Identify all parts packed in the carton against the parts list. Remove all protective materials and place the parts on a non-abrasive surface to avoid scratching.



**NOTE:** More than one person may be required to complete the assembly of this product.

## HARDWARE INCLUDED



**NOTE:** Tools not shown to actual size.

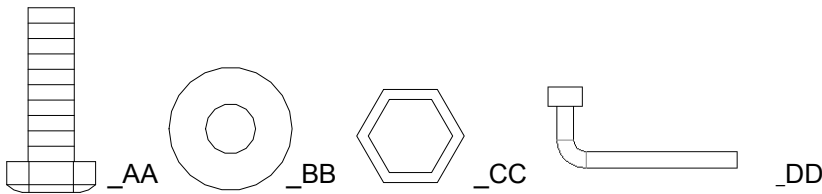

Part	Description	Quantity
AA	M6*20mm Hex bolt	12
BB	M6 Washer	12
CC	M6 Hex bolt cap	12
DD	M6 Socket wrench	1

# Pre-Assembly (continued)

## PACKAGE CONTENTS

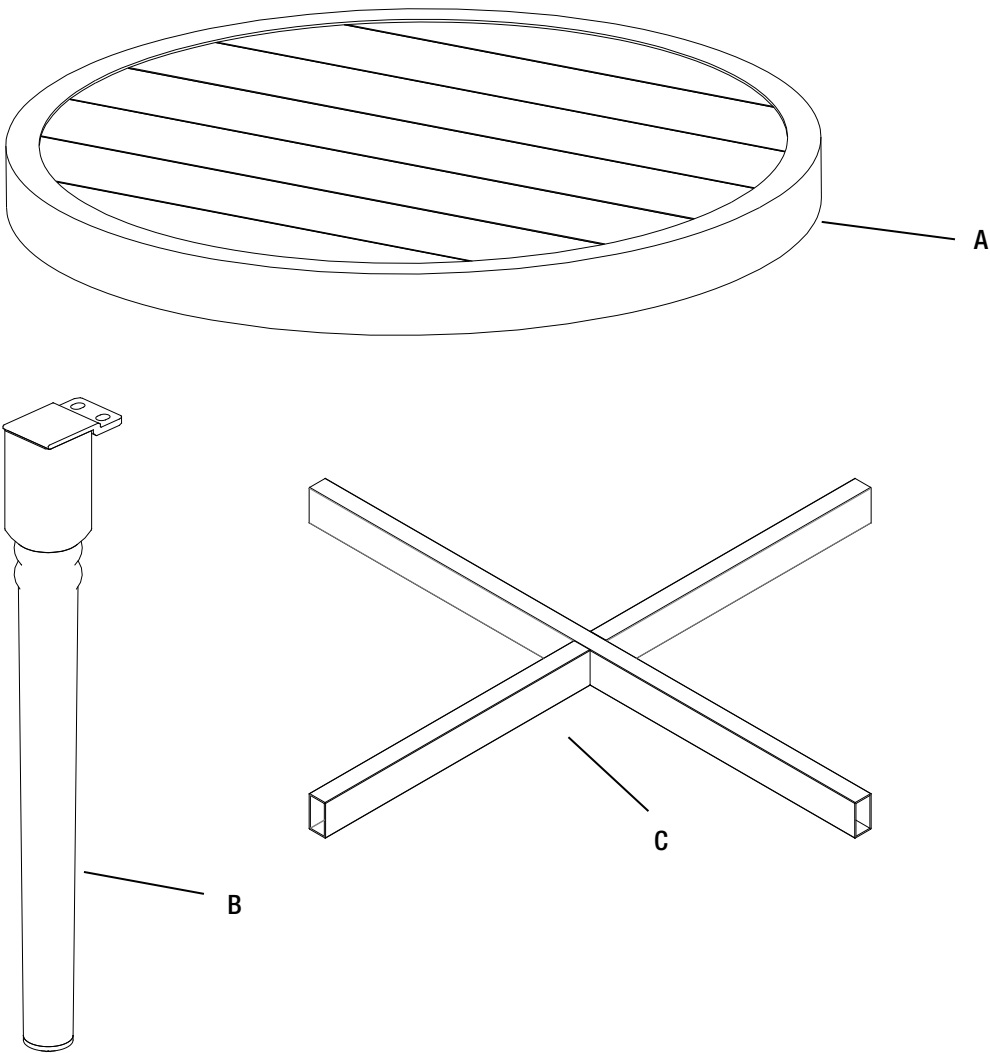

Part	Description	Quantity
A	Table top	1
B	Table leg	4
C	Table connector	1

# Assembly

## 1 Attaching the table legs

- Attach the four legs (B) to the leg connector (C) using the M6 hex bolts (AA) and washers (BB). Cover the bolt heads with caps (CC).



**NOTE:** Please ensure the bolts are assembled correctly and use the M6 wrench (DD) to tighten.

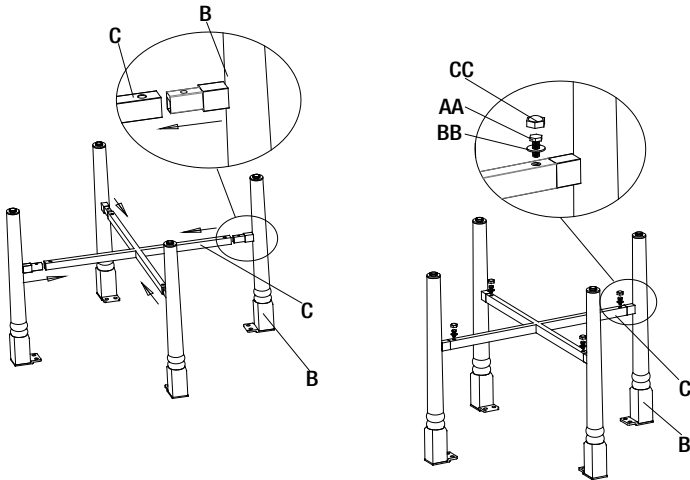

## 2 Attaching the table top

- Place the table top (A) on a soft, flat non-abrasive surface. Attach the table legs (B) to the table top (A) with the M6 hex bolts (AA) and washers (BB). Tighten all bolts and cover the heads with caps (CC).



**NOTE:** Please ensure all the bolts are assembled correctly and use the M6 wrench (DD) to tighten.

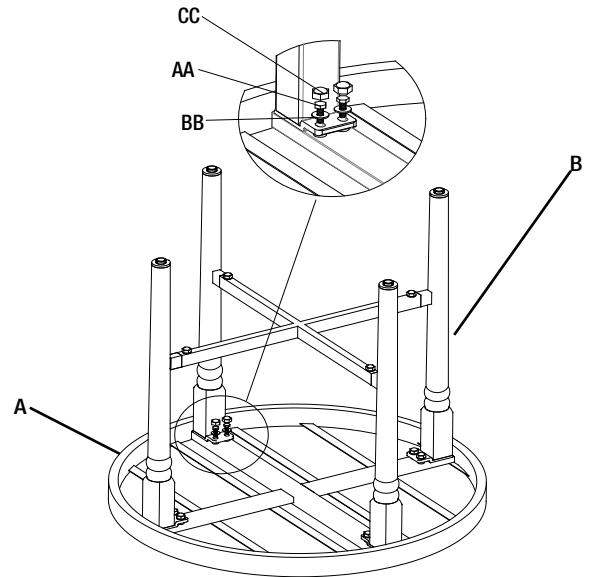

## 3 Positioning the table

- Turn the table over and set it down on its legs.
- The table is now ready for use.

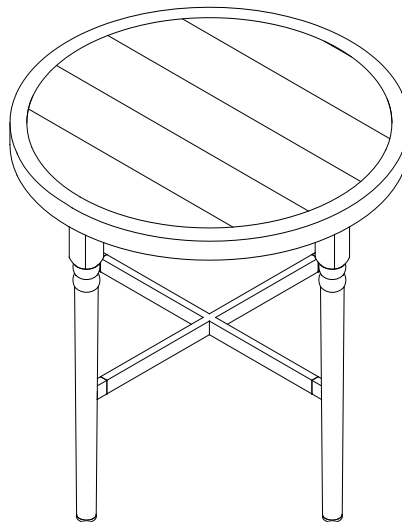

## Care and Cleaning

---

- ❑ Do not allow water to build up in the frames. This will cause corrosion and possible freezing damage in cold climates.
- ❑ Use a mild soap and water for normal cleaning. Do not use janitorial or alcohol based cleaners. Some cleaners may be marked as natural, but some ingredients may cause discoloration or have an adverse reaction to your finish.
- ❑ Rinse with clean water and dry with a soft, absorbent cloth towel.
- ❑ Treat the frames with a liquid wax for maximum protection against UV rays and/or salty, damp air.



Questions, problems, missing parts? Before returning to the store,  
call Hampton Bay Customer Service  
8 a.m. - 7 p.m., EST, Monday-Friday  
9 a.m. – 6 p.m. EST, Saturday

**1-855-HD-HAMPTON**

**HAMPTONBAY.COM**

Retain this manual for future use.