

Thanks for purchasing this product. Please read the instruction manual carefully before operation and well preserve it.

## SAFETY DIRECTIONS

1. Check before operation that the local power supply is the same as the specifications on the rating plate.

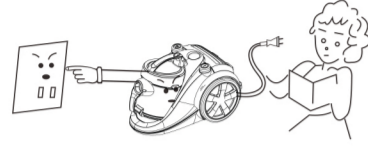

2. Do not use the vacuum cleaner to suck glowing ash, glowing cigarettes or matches, water, damp dust, etc.

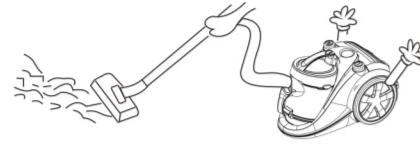

3. Don't let children play with this machine.



4. Please unplug the cleaner from the supply before cleaning it.



1

## MAINTENANCE

Filter maintenance

1

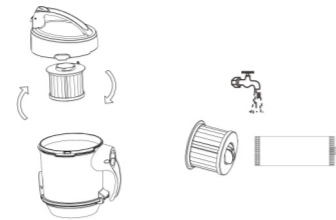

Take out the central HEPA filter and wash by running water, just as above picture shows.

2



Assemble the dried accessories as picture shows.

3

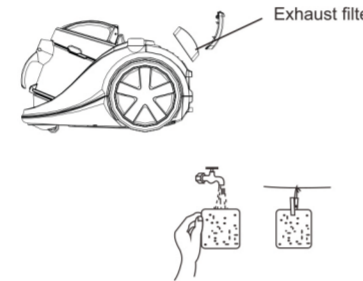

Take out the exhaust filter tapping it or washing in running water drying naturally then put it back.

6

## CAUTION

Don't pull the cord to unplug, when you would like to retract the cable, hold the plug and then press the retractor button.



Keep off from ovens and stoves, etc.



Don't suck at large fragments or sharp objects.



Don't wrest, tramp and haul the hose.



**Warning:** Never use this machine when the suction power becomes very weak. When this happens, please check if the dust bag is full (see **TO REPLACE DUST BAG**); Then check both filters if they are dirty (see **MAINTENANCE**); At last check the floor brush, tube, hose if any part is jammed.

Don't use the machine until it comes normal. If the problem remains, please submit to Repairing Center.

If the supply cord is damaged, it must be replaced by the manufacturer or its service agent or a similarly qualified person in order to avoid a hazard.

# OVENTE®

## CYCLONIC VACUUM ST2000 INSTRUCTION MANUAL VACUUM CLEANER

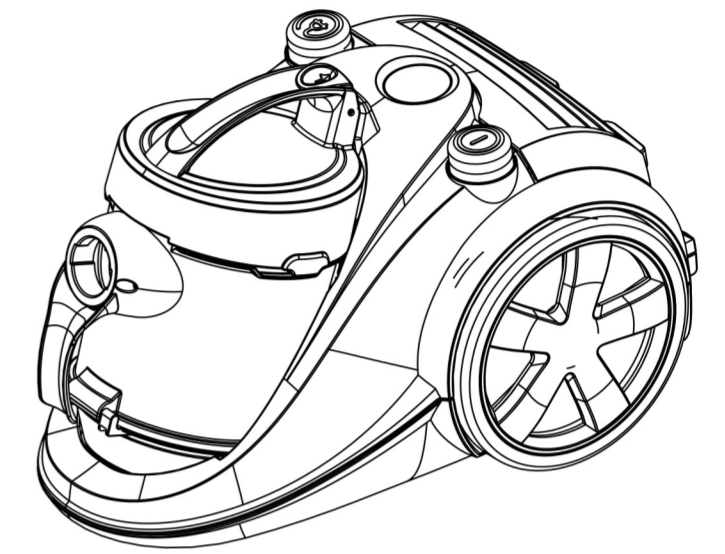

This appliance is for household use only

## OPERATION METHOD

1

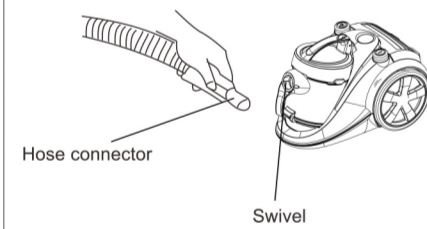

Insert the hose connector into the swivel of the Vacuum Cleaner.

2

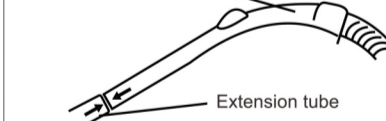

Insert the handle into the tube with a twisting force.

3

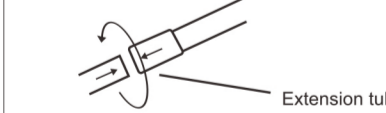

Same as above.

4

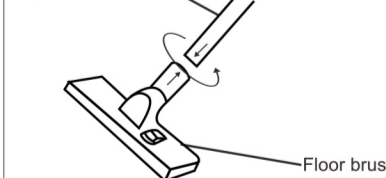

Same as above.

5

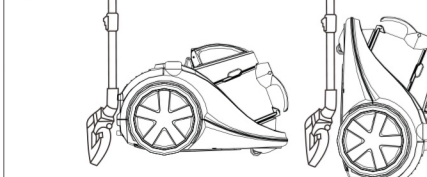

Standing position  
Put the fixing block into the hole on the body.

3

## OPERATION METHOD

1

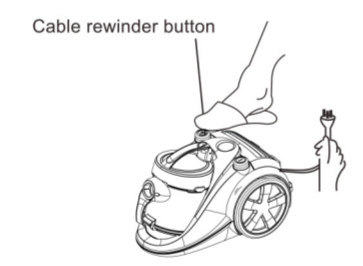

(1) Pull out the cord as long as you need, but do not exceed the mark of red and yellow.  
(2) Hold the plug when rewinding, you can press the button with your foot to retract the cable into the machine.

2

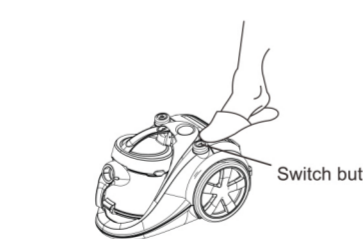

(1) Press the switch button to turn on/off the cleaner.

3

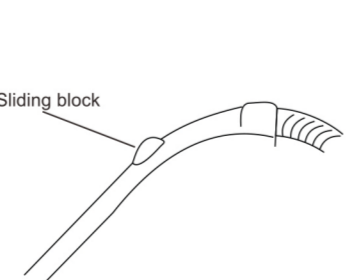

You can adjust the airflow by push the sliding block up and down.

4

**Warning:** This machine is a cyclonic design, no dust bag fitted. The LED dust indicator will light up when the dust container is full, or the filters are clogged. You can follow below MAINTENANCE instructions to resolve this problem.

## MAINTENANCE

Dust cup maintenance: Please always keep the dust cup clean before each operation. You can wash the cup in water whenever necessary.

1

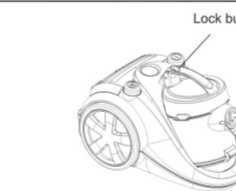

Press the locking block, then push front to open the dust compartment

2



Take up the dust compartment

3



Turn the dust compartment upside down. Press the automatic release button and open the gray cover. Twist counterclockwise to take the filter out and twist clockwise to lock.

4

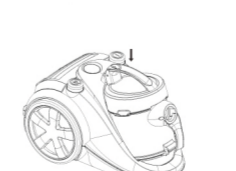

Push the dust compartment down to fix it on the body.

5

## PARTS NAME

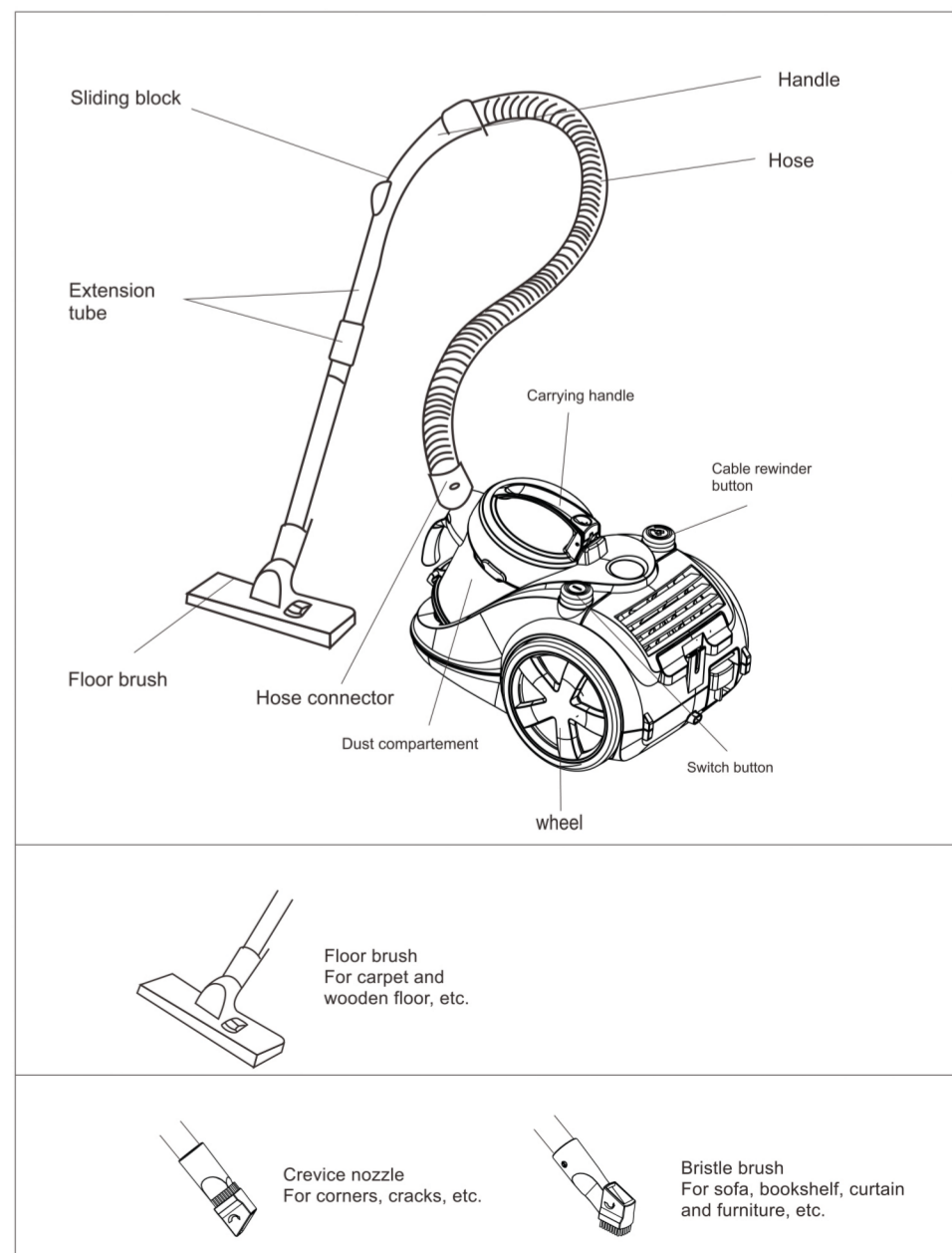

2