



Product Model Numbers Ironing Centers: IAW-42

Dimensions (Actual Size)

- Overall height: 51"
- Overall width: 14 1/2"
- Overall depth including door: 3 3/4"
- Dimension from wall to outer edge of frame (when recessed): Flush
- Penetration into opening: 3"
- Rough opening height: 51"
- Rough opening width: 14 1/2"
- Wall opening depth: 3 7/8"

Additional Information

- Unit may be surface mounted (extends into the room 3 3/4") or can be recessed (door only extends into room for a flush mount) into any wall with standard 16" center studs.
- See table bottom right to determine desired ironing board height above the floor.
- Unit can be provided with a left piano hinge door upon request. Right hinge is standard. For flush mount special hinges are required.
- Comes standard with wood veneer door.
- Recessed mounting - Recommended to attach 2" x 4" cleat to studs, level with the bottom of opening (for support.)
- Door opens approximately 180°. Allow at least 16" to the side of the unit for door to swing open.
- Options include: flat white door, no door, sleeveboard, special hinges (recess applications), and iron.

See Page 2 for additional information

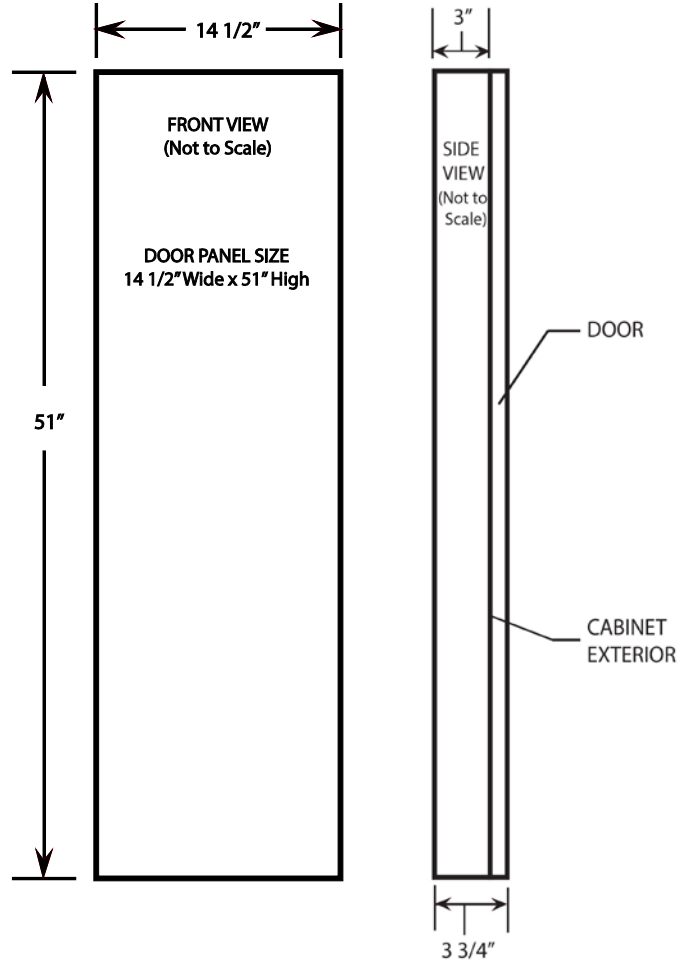

Ironing Board Height Surface Mount or Recessed	
Cut Opening Above floor	Board Height
28"	35"
27"	34"
26"	33"
25"	32"
24"	31"
23"	30"
22"	29"



Page 2
Product Model IAW-42
Additional Information

Measurements when board is lowered
(Not to Scale)

Unit can be provided with a left hinged door upon request. Right hinge is standard. Door opens approximately 180°. Allow at least 16" from side of cabinet. Special hinges required for recessed mounting.

Surface Mount

Recessed Mount

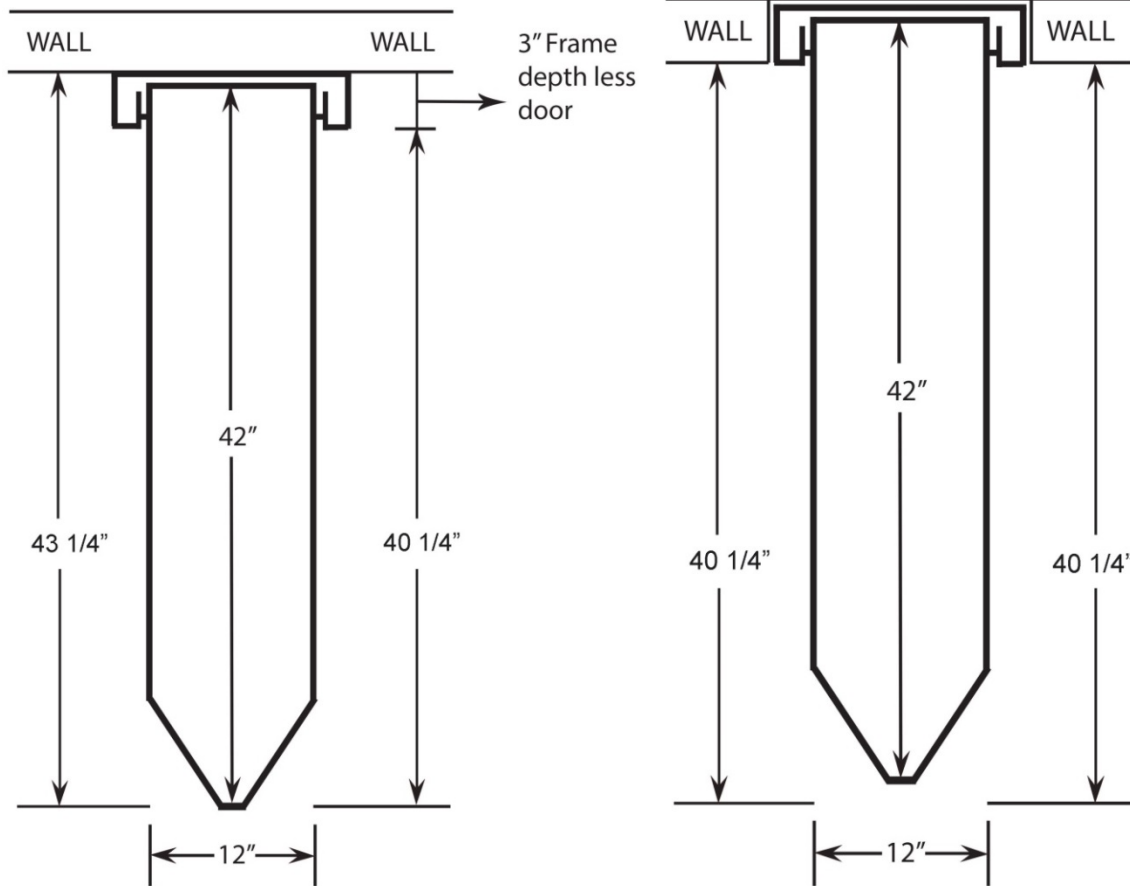

Recommended Adequate Space/Clearance for Ironing

Distance from Wall to tip of Ironing Board (Surface Mount)	43 1/4"
(Recessed Mount)	40 1/4"
Swivel Clearance from cutout opening of cabinet	N/A
Distance from Wall in Full Swivel Position	N/A
Standing Area Clearance **	24"

** The recommended distance from the side of the ironing board where the user will typically stand to ensure adequate space for ironing.