

ASSEMBLY & INSTALLATION INSTRUCTIONS

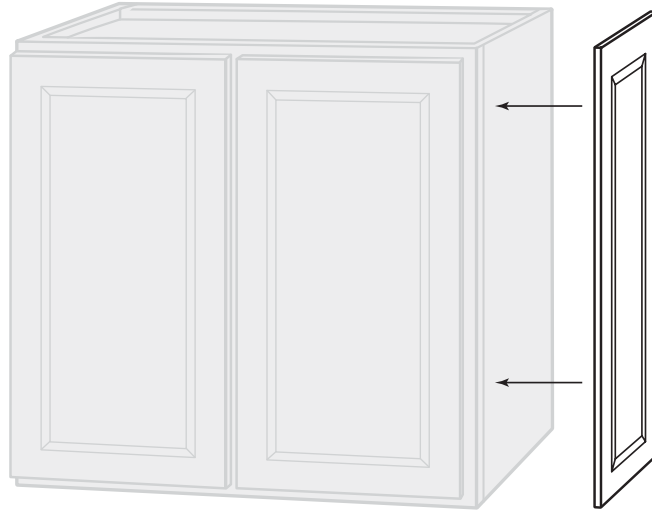

Model Number(s):

KAEP1230
1530
1830
1236
1242
2430

1 **ALIGN PANEL** — Panel should align at the top and bottom with the door on the front of the cabinet. Panel can be secured temporarily with a clamps.

2 **SECURE TO CABINET** — Pre-drill through the cabinet into the back of the door. If the door has a wood frame (Hampton, Shaker), take care to drill into the door frame and not the center panel. Use #8 x 3/4" screws to secure the door to the cabinet side.

If a flush-fit panel has been installed to the cabinet previously, 1" screws will be required.

