

Item #469-BLK

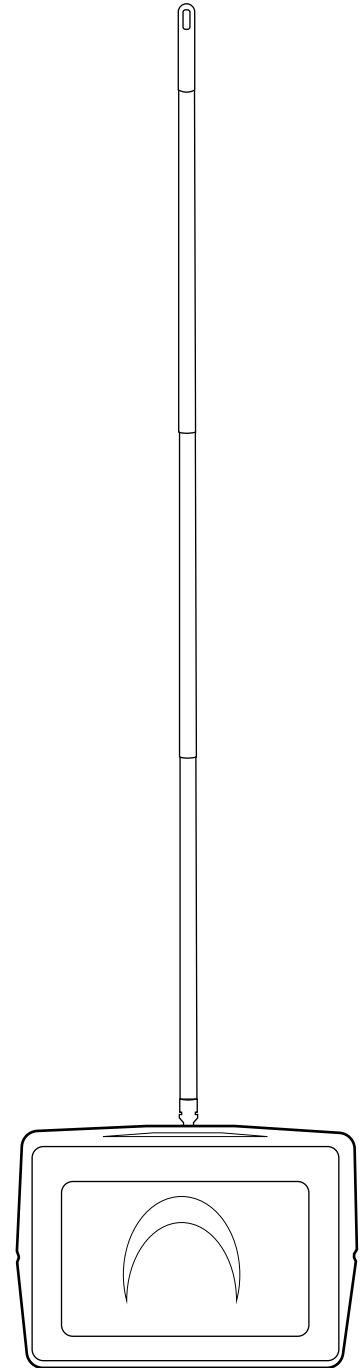

# TRIPLE BRUSH FLOOR AND CARPET SWEEPER

**INSTRUCTION MANUAL**

1. Three parts of items B and One part item C screw with a simple twisting motion into each other to form the handle of the carpet sweeper.
2. Securely screw the bottom portion of item B into item A.
3. Item D (cleaning brush for bristles) snaps onto the front of the handle at the bottom above the sweeper.
4. To empty – 1. Turn over sweeper and push down on refuse compartment towards the center using the indents provided to open (see image 1 and 2).  
2. After emptying both compartments use the attached brush to clean any remaining refuse from middle and side sweeper bristles (see image 3).

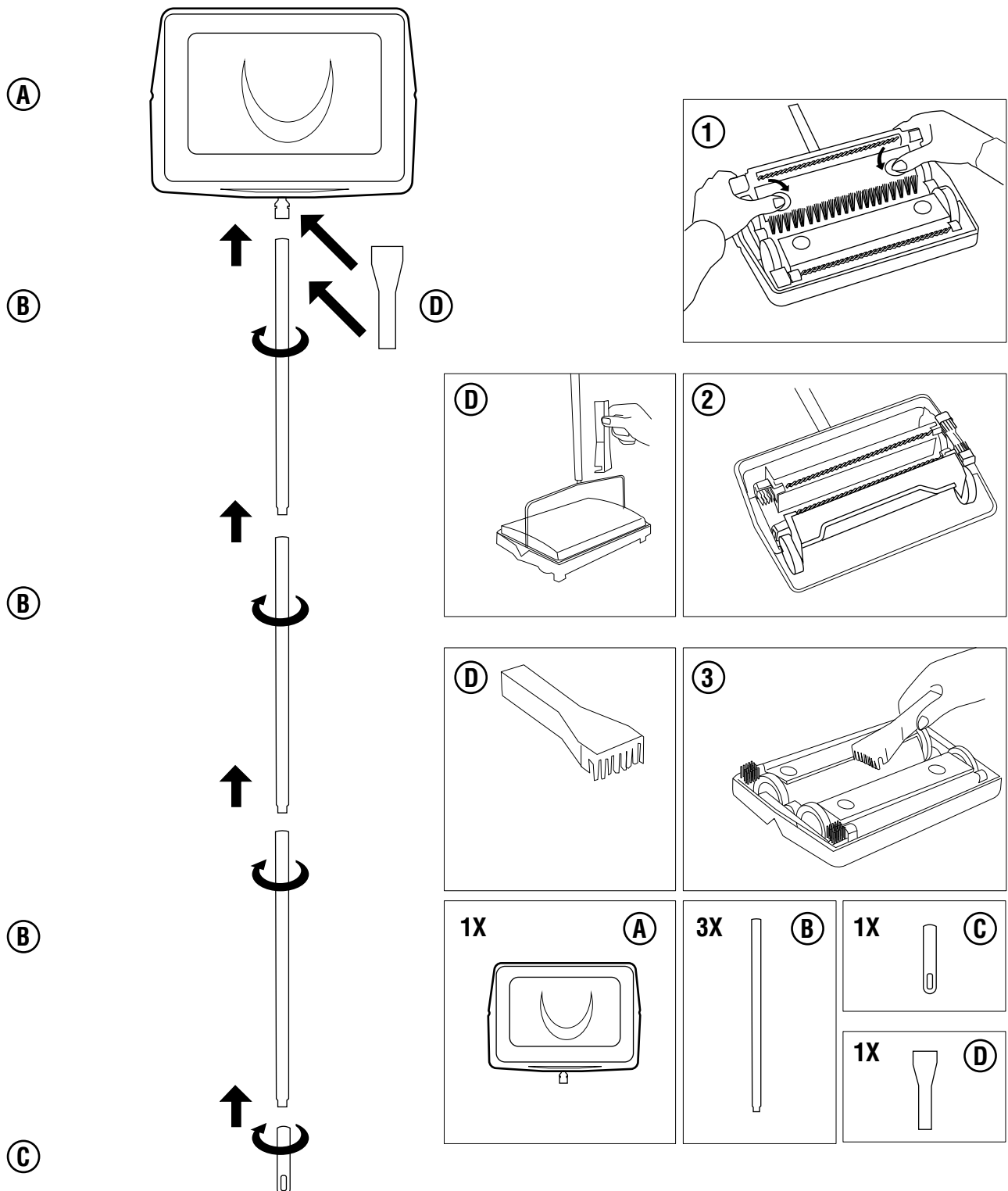



follow us on

