

# Owner's Manual & Safety Instructions

Save This Manual Keep this manual for the safety warnings and precautions, assembly, operating, inspection, maintenance and cleaning procedures.

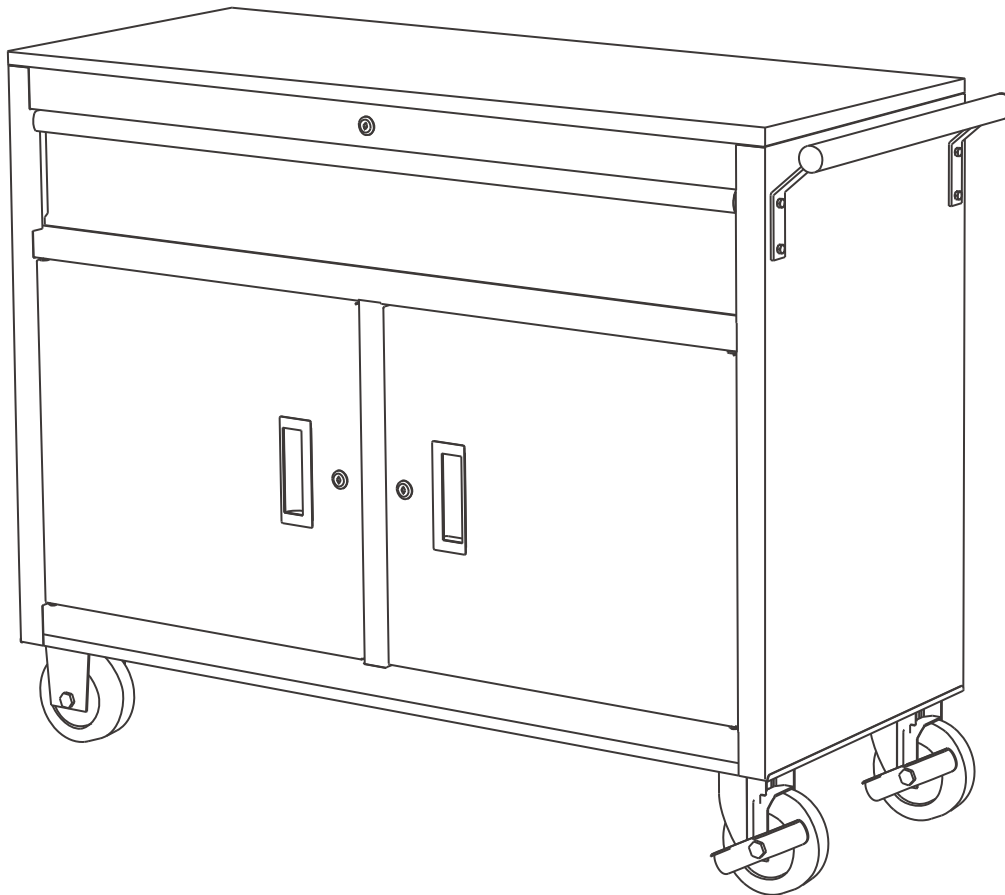

## 46" MOBILE WORKBENCH WITH SOLID WOOD TOP



When unpacking, make sure that the product is intact and undamaged. If any parts are missing or broken, please send a Email to [customerservice@xindadi.com](mailto:customerservice@xindadi.com).

### **▲WARNING**

Read this material before using this product. Failure to do so can result in serious injury. **SAVE THIS MANUAL.**



# PEGBOARD

XTB4602BP

# MANUAL

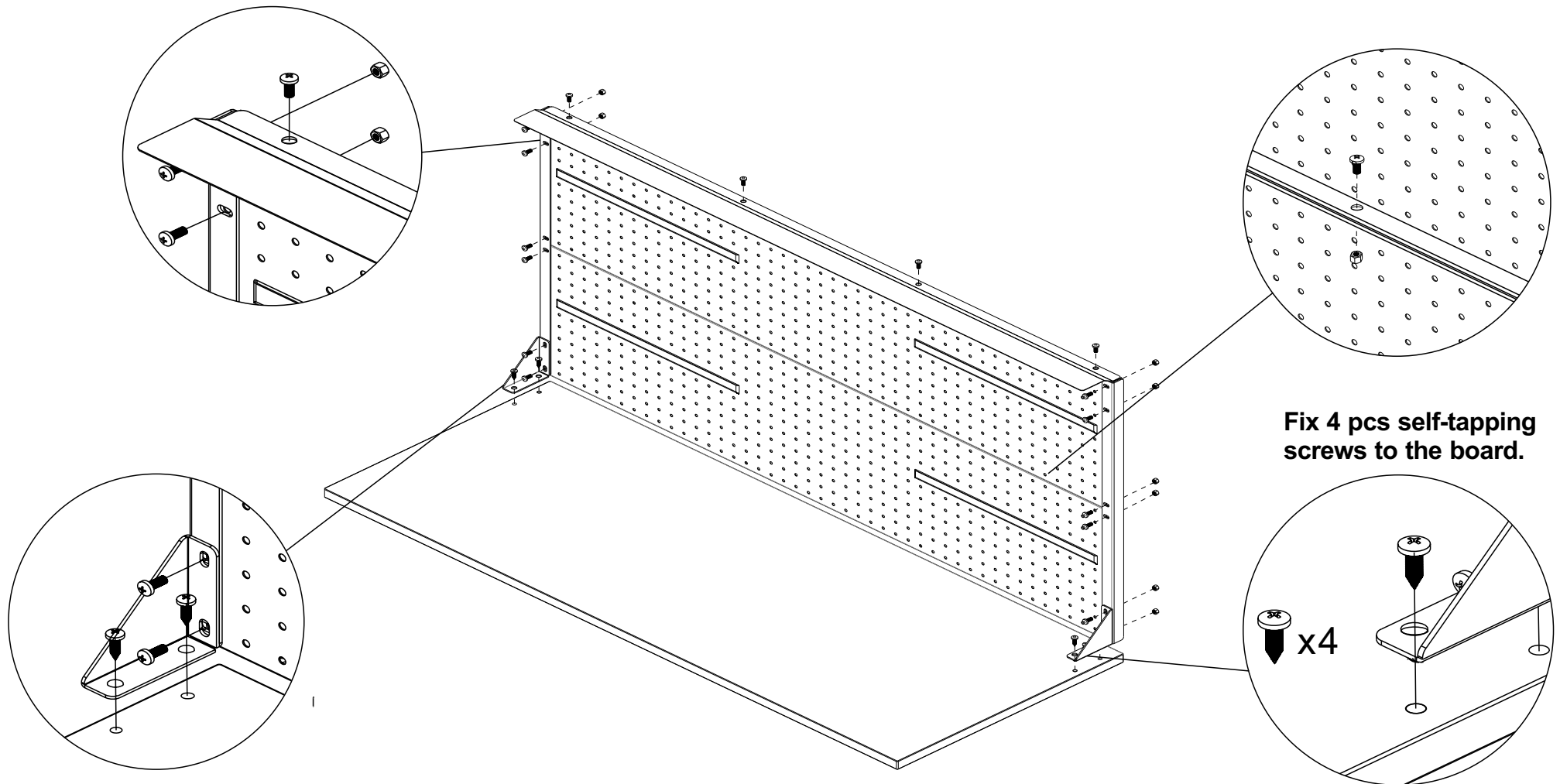

# IMPORTANT SAFETY INFORMATION

## Assembly Precautions

---

1. Assemble only according to these instructions. Improper assembly can create hazards.
2. Wear ANSI-approved safety goggles and heavy-duty work gloves during assembly.
3. Keep assembly area clean and well lit.
4. Keep bystanders out of the area during assembly.
5. Do not assemble when tired or when under the influence of alcohol, drugs or medication.
6. Weight capacity and other product capabilities apply to properly and completely assembled product only.
7. Assemble on a flat, level, hard and smooth surface capable of safely supporting loaded Workbench.

## Use Precautions

---

### TO PREVENT SERIOUS INJURY AND DEATH FROM TIPPING:

1. LOAD FROM BOTTOM UP ONLY.
2. DO NOT SIT, STAND OR CLIMB ON THIS ITEM.
3. This product is not a toy nor a toy chest. Do not allow children to play with or near this item.
4. Do not use for food preparation.
5. Do not exceed 1200 lb weight capacity, evenly distributed from bottom up. Uneven loading causes tipping. Be aware of dynamic loading! Sudden load movement may briefly create excess load causing product failure.
6. Empty, close, and lock Drawer before moving.
7. Use only on a flat, level, hard and smooth surface capable of safely supporting a fully loaded Workbench. Do not roll Workbench over concrete seams or other rough/uneven surfaces.
8. Do not lift using handle(s). Do not move or lift while loaded.
9. Lock Swivel Casters after moving.
10. Do not mount on truck bed or any other moving object.
11. Use as intended only.
12. Inspect before every use; do not use if parts are loose or damaged.
13. Maintain product labels and nameplates. These carry important safety information. If unreadable or missing, contact to Email [customerservice@xindadi.com](mailto:customerservice@xindadi.com).

# Assembly Instructions



Read the ENTIRE IMPORTANT SAFETY INFORMATION section at the beginning of this document including all text under subheadings therein before set up or use of this product.

1. Assemble on a flat, level, hard and smooth surface capable of safely supporting a fully loaded Workbench.
2. Attach Handle (3) to either side of Workbench using four Handle Bolts (4).

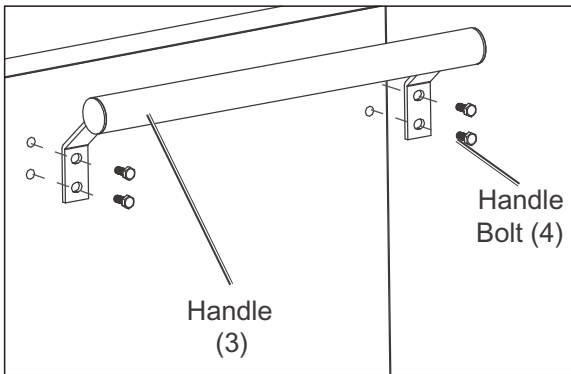

3. Attach two Swivel Casters (6) to the same end as Handle using eight Caster Bolts (10) from the inside of the cabinet down, secured with eight Flat Washers (8), eight Spring Washers (9), and eight Caster Nuts (7).
4. Attach two Fixed Casters (5) to the opposite end from Handle using eight Caster Bolts (10) from the inside of the cabinet down, secured with eight Flat Washers (8), eight Spring Washers (9), and eight Caster Nuts (7).
5. Lock the Swivel Casters by depressing the brake levers.

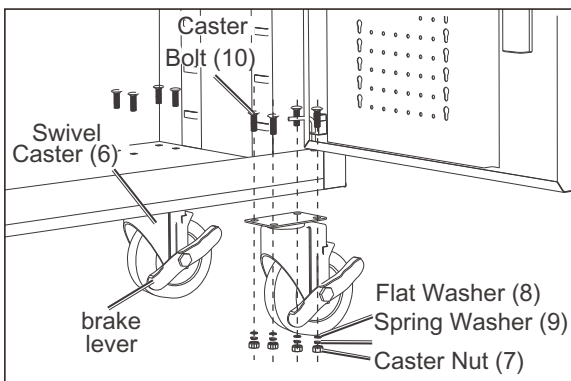

6. Install the four tabs on each Left Shelf (12) into the racks on the left side and center of the Cabinet to install them at the desired heights.
7. Install the four tabs on each Right Shelf (13) into the racks on the right side and center of the Cabinet to install them at the desired heights.

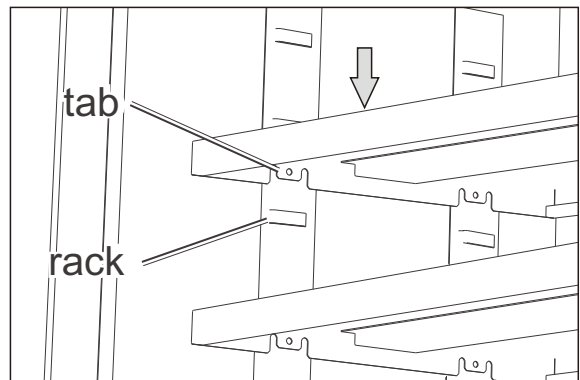

8. Put 3 long inserting pieces(14/A) to the drawer then fix 4 smaller inserting pieces(15/B) to correct position as picture showing

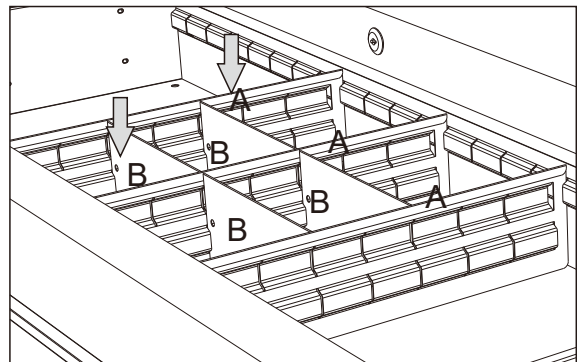

## Operation Instructions



Read the ENTIRE IMPORTANT SAFETY INFORMATION section at the beginning of this document including all text under subheadings therein before set up or use of this product.

1. Empty Drawer.
2. Close Drawer and lock it.
3. Unlock Swivel Casters.
4. Roll Workbench to a flat, level, hard and smooth surface capable of safely supporting a fully loaded Workbench. Do not roll Workbench over concrete seams or other rough/uneven surfaces.
5. Lock Swivel Casters.
6. Unlock Drawer and fill Workbench evenly, from bottom to top. Do not exceed weight capacities.

## Maintenance and Servicing



Procedures not specifically explained in this manual must be performed only by a qualified technician.

### **!WARNING**

TO PREVENT SERIOUS INJURY FROM TOOL FAILURE:

Do not use damaged equipment. If any part becomes damaged, have the problem corrected before further use.

1. PERIODICALLY, inspect the general condition of the Workbench. Check for:
  - loose hardware,
  - misalignment or binding of moving parts,
  - brake operation,
  - caster swivel function and movement,
  - cracked or broken parts,
  - any other condition that may affect its safe operation.
2. Wipe external surfaces of the Workbench with clean cloth.
3. Lubricate Drawer Slides as needed.

Parts List

Part	Description	Qty
1	Wood Top	1
2	Cabinet	1
3	Handle	1
4	Handle Bolt	4
5	Fixed Caster	2
6	Swivel Caster	2
7	Caster Nut	16

Part	Description	Qty
8	Flat Washer	16
9	Spring Washer	16
10	Caster Bolt	16
11	Drawer	1
12	Left Shelf	1
13	Right Shelf	1
14	Long Inserting Pieces	3
15	Smaller Inserting Pieces	4

Assembly Diagram

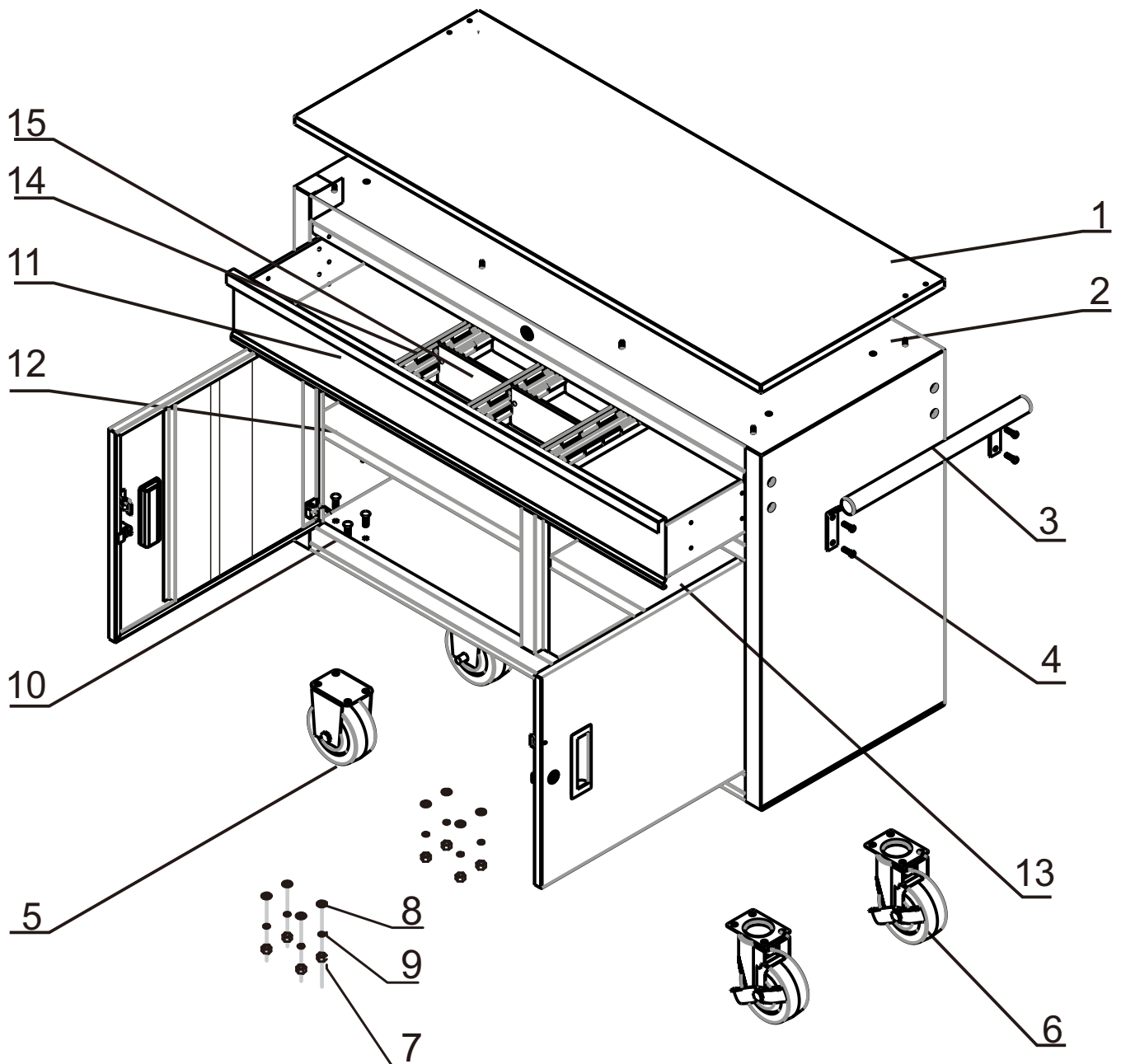

Note: Some parts are listed and shown for illustration purposes only, and are not available individually as replacement parts.