

ASSEMBLY INSTRUCTIONS

**⚠ READ ALL SAFETY WARNINGS & ASSEMBLY INSTRUCTIONS CAREFULLY
BEFORE ASSEMBLING OR OPERATING YOUR GRILL.**

FOR MISSING PARTS, PLEASE CALL CUSTOMER SERVICE AT 800-527-0717.

Inspect contents of the box to ensure all parts are included and undamaged.

We recommend two people work together when assembling this unit.

The following tools are required to assemble this Smoke'N Pit:

- Pliers
- Phillips & Flathead Screwdrivers
- Adjustable Wrench

PARTS LIST - Smoke'N Pit:

- | | | | |
|---|------------------------------|----|--------------------------|
| ① | 2 Handle Coils | ②⑧ | 1 Firebox Door Latch |
| ② | 2 Handle Axles | ②⑨ | 1 Firebox Door Hinge |
| ③ | 4 Handle Stands | ③⑩ | 1 Firebox Charcoal Grate |
| ④ | 1 Temperature Gauge Seat | ③① | 2 Firebox Cooking Grills |
| ⑤ | 1 Temperature Gauge | ③② | 1 Side Handle |
| ⑥ | 1 Smokestack Damper | ③③ | 1 Firebox Lid |
| ⑦ | 1 Smokestack Damper Assembly | ③④ | 1 Firebox Lid Stop |
| ⑧ | 1 Grill Lid | | |
| ⑨ | 1 Warming Rack | | |
| ⑩ | 3 Cooking Grills | | |
| ⑪ | 2 Charcoal Grate Adjusters | | |
| ⑫ | 1 Charcoal Grate | | |
| ⑬ | 1 Charcoal Tray | | |
| ⑭ | 1 Grill Base | | |
| ⑮ | 1 Front Shelf | | |
| ⑯ | 2 Front Table Supports | | |
| ⑰ | 2 Right Legs | | |
| ⑱ | 2 Leg Braces | | |
| ⑲ | 1 Grease Cup Holder | | |
| ⑳ | 2 Wheels | | |
| ㉑ | 1 Axle | | |
| ㉒ | 1 Shelf | | |
| ㉓ | 2 Left Legs | | |
| ㉔ | 1 Firebox Support | | |
| ㉕ | 1 Firebox Base | | |
| ㉖ | 1 Firebox Air Shutter | | |
| ㉗ | 1 Firebox Door | | |

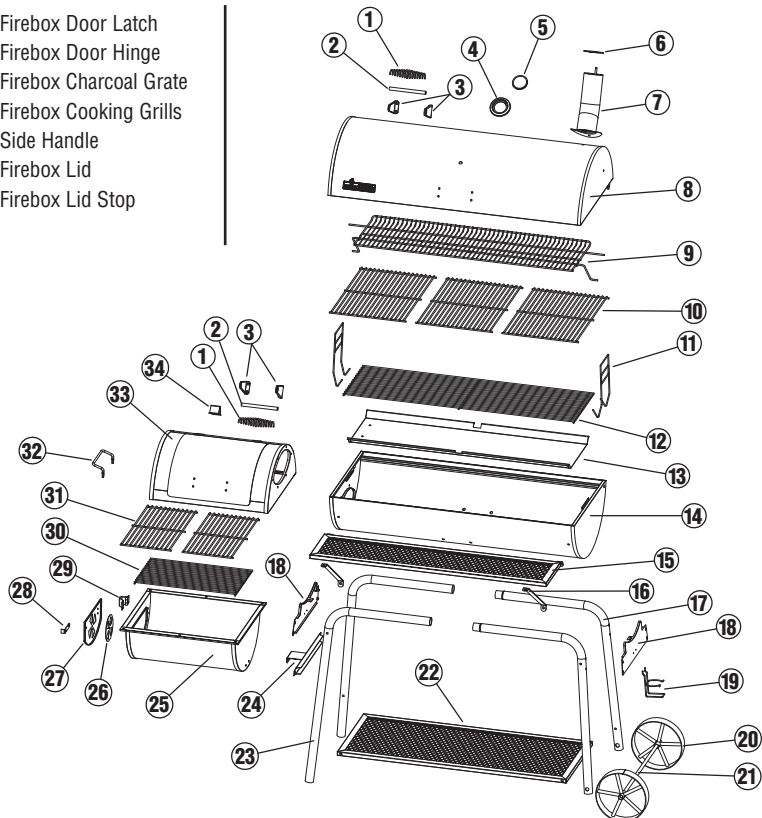

CALIFORNIA PROPOSITION 65 WARNING

This product contains chemicals, including lead in the brass of certain component parts, that are known to the State of California to cause cancer, and birth defects or other reproductive harm.

Wash hands after handling. When used, this product emits fuel combustion chemicals that are known to the State of California to cause cancer, and birth defects or other reproductive harm.

Follow all instructions in this manual and use only in well ventilated, outdoor area.

Parts Bag Contents

3	M6 X 25 mm Phillips Head Shoulder Bolts	4	Cotter Pins
4	M6 X 12 mm Phillips Head Bolts	1	M6 X Cap Nut
58	M5 X 12 mm Phillips Head Bolts	1	M6 Spring
1	M5 X 10 mm Phillips Head Shoulder Bolt	2	M10 Flat Washers
25	M5 Hexagonal Nuts	2	M10 Hexagonal Nuts

M6 X 25 mm Phillips Head Shoulder Bolts

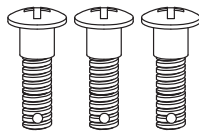

M6 X 12 mm Phillips Head Bolts

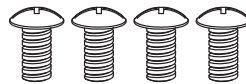

M5 Hexagonal Nuts

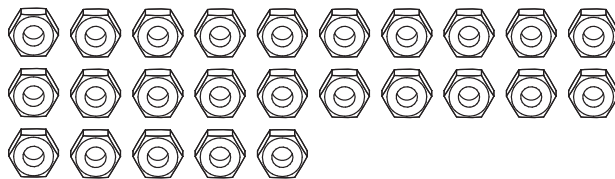

M5 X 12 mm Phillips Head Bolts

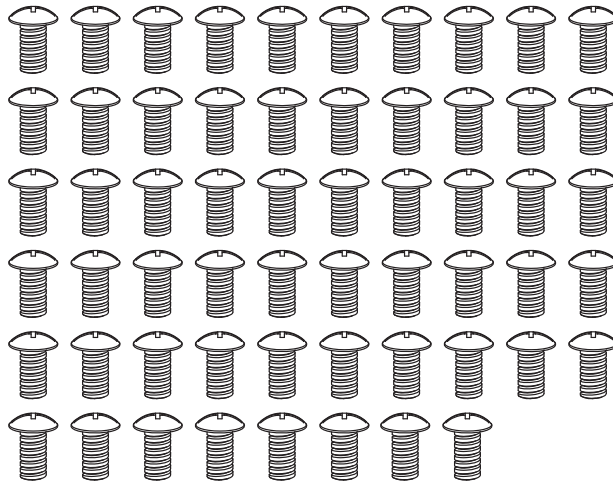

M10 Flat Washers

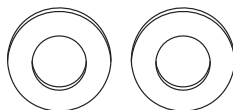

M10 Hexagonal Nuts

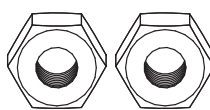

Cotter Pins

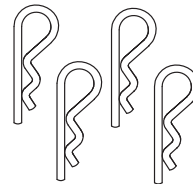

M5 X 10 mm Phillips Head Shoulder Bolt



M6 Cap Nut



M6 Spring



Choose a good, cleared assembly area and get a friend to help you put your grill together. Lay cardboard down to protect grill finish and assembly area. Turn the grill on its side to begin assembly.

Step 1

Connect right and left legs together (2 pairs). Front pair legs will have two extra holes for front shelf supports as illustrated.

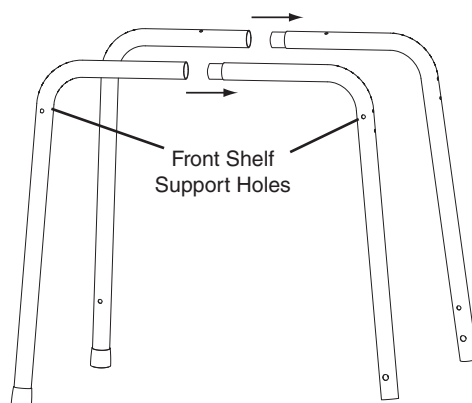

Step 2

Install leg braces with support flange towards center of grill onto the legs using eight M5 x 12 mm Phillips head bolts. Do not tighten until Step 5 is completed. Next, install firebox support bracket onto the holes on the left legs using two M5 x 12 mm Phillips head bolts. Do not tighten until Step 5 is completed.

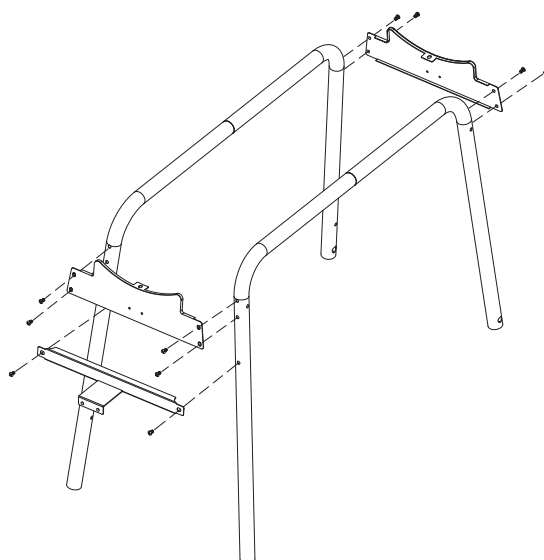

Step 3

Attach the shelf to the legs using four M5 x 12 mm Phillips head bolts as illustrated.

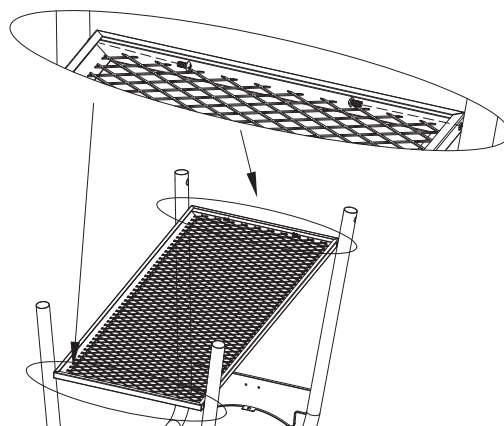

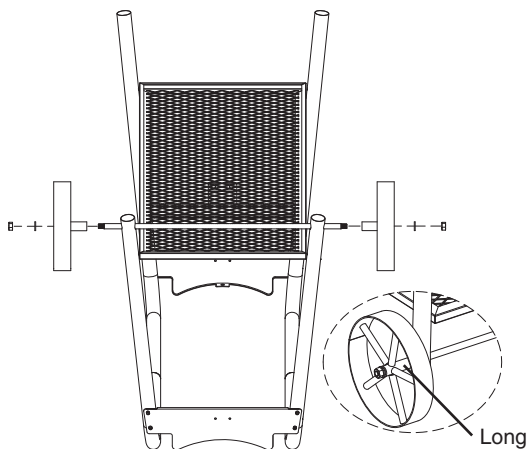

Step 4

Put axle through the holes on the right legs and install the wheels using two M10 flat washers and two M10 nuts as illustrated.

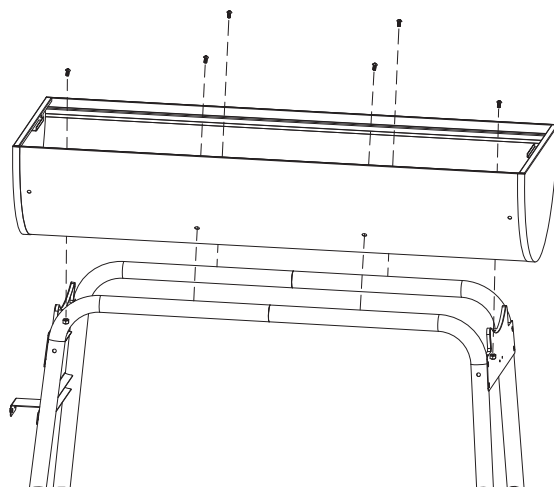

Step 5

Install grill base with firebox opening towards left side on top of the legs using four M5 x 12 mm Phillips head bolts.

Install two M5 x 12 mm Phillips head bolts and M5 nuts thru grill base and leg braces.

NOTE: Now tighten all screws in Steps 1 thru Step 5.

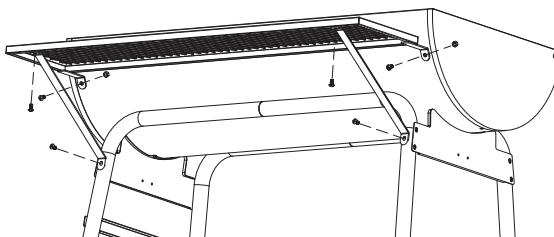

Step 6

Attach front shelf to front of grill base using two M5 x 12 mm Phillips head bolts and M5 nuts. Attach table supports with slotted holes towards front shelf using four M5 x 12 mm Phillips head bolts.

Step 7

Attach side handle onto firebox lid using two M5 x 12 mm Phillips head bolts and two M5 nuts.

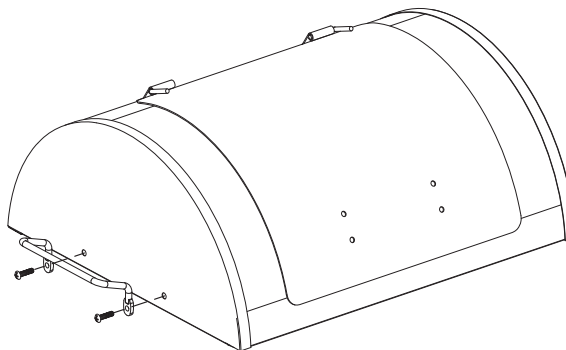

Step 8

Install the handle coil, handle axle and handle stands using two M6 x 12 mm Phillips head bolts. Secure the handle assembly to firebox lid using four M5 x 12 mm Phillips head bolts and four M5 nuts as illustrated.

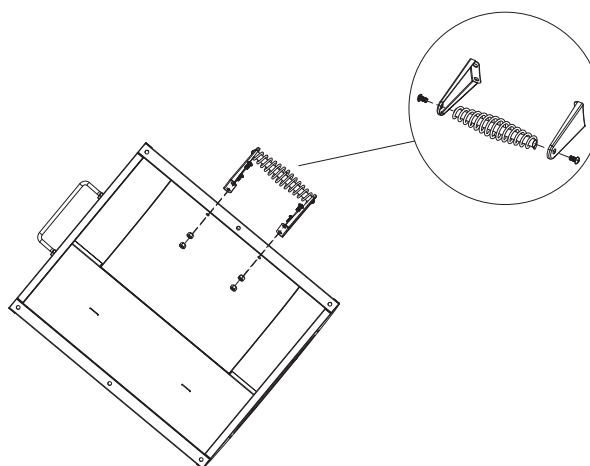

Step 9

Attach firebox lid stop using one M5 x 12 mm Phillips head bolt and M5 nut.

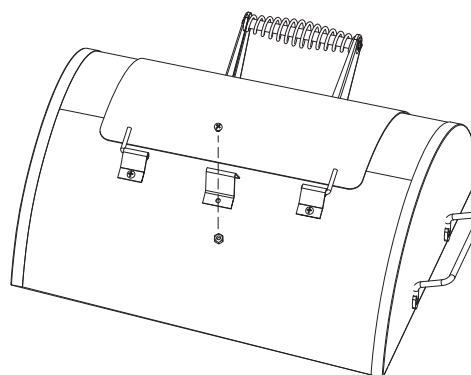

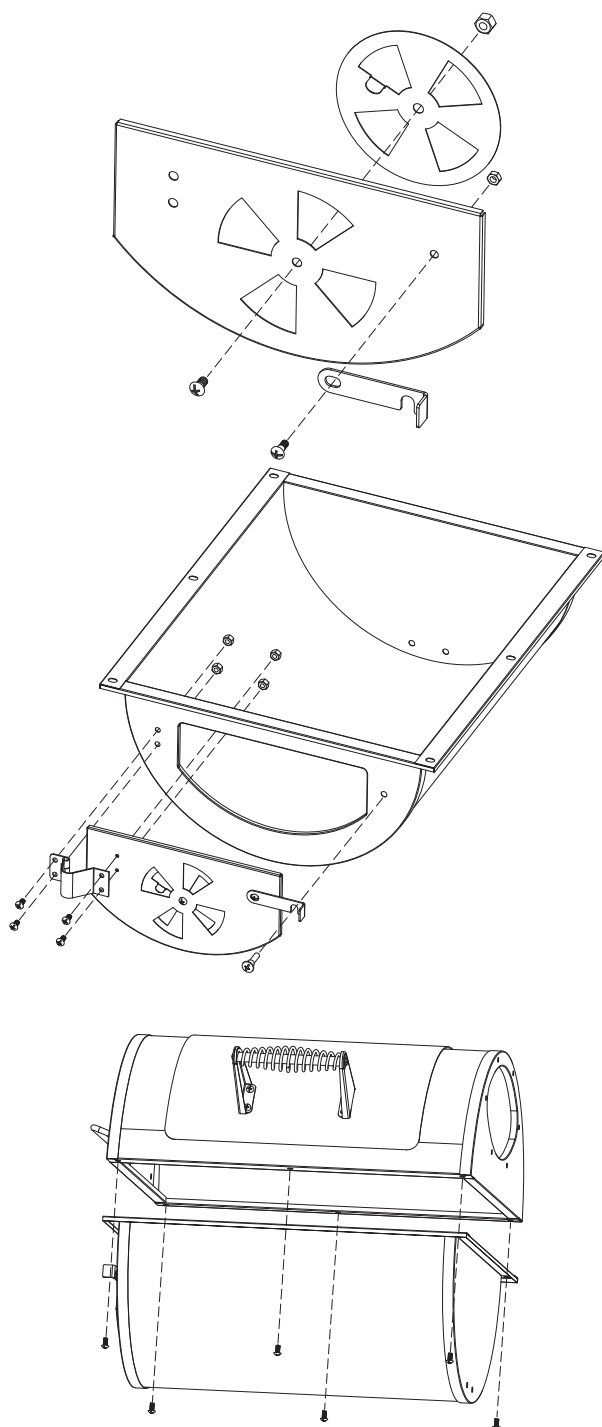

Step 10

Attach air shutter onto firebox door using one M5 x 12 mm Phillips head bolt and M5 nut. Do not over tighten air shutter, air shutter should move freely.

Attach door latch using one M5 x 10 mm Phillips head shoulder bolt and M5 nut as illustrated.

Step 11

Connect firebox door hinge to the outside of door and firebox base using four M5 x 12 mm Phillips head bolts and M5 nuts.

Attach one M6 x 25 mm Phillips head shoulder bolt onto firebox base for door latch.

Step 12

Connect firebox lid and firebox base using six M5 x 12 mm Phillips head bolts.

Step 13

Connect firebox and grill base together using six M5 x 12 mm bolts.

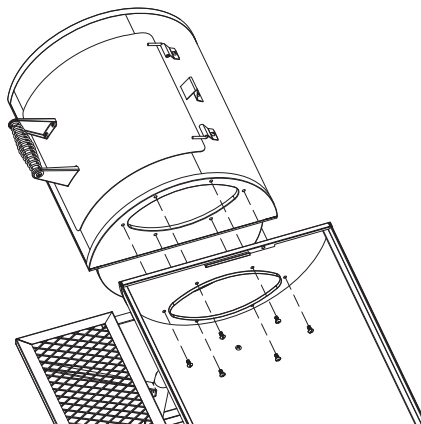
**Step 14**

Connect firebox support with firebox base using two M5 x 12 mm Phillips head bolts and M5 nuts.

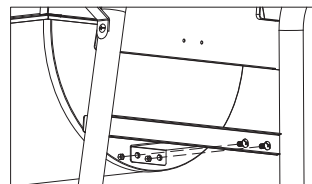
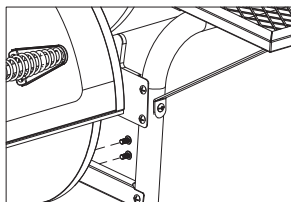
**Step 15**

Install smokestack assembly into grill lid using two M5 x 12 mm bolts and M5 nuts.

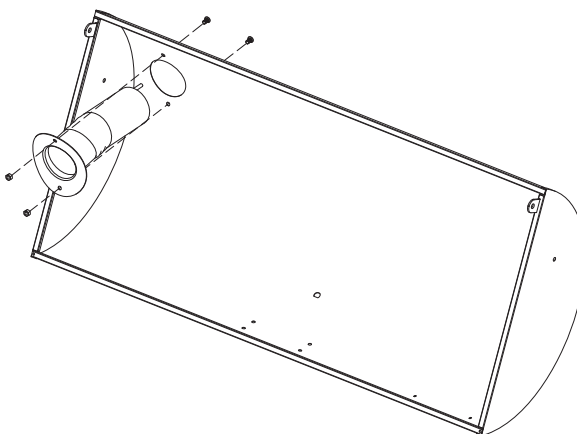

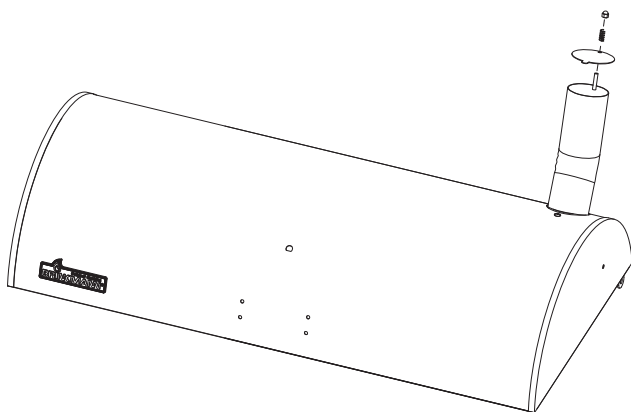

Step 16

Install smokestack damper and spring onto smokestack assembly. Secure smokestack damper and spring using one M6 cap nut.

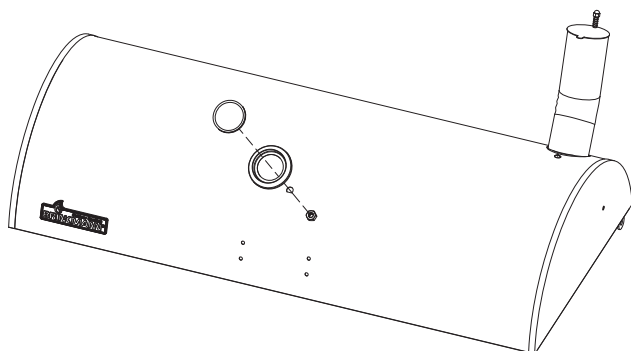

Step 17

Install the temperature gauge and temperature thermometer bezel as illustrated.

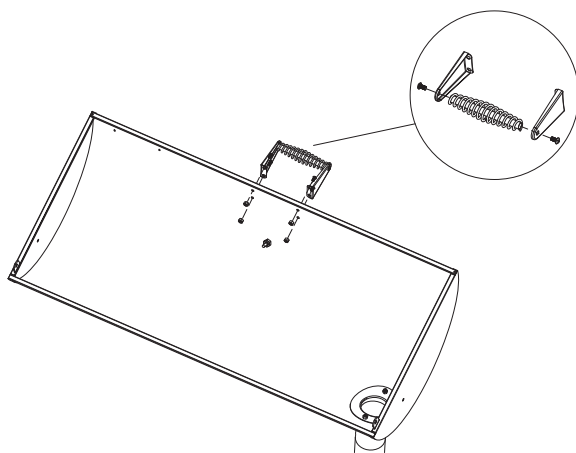

Step 18

Install the handle coil, handle axle and handle stands using two M6 × 12 mm Phillips head bolts. Secure the handle assembly to lid using four M5 × 12 mm Phillips head bolts and four M5 nuts as illustrated.

Step 19

Install grill lid on grill base using two M6 x 25 mm shoulder bolts and two cotter pins.

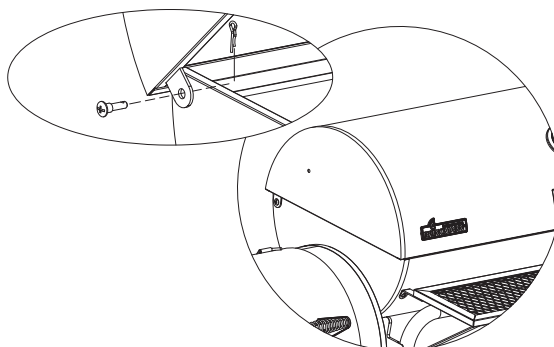

Step 20

Attach the charcoal tray to charcoal grate by hooking tray edges onto grate frame.

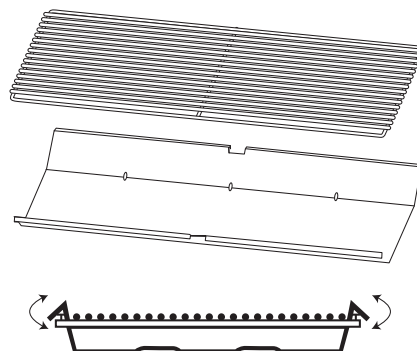

Step 21

Use charcoal grate adjusters to lower charcoal grate assembly into grill base. Rest charcoal grate adjusters on supports in grill base.

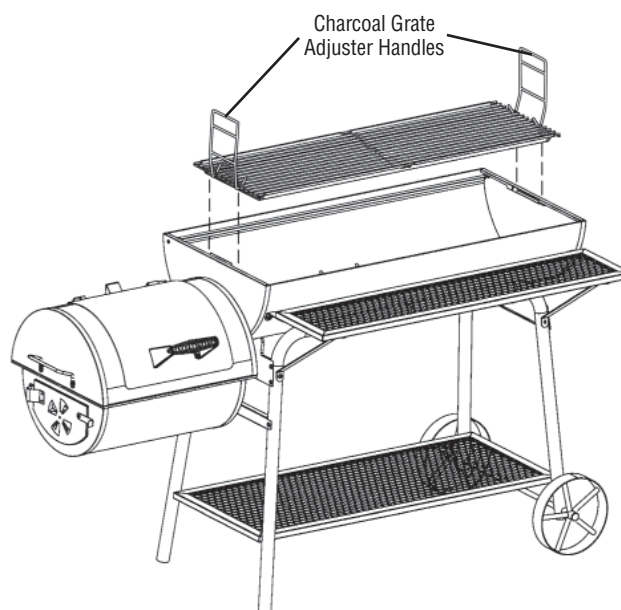

⚠ WARNING: Never hang charcoal grate from charcoal grate adjuster handles.

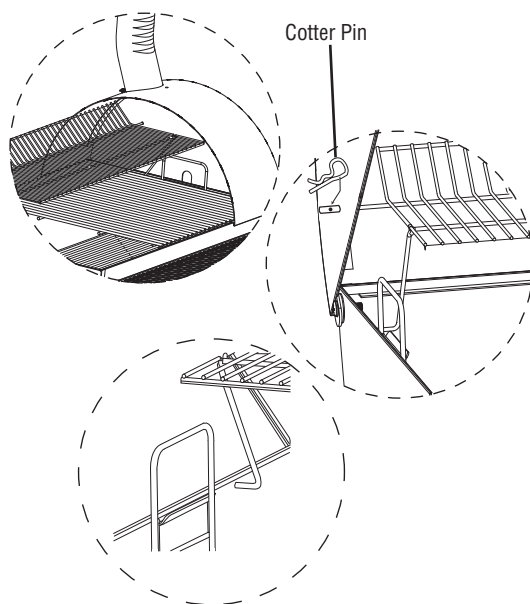

Step 22

Install the warming rack inside the grill lid. Insert the rack pin through the holes from the outside of grill lid and install two cotter pins.

Align the warming rack support arm holes with the holes on the side panel of grill base.

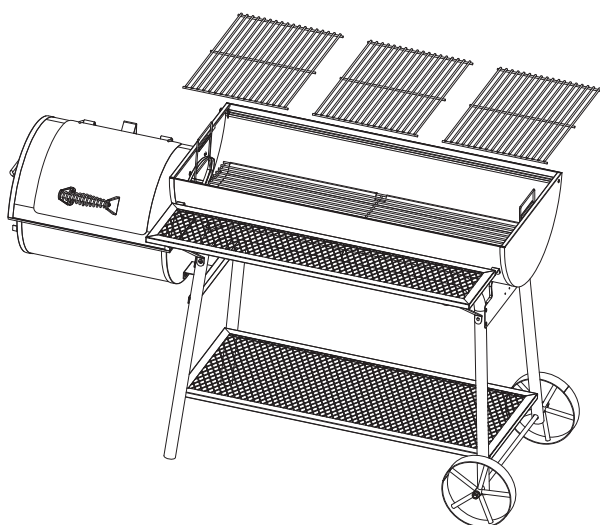

Step 23

Place cooking grills on support lips of grill base.

Step 24

Place firebox charcoal grate inside the bottom of firebox.

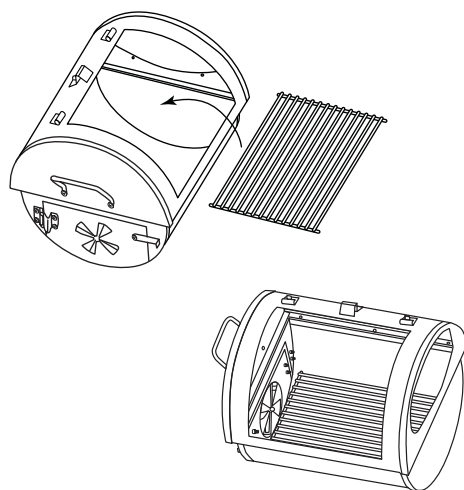
**Step 25**

Place firebox cooking grills inside the top of firebox base.

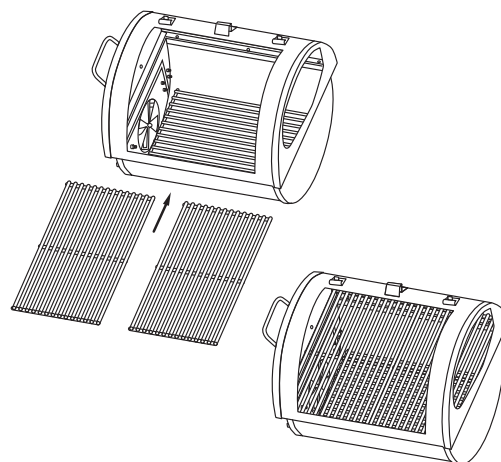
**Step 26**

Insert grease cup holder into holes on right leg brace.

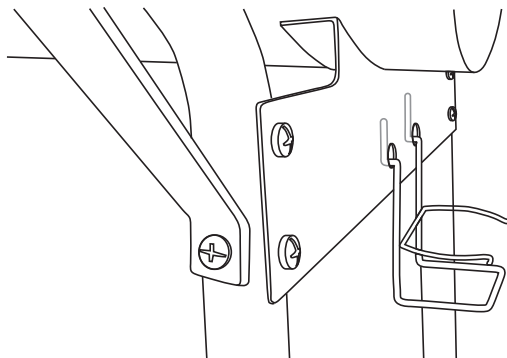

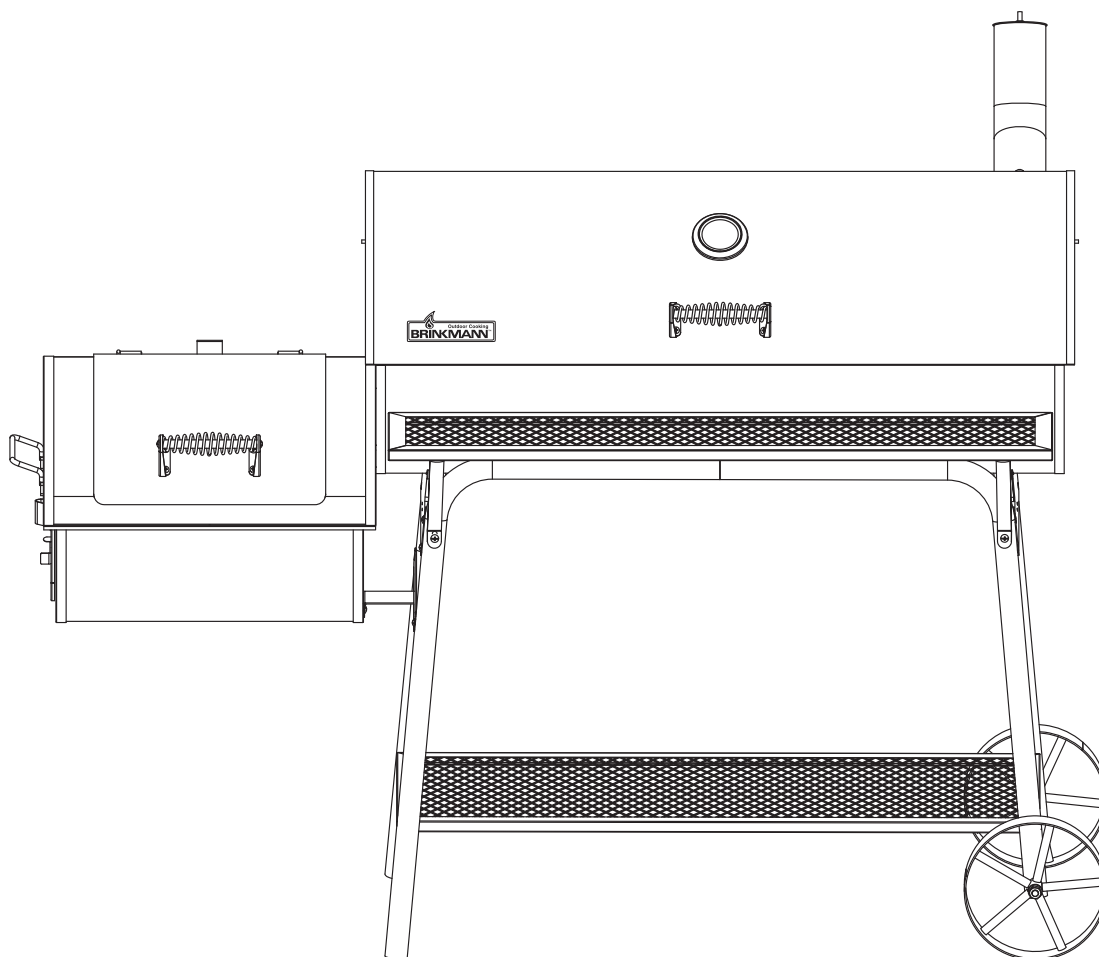

Smoke'N Pit
(Assembled)