



Aero-ALERT™ Alarm Kit

P/N: 102486

Function:

The Aero-ALERT™ alarm kit is designed to produce an audible signal when the Aero-Stream® product has an air output of less than 1 PSI. In the event of an alarm signal see the troubleshooting section below.

Service and Maintenance

The alarm is designed to produce the audible signal for at least 60 days on the self contained battery. The battery should be replaced annually. It is suggested that they be replaced at the same time as your fire detection smoke alarm in your home.

Directions

1. Install the airline/tee fitting in the output air line of the Aero-Stream® unit. Clamp the air line with plastic clamp (figure 2).
2. If you are using an air line extension kit attached the adapter assembly as shown in (figure 4)
3. Connect the 1/8" air line from the tee to the pressure switch barbed fitting on the side of the Aero-ALERT™ (figure 3).
4. Remove the (4) cover screws and the cover. Attach the battery connector and replace cover and screws. The drain holes must be located on the same side as the buzzer hole. **Hint:** The alarm will sound-off if the compressor is not running. To temporarily mute the alarm, place a piece of tape over the 1/4" buzzer hole.
5. Clean the enclosure surface with water and then wipe surface with rubbing alcohol. Remove the protective film from the Velcro pads. With the hose spigot on the side and buzzer hole facing down, firmly press the alarm to the surface (figure 4).



Figure 1



Figure 2

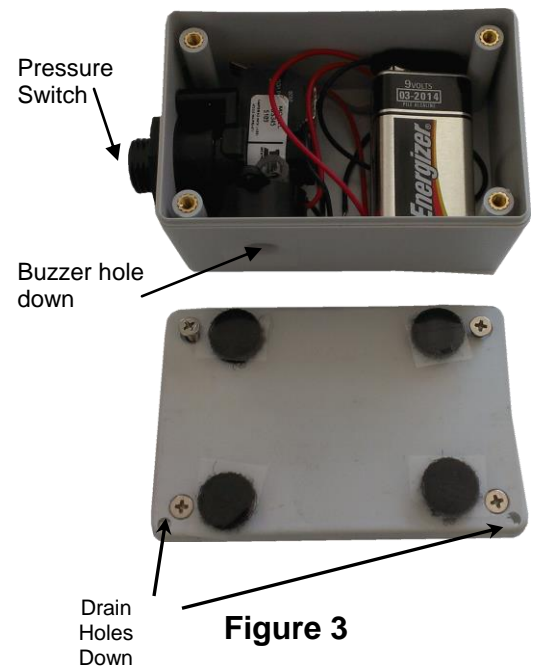

Figure 3

Troubleshooting

The alarm will sound-off from the air switch indicating low or no air pressure output. Follow the steps below to determine the cause of the alarm.

1. Make sure the large air line connections are not leaking. If not leaking go to step 2 (figure 2).
2. Make sure the small air line is tightly connected to the black "tee" and the fitting on the pressure switch of the alarm box. If the connections are tight, pinch the large air line after the black "tee" (on the tank side of the tee) to deadhead the pump. The sound output of the pump will change. If the alarm goes off the air switch is o.k. If the alarm does not go out call Aero-Stream®.

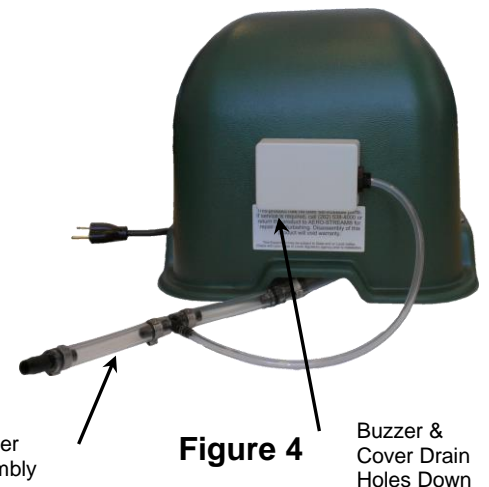

Figure 4