

White Shorewood Unassembled 1-Door 2-Drawer Vanity with Solid White Cultured Marble Vanity Top, 25"

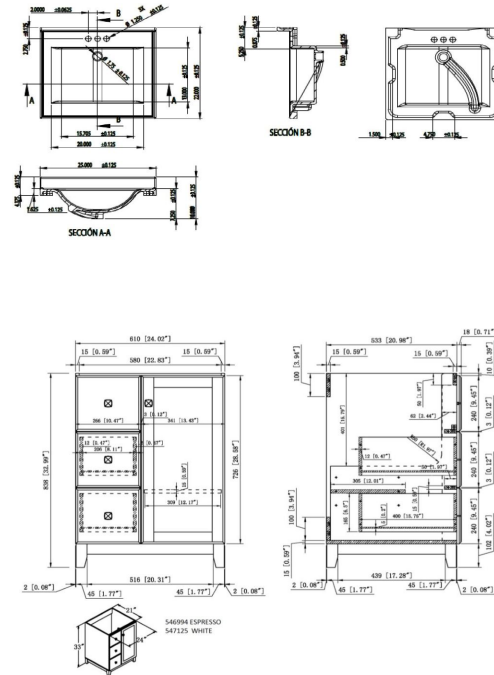

SPECIFICATIONS

MATERIAL CONSTRUCTION:	Wood/Cultured Marble	TOE KICK INSET WIDTH:	N/A
ASSEMBLY REQUIRED:	Yes	BACK PANEL MATERIAL:	N/A
ASSEMBLED DIMENSIONS:	37.5" H x 25" L x 22" D	BACK BRACE MATERIAL:	Particle Board
ASSEMBLED WEIGHT:	103.3 lbs.	FAUCET TYPE:	N/A
TOOLS NEEDED FOR INSTALLATION:	Screwdriver	NUMBER OF MOUNTING HOLES:	3
CONSTRUCTION TYPE:	Frameless	BOWL MATERIAL:	Cultured Marble
HINGE STYLE:	Soft Close	BACK SPLASH INCLUDED:	Yes
DOOR STYLE:	1 Pine+MDF Shaker Doors	COLOR:	Solid White
DRAWER STYLE:	2 MDF Drawers	NUMBER OF BOWLS:	1
GLIDE STYLE:	STD Easy Glide	BOWL DIMENSIONS:	7" H x 20" W x 13" D
FAKE DWR STYLE:	MDF	BOWL SHAPE:	Rectangle
DWR #1 DIMENSIONS:	6.3" H x 15.75" W	SINK THICKNESS:	N/A
DWR CONSTRUCTION:	Standard	MOUNTING TYPE:	Integrated
SHELF STYLE:	Adjustable	OVERFLOW HOLE:	Yes
SHELF ADJUSTABILITY INCREMENTS:	1.26"	WARRANTY:	1-Year limited warranty
SHELF MAX WEIGHT CAPACITY:	40 lbs.	CARB COMPLIANT:	CARB Phase 2
SHELF DIMENSIONS:	12.76" W x 12.01" D	LEGAL FOR SALE IN CALIFORNIA:	Yes
SHELF THICKNESS:	0.59"	TSCA TITLE IV COMPLIANT:	Yes
SHELF MATERIAL:	Particle Board		
FRAME STYLE:	N/A		
FACE FRAME MATERIAL:	N/A		
SIDES MATERIAL:	Particle Board		
BOTTOM MATERIAL:	Particle Board		



TYPE:
JOB:
ORDER CODE:
APPROVALS: