

SmartTools

STINGRAY

The newest innovation for pulling wire!

In today's high tech world there is a lot of cable being pulled above drop ceilings, and that cable is fragile and expensive. Snagging cables on the drop ceiling not only ruins the cable but also the ceiling, creating delays and extra costs. That is all a thing of the past with Madison's new Stingray. Simply remove the ceiling tiles and snap the Stingray into the corner of the drop ceiling. That's it! You now have a safe and effective chase to run your cables through any drop ceiling. When you're finished simply pull the Stingray's tail and slide it off the grid.

- Protects expensive and fragile cables
- Protects ceiling from twisting and marring
- Smooth interior for an almost frictionless chase
- Side slit allows for easy cable removal
- Fits 1" standard ceiling grid
- Easy to install and remove



PROTECTS THE GRID. PROTECTS THE CABLES.



INSTRUCTIONS FOR USE

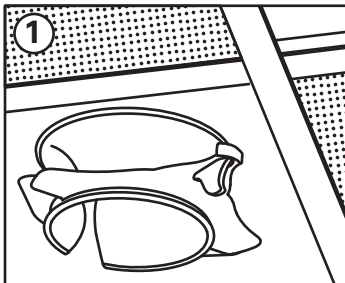

1. Remove both tiles in the corner of the ceiling you wish to install the Stingray, and position the Stingray tail down as shown.

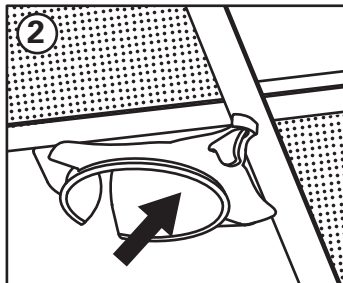

2. Slide Stingray into the corner of the ceiling grid, positioning the upper fins above the grid, and the lower fins below the grid.

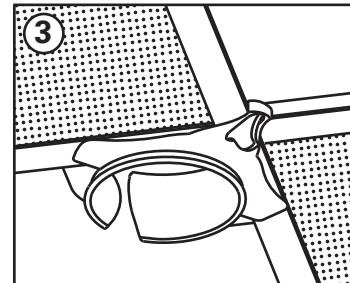

3. With the ceiling grid slotted between the Stingray's fins, push until Stingray locks into corner. You are now ready to run your wire.

TO REMOVE: Simply pull the Stingray's tail to release from ceiling grid and slide off.