

DESCRIPTION

A family of Gimbal Ring lampholders designed for PAR30 or PAR38 lamps. Lampholders are available in Satin White or Matte Black finishes. Lazer lampholders are compatible with all Halo Power-Trac systems.

Catalog #	Type
Project	
Comments	
Prepared by	Date

SPECIFICATION FEATURES

A...Electrical Quick Lock Adapter

Lexan polycarbonate casing. Attaches electrically and mechanically anywhere along track. Visual polarity line assures proper grounding. Two position conductor allows use in single circuit and either circuit of two circuit track.

B...Yoke

Matching finish yoke allows lampholder to rotate 358° and adjust vertically from 0° to 90°.

C...Gimbal Ring

Die formed gimbal ring contains lamp retention springs, provide lamp regress for optimum lamp position, provides uniform appearance between lamp types.

Listings

UL/CSA listed for use with Halo and Lazer-by-Halo track and track systems

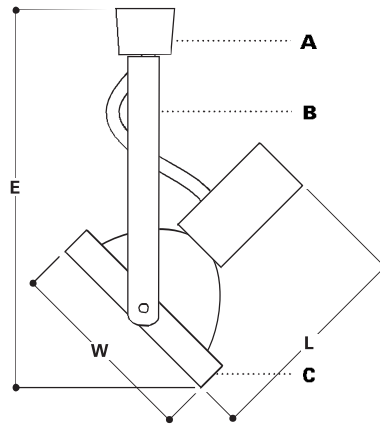

LZR330



LZR338

**LINE VOLTAGE
GIMBAL RING
LAMPHOLDERS**

Lazer by Halo

ORDERING INFORMATION

SAMPLE NUMBER: LZR330P

Lampholders	Finishes
LZR330 LZR338	P=Satin White with Black Baffle MB=Satin Black with Black Baffle



LZR330

For use with:
75W PAR30
(Short neck lamp only)
W=4" [102mm]
L =4 1/4" [108mm]
E =7 15/16" [202mm]

LZR338

For use with:
150W PAR38
W=5" [111mm]
L=6 1/8" [156mm]
E =10 1/4" [260mm]

ADV990373

9/04

TAB: Lazer Lampholders and Track
Sheet 4

Note: Specifications and Dimensions subject to change without notice.

Visit our web site at www.cooperlighting.com